

MAIN FLOOR PLAN - METHANE EXTRACTION
 SCALE 1:100
 NOTE: REFER TO INSTALLATION DETAILS ON MECHANICAL DRAWING M4.1

MAIN FLOOR PLAN - METHANE EXTRACTION
 SCALE 1:100

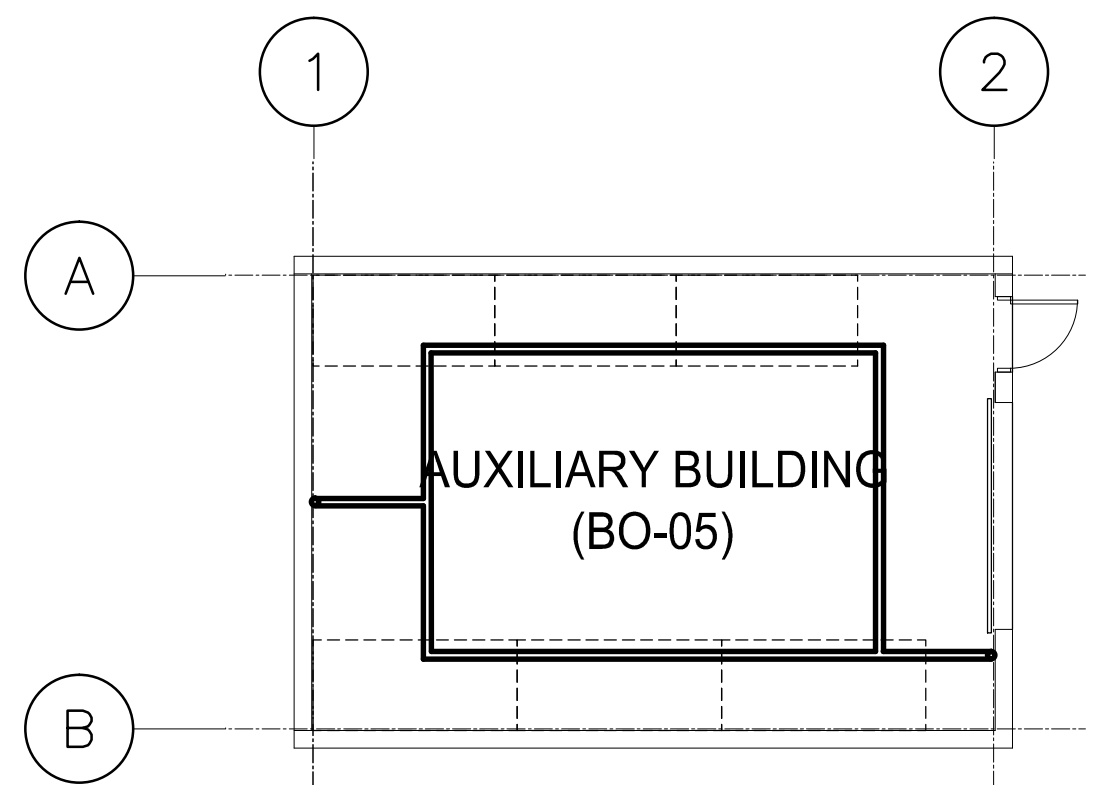

MAIN FLOOR PLAN - METHANE EXTRACTION
 SCALE 1:100

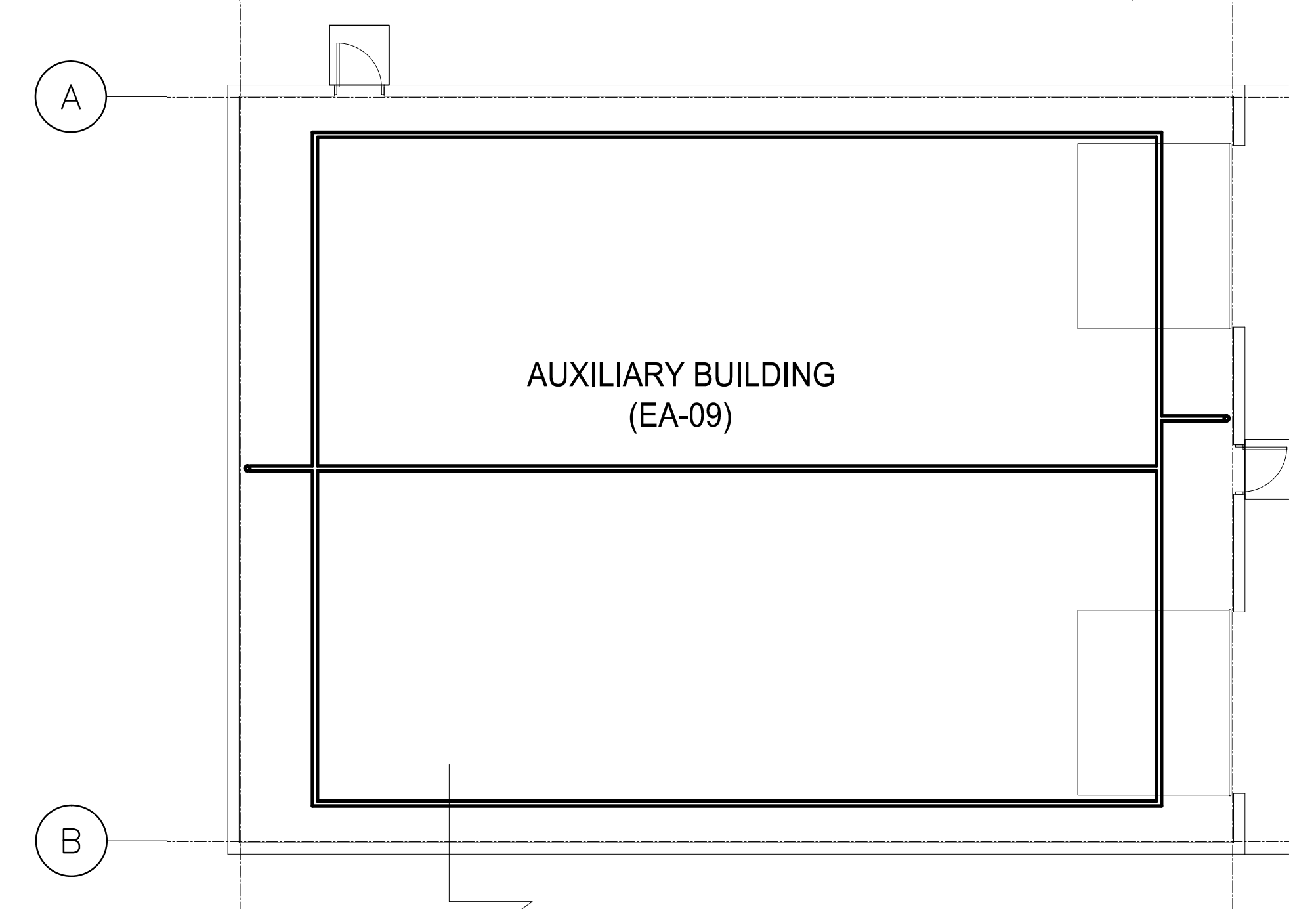

MAIN FLOOR PLAN - METHANE EXTRACTION
 SCALE 1:100

GENERAL NOTE
 INCLUDE IN MECHANICAL WORK AND PRICING SUBMISSION ALL THE MECHANICAL REQUIREMENTS OF THE CITY OF WINNIPEG REQUEST FOR PROPOSAL FOR THIS PROJECT (DESIGN AND CONSTRUCTION OF THE PUBLIC WORKS EAST YARD COMPLEX AT THE FORMER ELMWOOD/NAIRN LANDFILL SITE) INCLUDING ALL SPECIFICATIONS, SUBSEQUENT ADDENDA, CLARIFICATIONS, AND APPROVED CHANGE DIRECTIVES AS INTERPRETED BY THE CITY OF WINNIPEG AND THEIR ADVOCATE PROFESSIONAL ENGINEERS AND CONSULTANTS. THE MECHANICAL PLANS OUTLINED HEREIN ARE PROVIDED AS A GUIDE TO THE INTENT OF THE REQUEST FOR PROPOSAL REQUIREMENTS. IN THE CASE OF A CONFLICT OR OMISSION BETWEEN THE DRAWINGS AND SPECIFICATIONS AND THE INTERPRETED CITY OF WINNIPEG REQUEST FOR PROPOSAL, THE INSTALLATION SHALL BE COMPLETED IN CONFORMANCE WITH THE CITY OF WINNIPEG STATEMENT OF REQUIREMENTS AS INTERPRETED BY THE CITY OF WINNIPEG OR THEIR PROJECT PROFESSIONAL ENGINEERING REPRESENTATIVE.

REV	DESCRIPTION	DATE	BY
3	ISSUED FOR CONSTRUCTION	11 MAY 2012	PSG
2	ISSUED FOR 66% REVIEW	06 MAR 2012	PSG
1	ISSUED FOR 33% REVIEW	06 JAN 2012	PSG

NOVA 3 ENGINEERING LTD.
 CONSULTING ENGINEERS
 201-120 FORT STREET
 WINNIPEG, MANITOBA
 R3C 1C7
 TEL.: (204) 943-6142
 FAX.: (204) 942-1276
 CN: 31-178
 THIS DRAWING IS THE EXCLUSIVE PROPERTY OF NOVA 3 ENGINEERING LTD. AND MAY ONLY BE REPRODUCED WITH THE WRITTEN PERMISSION OF NOVA 3 ENGINEERING LTD.
 THE CONCEPT AND DESIGN INCORPORATED INTO THIS DRAWING ARE BASED ON INFORMATION PROVIDED BY THE CLIENT AND OTHER RELATED SOURCES. PROFESSIONAL ENGINEER ACCEPTS NO RESPONSIBILITY FOR DRAWING AND DESIGN UNLESS DRAWING IS ACCOMPANIED BY ORIGINAL SEALED AND SIGNED LETTER OF INTENT AND CERTIFICATE OF INSPECTION. REFER TO WWW.NOVA3.CA FOR CAUTIONARY NOTES.

APEGM
 Certificate of Authorization
 Nova 3 Engineering Ltd.
 No.962 Date: _____



ERNST HANSCH
 CONSTRUCTION LTD.

3 TERRACON PLACE
 WINNIPEG, CANADA R2J 4B3
 TEL. (204) 233 7881
 FAX (204) 233 4733
 general@ehansch.com
 www.ehansch.com

CLIENT: **CITY OF WINNIPEG PUBLIC WORKS DEPARTMENT**
 PROJECT NUMBER: **1511**
 DRAWN BY: **BSD**
 DATE: **MAR 6, 2012**
 SCALE: **1: 100**

PROJECT TITLE:
CITY OF WINNIPEG PUBLIC WORKS EAST YARD COMPLEX MAIN OFFICE & GARAGES
 SHEET TITLE:
MAIN FLOOR PLAN - METHANE EXTRACTION

SHEET NUMBER:
M4.5
 REVISION NUMBER:
0