

1 MAIN FLOOR KEY PLAN
A-2.1 Scale 1:500

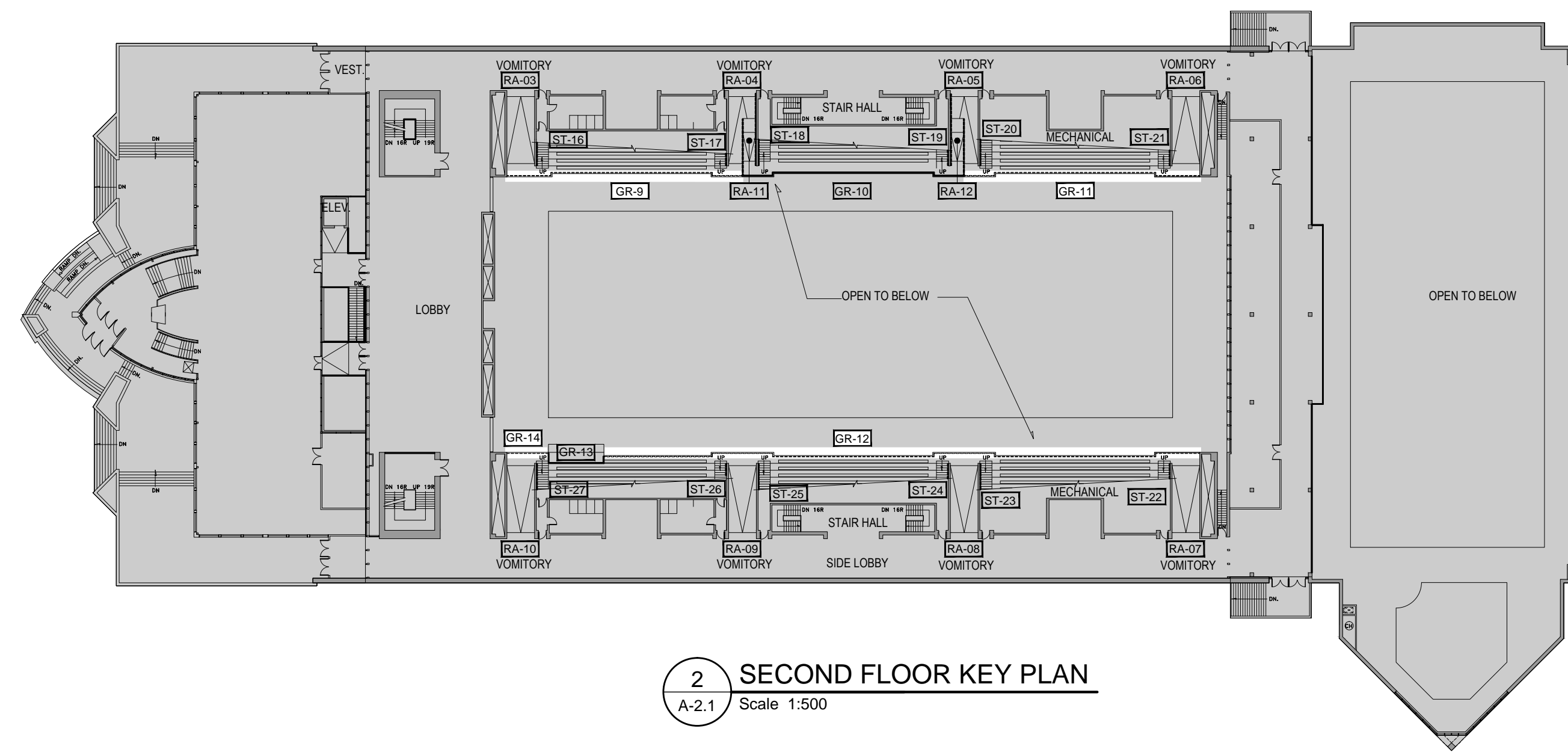

2 SECOND FLOOR KEY PLAN
A-2.1 Scale 1:500

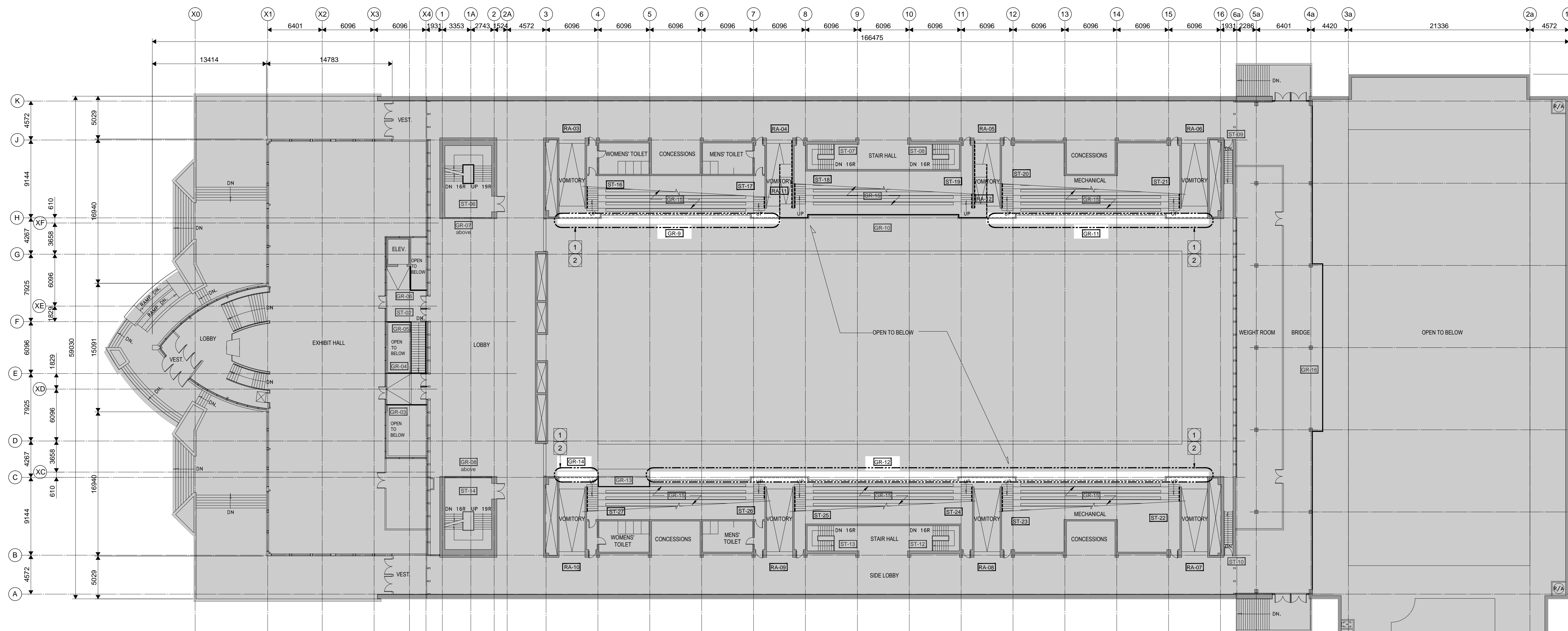

3 SECOND FLOOR DEMOLITION PLAN
A-2.1 Scale 1:250

- DEMOLITION PLAN NOTES:**
- 1 DEMOLISH EXISTING 4"x4" FIR RAIL AND ASSOCIATED 1-1/2"x1-1/2" STEEL BAR MOUNTING BRACKETS WELDED TO THE SLEEVES IN THE EXISTING C.I.P. CONCRETE WALL.
 - 2 DEMOLISH 4"x4" LIP AT THE EXISTING C.I.P. CONCRETE WALL.

LEGEND

AREA N.I.C.
GR-XX GUARD No.
RA-XX RAMP No.
ST-XX STAIR No.

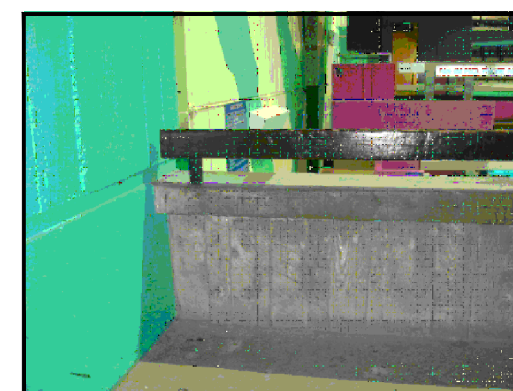

- GR-11
- GR-02 SIM.
- GR-12 SIM.
- GR-14 SIM.



ISSUED FOR
TENDER OWNER REVIEW
SEAL

ARCHITECT / PRIME CONSULTANT
SYNYSHYN
ARCHITECTURE + INTERIOR DESIGN INC.
MANITOBA • ALBERTA
T: 204.947.1100
F: 204.956.5742
603-63 Albert Street Winnipeg, Manitoba
R3B 1G4 Canada info@synyshyn.com www.synyshyn.com

ENGINEERING CONSULTANT
Crosier Kilgour & Partners Ltd.
CONSULTING STRUCTURAL ENGINEERS
300-275 Carlton Street Winnipeg, Manitoba R3C 5R6
T 204.943.7201 F 204.943.7507
2011-1092

PROJECT TITLE
PAN-AM POOL GUARD AND HANDRAIL UPGRADES (phase I)
25 Poseidon Bay, Winnipeg, Manitoba

DRAWING TITLE
KEY PLANS, LEGEND AND SECOND FLOOR DEMOLITION PLAN

DESIGNED BY JS DRAWN BY
ISSUE DATE 06/29/12 REVISION No.
PROJECT No. 12902 DRAWING No. A-2.1