

Drawings and specifications, as instruments of service are the property of the architect. The copyright in the same being reserved to him. No reproduction may be made without the permission of the architect and when made, must bear his name. All prints to be returned to the architect. The contractor shall verify dimensions and data noted herein with conditions on the site and is held responsible for reporting any discrepancy to the architect for adjustment. This drawing shall not be used for building purposes until countersigned by:

Chantal Lalary
SUBCONSULTANTS

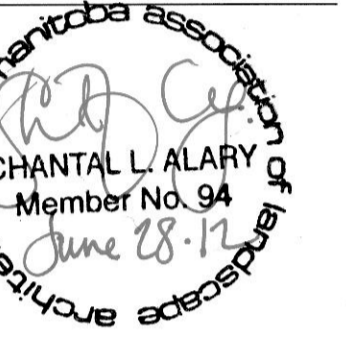

Friesen Tokar Architects + Interior Designers
200 - 300 Westford Drive Winnipeg, Canada R3B 0G5 Tel: 204-886-9323 Fax: 204-837-7335



| | |
|------------------|-------------|
| 12420 | PROJECT NO. |
| 2012.06.28 | DATE |
| RE | DRAWN BY |
| CA | CHECKED BY |
| | FILE/PATH |
| | CLIENT |
| CITY OF WINNIPEG | |

PROJECT TITLE
**ROSE HILL PARK
& PLAYGROUND UPGRADES
186 GARTON AVENUE**

CONTENTS
EXISTING SITE PLAN & DEMOLITION

DRAWING
L1.0

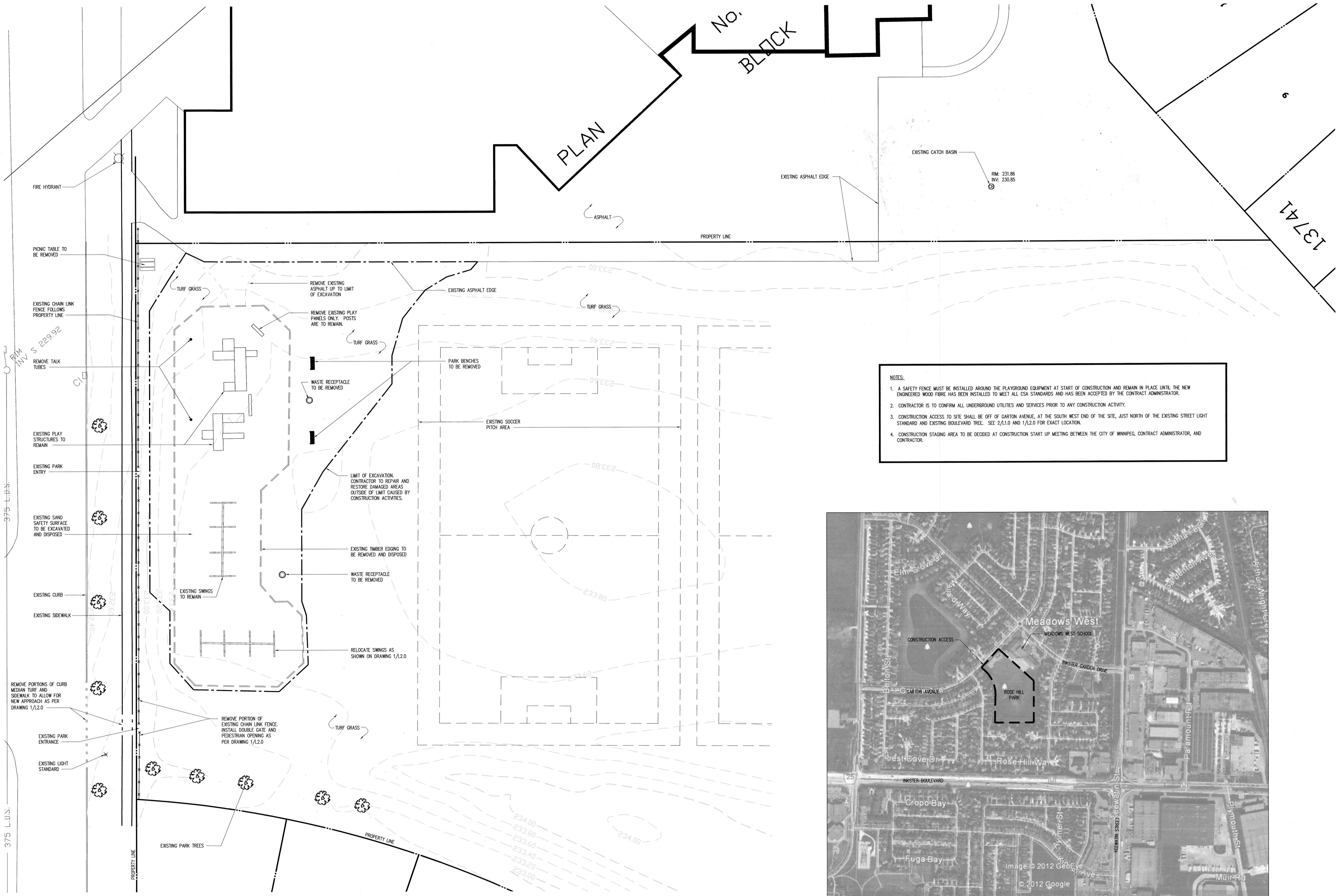

- NOTES:**
1. A SAFETY FENCE MUST BE INSTALLED AROUND THE PLAYGROUND EQUIPMENT AT START OF CONSTRUCTION AND REMAIN IN PLACE UNTIL THE NEW ENGINEERED WOOD FIBRE HAS BEEN INSTALLED TO MEET ALL CSA STANDARDS AND HAS BEEN ACCEPTED BY THE CONTRACT ADMINISTRATOR.
 2. CONTRACTOR IS TO CONFIRM ALL UNDERGROUND UTILITIES AND SERVICES PRIOR TO ANY CONSTRUCTION ACTIVITY.
 3. CONSTRUCTION ACCESS TO SITE SHALL BE OFF OF GARTON AVENUE, AT THE SOUTH WEST END OF THE SITE, JUST NORTH OF THE EXISTING STREET LIGHT STANDARD AND EXISTING BOULEVARD TREE. SEE 2/1.0 AND 1/1.2.0 FOR EXACT LOCATION.
 4. CONSTRUCTION STAGING AREA TO BE DECIDED AT CONSTRUCTION START UP MEETING BETWEEN THE CITY OF WINNIPEG, CONTRACT ADMINISTRATOR, AND CONTRACTOR.



2
L1.0
SITE LOCATION PLAN
NTS

1
L1.0
EXISTING SITE PLAN & DEMOLITION
1:250 @ 24" X 36" SHEET SIZE