

sheet size - Super A1 24" x 36"

CAD File Name: 11-0107-22_kelvin_site_3D_render_3D_render_park_surface.dwg

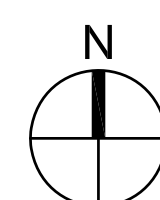
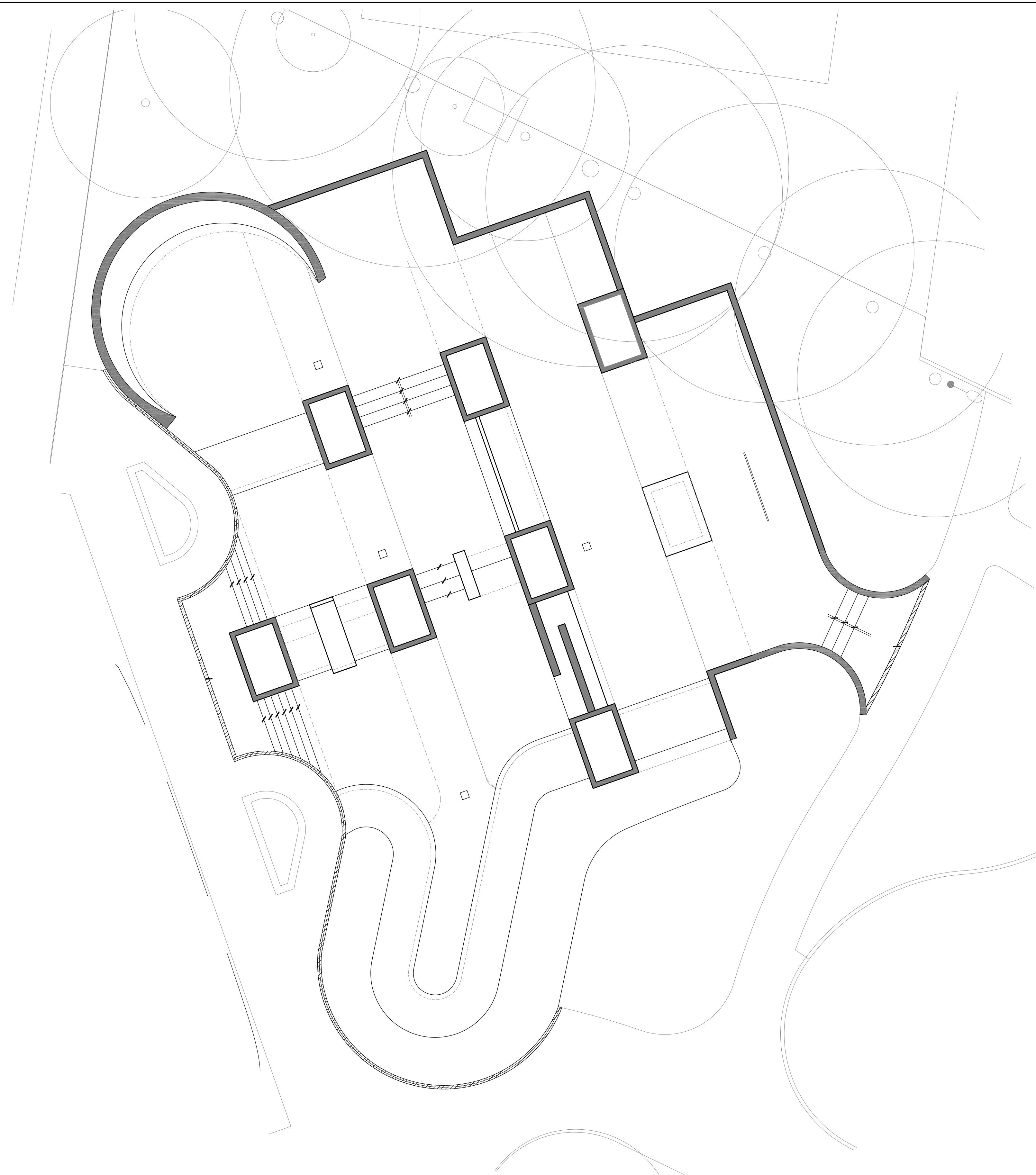

PENDING ENGINEERING

A.	SECTION LETTER OR DETAIL NUMBER.			
B.	DRAWING WHERE SECTION OR DETAIL IS DRAWN.			
OR				
A.	DRAWING WHERE SECTION OR DETAIL IS INDICATED.			
---	SECTION OR DETAIL SHOWN ON SAME DRAWING.			
1	12 / 08 / 16	ISSUED FOR TENDER	DKM	
0	12 / 07 / 19	ISSUED FOR TENDER	DKM	
REV	YY / MM / DD	DESCRIPTION	BY	

SEAL

(A) (A)
(B) (---)

CLIENT

CITY OF WINNIPEG
PLANNING, PROPERTY AND
DEVELOPMENT DEPARTMENT
300 - 65 GARRY ST. R3C 4K4

SCATLIFF + MILLER + MURRAY Inc.

TEL 204 927-3444 1120 - 201 PORTAGE AVENUE
FAX 204 927-3443 WINNIPEG, MB, CANADA

PROJECT	KELVIN RECREATION SITE		
	B.P.C.C.		
TITLE	SKATE PARK EXCAVATION PLAN		
DESIGN	DRAWN	DATE - Y / M / D	SCALE
-	-	2012/07/19	1:100
CHECKED	APPROVED	PROJECT NO.	DRAWING NO.
-	-	11-0107-22	L-06