

- 14-18.00 CONNECT TO EXIST 150 AC WM
- 14-18.00 INSTALL 150 AC BEND
- 14-18.00 INSTALL 150 45° BEND
- 04-94.91 S. R. GRANT AVE. INSTALL 150 VALVE
- 04-94.95 ABANDON EXIST VALVE
- 04-95.79 REMOVE EXIST 200x200x150x150 CROSS AND INSTALL 200x200x150x150 CROSS
- 14-00
- 14-04.00 INSTALL 150 45° VERT. BEND (SD=005)
- 14-05.00 INSTALL 150 45° VERT. BEND (SD=005)
- 14-06.00 EXIST BEND
- 14-06.03 EXIST BEND
- 14-06.04 EXIST BEND
- 14-06.12 EXIST BEND
- 14-18.00 INSTALL 150 45° VERT. BEND (SD=005)
- 14-19.00 INSTALL 150 45° VERT. BEND (SD=005)
- 14-25.00 S. R. GRANT AVE. INSTALL 150 VALVE
- 14-25.50 ABANDON EXIST VALVE
- 14-26.42 REMOVE EXIST HYDRANT
- 14-26.50 INSTALL HYDRANT (SD=007)
- 14-28.00 INSTALL 150x150x150 TEE
- 14-50 GRADE CHANGE
- 14-57.50 INSTALL HYDRANT (SD=007)
- 14-58.00 INSTALL 150x150x150 TEE

NOTE: CHAINAGES SHOWN ARE ALONG E R OF WAVERLEY ST

WAVERLEY STREET

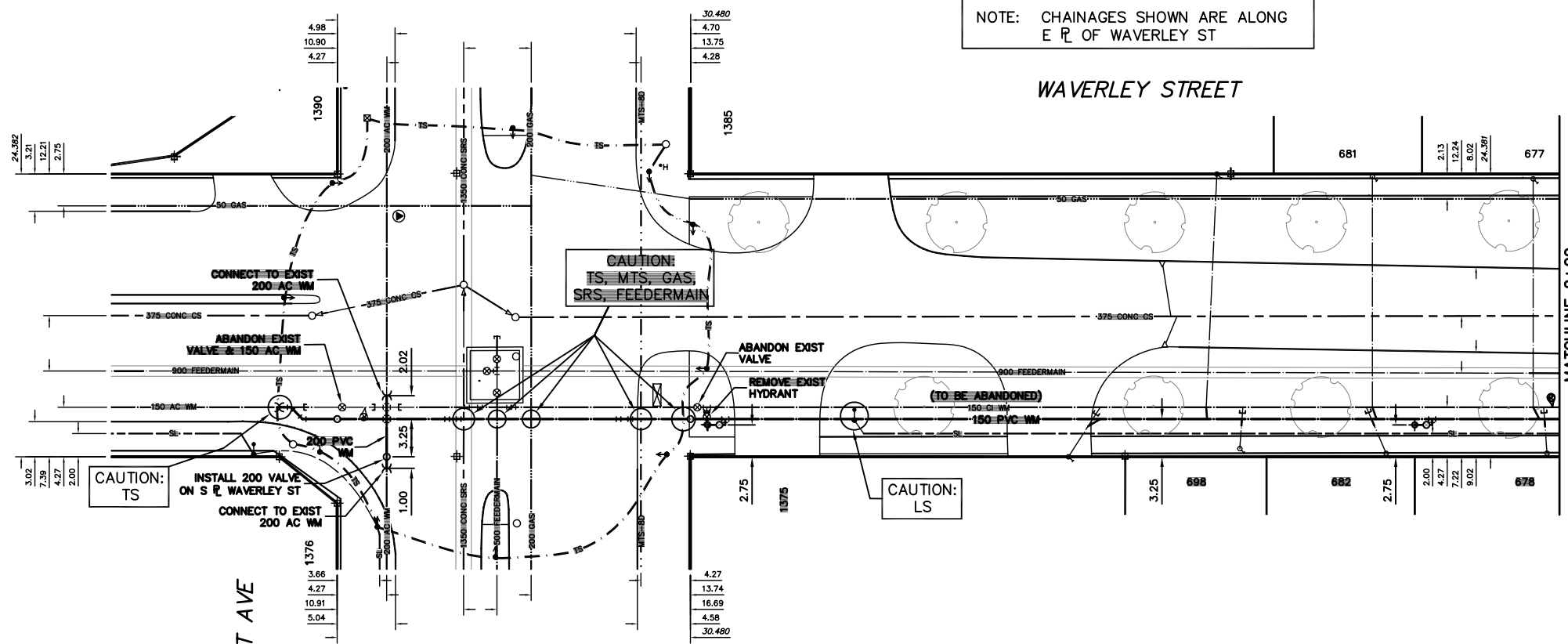

WATER SERVICE INFORMATION

ADDRESS	SIZE (mm) (STREET)	SIZE (mm) (PROP.)	SHORT & LONG MEASUREMENT	CORP. LOCATION	REMARKS
677 WAVERLEY ST	20	20	72.71>NNL GRANT	OPP S/C	-
678 WAVERLEY ST	20	20	73.88>NNL GRANT	0.3 S OF S/C	-
681 WAVERLEY ST	20	20	58.78>NNL GRANT	OPP S/C	-
682 WAVERLEY ST	20	20	60.09>NNL GRANT	1.8 S OF S/C	-
698 WAVERLEY ST	20	20	47.51>NNL GRANT	0.3 N OF S/C	-
1375 GRANT AVE	20	20	32.65>NNL GRANT	2.7 N OF S/C	SERV. OFF WAVERLEY
1385 GRANT AVE	25	25	45.47>NNL GRANT	0.8 S OF S/C	SERV. OFF WAVERLEY

*SERVICES TO BE RENEWED TO R ALL OTHERS TO BE RECONNECTED

CONSTRUCTION NOTES:
 NO CONSTRUCTION EQUIPMENT OR MATERIAL TO BE PLACED OR SETUP DIRECTLY OVER 900 FEEDERMAIN.
 DO NOT USE VIBRATORY EQUIPMENT WITHIN 3.0 m OF 900 FEEDERMAIN.

NOTE: ALL VALVES TO BE INSTALLED COUNTER-CLOCKWISE TO CLOSE

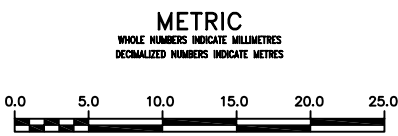

WARNING
 IF POWER EQUIPMENT OR EXPLOSIVES ARE TO BE USED FOR EXCAVATION ON THIS PROJECT THE CONTRACTOR MUST:
 1) NOTIFY THE GAS COMPANY OF THE PROPOSED LOCATION OF EXCAVATION.
 2) TAKE PRECAUTION TO AVOID DAMAGE TO GAS COMPANY INSTALLATIONS.
 SEE PROVINCIAL REGULATION 210/72 FOR DETAILS

LOCATION APPROVED UNDERGROUND STRUCTURES
 SUPV. U/G STRUCTURES COMMITTEE DATE
 NOTE:
 LOCATION OF UNDERGROUND STRUCTURES AS SHOWN ARE BASED ON THE BEST INFORMATION AVAILABLE BUT NO GUARANTEE IS GIVEN THAT ALL EXISTING UTILITIES ARE SHOWN OR THAT THE GIVEN LOCATIONS ARE EXACT. CONFIRMATION OF EXISTENCE AND EXACT LOCATION OF ALL SERVICES MUST BE OBTAINED FROM THE INDIVIDUAL UTILITIES BEFORE PROCEEDING WITH CONSTRUCTION.

B.M. ELEV.	
CONSTRUCTION COMPLETION DATE: YYYY MM DD	
DESIGNED BY	NC
CHECKED BY	SC
DRAWN BY	CJH
APPROVED BY	KZ
SCALE:	
HORIZONTAL	1:250
VERTICAL	1:50
RELEASED FOR CONSTRUCTION	
K.R. ZUREK	
DATE	JULY 30, 2012
NO.	REVISIONS
DATE	BY
DATE	2012 07 31
PLOT DATE:	2012 07 31

ENGINEER'S SEAL
 ORIGINAL SIGNED BY S.R.J. COURNOYER 12-07-30
 CONSULTANT DRAWING NUMBER

THE CITY OF WINNIPEG
 WATER AND WASTE DEPARTMENT
 ENGINEERING DIVISION
 2012 WATERMAIN RENEWALS
 WAVERLEY STREET
 GRANT AVENUE TO
 75 N OF GRANT AVENUE
 SHEET 8 OF 9
 CITY DRAWING NUMBER
 D-13031