

GUILDFORD STREET

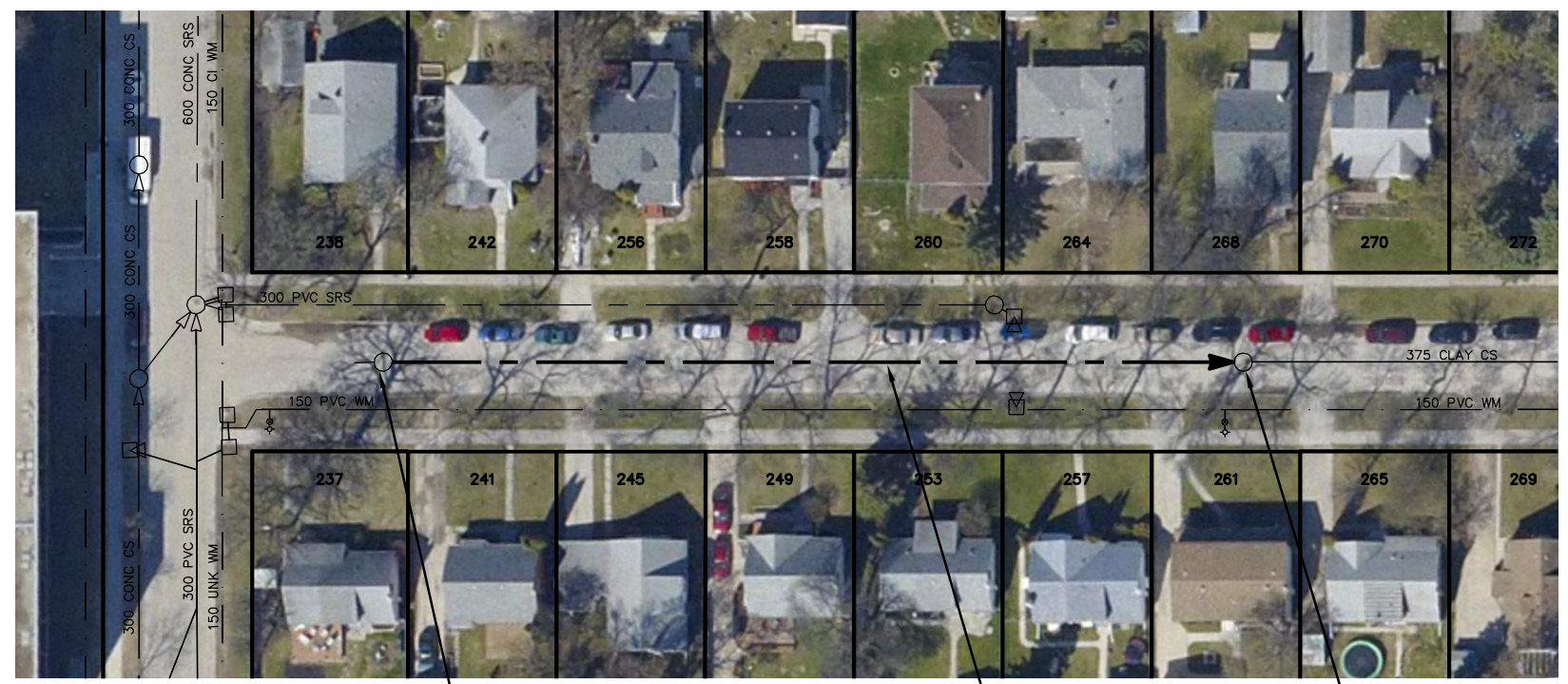

LODGE AV

S-MH20004823
RIM 234.39
INV N 231.42
INV S 231.49

88.20 OF 300 CLAY CS
TO BE LINED S-MA20005269
(FULLY DETERIORATED)

S-MH20004850
RIM 234.20
INV N 231.28
INV S 231.28

SEWER JUNCTION INFORMATION FROM SEWER VIDEO INSPECTION SEWER ID S-MA20005269		
DISTANCE FROM MH ID S-MH20004823		
DISTANCE	DIAMETER	CLOCK
2.8	150	10
2.9	150	3
17.6	150	11
18.4	150	2
19.1	150	2
30.7	150	2
33.1	150	11
33.8	150	1
47.8	150	10
48.0	150	2
48.6	150	1
61.0	150	2
63.4	150	11
64.1	150	2
64.9	150	2
65.0	150	10
79.0	150	2

WARNING

IF POWER EQUIPMENT OR EXPLOSIVES ARE TO BE USED FOR EXCAVATION ON THIS PROJECT THE CONTRACTOR MUST:

- 1) NOTIFY THE GAS COMPANY OF THE PROPOSED LOCATION OF EXCAVATION.
- 2) TAKE PRECAUTION TO AVOID DAMAGE TO GAS COMPANY INSTALLATIONS.

SEE PROVINCIAL REGULATION 210/72 FOR DETAILS

METRIC

WHOLE NUMBERS INDICATE MILLIMETRES
DECIMALIZED NUMBERS INDICATE METRES



LOCATION APPROVED UNDERGROUND STRUCTURES SUPV. U/G STRUCTURES COMMITTEE _____ DATE _____ NOTE: LOCATION OF UNDERGROUND STRUCTURES AS SHOWN ARE BASED ON THE BEST INFORMATION AVAILABLE BUT NO GUARANTEE IS GIVEN THAT ALL EXISTING UTILITIES ARE SHOWN OR THAT THE GIVEN LOCATIONS ARE EXACT. CONFIRMATION OF EXISTENCE AND EXACT LOCATION OF ALL SERVICES MUST BE OBTAINED FROM THE INDIVIDUAL UTILITIES BEFORE PROCEEDING WITH CONSTRUCTION.	B.M. ELEV. CONSTRUCTION COMPLETION DATE: YYYY MM DD <table border="1" style="width: 100%; height: 40px;"> <tr><td> </td><td> </td><td> </td><td> </td></tr> </table>					<table border="1" style="width: 100%;"> <tr> <td>DESIGNED BY</td><td>SC</td> <td>CHECKED BY</td><td>SC</td> </tr> <tr> <td>DRAWN BY</td><td>JB</td> <td>APPROVED BY</td><td>KZ</td> </tr> <tr> <td>SCALE:</td><td rowspan="2">1:750</td> <td>RELEASED FOR CONSTRUCTION</td><td> </td> </tr> <tr> <td>HORIZONTAL</td><td> </td> </tr> <tr> <td>VERTICAL</td><td> </td> <td> </td><td> </td> </tr> <tr> <td>DATE</td><td>2012 08 17</td> <td>DATE</td><td> </td> </tr> <tr> <td>PLOT DATE:</td><td>2012 08 17</td> <td> </td><td> </td> </tr> </table>	DESIGNED BY	SC	CHECKED BY	SC	DRAWN BY	JB	APPROVED BY	KZ	SCALE:	1:750	RELEASED FOR CONSTRUCTION		HORIZONTAL		VERTICAL				DATE	2012 08 17	DATE		PLOT DATE:	2012 08 17			ENGINEER'S SEAL ORIGINAL SIGNED BY S.R.J. COURNOYER AUG. 15, 2012 CONSULTANT DRAWING NUMBER -	<h2 style="margin: 0;">THE CITY OF WINNIPEG</h2> <p style="margin: 0;">WATER AND WASTE DEPARTMENT ENGINEERING DIVISION</p> <p style="margin: 0;">2012 SEWER RENEWALS BY CIPP LINING GUILDFORD STREET 1ST MH N OF LODGE AVENUE TO 2ND MH N OF LODGE AVENUE</p>	SHEET 18 OF 57 CITY DRAWING NUMBER 10290
DESIGNED BY	SC	CHECKED BY	SC																																
DRAWN BY	JB	APPROVED BY	KZ																																
SCALE:	1:750	RELEASED FOR CONSTRUCTION																																	
HORIZONTAL																																			
VERTICAL																																			
DATE	2012 08 17	DATE																																	
PLOT DATE:	2012 08 17																																		