

MULVEY AVENUE

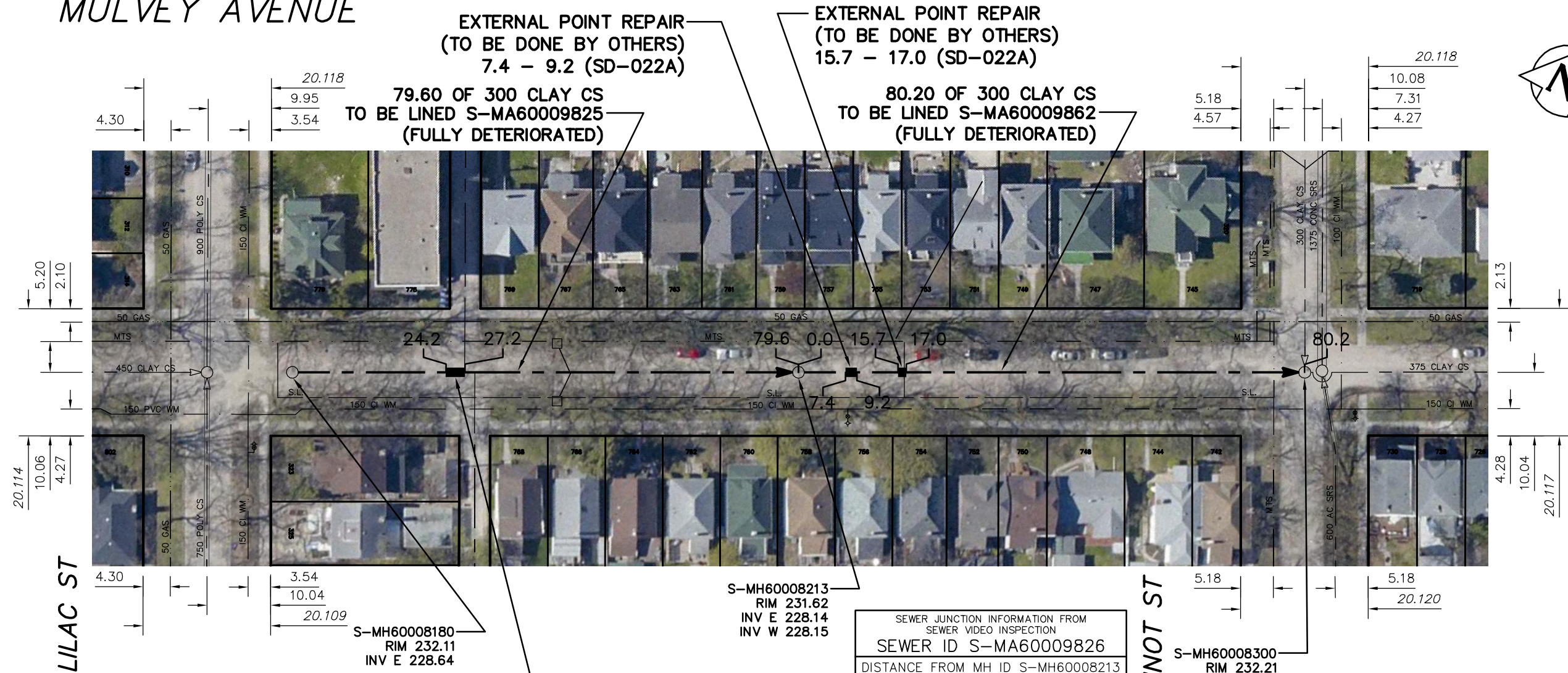

**EXTERNAL POINT REPAIR
(TO BE DONE BY OTHERS)
24.2 - 27.2 (SD-022A)**

SEWER JUNCTION INFORMATION FROM SEWER VIDEO INSPECTION
SEWER ID S-MA60009825

DISTANCE FROM MH ID S-MH60008180		
DISTANCE	DIAMETER	CLOCK
4.1	150	10
18.7	150	2

SEWER JUNCTION INFORMATION FROM SEWER VIDEO INSPECTION
SEWER ID S-MA60009825

DISTANCE FROM MH ID S-MH60008213		
DISTANCE	DIAMETER	CLOCK
13.6	150	2
23.0	150	11
23.0	150	11
29.9	150	2
38.7	150	11
39.9	250	10
40.6	250	2
45.7	150	2
51.1	250	10
53.1	150	3

SEWER JUNCTION INFORMATION FROM SEWER VIDEO INSPECTION
SEWER ID S-MA60009826

DISTANCE FROM MH ID S-MH60008213		
DISTANCE	DIAMETER	CLOCK
2.8	150	1
8.4	150	10
15.9	150	2
16.5	150	11
30.9	150	1
31.6	150	11
45.9	150	2
48.6	150	10
53.6	150	2
61.7	150	2
62.3	150	10
69.1	150	3
69.8	150	10
71.9	150	11
75.6	150	1

S-MH60008300
RIM 232.21
INV E 226.63
INV W 226.64
INV N 226.81

WARNING

IF POWER EQUIPMENT OR EXPLOSIVES ARE TO BE USED FOR EXCAVATION ON THIS PROJECT THE CONTRACTOR MUST:

- 1) NOTIFY THE GAS COMPANY OF THE PROPOSED LOCATION OF EXCAVATION.
- 2) TAKE PRECAUTION TO AVOID DAMAGE TO GAS COMPANY INSTALLATIONS.

SEE PROVINCIAL REGULATION 210/72 FOR DETAILS

METRIC
WHOLE NUMBERS INDICATE MILLIMETRES
DECIMALIZED NUMBERS INDICATE METRES

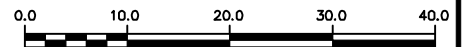

LOCATION APPROVED
UNDERGROUND STRUCTURES

SUPV. U/G STRUCTURES COMMITTEE DATE

NOTE:

LOCATION OF UNDERGROUND STRUCTURES AS SHOWN ARE BASED ON THE BEST INFORMATION AVAILABLE BUT NO GUARANTEE IS GIVEN THAT ALL EXISTING UTILITIES ARE SHOWN OR THAT THE GIVEN LOCATIONS ARE EXACT. CONFIRMATION OF EXISTENCE AND EXACT LOCATION OF ALL SERVICES MUST BE OBTAINED FROM THE INDIVIDUAL UTILITIES BEFORE PROCEEDING WITH CONSTRUCTION.

B.M. ELEV.			
CONSTRUCTION COMPLETION DATE: YYYY MM DD			
NO.	REVISIONS	DATE	BY

DESIGNED BY	SC	CHECKED BY	SC
DRAWN BY	JB	APPROVED BY	KZ
SCALE:	1:750		
HORIZONTAL			
VERTICAL			
DATE	2012 08 17	DATE	
PLOT DATE:	2012 08 17		

ENGINEER'S SEAL
**ORIGINAL SIGNED BY
S.R.J. COURNOYER
AUG. 15, 2012**
CONSULTANT DRAWING NUMBER



THE CITY OF WINNIPEG
WATER AND WASTE DEPARTMENT
ENGINEERING DIVISION

2012 SEWER RENEWALS
BY CIPP LINING
MULVEY AVENUE
MH AT LILAC STREET (EPL) TO
MH AT ARBUTHNOT STREET

SHEET 28 OF 57

CITY DRAWING NUMBER

10300

BID OPPORTUNITY: ??-????
CONTRACT NUMBER: ??

FILE PATH: R:\DRAWINGS\SEWER\2012_RENEWALS\CIPP, TPR, and EPR\CONTRACT 10\CIPP LINING\
FILE NAME: MULVEY.dwg