

**1** BASEMENT PLAN - EXISTING / DEMOLITION  
A-3.1 SCALE: 1:100

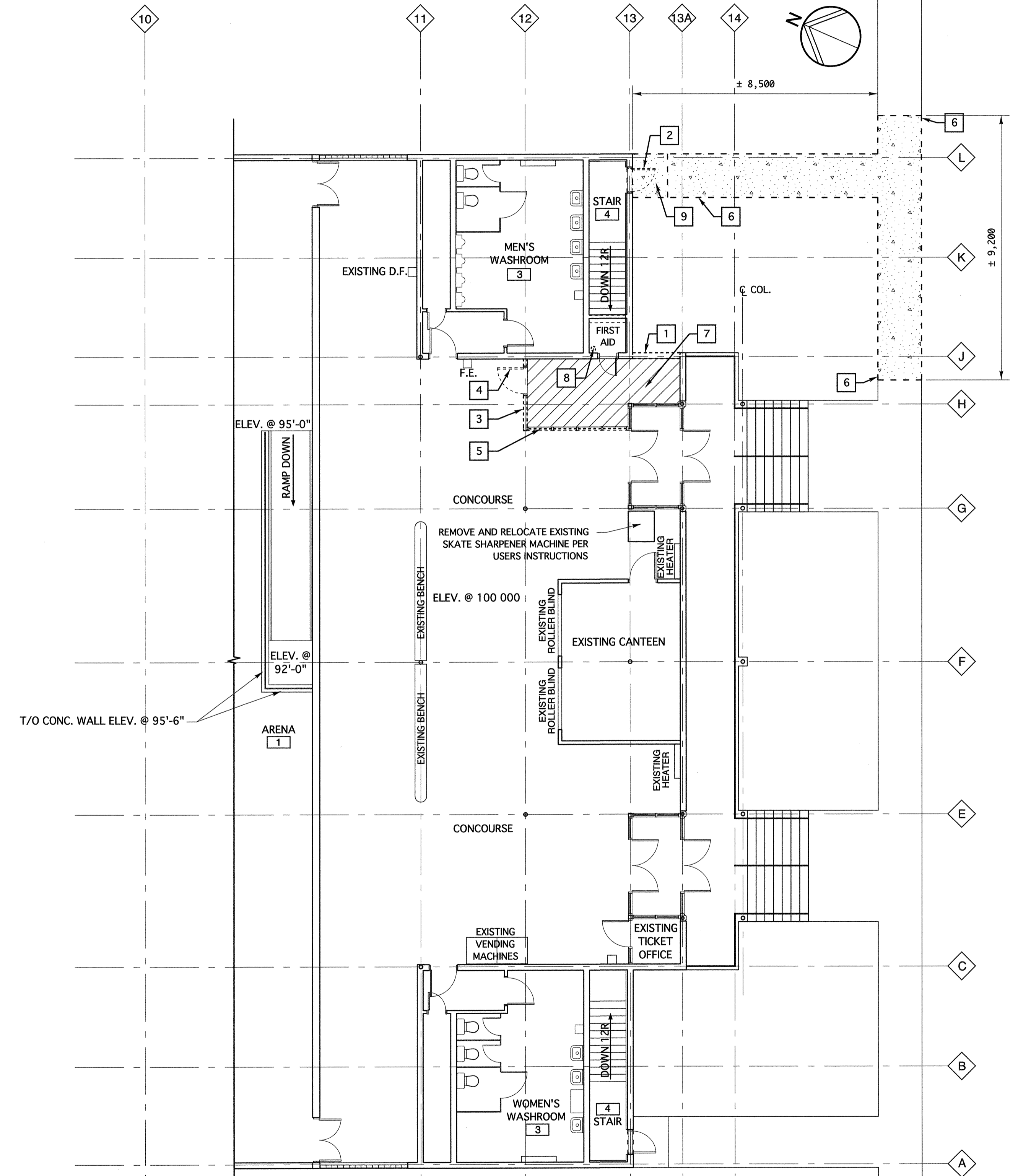

**2** MAIN FLOOR PLAN - EXISTING / DEMOLITION  
A-3.1 SCALE: 1:100

- NUMBERED NOTES:**
- 1 CUT/REMOVE EXISTING 190mm CONC. BLOCK WALL FOR ACCESS TO NEW ELEVATOR LOBBY - SEE STRUCTURAL
  - 2 REMOVE EXISTING DOOR
  - 3 REMOVE EXISTING WALL
  - 4 CAREFULLY REMOVE EXISTING DOOR AND RELOCATE AS PER FLOOR PLANS
  - 5 CAREFULLY REMOVE EXISTING TICKET OFFICE GLAZING AND RELOCATE AS PER FLOOR PLANS
  - 6 REMOVE EXISTING SIDEWALK TO EXTENT REQUIRED FOR NEW CONSTRUCTION
  - 7 PATCH AND MAKE GOOD EXISTING FLOOR, WALL, CEILING FINISHES WHERE EXISTING WALLS ARE REMOVED.
  - 8 CORE NEW HOLE IN EXISTING FLOOR FOR NEW RAIN WATER LEADER - SEE MECHANICAL.
  - 9 REMOVE EXISTING CONCRETE LANDING AT EXISTING EXIT DOOR.

ISSUED FOR TENDER SEPT. 28, 2012

revision

This drawing must not be scaled.

The general Contractor must verify all dimensions, datums and levels prior to commencement of work. All errors and omissions must be reported immediately to the Architect.

Variations and modifications to work shown on this drawing shall not be carried out without written permission from the Architect.

This drawing is the exclusive property of the Architect and cannot be reproduced without written permission of the Architect. Reproduction must bear the name of the Architect. Copyright © 2012.

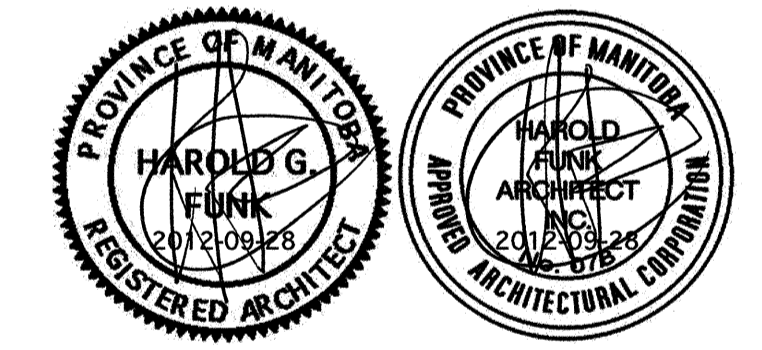

**harold funk** architect inc.

Harold Funk Architect Inc.  
Architecture and Urban Design

401-55 Donald Street, Winnipeg, Manitoba R3C 1L8  
T (204) 943-5087 info@funkarchitect.com  
F (204) 949-9231 funkarchitect.com

project  
**ELEVATOR ADDITION AND ACCESSIBILITY UPGRADES OF CENTURY ARENA**  
Winnipeg, Manitoba Bid Opportunity No. 579-2012

sheet title  
**BASEMENT AND MAIN FLOOR DEMOLITION PLANS**

project number: 12-003 drawing number:  
scale: 1:100 or AS SHOWN **A-3.1**  
drawn by: C.G.  
approved by: H.F.  
date: SEPT. 28, 2012