

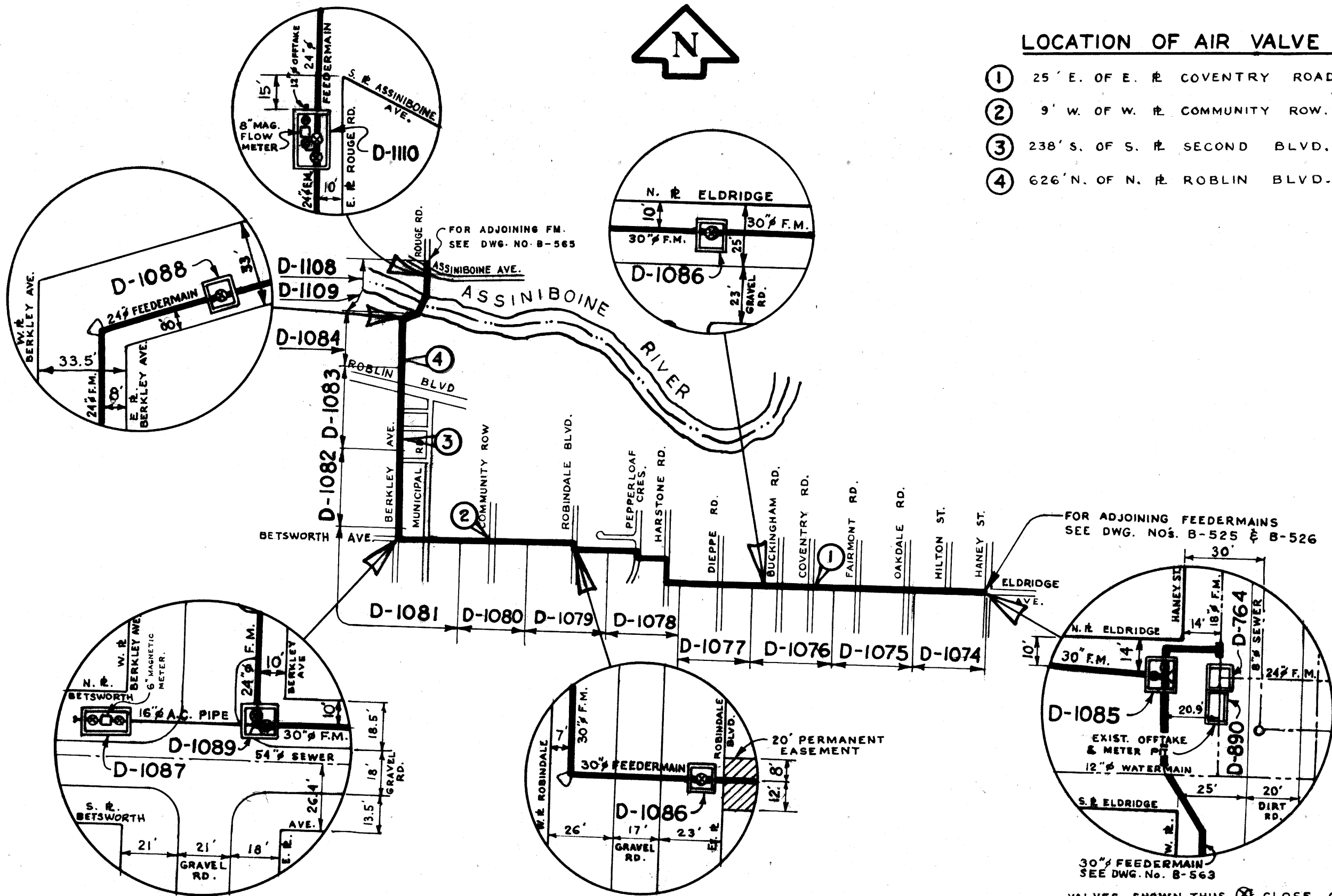

LOCATION OF AIR VALVE PITS

- ① 25' E. OF E. R. COVENTRY ROAD.
- ② 9' W. OF W. R. COMMUNITY ROW.
- ③ 238' S. OF S. R. SECOND BLVD.
- ④ 626' N. OF N. R. ROBLIN BLVD.



FOR ADJOINING FEEDERMAINS
SEE DWG. NOS. B-525 & B-526

30" FEEDERMAIN
SEE DWG. No. B-563

VALVES SHOWN THUS ⊗ CLOSE CLOCKWISE
VALVES SHOWN THUS ⊠ CLOSE COUNTERCLOCKWISE.

| NO. | DESCRIPTION | DATE | BY |
|------------------|-----------------|---------|-----|
| 2 | REVISED TO DATE | 24.9.82 | TM. |
| 1 | REVISED TO DATE | MAR 71 | HB |
| REVISIONS | | | |

THE CITY OF WINNIPEG
**WATERWORKS WASTE &
DISPOSAL DEPT.**
DIRECTOR - A. PENMAN

WATERWORKS DEPT
**CHARLESWOOD ASSINIBOIA FEEDERMAIN
VALVE & METER PIT LOCATIONS**

DES. W. S. B. CHKD. *dkh*
DRN. HB DATE OCT 65
DEPT. CHK'D.
APPROVED *[Signature]*

SCALE
1" = 1500'
DRAWING NO.
B-556

MICROFILMED 1973