

0+75
 0+78.867 W R. GUELPH ST
 0+80.76 CONNECT TO EXIST MH ID S-MH60008715
 0+90.21 ABANDON EXIST MH ID S-MH60008758
 1+00 E R. GUELPH ST
 1+25
 1+50
 1+75
 1+77.71 ABANDON EXIST MH ID S-MH60008759
 1+77.90 REMOVE EXIST PLUG AND CONNECT TO EXIST 450 CONC CS
 1+79.39 EXIST MH ID S-MH60008760
 2+00

NOTE: CHAINAGES SHOWN ARE ALONG N. R. OF HARVARD AVE.

SEWER SERVICE INFORMATION

ADDRESS	SIZE (mm) MATERIAL	R DIST JUNCTION TIE	REMARKS
155 HARVARD AVE RESIDENTIAL	-	8.54 E OF WL	-
158 HARVARD AVE RESIDENTIAL	-	2.14 W OF 1ST MH W HARROW	-
161 HARVARD AVE RESIDENTIAL	-	5.49 W OF EL	-
162 HARVARD AVE RESIDENTIAL	-	2.75 W OF 1ST MH W HARROW	-
164 HARVARD AVE RESIDENTIAL	-	-	-
166 HARVARD AVE RESIDENTIAL	-	4.27 W OF EL	-
167 HARVARD AVE RESIDENTIAL	-	30.50 W OF 1ST MH W HARROW	-
172 HARVARD AVE RESIDENTIAL	150	4.58 W OF EHL	-
175 HARVARD AVE RESIDENTIAL	-	32.94 W OF 1ST MH W HARROW	-
176 HARVARD AVE RESIDENTIAL	-	8.69 E OF WL	-
177 HARVARD AVE RESIDENTIAL	-	62.83 W OF 1ST MH W HARROW	-
178 HARVARD AVE RESIDENTIAL	-	10.68 E OF WL	-
179 HARVARD AVE RESIDENTIAL	-	62.22 W OF 1ST MH W HARROW	-

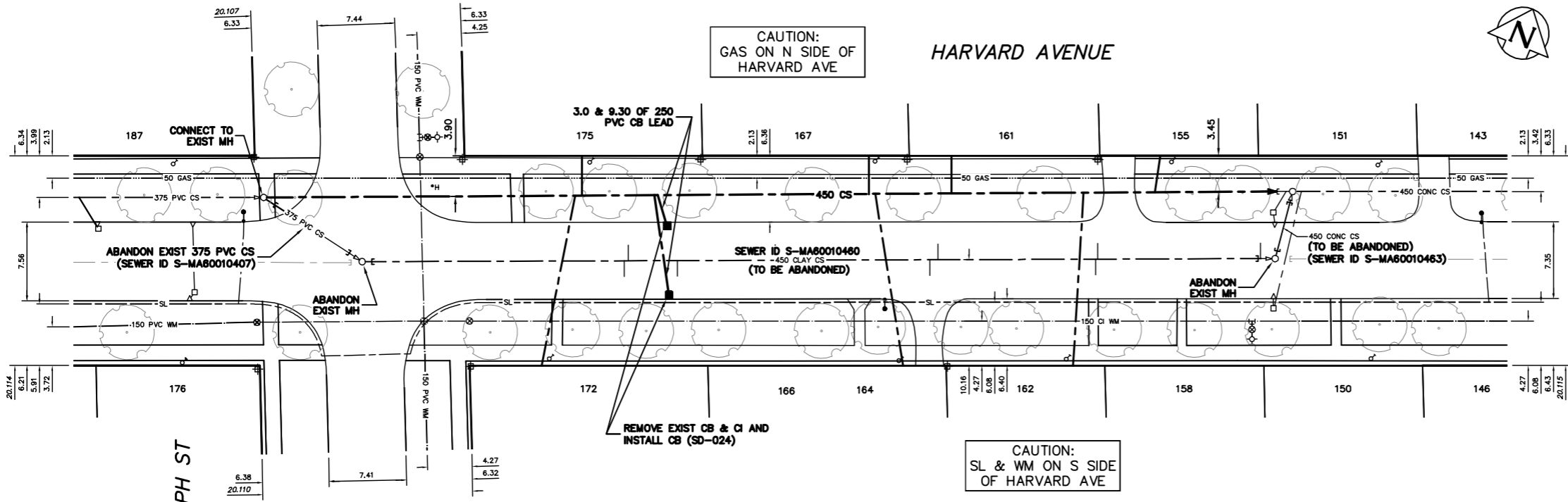

SEWER JUNCTION INFORMATION FROM SEWER VIDEO INSPECTION
 SEWER ID S-MA60010460
 DISTANCE FROM MH ID S-MH60008758

DISTANCE	DIAMETER	CLOCK
25.1	150	2
25.5	150	10
30.2	150	2
39.6	150	10
54.4	150	2
55.2	150	10
70.3	150	1
70.5	150	11
86.1	150	10

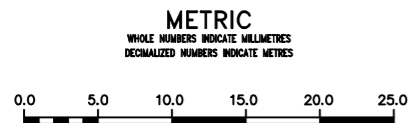

WARNING
 IF POWER EQUIPMENT OR EXPLOSIVES ARE TO BE USED FOR EXCAVATION ON THIS PROJECT THE CONTRACTOR MUST:
 1) NOTIFY THE GAS COMPANY OF THE PROPOSED LOCATION OF EXCAVATION.
 2) TAKE PRECAUTION TO AVOID DAMAGE TO GAS COMPANY INSTALLATIONS.
 SEE PROVINCIAL REGULATION 210/72 FOR DETAILS

LOCATION APPROVED UNDERGROUND STRUCTURES
 SUPV. U/G STRUCTURES COMMITTEE DATE
 NOTE:
 LOCATION OF UNDERGROUND STRUCTURES AS SHOWN ARE BASED ON THE BEST INFORMATION AVAILABLE BUT NO GUARANTEE IS GIVEN THAT ALL EXISTING UTILITIES ARE SHOWN OR THAT THE GIVEN LOCATIONS ARE EXACT. CONFIRMATION OF EXISTENCE AND EXACT LOCATION OF ALL SERVICES MUST BE OBTAINED FROM THE INDIVIDUAL UTILITIES BEFORE PROCEEDING WITH CONSTRUCTION.

NO.	REVISIONS	DATE	BY

DESIGNED BY	NC	CHECKED BY	SC
DRAWN BY	CJH	APPROVED BY	KZ
SCALE:	RELEASED FOR CONSTRUCTION		
HORIZONTAL	1:250		
VERTICAL	1:50		
DATE	2012 10 26	DATE	
PLOT DATE:	2012 10 26		

ENGINEER'S SEAL
ORIGINAL SIGNED BY
 S.R.J. COUNROYER
 12-10-26
 CONSULTANT DRAWING NUMBER

THE CITY OF WINNIPEG
 WATER AND WASTE DEPARTMENT
 ENGINEERING DIVISION
 2012 SEWER RENEWALS & REPAIRS
HARVARD AVENUE
 MH AT GUELPH STREET TO 1ST MH E OF GUELPH STREET
 SHEET 19 OF 21
 CITY DRAWING NUMBER 10430