

ONE-TOP CHORD SECTION 2A^R ONE-TOP CHORD SECTION 2B^R
 ONE- 10 2A^L (LEFT) ONE- do 2B^L (LEFT)

- MATERIAL LIST.**
- GA 264 x 3/8 R = 9.8
 - gb 20 x 3/8 R = 2.14
 - gc 182 x 3/8 R = 2.92
 - gd 18 x 3/8 R = 3.78
 - ga1 84 x 3/8 R = 3.82
 - gc1 242 x 3/8 R = 5.52
 - ga1 36 x 3/8 FILL = 1.5
 - fa 678 x 3/8 FILL = 76
 - ma 7 x 9 x 3/8 TEE = 76 (CUT 16 WFS)
 - pa 18 x 1/2 R (RE) = 38.58
 - pb 17 x 1/2 R (RE) = 17.02
 - pc 17 x 1/2 R (RE) = 17.42
 - pd 18 x 1/2 R (RE) = 38.02
 - pf 17 x 1/2 R (RE) = 17.18
 - Da 10 x 1/2 R (RE) = 2.92
 - Db1 10 x 1/2 R (RE) = 3.02
 - Dc 34 x 2 BAR = 1.14
 - Dc1 34 x 2 BAR = 1.11

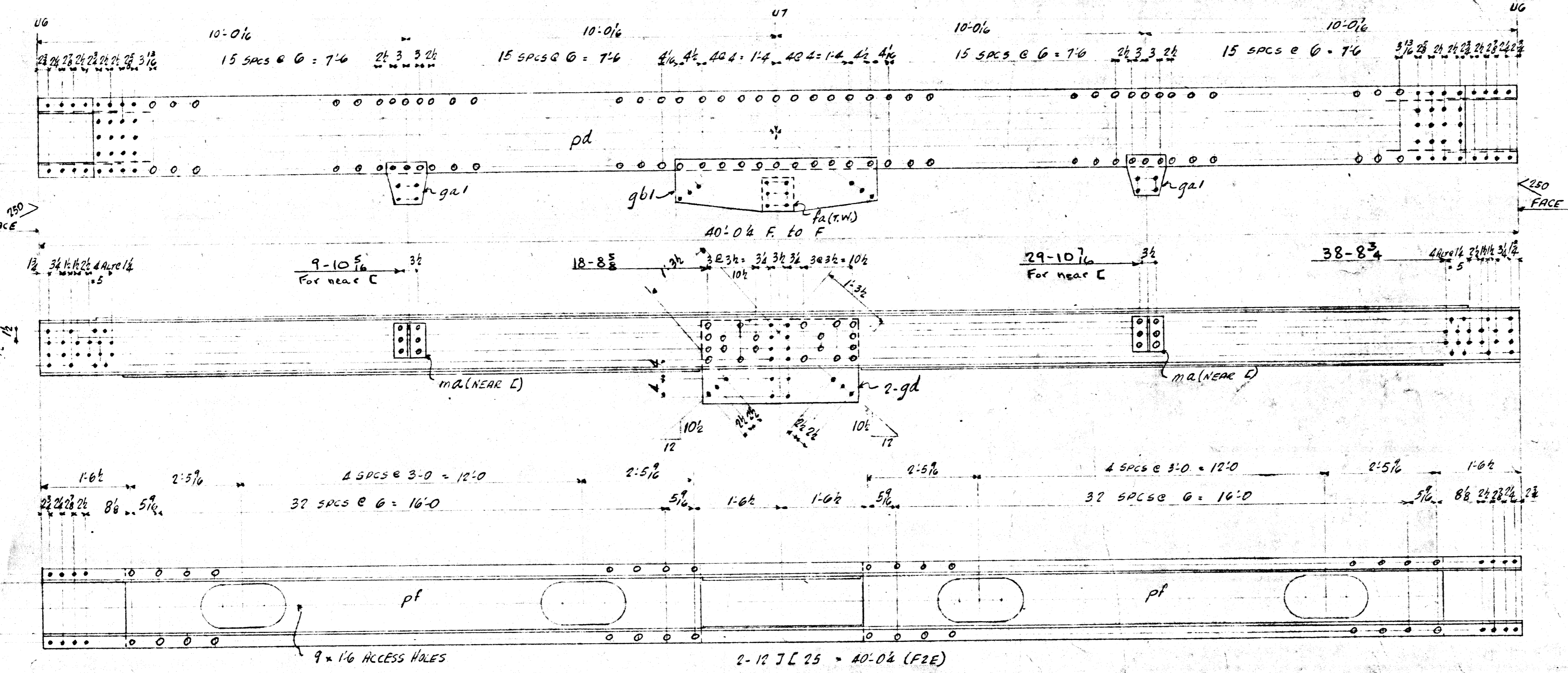

2-TOP CHORD SECTIONS 2C

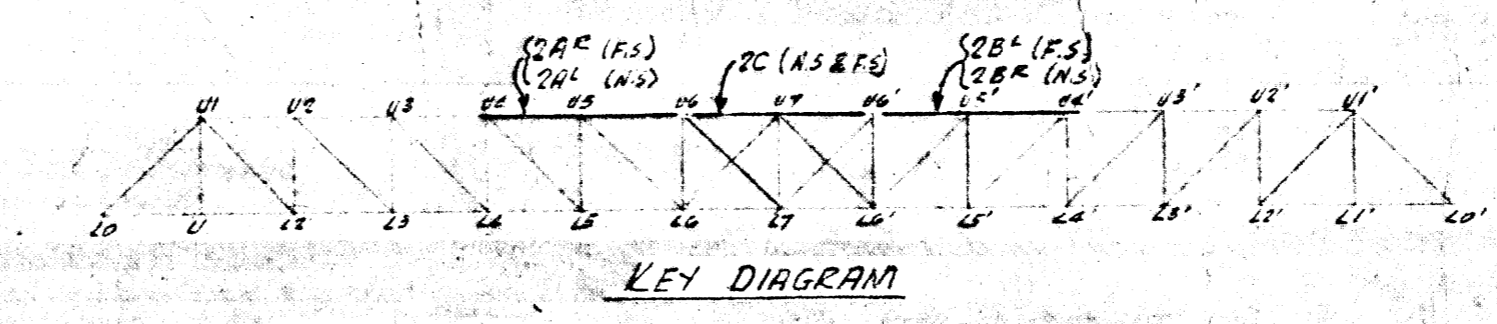

BC 4505-15
 Microfilm 1965

RIVETS: 2
 OPEN HOLES: 12
 FOR GENERAL NOTES SEE DRAWG #1

DOMINION BRIDGE CO., LIMITED LACHINE, QUE.	
DESCRIPTION	WATER PIPE BRIDGE HUNKEY STREET, WINNIPEG
DETAIL	TOP CHORD SECTION U6-U9 (15)
PROPRIETOR	CITY OF WINNIPEG
PURCHASER	DB CO WINNIPEG
DRAWN	MAY 11 58
CHECKED	D. GAVIN MAY 12 58
APPROVED	
SCALE	= 1 FOOT
DEPT.	GAVIN
CONT.	W6217

REVISION NO.	DATE	REVISION	MADE BY
A	MAY 23	Running Dim's added	HMD