

1 WEST ENTRANCE PLAN VIEW
C-202 1:250

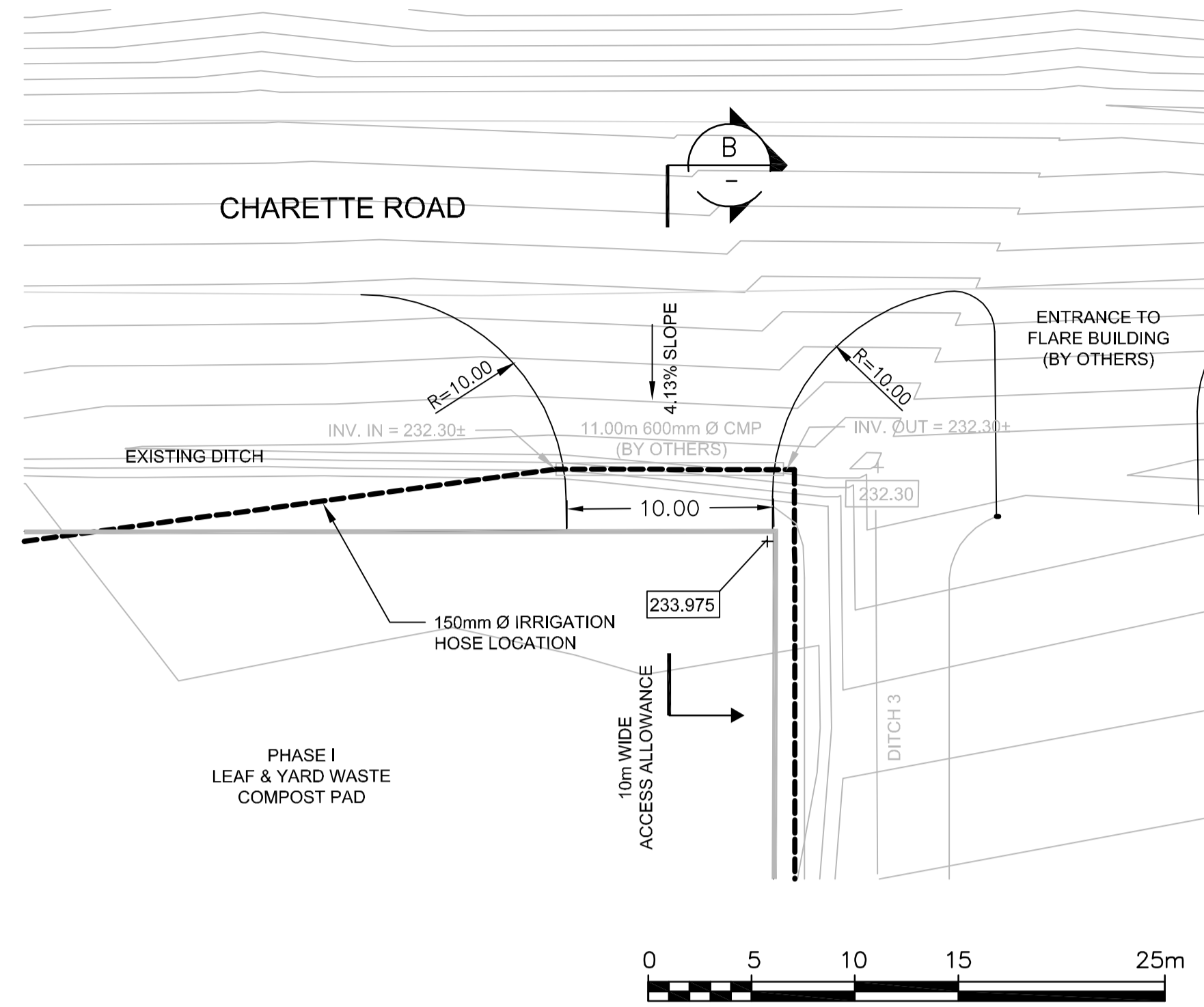

2 EAST ENTRANCE PLAN VIEW
C-202 1:250

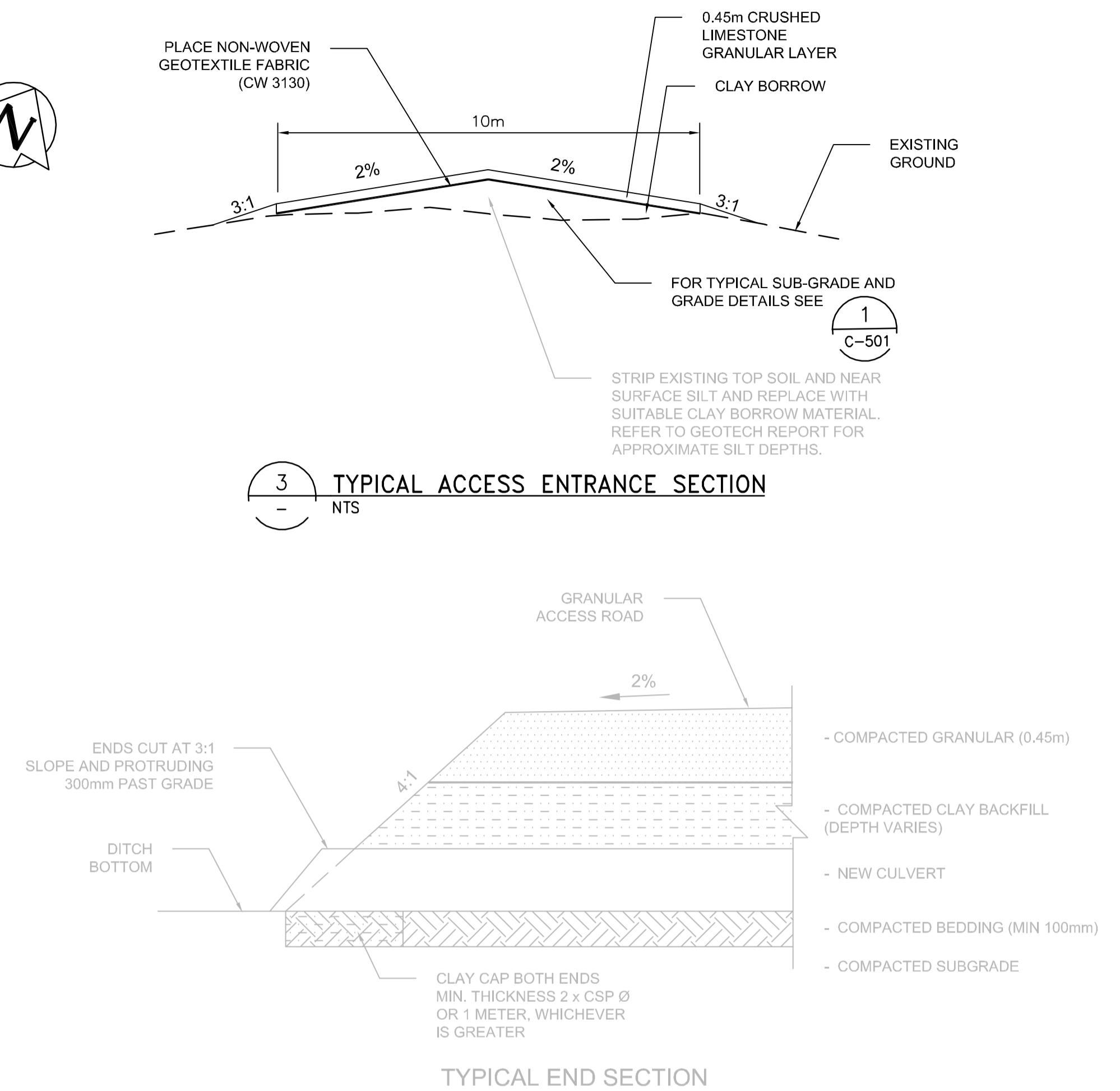

3 TYPICAL ACCESS ENTRANCE SECTION
NTS

TYPICAL END SECTION

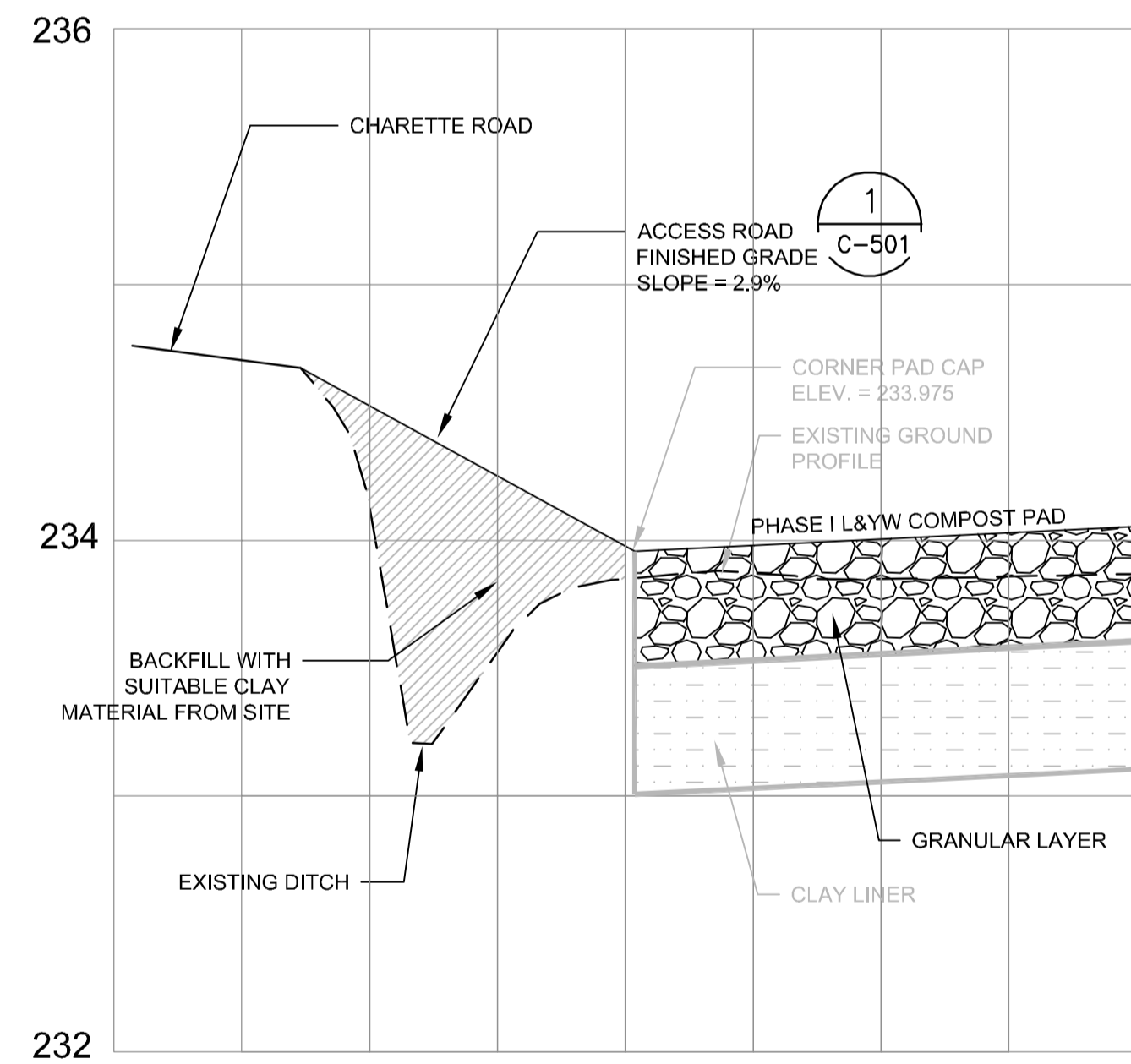

A WEST ENTRANCE SECTION
H: 1:250 V: 1:25

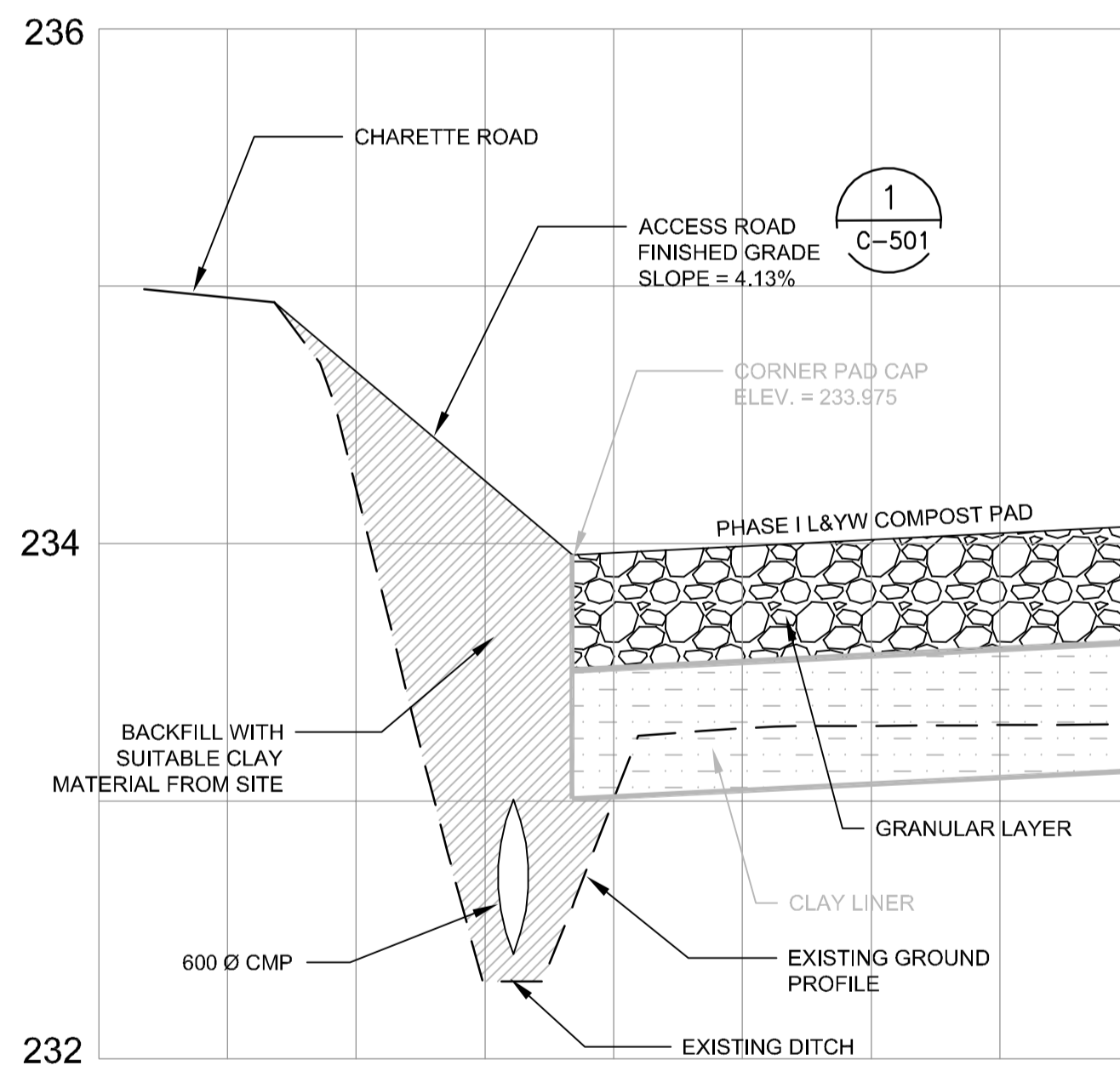

B EAST ENTRANCE SECTION
H: 1:250 V: 1:25

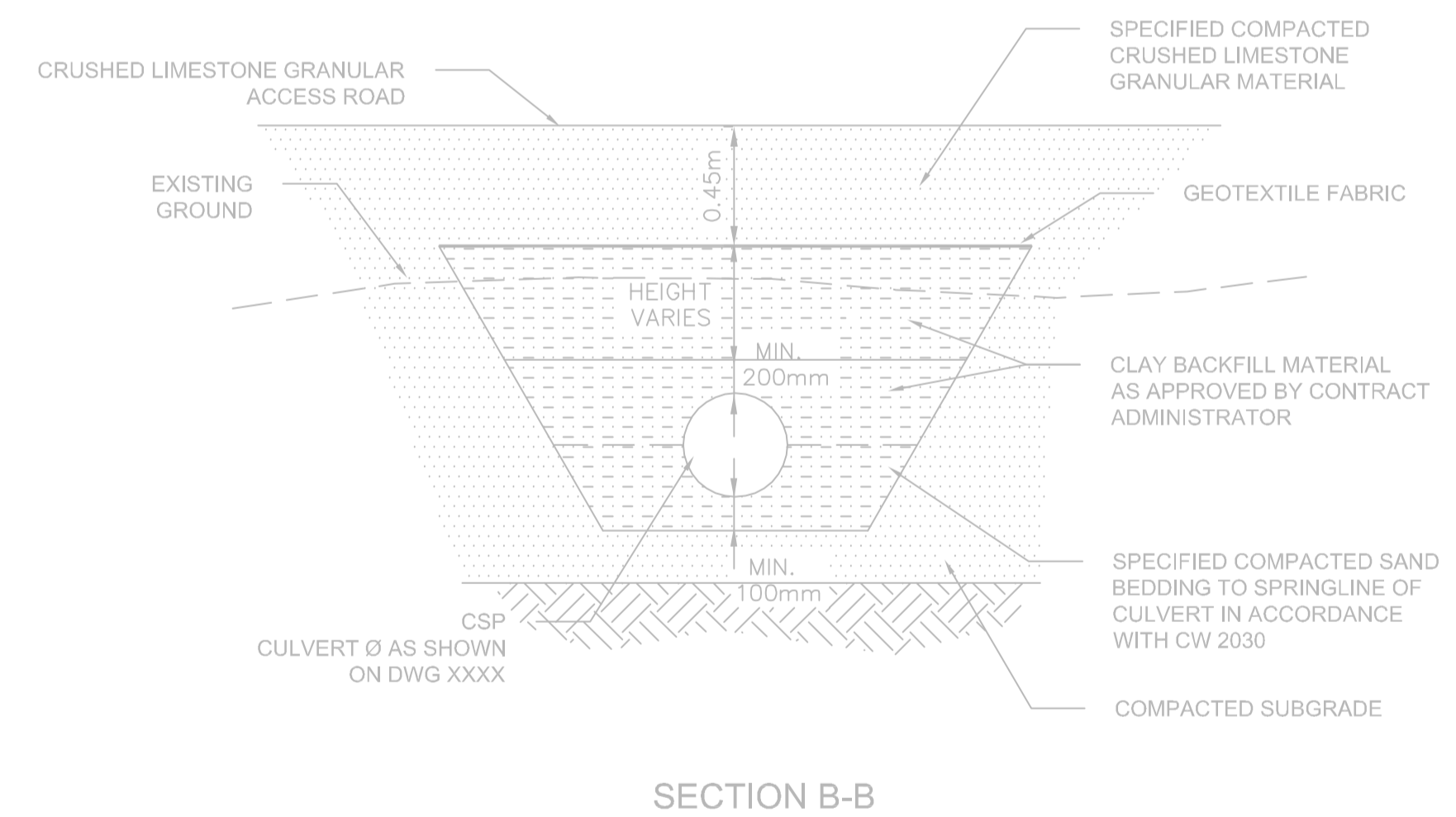

- NOTES:
1. MATCH CULVERT INVERT TO BOTTOM OF DITCH.
 2. INSTALLATION OF CULVERT IN ACCORDANCE WITH CW 3610.

4 TYPICAL CULVERT DETAILS
NTS



B.M. ELEV.			
CONSTRUCTION COMPLETION DATE: YYYY MM DD			
DESIGNED BY	DES	CHECKED BY	CHK
DRAWN BY	DWN	APPROVED BY	APP
SCALE:		RELEASED FOR CONSTRUCTION	
HORIZONTAL	1:250	DATE	
VERTICAL	1:25	DATE	
0	ISSUED FOR CONSTRUCTION	13/01/25	GMH
NO.	REVISIONS	DATE	BY
		2013 01 25	
PLOT DATE: 2013 02 07			

CH2MHILL

DESIGNED BY: DES
CHECKED BY: CHK
DRAWN BY: DWN
APPROVED BY: APP
SCALE: HORIZONTAL 1:250, VERTICAL 1:25
RELEASED FOR CONSTRUCTION DATE: 2013 01 25

ENGINEER'S SEAL
PROVINCE OF MANITOBA
WILLIAMSON
Member
REGISTERED PROFESSIONAL ENGINEER
CONSULTANT DRAWING NUMBER
C-305

THE CITY OF WINNIPEG
WATER AND WASTE DEPARTMENT
ENGINEERING DIVISION
Winnipeg
BRADY ROAD RESOURCE MANAGEMENT FACILITY
LEAF AND YARD WASTE AND PILOT BIOSOLIDS COMPOSTING
CIVIL
ENTRANCE PLAN, SECTION & DETAILS

SHEET 14 OF 45
CITY DRAWING NUMBER
1-0400B-C0010-001-00