

HOUSE WATER SERVICE INFORMATION				
ADDRESS & NATURE OF SERVICE	SIZE (mm) & TYPE	SHORT & LONG MEASUREMENT	CORP LOCATION	REMARKS
155 WELLINGTON CRES	150 UNKNOWN			COMBINED DOMESTIC SUPPLY & FIRE PROTECTION
221 WELLINGTON CRES	100 UNKNOWN			COMBINED DOMESTIC SUPPLY & FIRE PROTECTION

CHAINAGE ALONG SOUTH OF WELLINGTON CRESCENT

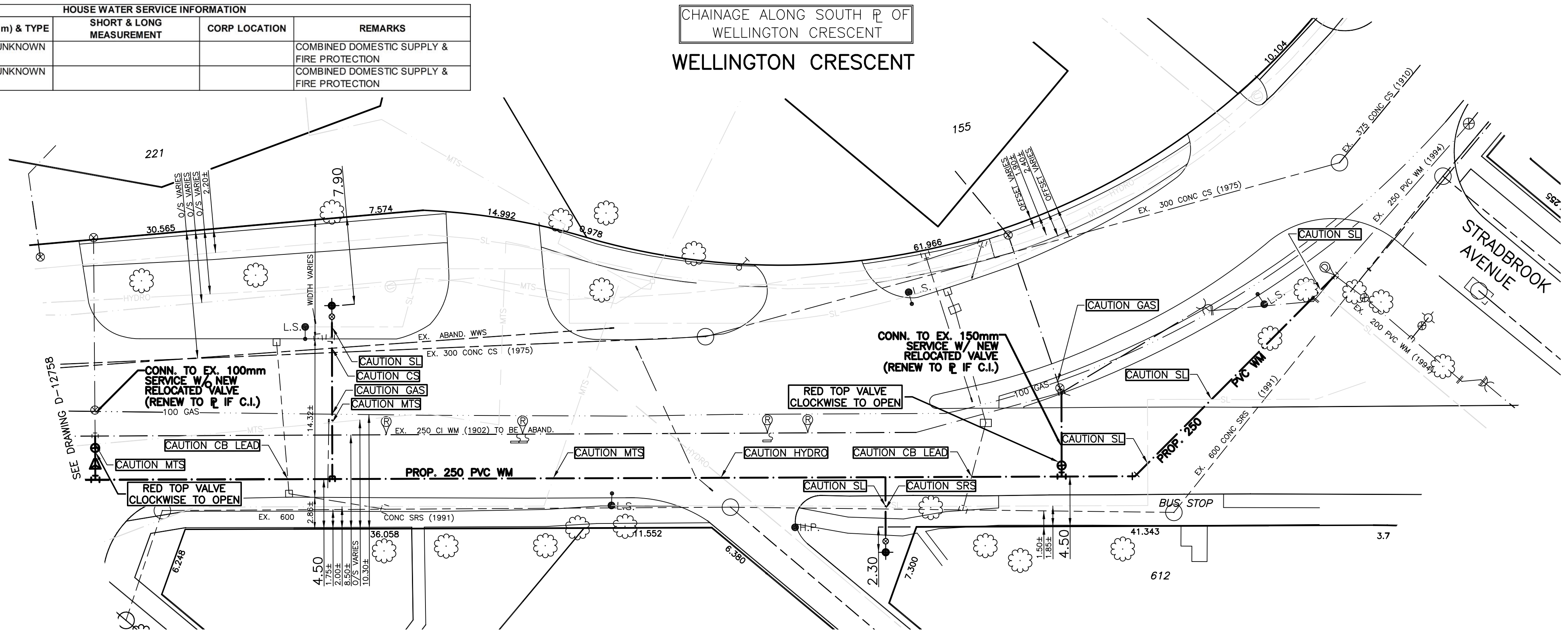

- NOTES:**
1. ALL GATE VALVES ARE CLOCKWISE TO OPEN WITH A RED OPERATING NUT UNLESS NOTED OTHERWISE.
 2. WATERMAIN TO BE INSTALLED BY TRENCHLESS METHODS.
 3. BACKFILL IS CLASS 5 WITHIN BOULEVARD AND CLASS 3 WHEN WITHIN 1.0m OF PAVEMENT OR SIDEWALK.
 4. WATER SERVICES ARE 19mm UNLESS OTHERWISE NOTED.
 5. MINIMUM COVER TO TOP OF WATERMAIN SHALL BE 2.4m.
 6. LOCATION OF ALL SERVICES TO BE CONFIRMED IN FIELD.
 7. EXPOSE EXISTING WATERMAIN TO CONFIRM DEPTH PRIOR TO CONSTRUCTION.
 8. ALL LEAD AND CAST IRON SERVICES TO BE RENEWED TO PROPERTY LINE.
 9. SERVICES TO BE RENEWED SHALL BE REPLACED FROM WATERMAIN TO PROPERTY LINE. ALL OTHERS TO BE RECONNECTED.



"Description of property limits, and existing and/or proposed features relative to these limits as shown on this drawing do not represent a Legal Survey. GENVAR makes no representation or guarantee that the property limit information is accurate. GENVAR accepts no responsibility for damages, if any, suffered by any third party as a result of decisions made or actions based on this drawing."

METRIC
WHOLE NUMBERS INDICATE MILLIMETRES
DECIMALIZED NUMBERS INDICATE METRES

EXISTING	LEGEND - PLAN	PROPOSED	EXISTING	LEGEND - PLAN	PROPOSED	EXISTING	LEGEND - PROFILE	PROPOSED
	WATERMAIN			HYDRANT			VALVE	
	CURB STOP			WASTE WATER SEWER			LAND DRAINAGE SEWER	
	C.B. LEAD			MANHOLE			CATCH BASIN	
	TEE			BEND			ANODE	
	REDUCER			PLUG			TREE	
	LAMP STANDARD			GAS			HYDRO	
	M.T.S.			TRAFFIC SIGNAL			CONCRETE/ASPHALT	
	SIDEWALK			CENTERLINE				

LOCATION APPROVED UNDERGROUND STRUCTURES

SUPV. U/G STRUCTURES DATE COMMITTEE

NOTE:
LOCATION OF UNDERGROUND STRUCTURES AS SHOWN ARE BASED ON THE BEST INFORMATION AVAILABLE BUT NO GUARANTEE IS GIVEN THAT ALL EXISTING UTILITIES ARE SHOWN OR THAT THE GIVEN LOCATIONS ARE EXACT. CONFIRMATION OF EXISTENCE AND EXACT LOCATION OF ALL SERVICES MUST BE OBTAINED FROM THE INDIVIDUAL UTILITIES BEFORE PROCEEDING WITH CONSTRUCTION.

NO.	REVISIONS	DATE	BY
3	BID OPPORTUNITY 90-2012	MAR/12	P.R.
2	REVISED DESIGN	MAR/12	P.R.
1	ISSUED FOR REVIEW	FEB/12	P.R.

GENVAR
10 PRAIRIE WAY WINNIPEG, MANITOBA R2J 3J8
PH: (204)-233-2113 FAX: (204)-233-2080

DESIGNED BY: P.R.
CHECKED BY: R.H.
DRAWN BY: P.R.
APPROVED BY: I.McK.
HOR. SCALE: 1:250
VERT. SCALE: 1:50
DATE: MARCH 2012

RELEASED FOR CONSTRUCTION
ORIGINALLY SIGNED BY
S. COURNOYER P. ENG
DATE: MARCH 15, 2012



THE CITY OF WINNIPEG
WATER AND WASTE DEPARTMENT

2012 CAPITAL WORKS
WATERMAIN RENEWALS
WELLINGTON CRESCENT

WARDLAW AVENUE
TO STRADBROOK AVENUE

SHEET 3 OF 3
CITY DRAWING NO. D-12759