

LANSDOWNE AVENUE

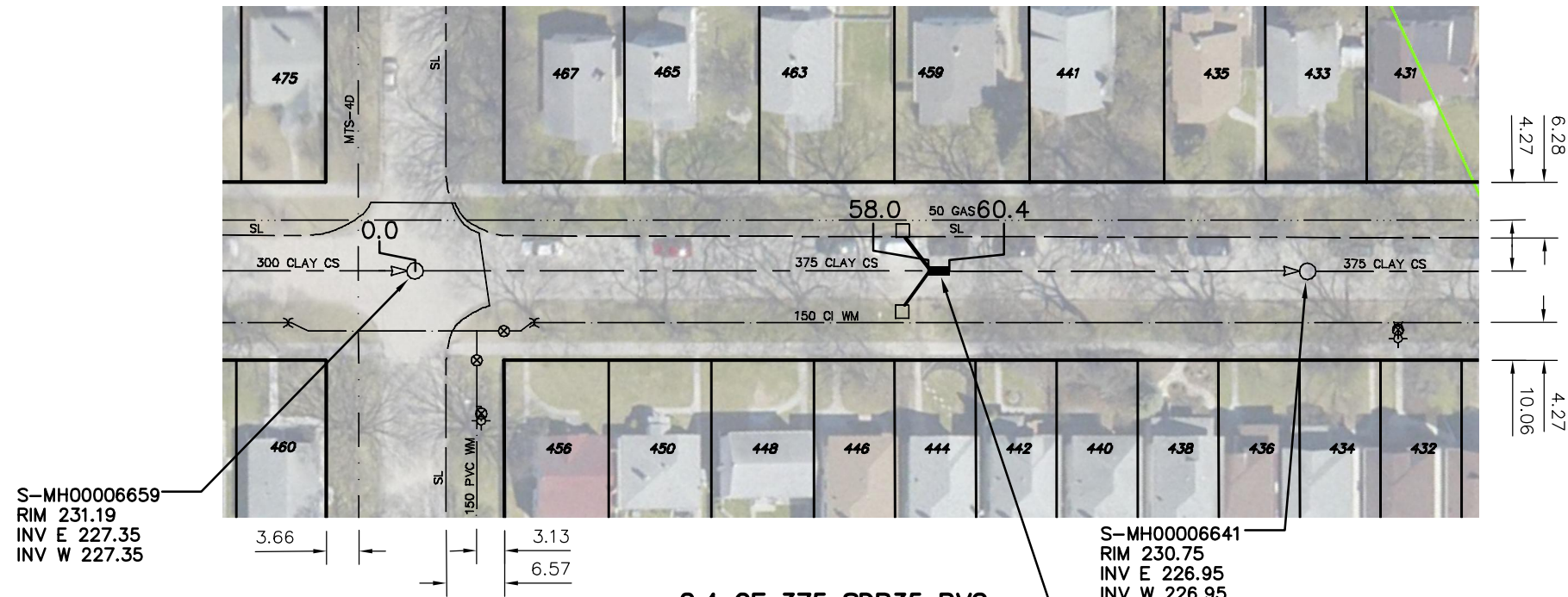
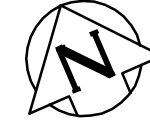

SEWER JUNCTION INFORMATION FROM SEWER VIDEO INSPECTION		
SEWER ID S-MA00010129		
DISTANCE FROM MH ID S-MH00006659		
DISTANCE	DIAMETER	CLOCK
12.0	150	1
17.1	150	2
23.3	150	10
26.7	150	2
31.0	150	10
44.8	150	2
46.3	150	10
53.4	150	2
54.6	250	10
58.4	250	2
58.8	150	10
61.5	150	10
72.5	150	2
76.8	150	10
81.1	150	2
92.1	150	10
98.2	150	2

**2.4 OF 375 SDR35 PVC SEWER REPAIR (SD-022A)
REPLACE 9.0 OF 250 SDR35 PVC CATCH BASIN LEAD.**

WARNING

IF POWER EQUIPMENT OR EXPLOSIVES ARE TO BE USED FOR EXCAVATION ON THIS PROJECT THE CONTRACTOR MUST:

- 1) NOTIFY THE GAS COMPANY OF THE PROPOSED LOCATION OF EXCAVATION.
- 2) TAKE PRECAUTION TO AVOID DAMAGE TO GAS COMPANY INSTALLATIONS.

SEE PROVINCIAL REGULATION 210/72 FOR DETAILS

ANDREWS ST

METRIC

WHOLE NUMBERS INDICATE MILLIMETRES
DECIMALIZED NUMBERS INDICATE METRES

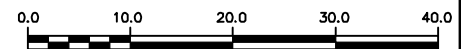

LOCATION APPROVED
UNDERGROUND STRUCTURES

SUPV. U/G STRUCTURES COMMITTEE DATE

NOTE:

LOCATION OF UNDERGROUND STRUCTURES AS SHOWN ARE BASED ON THE BEST INFORMATION AVAILABLE BUT NO GUARANTEE IS GIVEN THAT ALL EXISTING UTILITIES ARE SHOWN OR THAT THE GIVEN LOCATIONS ARE EXACT. CONFIRMATION OF EXISTENCE AND EXACT LOCATION OF ALL SERVICES MUST BE OBTAINED FROM THE INDIVIDUAL UTILITIES BEFORE PROCEEDING WITH CONSTRUCTION.

B.M. ELEV.	
CONSTRUCTION COMPLETION DATE: YYYY MM DD	
DESIGNED BY	TS
CHECKED BY	SC
DRAWN BY	MA
APPROVED BY	KZ
SCALE:	
HORIZONTAL	1:750
VERTICAL	
RELEASED FOR CONSTRUCTION	
CONSULTANT DRAWING NUMBER	-
NO.	REVISIONS
DATE	BY
DATE	2014 01 03
DATE	

PLOT DATE: 2014 01 03

ENGINEER'S SEAL

ORIGINAL
SIGNED BY
S.R.J.
COURNOYER
14-01-06

CONSULTANT DRAWING NUMBER

BID OPPORTUNITY: 1066-2013
CONTRACT NUMBER: 14



THE CITY OF WINNIPEG
WATER AND WASTE DEPARTMENT
ENGINEERING DIVISION

2013 SEWER RENEWALS AND REPAIRS

SHEET 18 OF 32

CITY DRAWING NUMBER

LANSDOWNE AVENUE
MH AT ANDREWS STREET TO
1ST MH E OF ANDREWS STREET

10709

FILE PATH: R:\DRAWINGS\SEWER\2013_RENEWALS\EPR's and Renewals\Contract #14\CONSTRUCTION DRAWINGS\
FILE NAME: LANSDOWNE.dwg