

NOTE: CHAINAGES SHOWN ARE ALONG N. R. OF BELMONT AVE.

CAUTION:  
GAS ON N SIDE OF  
BELMONT AVE

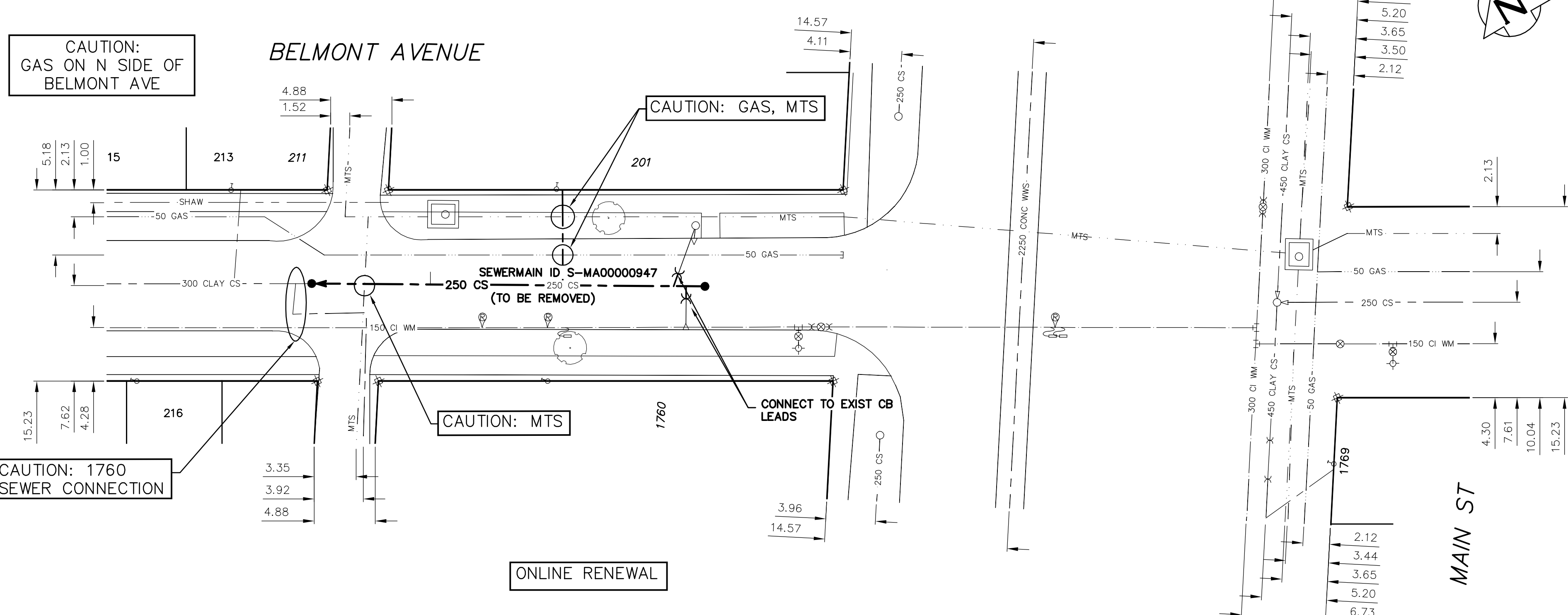

SEWER SERVICE INFORMATION				
ADDRESS	SIZE (mm)	R. DIST	JUNCTION TIE	REMARKS
201 BELMONT AVE	-	14.09	E OF WL	RENEW TO R. W/150 PVC
COMMERCIAL	-	11.35	W 1ST MH W OF MAIN	SHARED W/#213
211 BELMONT AVE	-	4.37	E OF WL	SHARED W/#213
RESIDENTIAL	-	48.8	WW MAIN ST	-
213 BELMONT AVE	-	4.37	E OF WL	SHARED W/#211
RESIDENTIAL	-	5.93	W 2ND MH W OF MAIN	-
1760 MAIN ST	150	8.09	S OF NL	SERVED FROM BACK LANE
RESIDENTIAL	CONC	2.02	W 2ND MH W OF MAIN	-

SEWER JUNCTION INFORMATION FROM SEWER VIDEO INSPECTION		
SEWER ID S-MA00000947		
DISTANCE FROM MH ID S-MH00000826	DIAMETER	CLOCK
1.5	150	4
2.5	150	9
21.9	150	3

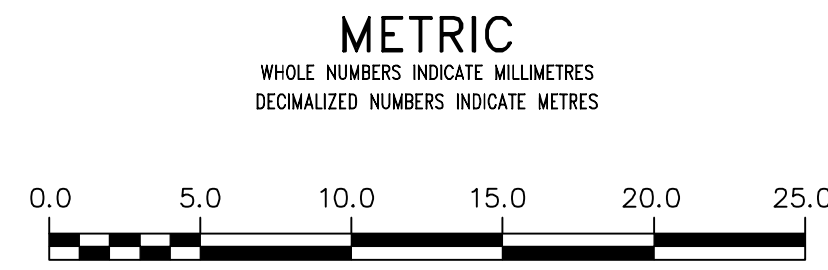

**WARNING**  
IF POWER EQUIPMENT OR EXPLOSIVES ARE TO BE USED FOR EXCAVATION ON THIS PROJECT THE CONTRACTOR MUST:  
1) NOTIFY THE GAS COMPANY OF THE PROPOSED LOCATION OF EXCAVATION.  
2) TAKE PRECAUTION TO AVOID DAMAGE TO GAS COMPANY INSTALLATIONS.  
SEE PROVINCIAL REGULATION 210/72 FOR DETAILS

LOCATION APPROVED UNDERGROUND STRUCTURES  
SUPV. U/G STRUCTURES COMMITTEE DATE  
NOTE:  
LOCATION OF UNDERGROUND STRUCTURES AS SHOWN ARE BASED ON THE BEST INFORMATION AVAILABLE BUT NO GUARANTEE IS GIVEN THAT ALL EXISTING UTILITIES ARE SHOWN OR THAT THE GIVEN LOCATIONS ARE EXACT. CONFIRMATION OF EXISTENCE AND EXACT LOCATION OF ALL SERVICES MUST BE OBTAINED FROM THE INDIVIDUAL UTILITIES BEFORE PROCEEDING WITH CONSTRUCTION.

B.M. ELEV.	
CONSTRUCTION COMPLETION DATE: YYYY MM DD	
DESIGNED BY	MK
CHECKED BY	SC
DRAWN BY	RS
APPROVED BY	KZ
SCALE:	
HORIZONTAL	1:250
VERTICAL	1:50
DATE	2014 01 02
RELEASED FOR CONSTRUCTION	
DATE	
NO.	REVISIONS
DATE	BY
PLOT DATE: 2014 01 03	

ENGINEER'S SEAL  
ORIGINAL SIGNED BY  
S.R.J. COURNOYER  
14-01-06  
CONSULTANT DRAWING NUMBER

THE CITY OF WINNIPEG  
WATER AND WASTE DEPARTMENT  
ENGINEERING DIVISION  
2013 SEWER RENEWALS AND REPAIRS  
SHEET 31 OF 32  
CITY DRAWING NUMBER  
10728

BELMONT AVENUE  
1ST MH W OF MAIN STREET TO  
2ND MH W OF MAIN STREET