

- CONSTRUCTION NOTES:**
- EACH CATCH BASIN (CB) AND CATCH PIT (CP) INSTALLED IN PAVEMENT TO HAVE AP-011 FRAME AND COVER.
 - EACH DITCH INLET CATCH BASIN TO HAVE A DITCH INLET GRATE AS PER DETAIL SHEET 45.
 - CONTRACTOR TO EXPOSE AND VERIFY INVERTS OF ALL JUNCTIONS OR CONNECTIONS TO MAINLINE LDS PRIOR TO INSTALLATION OF CATCH BASINS.
 - CLASS 3 BACKFILL TO BE USED WITHIN 1.0m OF PAVEMENT FOR ALL UNDERGROUND INSTALLATIONS.
 - EXISTING MANHOLES AND CATCH BASINS TO BE ADJUSTED TO DESIGN ELEVATION.
 - INSTALL 200mm PLAIN DOWELLED CONCRETE TRANSITION SLABS C/W ASPHALT OVERLAY WHERE ASPHALT PAVEMENT MATCHES CONCRETE PAVEMENT.
 - ADD 200.00 M TO ABBREVIATED ELEVATION TO OBTAIN GEODETIC ELEVATION.

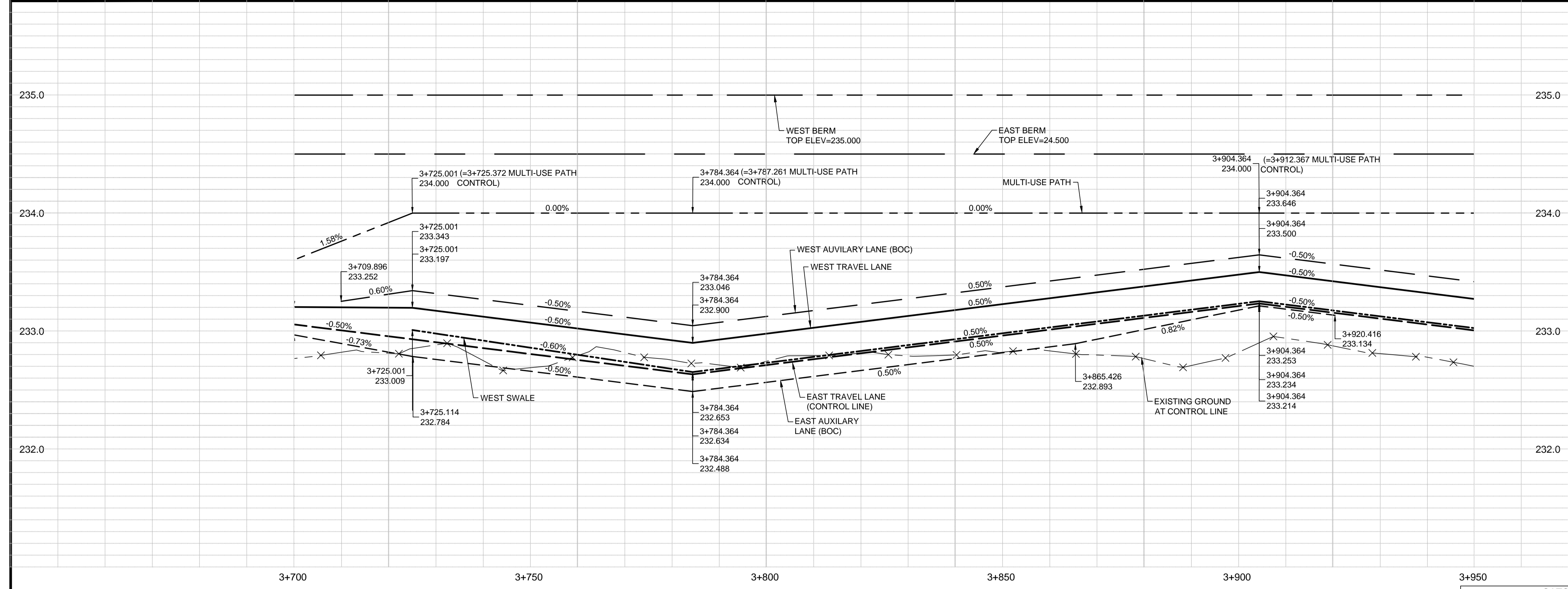

KENASTON BOULEVARD SOUTHBOUND

CATCH BASIN, CATCH PIT, DITCH INLET & MANHOLES STRUCTURE AND LOCATION SCHEDULE

TYPE	STATION	O/S FROM CONTROL	RIM ELEV	BOT. ELEV	LEAD INV	MAIN INV	PIPE LEAD
CB 10	3+784.330	14.655 L	232.653	230.403	E 231.003	-	56.0m - 300mm/GR=5.28%
CB 11	3+784.364	4.050 R	232.488	230.238	E 230.838	229.829	6.0m - 300mm/GR=16.66%
CP 4	3+782.364	4.050 R	232.498	231.598	N 231.598	-	2.0m - 250mm
CP 5	3+786.364	4.050 R	232.498	231.598	S 231.598	-	2.0m - 250mm

CP - SD-023, AP-011
DITCH CB - SD-025, DITCH INLET GRATE

ROAD CB - SD-024, AP-011
MH - SD-010, AP-004, AP-005

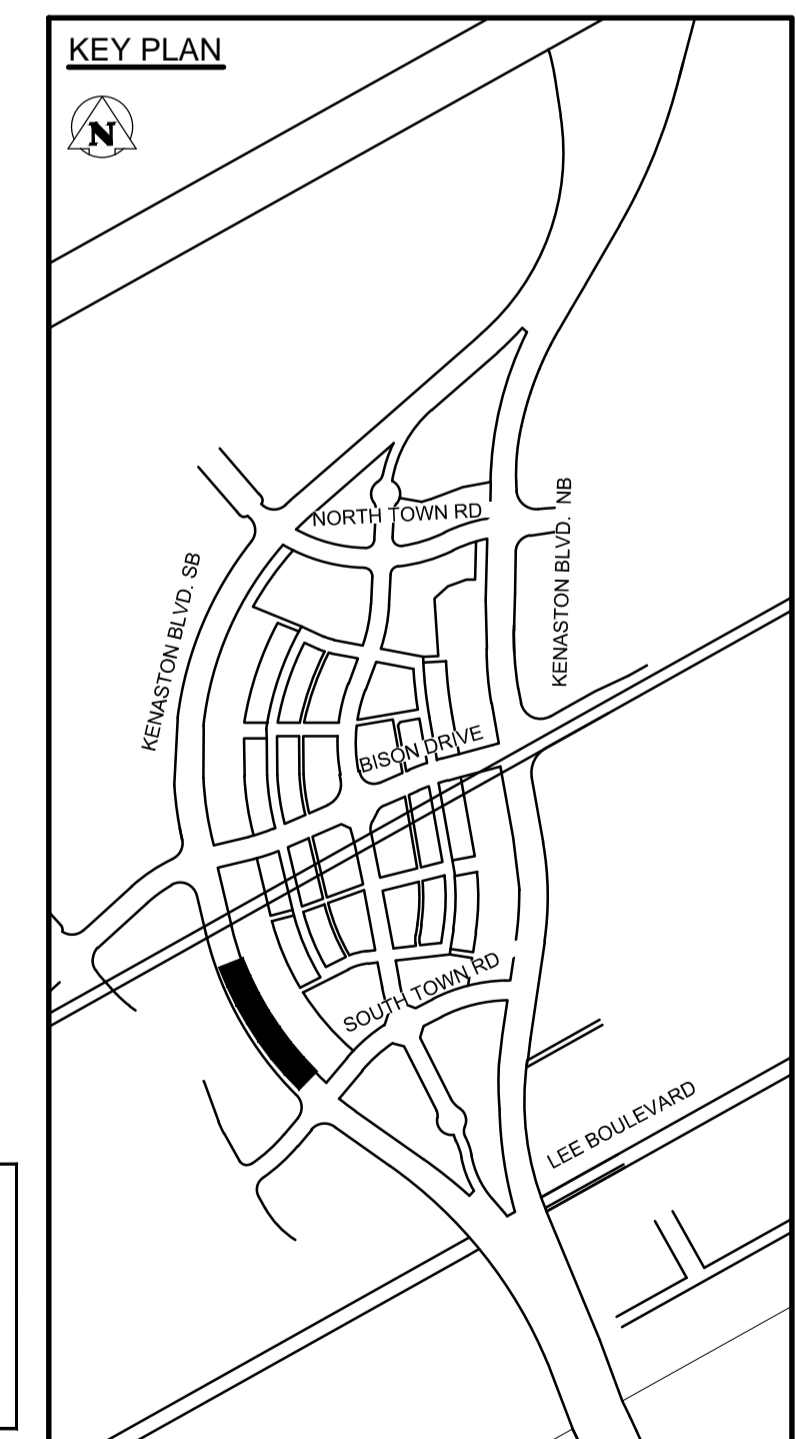
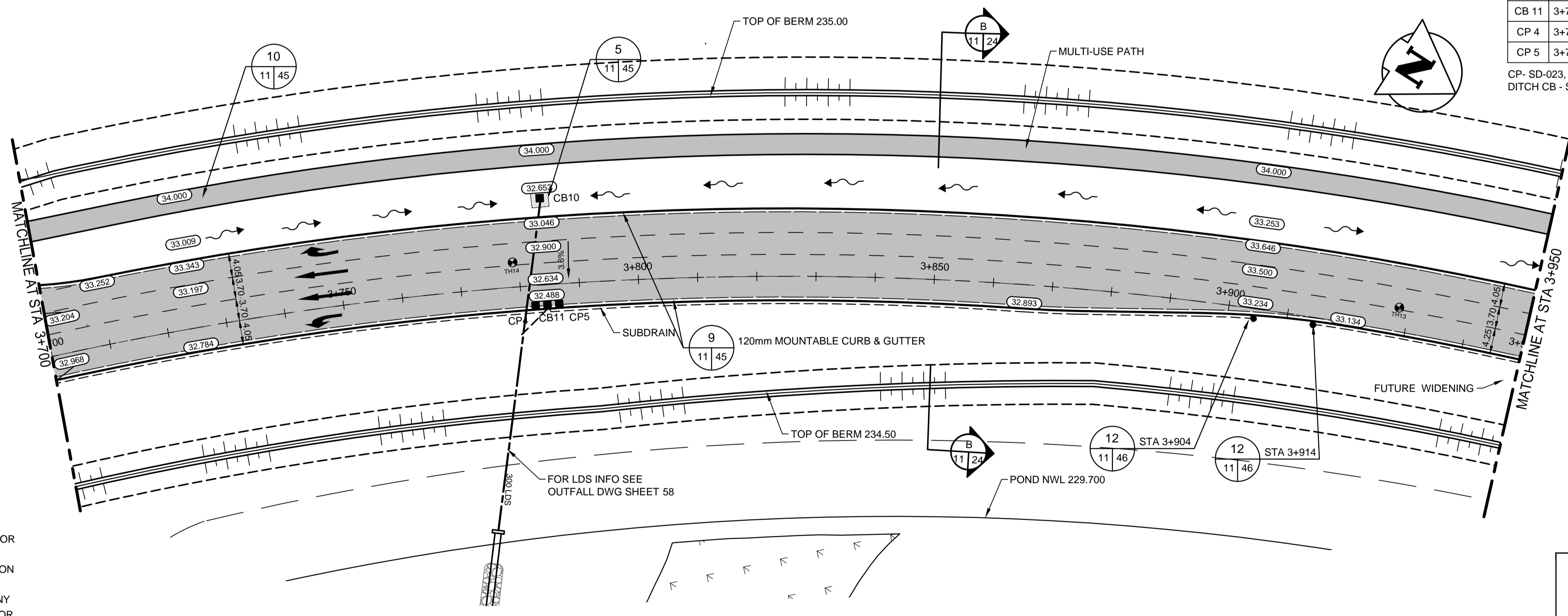

METRIC

WHOLE NUMBERS INDICATE MILLIMETRES
DECIMALIZED NUMBERS INDICATE METRES

WARNING

- IF POWER EQUIPMENT OR EXPLOSIVES ARE TO BE USED FOR EXCAVATION ON THIS PROJECT THE CONTRACTOR MUST:
- NOTIFY THE GAS COMPANY OF THE PROPOSED LOCATION OF EXCAVATION.
 - TAKE PRECAUTION TO AVOID DAMAGE TO GAS COMPANY INSTALLATIONS SEE PROVINCIAL REGULATION 210/72 FOR DETAILS.
 - OBTAIN EXCAVATION PERMITS PRIOR TO CONSTRUCTION.

84R635 - Lake Crest Rd. & Waverley St. Tblt top on top of 0.05m dia. x 2.4m iron pipe, 14.2m N. of S.L. of Lake Crest Rd. & 0.6m E. of E.L. of Waverley St.



150 W.M.	WATERMAIN	150 W.M.	M.T.S.	M.T.S.	150 mm W.M.	WATERMAIN	150 mm W.M.
+	HYDRANT VALVE	+			+	HYDRANT VALVE	+
300 LDS	LAND DRAINAGE SEWER	300 LDS			300 mm L.D.S.	LAND DRAINAGE SEWER	300 mm L.D.S.
250 WWS	WASTE WATER SEWER	250 WWS			250 mm W.W.S.	WASTE WATER SEWER	250 mm W.W.S.
○	MANHOLE	●			○	NORTH/WEST GUTTER	---
□	CATCH BASIN	■			○	SOUTH/EAST GUTTER	---
⊕	TEST HOLES	⊕			○	NORTH/WEST T/LANE	---
○	CULVERT	○			○	SOUTH/EAST T/LANE	---
100 GAS	GAS	100 GAS			○		
HYDRO	HYDRO	HYDRO			○		
EXISTING	LEGEND-PLAN	PROPOSED	EXISTING	LEGEND-PLAN	PROPOSED	EXISTING	LEGEND-PROFILE

UNDERGROUND STRUCTURES

SUPV. U/G STRUCTURES COMMITTEE DATE

NOTE:
LOCATION OF UNDERGROUND STRUCTURES AS SHOWN ARE BASED ON THE BEST INFORMATION AVAILABLE. BUT NO GUARANTEE IS GIVEN THAT ALL EXISTING UTILITIES ARE SHOWN OR THAT THE GIVEN LOCATIONS ARE EXACT. CONFIRMATION OF EXISTENCE AND EXACT LOCATION OF ALL SERVICES MUST BE OBTAINED FROM THE INDIVIDUAL UTILITIES BEFORE PROCEEDING WITH CONSTRUCTION.

NO.	REVISIONS	DATE	BY	DATE
2	ISSUED FOR TENDER	3/04/08	V.M.M.	
1	ISSUED FOR REVIEW	3/03/27	V.M.M.	
0	ISSUED FOR 90% REVIEW	13/02/22	V.M.M.	

DESIGNED BY: V.M.M., T.G.
DRAWN BY: T.G.
CHECKED BY: S.B.C.
APPROVED BY: V.M.M.

DESIGN TEAM:

ENGINEER'S SEAL:

RELEASED FOR CONSTRUCTION DATE: 12/11/06

CONSULTANT PROJECT NUMBER: 113705751

THE CITY OF WINNIPEG PUBLIC WORKS DEPARTMENT

WWARP PART 3 - CONTRACT 1
STA 2+922.4 TO STA 5+935

KENASTON BOULEVARD EXTENSION - SB LANES PAVING & GRADING - KENASTON BLVD. SB
STA 3+700 TO STA 3+950

CITY DRAWING NUMBER: P-3345-11
SHEET 11 OF 64
CONSULTANT DRAWING NUMBER: C-204

VA 1137\active\113705751\drawing\404_working\sheet_files\05751c-201-xxx.dwg