

- CONSTRUCTION NOTES:**
- EACH CATCH BASIN (CB) AND CATCH PIT (CP) INSTALLED IN PAVEMENT TO HAVE AP-011 FRAME AND COVER.
  - EACH DITCH INLET CATCH BASIN TO HAVE A DITCH INLET GRATE AS PER DETAIL SHEET 45.
  - CONTRACTOR TO EXPOSE AND VERIFY INVERTS OF ALL JUNCTIONS OR CONNECTIONS TO MAINLINE LDS PRIOR TO INSTALLATION OF CATCH BASINS.
  - CLASS 3 BACKFILL TO BE USED WITHIN 1.0M OF PAVEMENT FOR ALL UNDERGROUND INSTALLATIONS.
  - EXISTING MANHOLES AND CATCH BASINS TO BE ADJUSTED TO DESIGN ELEVATION.
  - INSTALL 200mm PLAIN DOWELED CONCRETE TRANSITION SLABS C/W ASPHALT OVERLAY WHERE ASPHALT PAVEMENT MATCHES CONCRETE PAVEMENT.
  - ADD 200.00 m TO ABBREVIATED ELEVATION TO OBTAIN GEODETIC ELEVATION.

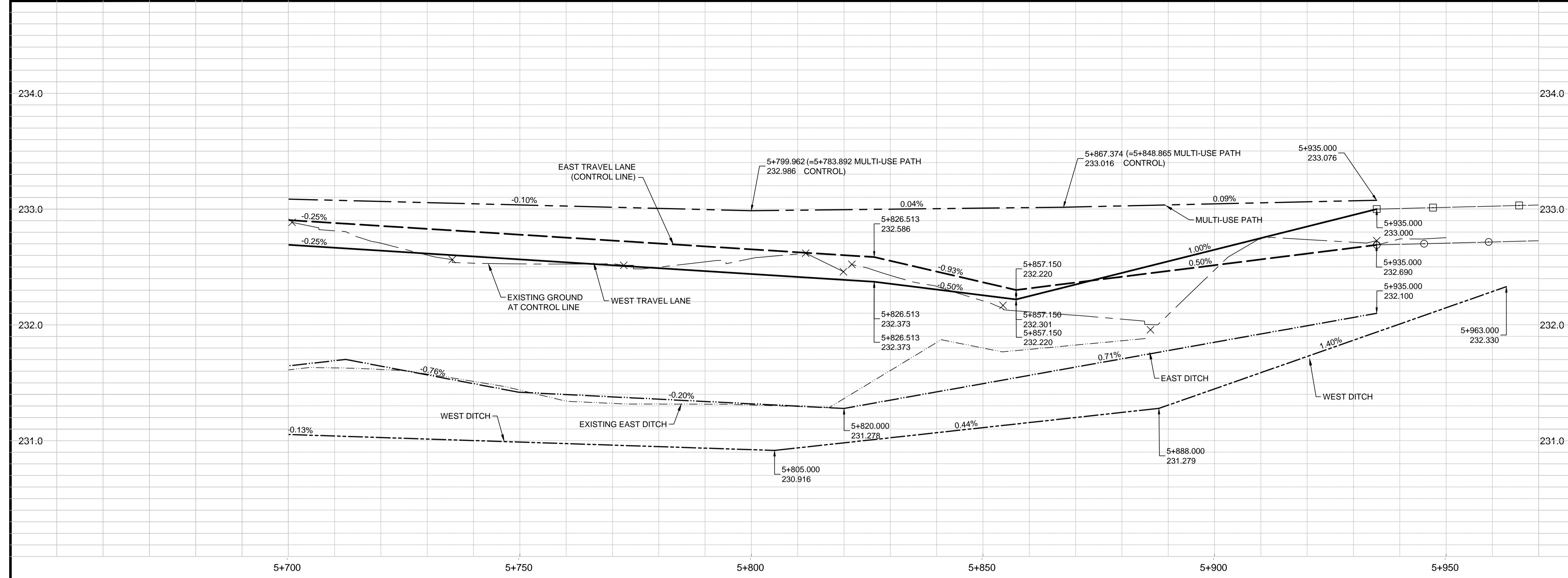

CATCH BASIN, CATCH PIT, DITCH INLET & MANHOLES STRUCTURE AND LOCATION SCHEDULE							
TYPE	STATION	O/S FROM CONTROL	RIM ELEV.	BOT. ELEV.	LEAD INV.	MAIN INV.	PIPE LEAD
CB 30	5+805.049	19.907 L	230.916	228.666	S 229.266	228.700	6.0m - 300mm/GR=9.43%
CB 31	5+806.273	75.847 L	232.500	230.250	230.850	228.700	59.0m - 300mm/GR=3.64%

CP - SD-023, AP-011  
DITCH CB - SD-025, DITCH INLET GRATE

ROAD CB - SD-024, AP-011  
MH - SD-010, AP-004, AP-005

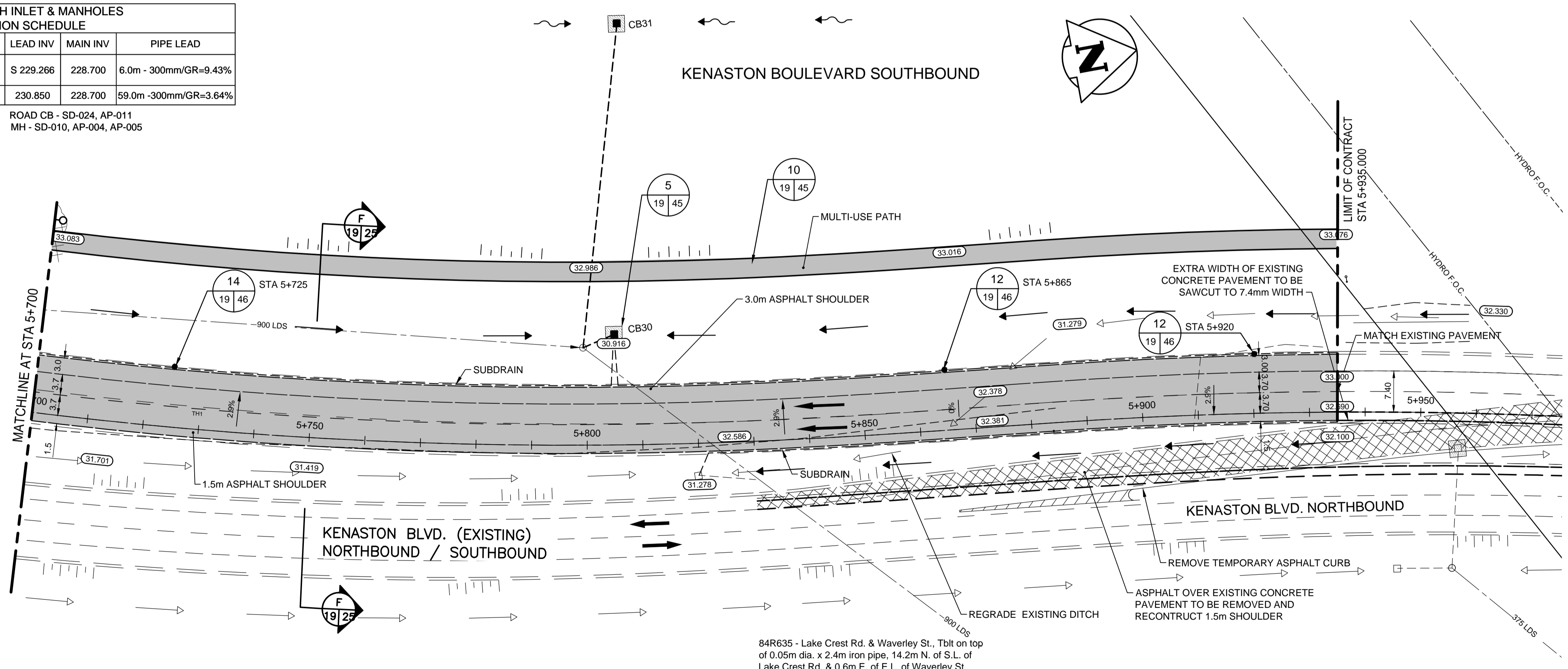

**WARNING**

IF POWER EQUIPMENT OR EXPLOSIVES ARE TO BE USED FOR EXCAVATION ON THIS PROJECT THE CONTRACTOR MUST:

- NOTIFY THE GAS COMPANY OF THE PROPOSED LOCATION OF EXCAVATION.
- TAKE PRECAUTION TO AVOID DAMAGE TO GAS COMPANY INSTALLATIONS SEE PROVINCIAL REGULATION 210/72 FOR DETAILS.
- OBTAIN EXCAVATION PERMITS PRIOR TO CONSTRUCTION.

**METRIC**

WHOLE NUMBERS INDICATE MILLIMETRES  
DECIMALIZED NUMBERS INDICATE METRES

150 W.M.	WATERMAIN	150 W.M.	M.T.S.	M.T.S.	150 mm W.M.	WATERMAIN	150 mm W.M.
⊕	HYDRANT VALVE	⊕	CONCRETE ASPHALT PLANING	⊕	300 mm L.D.S.	LAND DRAINAGE SEWER	300 mm L.D.S.
⊕	LAND DRAINAGE SEWER	⊕	CONCRETE ASPHALT PLANING	⊕	250 mm W.W.S.	WASTE WATER SEWER	250 mm W.W.S.
⊕	WASTE WATER SEWER	⊕	CONCRETE ASPHALT PLANING	⊕	300 mm L.D.S.	LAND DRAINAGE SEWER	300 mm L.D.S.
⊕	MANHOLE	⊕	CONCRETE ASPHALT PLANING	⊕	250 mm W.W.S.	WASTE WATER SEWER	250 mm W.W.S.
⊕	CATCH BASIN	⊕	CONCRETE ASPHALT PLANING	⊕	300 mm L.D.S.	LAND DRAINAGE SEWER	300 mm L.D.S.
⊕	TEST HOLES	⊕	CONCRETE ASPHALT PLANING	⊕	250 mm W.W.S.	WASTE WATER SEWER	250 mm W.W.S.
⊕	CULVERT	⊕	CONCRETE ASPHALT PLANING	⊕	300 mm L.D.S.	LAND DRAINAGE SEWER	300 mm L.D.S.
⊕	GAS	⊕	CONCRETE ASPHALT PLANING	⊕	250 mm W.W.S.	WASTE WATER SEWER	250 mm W.W.S.
⊕	HYDRO	⊕	CONCRETE ASPHALT PLANING	⊕	300 mm L.D.S.	LAND DRAINAGE SEWER	300 mm L.D.S.
⊕	HYDRO	⊕	CONCRETE ASPHALT PLANING	⊕	250 mm W.W.S.	WASTE WATER SEWER	250 mm W.W.S.
⊕	EXISTING	⊕	LEGEND-PLAN	⊕	PROPOSED	EXISTING	LEGEND-PROFILE
⊕	LEGEND-PLAN	⊕	PROPOSED	⊕	EXISTING	LEGEND-PROFILE	PROPOSED

**UNDERGROUND STRUCTURES**

SUPV. U/G STRUCTURES COMMITTEE DATE

NOTE:  
LOCATION OF UNDERGROUND STRUCTURES AS SHOWN ARE BASED ON THE BEST INFORMATION AVAILABLE. BUT NO GUARANTEE IS GIVEN THAT ALL EXISTING UTILITIES ARE SHOWN OR THAT THE GIVEN LOCATIONS ARE EXACT. CONFIRMATION OF EXISTENCE AND EXACT LOCATION OF ALL SERVICES MUST BE OBTAINED FROM THE INDIVIDUAL UTILITIES BEFORE PROCEEDING WITH CONSTRUCTION.

NO.	REVISIONS	DATE	BY
2	ISSUED FOR TENDER	3/04/08	V.M.M.
1	ISSUED FOR REVIEW	3/03/27	V.M.M.
0	ISSUED FOR 90% REVIEW	13/02/22	V.M.M.

B.M. 76-030 ELEV. 232.457m	DESIGNED BY V.M.M., T.G.	DESIGN TEAM
	DRAWN BY T.G.	
	CHECKED BY S.B.C.	
	APPROVED BY V.M.M.	
	HOR. SCALE 1:500	RELEASED FOR CONSTRUCTION
	VERTICAL 1:20	DATE

ENGINEER'S SEAL

PROVINCE OF MANITOBA REGISTERED PROFESSIONAL ENGINEER

V.M. MAROTI  
MEMBER 30809

CONSULTANT PROJECT NUMBER  
113705751

**THE CITY OF WINNIPEG PUBLIC WORKS DEPARTMENT**

WWARP PART 3 - CONTRACT 1  
STA 2+922.4 TO STA 5+935

KENASTON BOULEVARD EXTENSION - SB LANES  
PAVING & GRADING - KENASTON BLVD. SB  
STA 5+700 TO STA 5+950

CITY DRAWING NUMBER  
P-3345-19

SHEET 19 OF 64

CONSULTANT DRAWING NUMBER  
C-212

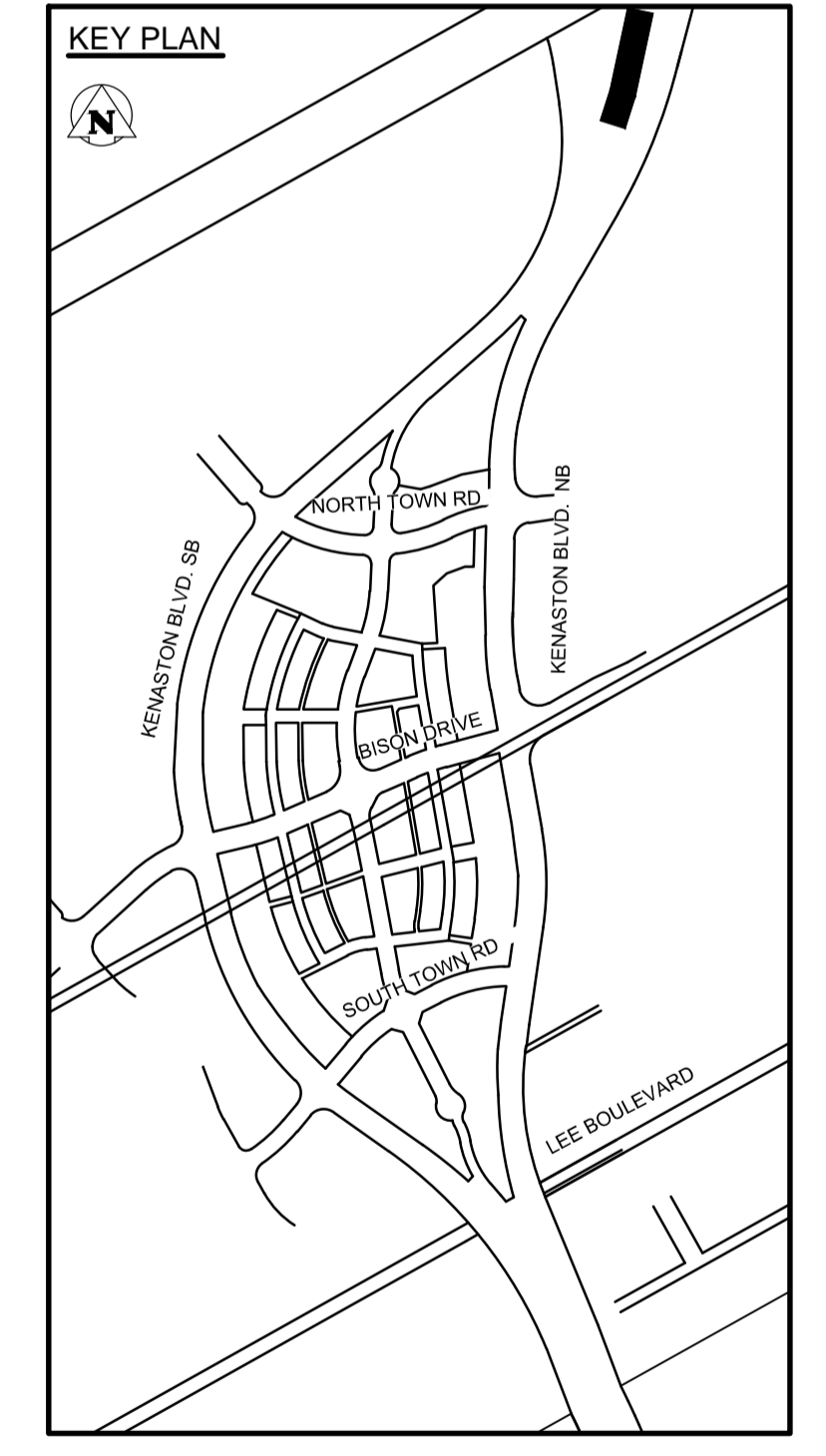

**APEGM**

Certificate of Authorization  
Stantec Consulting Ltd.  
No. 1301

VA:1137\vertical\113705751\drawing\404\_working\sheet\_files\05751c-208-xxx.dwg