

File Name: P:\Projects\2013\13-0107-001\DocControl\ToBesauser\DWG\247-2013_D-13159-Rev.0.dwg - Tab: D-13159-Rev.0.dwg - Plotted By: DDeroche 13/03/26 [Tue 11:13am]

WARNING

1. NOTIFY THE GAS COMPANY OF THE PROPOSED LOCATION OF EXCAVATION.
2. TAKE PRECAUTION TO AVOID DAMAGE TO GAS COMPANY INSTALLATIONS.
3. SEE PROVINCIAL REGULATION 140/92 FOR DETAILS.

METRIC

WHOLE NUMBERS INDICATE MILLIMETRES
DECIMALIZED NUMBERS INDICATE METRES

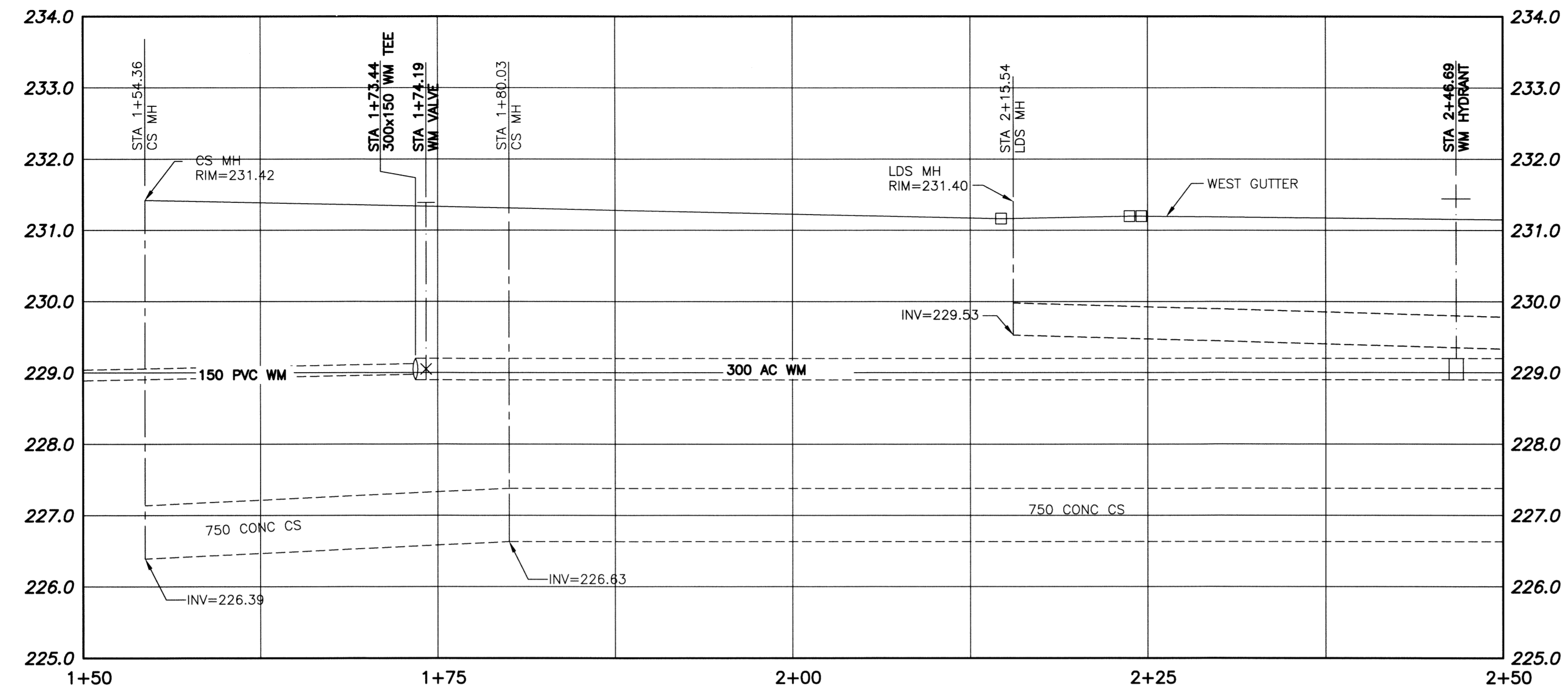

- CONSTRUCTION NOTES:**
1. EXPOSE WATERMAIN CONNECTIONS AND CONFIRM INVERTS PRIOR TO CONSTRUCTION.
 2. INSTALL WATERMAIN BY TRENCHLESS METHODS.
 3. ALL MATERIALS SHALL CONFORM TO THE CITY OF WINNIPEG STANDARD CONSTRUCTION SPECIFICATIONS.
 4. MINIMUM COVER TO TOP OF PROPOSED WATERMAIN SHALL BE 2.5m FROM STREET CENTERLINE.
 5. INSTALL ALL HYDRANTS WITH FLANGE ELEVATION 50mm TO 150mm ABOVE FINISHED GRADE.
 6. REPLACE ALL EXISTING LEAD SERVICES FROM THE PROPOSED WATERMAIN TO PROPERTY LINE.
 7. NOTIFY ALL AFFECTED RESIDENTS AND BUSINESSES 24 HOURS IN ADVANCE OF ANY WATER SHUTDOWN OR DISRUPTION OF SERVICES.
 8. LOCATION OF WATER SERVICES SHOWN ON DRAWING ARE APPROXIMATE. THE CONTRACTOR SHALL FIELD LOCATE ALL WATER SERVICES PRIOR TO CONSTRUCTION.
 9. BACKFILL UNDER OR WITHIN 1.0m OF PAVEMENTS, (INCLUDING SIDEWALKS) SHALL BE CLASS 3 BACKFILL EXCEPT AS NOTED. BACKFILL IN BOULEVARDS SHALL BE CLASS 5 BACKFILL.
 10. WATER VALVES TO BE CLOCKWISE TO CLOSE (BLACK OPERATING NUT)
 11. THE CONTRACTOR SHALL DETERMINE ON-SITE TO WHICH WATERMAIN (150 OR 300) EACH WATER SERVICE, ALONG THE ALIGNMENT OF THE 150 WATERMAIN BEING ABANDONED, IS CONNECTED. IF WATER SERVICES ARE CONNECTED TO THE 150 WATERMAIN, THE CONTRACTOR SHALL RELOCATE THE CONNECTION TO THE 300 WATERMAIN.
 12. THE CONTRACTOR SHALL REMOVE ALL VALVE BOXES AND CASINGS ALONG THE 150 AC WATERMAIN TO BE ABANDONED AND PATCH RESULTANT HOLE.

CURB STOP				CORPORATION STOP	
ADDRESS TYPE/NATURE	DISTANCE (METERS)	SIZE(mm) & TYPE	SHORT & LONG MEASUREMENT (METER)	CORPORATION LOCATION	REMARKS
246 ST ANNE'S RD RESIDENTIAL	BLDG 5.50	12 COPPER	3.60 L/R	REMARKS	NEW SEWER-CORP-13.10m S/MH (MH IN TURN LANE FROM FERMOR TO ST ANNE)
248 ST ANNE'S RD RESIDENTIAL	BLDG 5.50	12 COPPER	1.20 NSHL	4.30 N/SBL	AUG/21/02-WATER CUT OFF AT MAIN--SEWER UNABLE TO LOCATE
250 ST ANNE'S RD RESIDENTIAL		20 COPPER	3.35 NSHL		SEE PERMIT 36612

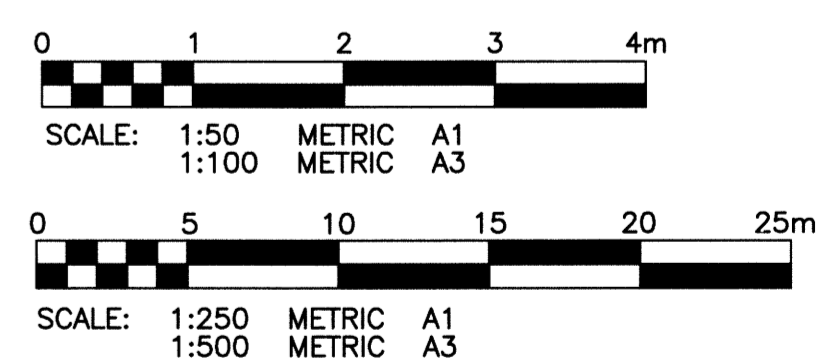
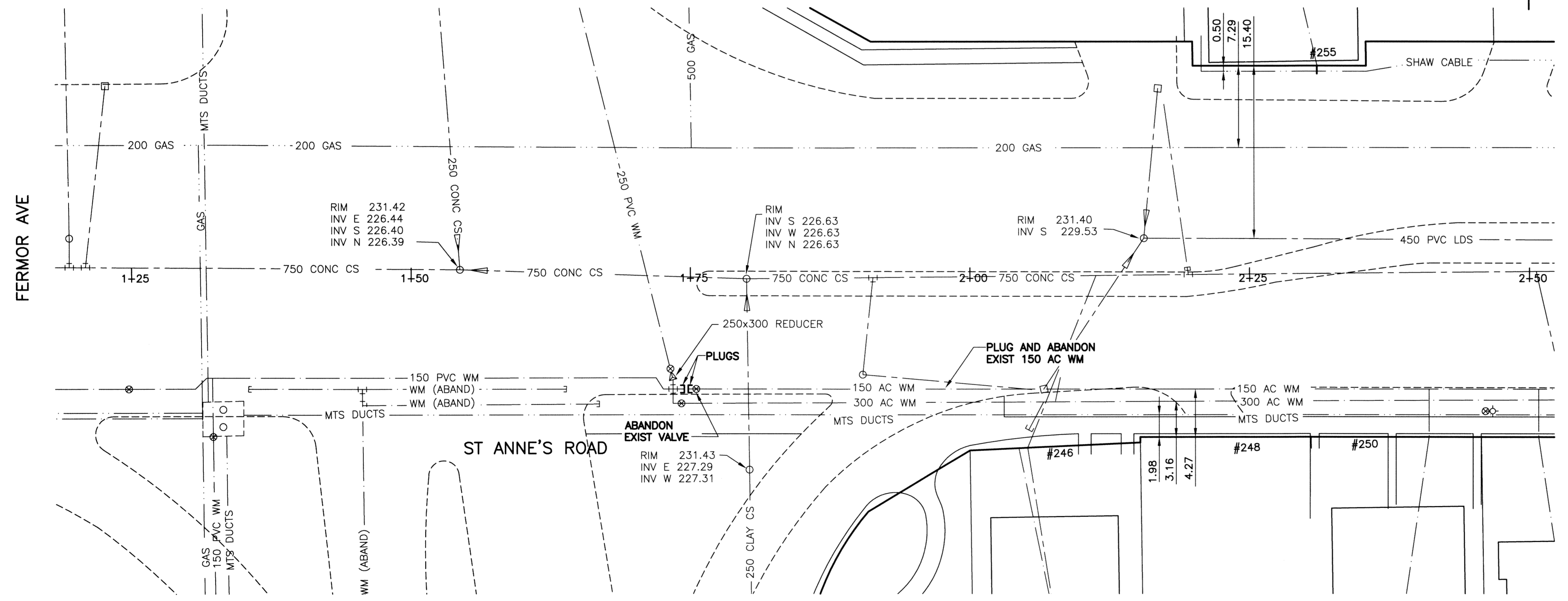
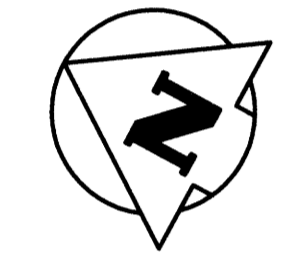

APGM
Certificate of Authorization
KGS Group
No. 245

150 WM	WATERMAIN	150 WM	HYDRO	150 WM	WATERMAIN	150 WM
⊕	HYDRANT	⊕	M.T.S.	⊕	HYDRANT, VALVE	⊕
⊙	VALVE	⊙	CONCRETE	⊙	LAND DRAINAGE SEWER	⊙
---	LAND DRAINAGE SEWER	---	ASPHALT	---	WASTE WATER SEWER	---
---	WASTE WATER SEWER	---	SIDEWALK	---	C PROFILE	---
○	MANHOLE	○	PLANING	○	NORTH/WEST GUTTER	○
□	CATCH BASIN	□	PROPERTY LINE	○	SOUTH/EAST GUTTER	○
▽	CURB INLET	▽	SURVEY BAR	◇, ○	N/W, S/E R'S	◇, ○
⌒	BEND	⌒	GAS	⌒, ○	N/W, S/E TOP/CURB	⌒, ○
⌒	REDUCER	⌒	CURB STOP	⌒		⌒
⌒	TEE	⌒	TEE	⌒		⌒
---	LEGEND-PLAN	---	LEGEND-PLAN	---	LEGEND-PROFILE	---

LOCATION APPROVED UNDERGROUND STRUCTURES

SUPV. U/G STRUCTURES DATE COMMITTEE

NOTE:
LOCATION OF UNDERGROUND STRUCTURES AS SHOWN ARE BASED ON THE BEST INFORMATION AVAILABLE BUT NO GUARANTEE IS GIVEN THAT THE GIVEN LOCATIONS ARE EXACT. CONFIRMATION OF EXISTENCE AND EXACT LOCATION OF ALL SERVICES MUST BE OBTAINED FROM THE INDIVIDUAL UTILITIES BEFORE PROCEEDING WITH CONSTRUCTION.

B.M. KGS BASE ELEV. DWGS BASE ON C.S.R.S. NAD 83 SYSTEM UTM GRID.

KGS GROUP CONSULTING ENGINEERS

DESIGNED BY: **BJM** CHECKED BY: **RBO**

DRAWN BY: **DMW** APPROVED BY:

HOR. SCALE: **1:250** VERTICAL: **1:50**

ISSUED FOR CONSTRUCTION: **13/03/26** BY: **[Signature]**

NO. REVISIONS DATE

ENGINEER'S SEAL

B.J. NIKOLAYENKO
Member 24688
REGISTERED PROFESSIONAL ENGINEER

CONSULTANT DRAWING NO. **13-0107-001**

THE CITY OF WINNIPEG
WATER AND WASTE DEPARTMENT

PROJECT TITLE: **2013 WATERMAIN RENEWALS CONTRACT 4**

ST ANNE'S ROAD
FERMOR AVE TO HAVELOCK AVE
STA 1+25 TO STA 2+50

SHEET **01** OF **07**

COMPUTER FILE NAME: **FERMOR AVE PLOT**

CITY DRAWING NUMBER: **D-13159**