

File Name: P:\Projects\2013\13-0107-001\Doc.Control\ToBeIssued\DWG\247-2013_D-13162-Rev 0.dwg - Tab: D-13162 Plotted By: DDeroche 13/03/26 [True 11:12am]

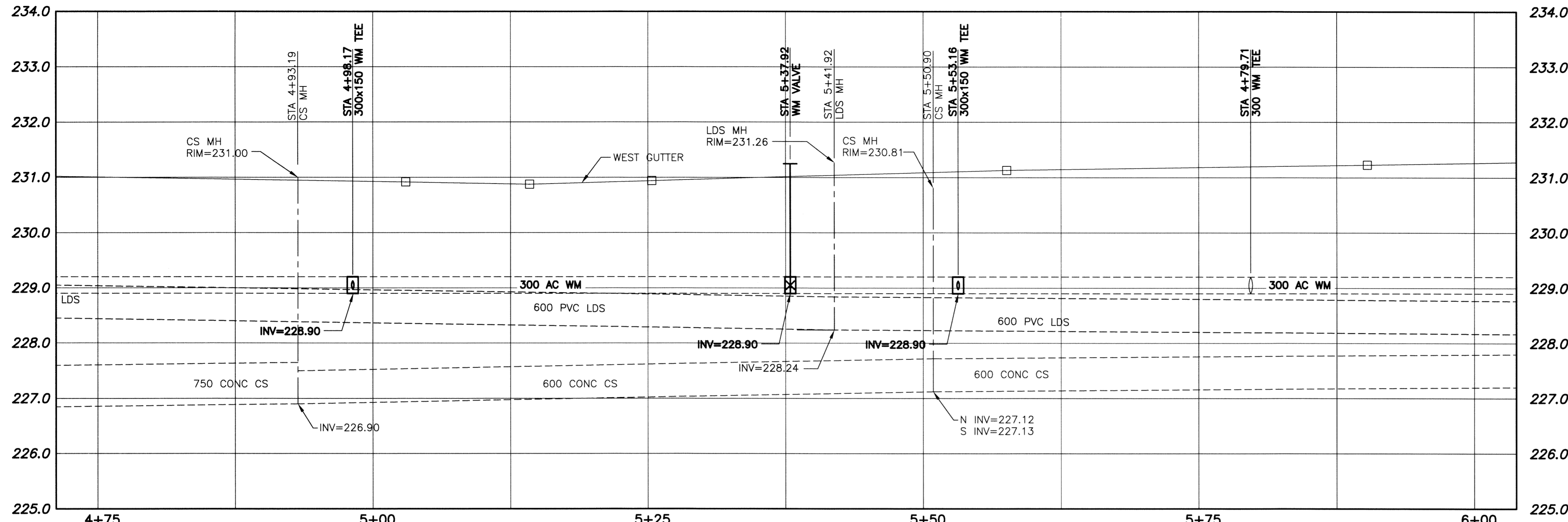

WARNING
 1. NOTIFY THE GAS COMPANY OF THE PROPOSED LOCATION OF EXCAVATION.
 2. TAKE PRECAUTION TO AVOID DAMAGE TO GAS COMPANY INSTALLATIONS.
 3. SEE PROVINCIAL REGULATION 140/92 FOR DETAILS.

METRIC
 WHOLE NUMBERS INDICATE MILLIMETRES
 DECIMALIZED NUMBERS INDICATE METRES

- CONSTRUCTION NOTES:**
- EXPOSE WATERMAIN CONNECTIONS AND CONFIRM INVERTS PRIOR TO CONSTRUCTION.
 - INSTALL WATERMAIN BY TRENCHLESS METHODS.
 - ALL MATERIALS SHALL CONFORM TO THE CITY OF WINNIPEG STANDARD CONSTRUCTION SPECIFICATIONS.
 - MINIMUM COVER TO TOP OF PROPOSED WATERMAIN SHALL BE 2.5m FROM STREET CENTERLINE.
 - INSTALL ALL HYDRANTS WITH FLANGE ELEVATION 50mm TO 150mm ABOVE FINISHED GRADE.
 - REPLACE ALL EXISTING LEAD SERVICES FROM THE PROPOSED WATERMAIN TO PROPERTY LINE.
 - NOTIFY ALL AFFECTED RESIDENTS AND BUSINESSES 24 HOURS IN ADVANCE OF ANY WATER SHUTDOWN OR DISRUPTION OF SERVICES.
 - LOCATION OF WATER SERVICES SHOWN ON DRAWING ARE APPROXIMATE. THE CONTRACTOR SHALL FIELD LOCATE ALL WATER SERVICES PRIOR TO CONSTRUCTION.
 - BACKFILL UNDER OR WITHIN 1.0m OF PAVEMENTS, (INCLUDING SIDEWALKS) SHALL BE CLASS 3 BACKFILL EXCEPT AS NOTED. BACKFILL IN BOULEVARDS SHALL BE CLASS 5 BACKFILL.
 - WATER VALVES TO BE CLOCKWISE TO CLOSE (BLACK OPERATING NUT)
 - THE CONTRACTOR SHALL DETERMINE ON-SITE TO WHICH WATERMAIN (150 OR 300) EACH WATER SERVICE, ALONG THE ALIGNMENT OF THE 150 WATERMAIN BEING ABANDONED, IS CONNECTED. IF WATER SERVICES ARE CONNECTED TO THE 150 WATERMAIN, THE CONTRACTOR SHALL RELOCATE THE CONNECTION TO THE 300 WATERMAIN.
 - THE CONTRACTOR SHALL REMOVE ALL VALVE BOXES AND CASINGS ALONG THE 150 AC WATERMAIN TO BE ABANDONED AND PATCH RESULTANT HOLE.

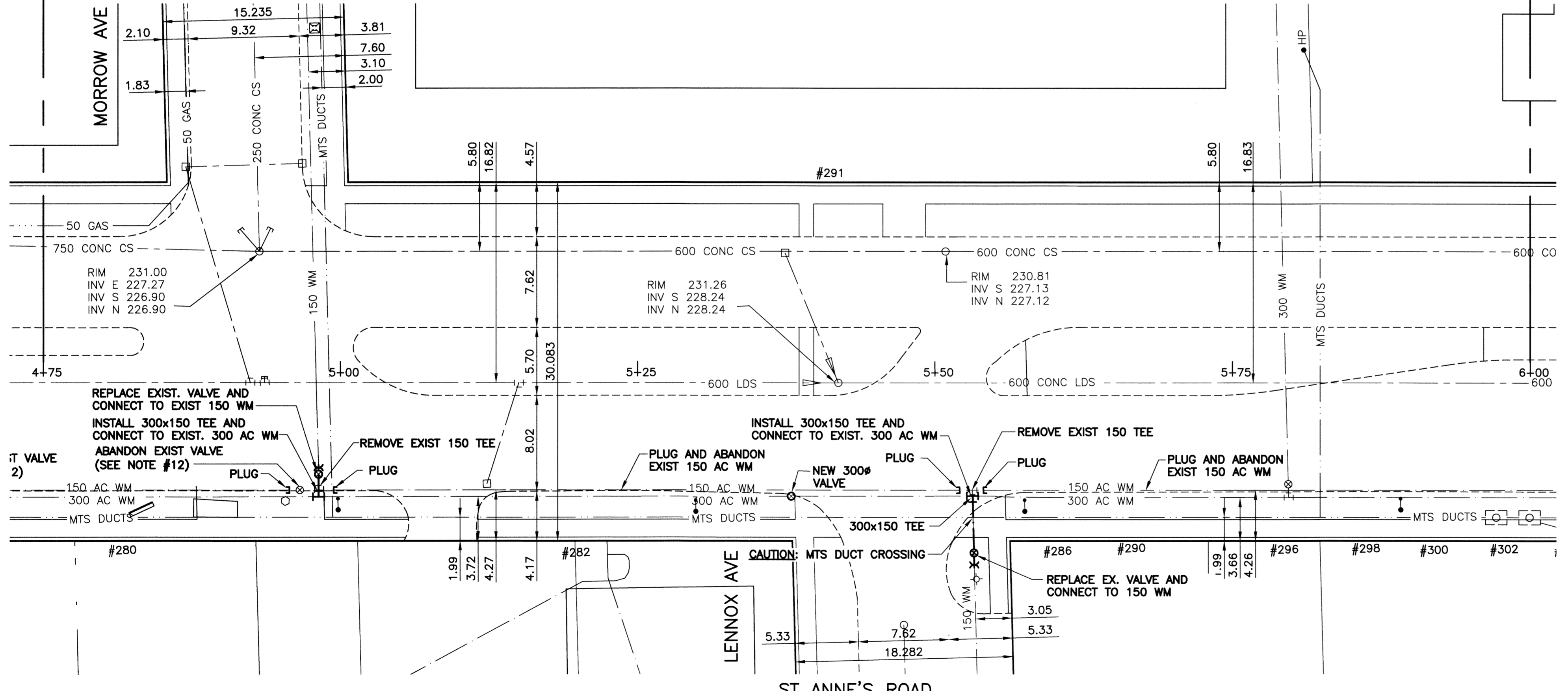
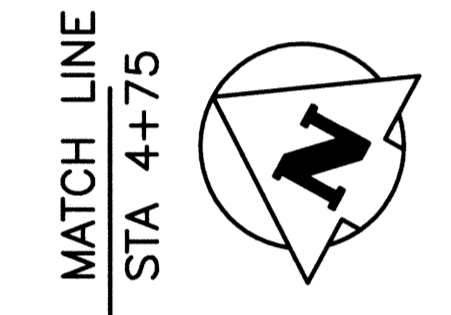

CURB STOP				CORPORATION STOP	
ADDRESS TYPE/NATURE	DISTANCE (METERS)	SIZE(mm) & TYPE	SHORT & LONG MEASUREMENT (METER)	CORPORATION LOCATION	REMARKS
280 ST ANNE'S RD COMMERCIAL		38 COPPER	3.00 SN IN SD/WK		MULT METERING W/28 2
280 ST ANNE'S RD COMMERCIAL		38 COPPER	3.00 SN IN SD/WK		DR/WY D274
280 ST ANNE'S RD COMMERCIAL		38 COPPER	3.00 SNL #282 IN SD/WK		MULT METERING
280 ST ANNE'S RD COMMERCIAL		20 COPPER			DR/WY D274
280 ST ANNE'S RD COMMERCIAL		20 COPPER			MULT METERING W/28 2
282 ST ANNE'S RD COMMERCIAL		20 COPPER	3.00 SN IN SD/WK		SEWER 200mm CONC
285 ST ANNE'S RD RESIDENTIAL			18.90 WE BLK LINE		MULT METERING M
286 ST ANNE'S RD COMMERCIAL			30.50 LR COR OF HSE		DR/WY A2646
288 ST ANNE'S RD COMMERCIAL	BLDG 13.72		35.97 FR S/CURB/L LENNOX		NORWOOD CREDIT UNION TAX-ST V-22900-08
290 ST ANNE'S RD COMMERCIAL		20	8.50 LR COR HSE		
291 ST ANNE'S RD COMMERCIAL	BLDG 0.15				
291 ST ANNE'S RD RESIDENTIAL	BLDG 5.50	50 COPPER	1.50 LL COR BLDG		TAX-STV-4-24000-08 S WR 250mm CONC INV
			13.10 NNBL WINDSOR MANOR		PL 749.22

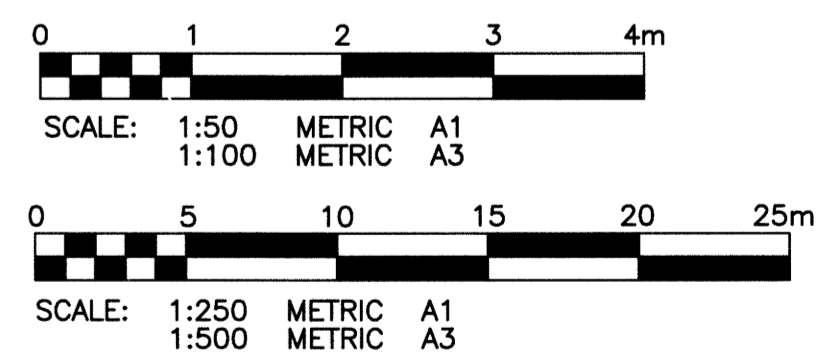

150 WM	300 AC WM	600 PVC LDS	600 CONC CS	150 WM	300 AC WM	600 PVC LDS	600 CONC CS
HYDRANT	VALVE	LAND DRAINAGE SEWER	WASTE WATER SEWER	HYDRO	M.T.S.	CONCRETE	ASPHALT
MANHOLE	CATCH BASIN	CURB INLET	BEND	REDUCER	PROPERTY LINE	SURVEY BAR	GAS
EXISTING	PROPOSED	EXISTING	PROPOSED	EXISTING	PROPOSED	EXISTING	PROPOSED

LOCATION APPROVED UNDERGROUND STRUCTURES

SUPV. U/G STRUCTURES COMMITTEE DATE

NOTE:
 LOCATION OF UNDERGROUND STRUCTURES AS SHOWN ARE BASED ON THE BEST INFORMATION AVAILABLE BUT NO GUARANTEE IS GIVEN THAT ALL EXISTING UTILITIES ARE SHOWN OR THAT THE GIVEN LOCATIONS ARE EXACT. CONFIRMATION OF EXISTENCE AND EXACT LOCATION OF ALL SERVICES MUST BE OBTAINED FROM THE INDIVIDUAL UTILITIES BEFORE PROCEEDING WITH CONSTRUCTION.

B.M. KGS BASE ELEV.	DWGS BASE ON C.S.R.S. NAD 83 SYSTEM UTM GRID.

KGS GROUP CONSULTING ENGINEERS

DESIGNED BY: **BJM**
 DRAWN BY: **DMW**
 HR. SCALE: 1:250
 VERTICAL: 1:50

CHECKED BY: **RBO**
 APPROVED BY: [Signature]
 RELEASED FOR CONSTRUCTION: [Date]

DATE: 13/01/16

ENGINEER'S SEAL

PROVINCE OF MANITOBA
B. J. NIKOLAYENKO
 Member
 24688
 M.A.S.T.E.C. / C.E.C.

THE CITY OF WINNIPEG WATER AND WASTE DEPARTMENT

PROJECT TITLE: **2013 WATERMAIN RENEWALS CONTRACT 4**

ST ANNE'S ROAD FERMOR AVE TO HAVELOCK AVE STA 4+75 TO STA 6+00

SHEET **04** OF **07**

COMPUTER FILE NAME: **FERMOR AVE PLOT**

CITY DRAWING NUMBER: **D-13162**

CONSULTANT DRAWING NO.: **13-0107-001**