

File Name: P:\Projects\2013\13-0107-001\DocControl\ToBeIssued\DWG\247-2013_D-13164-Rev.0.dwg - Tab: D-13164-Rev.0.dwg - Tab: D-13164-Rev.0.dwg [Tue 11:11am]

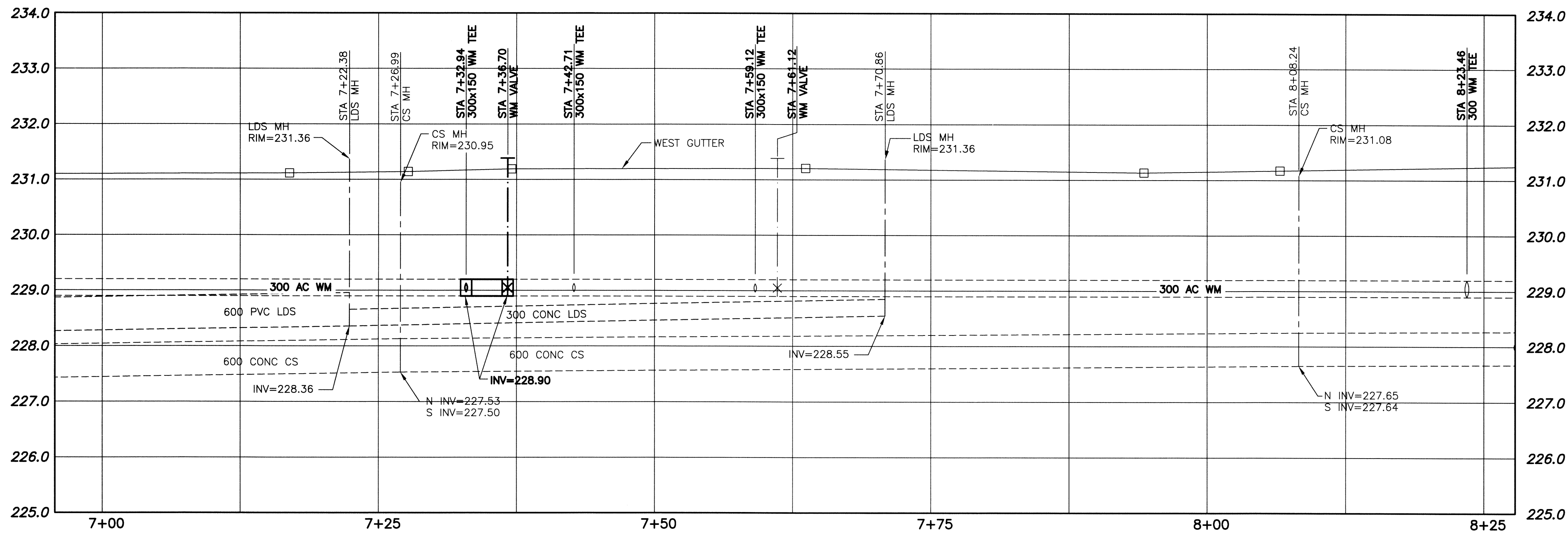

WARNING

1. NOTIFY THE GAS COMPANY OF THE PROPOSED LOCATION OF EXCAVATION.
2. TAKE PRECAUTION TO AVOID DAMAGE TO GAS COMPANY INSTALLATIONS.
3. SEE PROVINCIAL REGULATION 140/92 FOR DETAILS.

METRIC

WHOLE NUMBERS INDICATE MILLIMETRES
DECIMALIZED NUMBERS INDICATE METRES

- CONSTRUCTION NOTES:**
1. EXPOSE WATERMAIN CONNECTIONS AND CONFIRM INVERTS PRIOR TO CONSTRUCTION.
 2. INSTALL WATERMAIN BY TRENCHLESS METHODS.
 3. ALL MATERIALS SHALL CONFORM TO THE CITY OF WINNIPEG STANDARD CONSTRUCTION SPECIFICATIONS.
 4. MINIMUM COVER TO TOP OF PROPOSED WATERMAIN SHALL BE 2.5m FROM STREET CENTERLINE.
 5. INSTALL ALL HYDRANTS WITH FLANGE ELEVATION 50mm TO 150mm ABOVE FINISHED GRADE.
 6. REPLACE ALL EXISTING LEAD SERVICES FROM THE PROPOSED WATERMAIN TO PROPERTY LINE.
 7. NOTIFY ALL AFFECTED RESIDENTS AND BUSINESSES 24 HOURS IN ADVANCE OF ANY WATER SHUTDOWN OR DISRUPTION OF SERVICES.
 8. LOCATION OF WATER SERVICES SHOWN ON DRAWING ARE APPROXIMATE. THE CONTRACTOR SHALL FIELD LOCATE ALL WATER SERVICES PRIOR TO CONSTRUCTION.
 9. BACKFILL UNDER OR WITHIN 1.0m OF PAVEMENTS, (INCLUDING SIDEWALKS) SHALL BE CLASS 3 BACKFILL EXCEPT AS NOTED. BACKFILL IN BOULEVARDS SHALL BE CLASS 5 BACKFILL.
 10. WATER VALVES TO BE CLOCKWISE TO CLOSE (BLACK OPERATING NUT)
 11. THE CONTRACTOR SHALL DETERMINE ON-SITE TO WHICH WATERMAIN (150 OR 300) EACH WATER SERVICE, ALONG THE ALIGNMENT OF THE 150 WATERMAIN BEING ABANDONED, IS CONNECTED. IF WATER SERVICES ARE CONNECTED TO THE 150 WATERMAIN, THE CONTRACTOR SHALL RELOCATE THE CONNECTION TO THE 300 WATERMAIN.
 12. THE CONTRACTOR SHALL REMOVE ALL VALVE BOXES AND CASINGS ALONG THE 150 AC WATERMAIN TO BE ABANDONED AND PATCH RESULTANT HOLE.

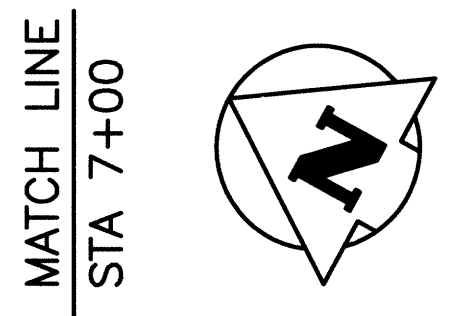

CURB STOP				CORPORATION STOP	
ADDRESS TYPE/NATURE	DISTANCE (METERS)	SIZE(mm) & TYPE	SHORT & LONG MEASUREMENT (METER)	CORPORATION LOCATION	REMARKS
315 ST ANNE'S RD COMMERCIAL		20 COPPER			TAX-ST V-24520-08. T/OFF @ STOP & WASTE. REMOVED MTR. & PLUGGED-JAN 03/95
315 ST ANNE'S RD COMMERCIAL		50 COPPER	1.20m EEBL		
317 ST ANNE'S RD COMMERCIAL		25 COPPER	1.20m E BLDG LINE		
329 ST ANNE'S RD FIRE DOMESTIC		100 CAST IRON	3.86m S S/L ASHTON	SEE REMARKS	S/C @ MAN ON W/S OF STREET-MARKED ON STREET LIGHT POLE SWR 150mm CONC REPAIR TO 100mm CI
329 ST ANNE'S RD SPRINKLER		150 PVC	4.57m S W/L ST ANNE @ MAN		
330 ST ANNE'S RD RESIDENTIAL		25 COPPER	6.0m S S P/L ASHTON	SEE REMARKS	SEWER 150mm CONC INV @ PL 748.53 SERVICE CONNECTION
340 ST ANNE'S RD COMMERCIAL		38 COPPER	0.70 EW BLDG		97/07/02-POS OF CC-6 2.40m W OF VALVE ON W/LIMIT ST ANNES ON BARTON. OFF-LINE RENEWAL

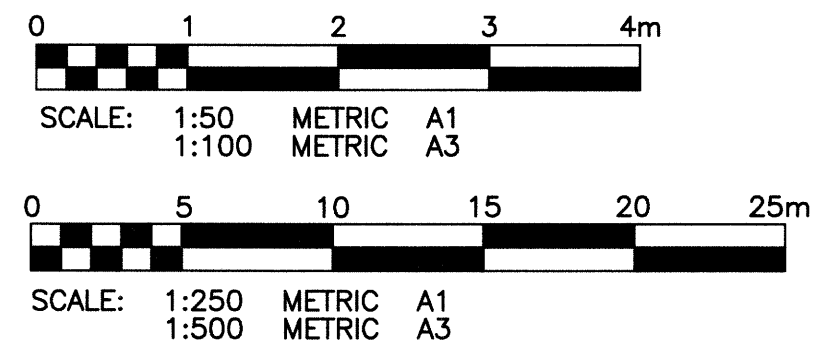
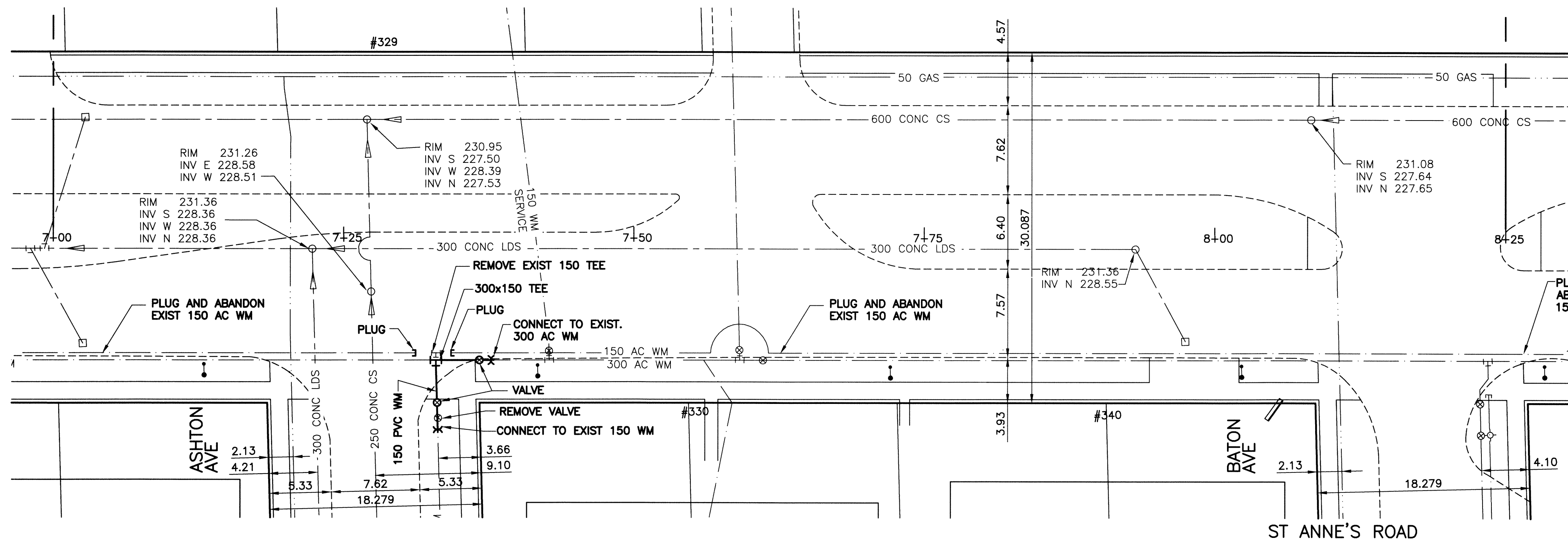

APEGM
Certificate of Authorization
KGS Group
No. 245

EXISTING	LEGEND-PLAN	PROPOSED	EXISTING	LEGEND-PLAN	PROPOSED	EXISTING	LEGEND-PROFILE	PROPOSED
150 WM	WATERMAIN	150 WM	HYDRO	WATERMAIN	150 WM	WATERMAIN	WATERMAIN	150 WM
Hydrant symbol	HYDRANT	Hydrant symbol	M.T.S.	HYDRANT, VALVE	Hydrant symbol	Hydrant symbol	HYDRANT, VALVE	Hydrant symbol
Valve symbol	VALVE	Valve symbol	CONCRETE	LAND DRAINAGE SEWER	Valve symbol	CONCRETE	LAND DRAINAGE SEWER	Valve symbol
300 LDS	LAND DRAINAGE SEWER	300 LDS	ASPHALT	WASTE WATER SEWER	300 LDS	ASPHALT	WASTE WATER SEWER	300 LDS
250 WWS	WASTE WATER SEWER	250 WWS	SIDEWALK	C PROFILE	250 WWS	SIDEWALK	C PROFILE	250 WWS
Manhole symbol	MANHOLE	Manhole symbol	PLANING	NORTH/WEST GUTTER	Manhole symbol	PLANING	NORTH/WEST GUTTER	Manhole symbol
Catch basin symbol	CATCH BASIN	Catch basin symbol	PROPERTY LINE	SOUTH/EAST GUTTER	Catch basin symbol	PROPERTY LINE	SOUTH/EAST GUTTER	Catch basin symbol
Curb inlet symbol	CURB INLET	Curb inlet symbol	SURVEY BAR	N/W, S/E R'S	Curb inlet symbol	SURVEY BAR	N/W, S/E R'S	Curb inlet symbol
Bend symbol	BEND	Bend symbol	GAS	N/W, S/E TOP/CURB	Bend symbol	GAS	N/W, S/E TOP/CURB	Bend symbol
Reducer symbol	REDUCER	Reducer symbol	CURB STOP		Reducer symbol	CURB STOP		Reducer symbol
Tee symbol	TEE	Tee symbol	TEE		Tee symbol	TEE		Tee symbol

LOCATION APPROVED UNDERGROUND STRUCTURES

SUPPLY U/G STRUCTURES COMMITTEE DATE

NOTE:
LOCATION OF UNDERGROUND STRUCTURES AS SHOWN ARE BASED ON THE BEST INFORMATION AVAILABLE BUT NO GUARANTEE IS GIVEN THAT THE GIVEN LOCATIONS ARE EXACT. CONFIRMATION OF EXISTENCE AND EXACT LOCATION OF ALL SERVICES MUST BE OBTAINED FROM THE INDIVIDUAL UTILITIES BEFORE PROCEEDING WITH CONSTRUCTION.

NO.	REVISIONS	DATE	BY
0	ISSUED FOR CONSTRUCTION	13/03/26	[Signature]

KGS GROUP CONSULTING ENGINEERS

DESIGNED BY: BJM
DRAWN BY: DMW

CHECKED BY: RBO
APPROVED BY: [Signature]

HOR. SCALE: 1:250
VERTICAL: 1:50

13/01/16

ENGINEER'S SEAL

B.J. MIKOLAYENKO
Member 24688
REGISTERED PROFESSIONAL ENGINEER

CONSULTANT DRAWING NO. 13-0107-001

THE CITY OF WINNIPEG WATER AND WASTE DEPARTMENT

PROJECT TITLE: 2013 WATERMAIN RENEWALS CONTRACT 4

ST ANNE'S ROAD FERMOR AVE TO HAVELOCK AVE STA 7+00 TO STA 8+25

SHEET 06 OF 07

COMPUTER FILE NAME: FERMOR AVE PLOT

CITY DRAWING NUMBER: D-13164