

File Name: P:\Projects\2013\13-0107-001\Doc.Control\TeBeissued\DWG\247-2013\_D-13166-Rev 0.dwg - Tab: D-13166 Plotted By: Dderoche 13/03/26 [Tue 11:11am]

**WARNING**

1. NOTIFY THE GAS COMPANY OF THE PROPOSED LOCATION OF EXCAVATION.
2. TAKE PRECAUTION TO AVOID DAMAGE TO GAS COMPANY INSTALLATIONS.
3. SEE PROVINCIAL REGULATION 140/92 FOR DETAILS.

---

**METRIC**

WHOLE NUMBERS INDICATE MILLIMETRES  
DECIMALIZED NUMBERS INDICATE METRES

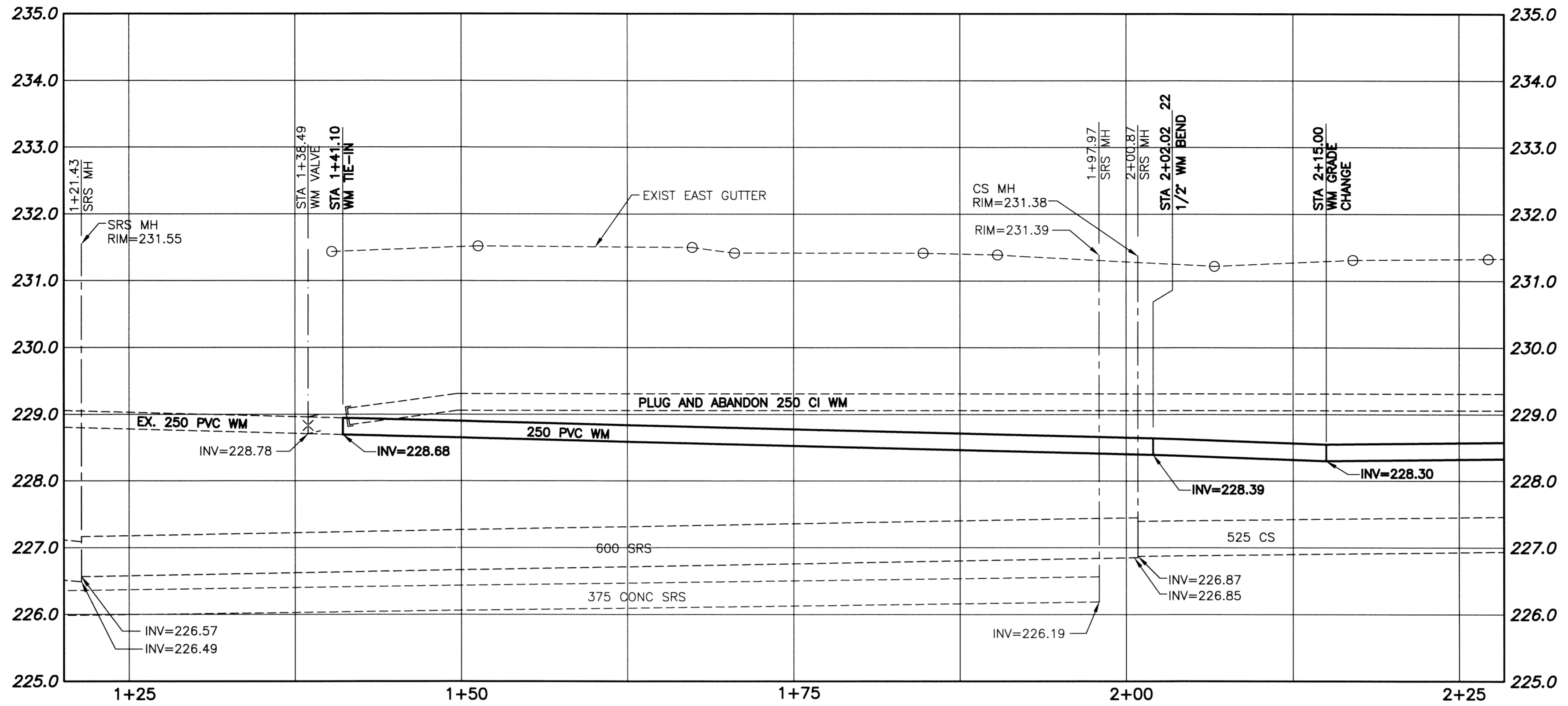

- CONSTRUCTION NOTES:**
1. EXPOSE WATERMAIN CONNECTIONS AND CONFIRM INVERTS PRIOR TO CONSTRUCTION.
  2. INSTALL WATERMAIN BY TRENCHLESS METHODS.
  3. ALL MATERIALS SHALL CONFORM TO THE CITY OF WINNIPEG STANDARD CONSTRUCTION SPECIFICATIONS.
  4. MINIMUM COVER TO TOP OF PROPOSED WATERMAIN SHALL BE 2.5m FROM STREET CENTERLINE.
  5. INSTALL ALL HYDRANTS WITH FLANGE ELEVATION 50mm TO 150mm ABOVE FINISHED GRADE.
  6. REPLACE ALL EXISTING LEAD SERVICES FROM THE PROPOSED WATERMAIN TO PROPERTY LINE.
  7. NOTIFY ALL AFFECTED RESIDENTS AND BUSINESSES 24 HOURS IN ADVANCE OF ANY WATER SHUTDOWN OR DISRUPTION OF SERVICES.
  8. LOCATION OF WATER SERVICES SHOWN ON DRAWING ARE APPROXIMATE. THE CONTRACTOR SHALL FIELD LOCATE ALL WATER SERVICES PRIOR TO CONSTRUCTION.
  9. BACKFILL UNDER OR WITHIN 1.0m OF PAVEMENTS, (INCLUDING SIDEWALKS) SHALL BE CLASS 3 BACKFILL EXCEPT AS NOTED. BACKFILL IN BOULEVARDS SHALL BE CLASS 5 BACKFILL.
  10. WATER VALVES TO BE CLOCKWISE TO CLOSE (BLACK OPERATING NUT)

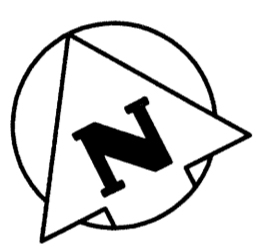

NOTE: CHAINAGES SHOWN ARE ALONG CENTERLINE OF R.O.W.

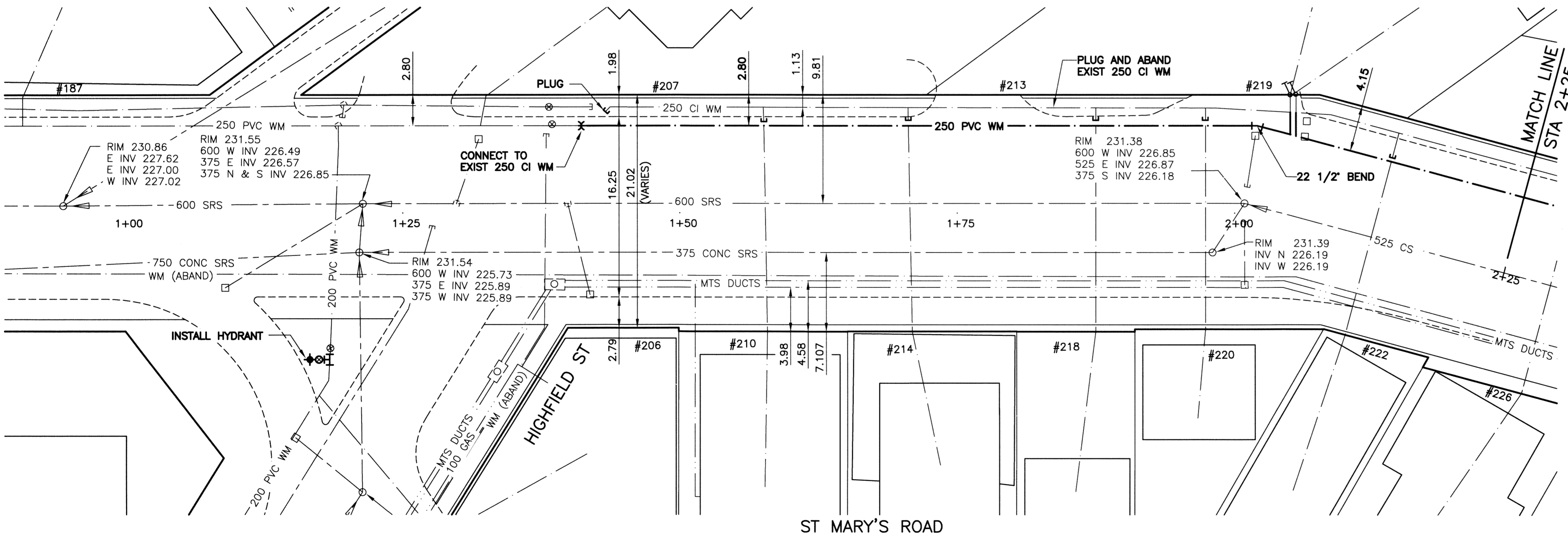

CURB STOP				CORPORATION STOP	
ADDRESS TYPE/NATURE	DISTANCE (METERS)	SIZE(mm) & TYPE	SHORT & LONG MEASUREMENT (METER)	CORPORATION LOCATION	REMARKS
213 ST MARY'S RD COMMERCIAL	BLDG 23.3	20 COPPER	0.6m L L COR OF HSE		LOT P 28/29/30/31/32 DR/WY 1058A RED TOP SHOP/CENTRE
213 ST MARY'S RD COMMERCIAL					PAOLO'S HAIRDRESSING
214 ST MARY'S RD RESIDENTIAL	BLDG 1.8	20 COPPER	5.4m L/RR OF HSE 1.7m CURB		SEWER/29
218 ST MARY'S RD RESIDENTIAL			2.4m R L COR HSE		SEWER/49
219 ST MARY'S RD COMMERCIAL	BLDG 23.0		2.1m R L COR HSE		LOT P 28/29/30/31/32 DR/WY 1058A 58.7m FROM NORTH CURB LINE OF NIVERVILLE SEWER/56
220 ST MARY'S RD COMMERCIAL	BLDG 1.4		4.4m L R COR HSE		
221 ST MARY'S RD COMMERCIAL	BLDG 14.0	20 COPPER	16.5m R/R FROM BLDG		
222 ST MARY'S RD COMMERCIAL			16.5m N/HYD		SEWER/46
225 ST MARY'S RD COMMERCIAL	CURB 0.6	20 COPPER	2.7m R R COR STORE IN WALK		
226 ST MARY'S RD COMMERCIAL	BLDG 0.2		7.0m LR CORNER OF HSE 34.9m N OF CURB/L NIVER		METER REMOVED JAN/89 - BURST NOT BILLED UNABLE TO TRACE OWNER
226 ST MARY'S RD COMMERCIAL	BLDG 3.3	20 COPPER	4.6m RL CORNER OF HSE		

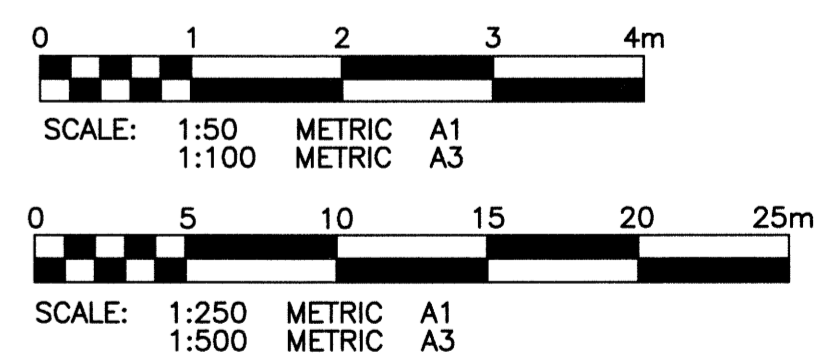

**APEGM**  
Certificate of Authorization  
KGS Group  
No. 245

150 WM	150 WM	HYDRO	150 WM	WATERMAIN	150 WM
⊕	⊕	M.T.S.	⊕	HYDRANT, VALVE	⊕
⊖	⊖	CONCRETE	⊖	LAND DRAINAGE SEWER	⊖
⊗	⊗	ASPHALT	⊗	WASTE WATER SEWER	⊗
⊘	⊘	SIDEWALK	⊘	Q PROFILE	⊘
○	○	PLANING	○	NORTH/WEST GUTTER	○
□	□	PROPERTY LINE	□	SOUTH/EAST GUTTER	□
▽	▽	SURVEY BAR	▽	N/W, S/E R'S	▽
∇	∇	GAS	∇	N/W, S/E TOP/CURB	∇
∩	∩	CURB STOP	∩		∩
∪	∪	TEE	∪		∪
⌋	⌋	EXISTING	⌋	EXISTING	⌋
⌌	⌌	PROPOSED	⌌	PROPOSED	⌌

**LOCATION APPROVED UNDERGROUND STRUCTURES**

SUPV. U/G STRUCTURES COMMITTEE DATE

NOTE:  
LOCATION OF UNDERGROUND STRUCTURES AS SHOWN ARE BASED ON THE BEST INFORMATION AVAILABLE BUT NO GUARANTEE IS GIVEN THAT ALL EXISTING UTILITIES ARE SHOWN OR THAT THE GIVEN LOCATIONS ARE EXACT. CONFIRMATION OF EXISTENCE AND EXACT LOCATION OF ALL SERVICES MUST BE OBTAINED FROM THE INDIVIDUAL UTILITIES BEFORE PROCEEDING WITH CONSTRUCTION.

B.M. KGS BASE ELEV. DWGS BASE ON C.S.R.S. NAD 83 SYSTEM UTM GRID.

**KGS GROUP CONSULTING ENGINEERS**

DESIGNED BY: BJM  
DRAWN BY: DMW

CHECKED BY: RBO  
APPROVED BY:

HOR. SCALE: 1:250  
VERTICAL: 1:50

ISSUED FOR CONSTRUCTION: 13/03/26 BY: [Signature]  
NO. REVISIONS: [ ] DATE: 13/01/16

ENGINEER'S SEAL

PROVINCE OF MANITOBA  
B.J. MIKOLAYENKO  
Member  
24688  
winnipeg 16/2013

CONSULTANT DRAWING NO. 13-0107-001

**THE CITY OF WINNIPEG WATER AND WASTE DEPARTMENT**

PROJECT TITLE: 2013 WATERMAIN RENEWALS CONTRACT 4

ST MARY'S ROAD HIGHFIELD STREET TO METCALFE AVENUE STA 1+00 TO STA 2+25

SHEET 01 OF 05  
COMPUTER FILE NAME: ST MARYS\_2 PLOT  
CITY DRAWING NUMBER: D-13166