

File Name: P:\Projects\2013\13-0107-001\Doc\Control\TobBelusued\DWG\247-2013_D-13170-Rev 0.dwg - Tab: D-13170-Rev 0.dwg - Tab: D-13170-Rev 0.dwg [Tue 11:10am]

WARNING

1. NOTIFY THE GAS COMPANY OF THE PROPOSED LOCATION OF EXCAVATION.
2. TAKE PRECAUTION TO AVOID DAMAGE TO GAS COMPANY INSTALLATIONS.
3. SEE PROVINCIAL REGULATION 140/92 FOR DETAILS.

METRIC

WHOLE NUMBERS INDICATE MILLIMETRES
DECIMALIZED NUMBERS INDICATE METRES

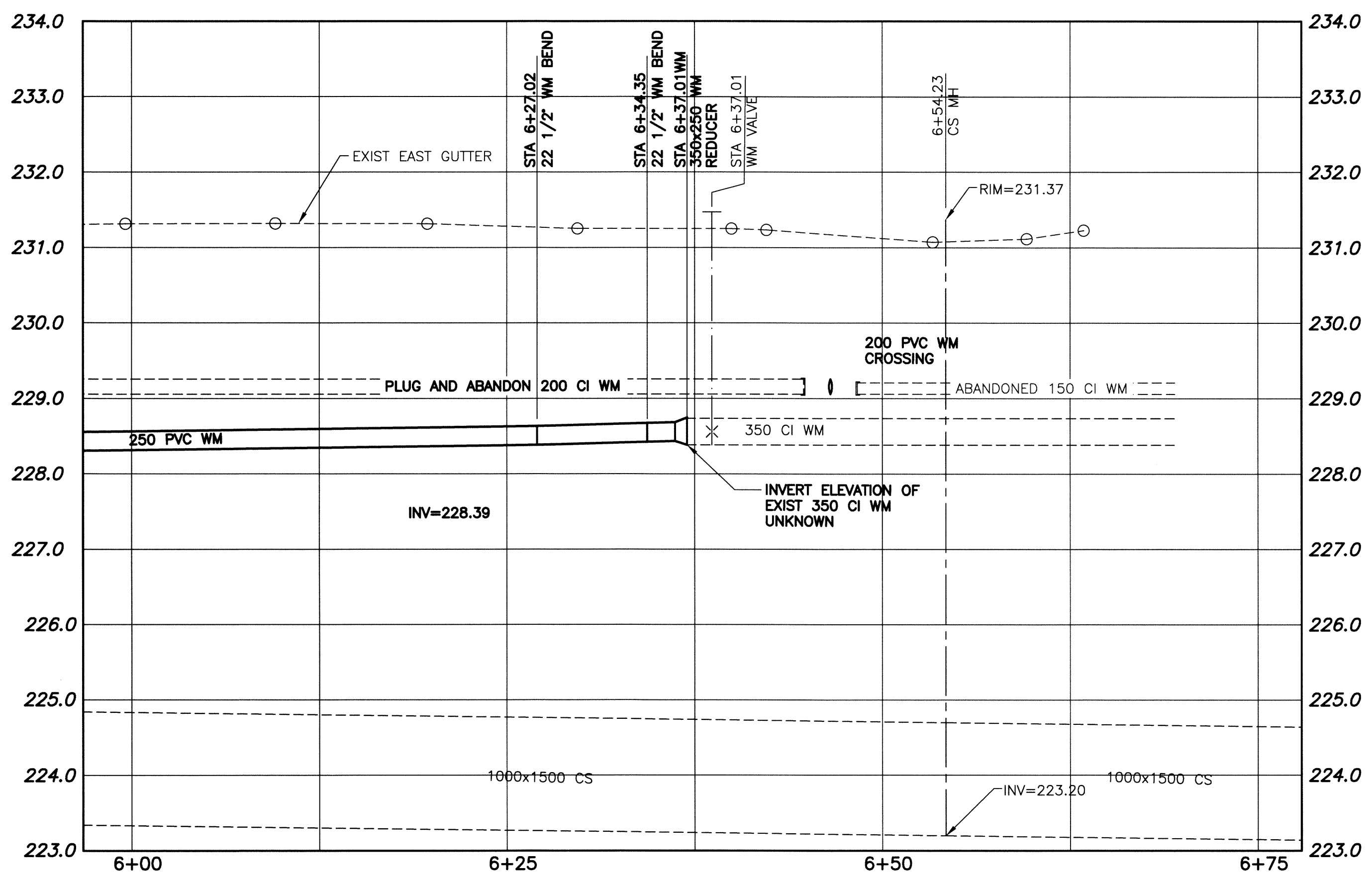

- CONSTRUCTION NOTES:**
1. EXPOSE WATERMAIN CONNECTIONS AND CONFIRM INVERTS PRIOR TO CONSTRUCTION.
 2. INSTALL WATERMAIN BY TRENCHLESS METHODS.
 3. ALL MATERIALS SHALL CONFORM TO THE CITY OF WINNIPEG STANDARD CONSTRUCTION SPECIFICATIONS.
 4. MINIMUM COVER TO TOP OF PROPOSED WATERMAIN SHALL BE 2.5m FROM STREET CENTERLINE.
 5. INSTALL ALL HYDRANTS WITH FLANGE ELEVATION 50mm TO 150mm ABOVE FINISHED GRADE.
 6. REPLACE ALL EXISTING LEAD SERVICES FROM THE PROPOSED WATERMAIN TO PROPERTY LINE.
 7. NOTIFY ALL AFFECTED RESIDENTS AND BUSINESSES 24 HOURS IN ADVANCE OF ANY WATER SHUTDOWN OR DISRUPTION OF SERVICES.
 8. LOCATION OF WATER SERVICES SHOWN ON DRAWING ARE APPROXIMATE. THE CONTRACTOR SHALL FIELD LOCATE ALL WATER SERVICES PRIOR TO CONSTRUCTION.
 9. BACKFILL UNDER OR WITHIN 1.0m OF PAVEMENTS, (INCLUDING SIDEWALKS) SHALL BE CLASS 3 BACKFILL EXCEPT AS NOTED. BACKFILL IN BOULEVARDS SHALL BE CLASS 5 BACKFILL.
 10. WATER VALVES TO BE CLOCKWISE TO CLOSE (BLACK OPERATING NUT)

CURB STOP				CORPORATION STOP	
ADDRESS TYPE/NATURE	DISTANCE (METERS)	SIZE(mm) & TYPE	SHORT & LONG MEASUREMENT (METER)	CORPORATION LOCATION	REMARKS
311 ST MARY'S RD RESIDENTIAL	BLDG 8.6	20 COPPER	2.7m R L COR HSE	SEWER/49	TAX-ST B-817840-06
315 ST MARY'S RD RESIDENTIAL	BLDG 8.1	25 COPPER	5.0m R L COR BLDG	SEWER/49	TAX STB2-817840-06
316 ST MARY'S RD RESIDENTIAL	BLDG 3.7	20 COPPER	6.2m N/S BLDG LINE	SEE TECHNICAL	SEE PERMIT 23837 FOR DETAILS
326 ST MARY'S RD COMMERCIAL	BLDG 0.2	25 COPPER	6.2m S OF N/L	IN/LINE WITH SC	SEWER/54. 96/08/01 WM RENEWAL
329 ST MARY'S RD COMMERCIAL	PROPERTY 0.2	20 COPPER	7.9 SSPL/METCALFE	0.6m S OF S/C	SEWER/39. 96/08/01 WM RENEWAL
332 ST MARY'S RD RESIDENTIAL	PROPERTY 1.0	25 COPPER	13.7m FR S/L CHAMPLAIN	IN LINE WITH S/C	SEWER/54. 96/08/01 WM RENEWAL
			29.3 SSPL/METCALFE		

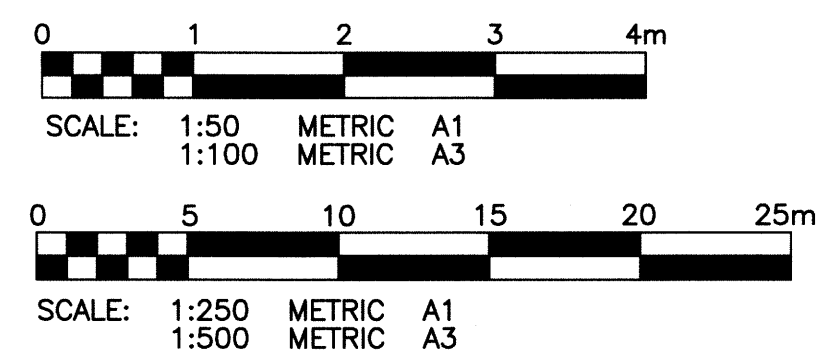
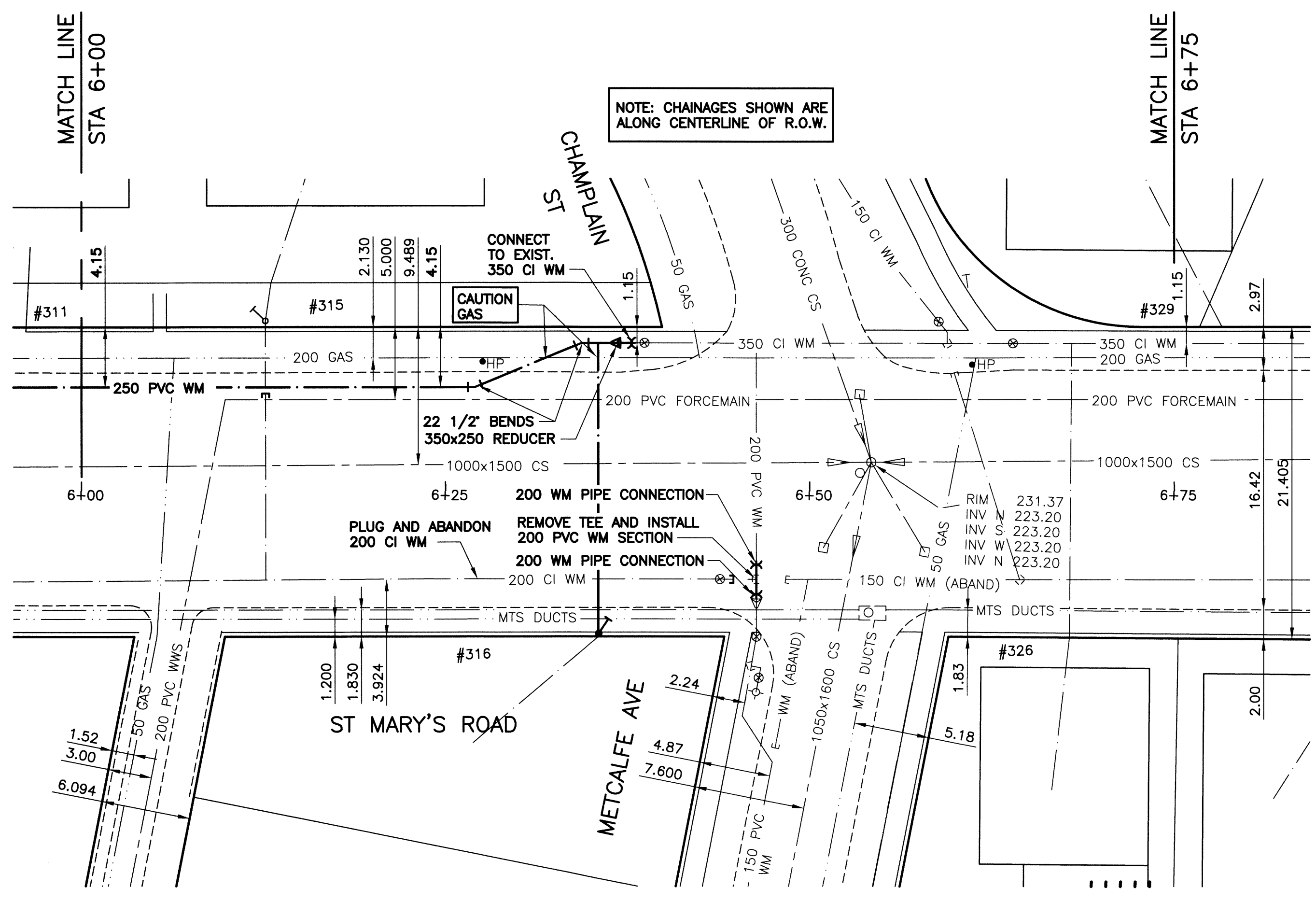
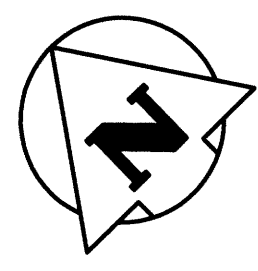

APEGM
Certificate of Authorization
KGS Group
No. 245

EXISTING	LEGEND-PLAN	PROPOSED	EXISTING	LEGEND-PLAN	PROPOSED	EXISTING	LEGEND-PROFILE	PROPOSED
150 WM	WATERMAIN	150 WM	HYDRO	HYDRO	150 WM	WATERMAIN	150 WM	WATERMAIN
Hydrant	HYDRANT	Hydrant	M.T.S.	M.T.S.	Hydrant	HYDRANT, VALVE	Hydrant	HYDRANT, VALVE
Valve	VALVE	Valve	CONCRETE	CONCRETE	Valve	LAND DRAINAGE SEWER	Valve	LAND DRAINAGE SEWER
300 LDS	LAND DRAINAGE SEWER	300 LDS	ASPHALT	ASPHALT	300 LDS	WASTE WATER SEWER	300 LDS	WASTE WATER SEWER
250 WWS	WASTE WATER SEWER	250 WWS	SIDEWALK	SIDEWALK	250 WWS	C PROFILE	250 WWS	C PROFILE
Manhole	MANHOLE	Manhole	PLANING	PLANING	Manhole	NORTH/WEST GUTTER	Manhole	NORTH/WEST GUTTER
Catch Basin	CATCH BASIN	Catch Basin	PROPERTY LINE	PROPERTY LINE	Catch Basin	SOUTH/EAST GUTTER	Catch Basin	SOUTH/EAST GUTTER
Curb Inlet	CURB INLET	Curb Inlet	SURVEY BAR	SURVEY BAR	Curb Inlet	N/W, S/E R'S	Curb Inlet	N/W, S/E R'S
Bend	BEND	Bend	GAS	GAS	Bend	N/W, S/E TOP/CURB	Bend	N/W, S/E TOP/CURB
Reducer	REDUCER	Reducer	CURB STOP	CURB STOP	Reducer		Reducer	
Tee	TEE	Tee	Curb Stop	Curb Stop	Tee		Tee	

LOCATION APPROVED UNDERGROUND STRUCTURES

SUPV. U/G STRUCTURES COMMITTEE DATE

NOTE: LOCATION OF UNDERGROUND STRUCTURES AS SHOWN ARE BASED ON THE BEST INFORMATION AVAILABLE BUT NO GUARANTEE IS GIVEN THAT ALL EXISTING UTILITIES ARE SHOWN OR THAT THE GIVEN LOCATIONS ARE EXACT. CONFIRMATION OF EXISTENCE AND EXACT LOCATION OF ALL SERVICES MUST BE OBTAINED FROM THE INDIVIDUAL UTILITIES BEFORE PROCEEDING WITH CONSTRUCTION.

B.M. KGS BASE ELEV. DWGS BASE ON C.S.R.S. NAD 83 SYSTEM UTM GRID.

KGS GROUP CONSULTING ENGINEERS

DESIGNED BY: BJM
DRAWN BY: DMW

CHECKED BY: RBO
APPROVED BY:

HOR. SCALE: 1:250
VERTICAL: 1:50

ISSUED FOR CONSTRUCTION: 13/03/2013
DATE: 13/01/16

ENGINEER'S SEAL

B.J. NIKOLAYENKO
Member 24888
M.A.S.C. 26/2013

CONSULTANT DRAWING NO. 13-0107-001

THE CITY OF WINNIPEG WATER AND WASTE DEPARTMENT

PROJECT TITLE: 2013 WATERMAIN RENEWALS CONTRACT 4

ST MARY'S ROAD HIGHFIELD STREET TO METCALFE AVENUE STA 6+00 TO STA 6+75

SHEET 05 OF 05
COMPUTER FILE NAME: ST MARYS_2 PLOT
CITY DRAWING NUMBER: D-13170