

File Name: P:\Projects\2013\13-0107-001\Doc\Control\DWG\247-2013-D-13173-Rev 0.dwg - Tab: D-13173 Plotted By: DDeroche 13/03/26 [Tue 11:09am]

WARNING
 1. NOTIFY THE GAS COMPANY OF THE PROPOSED LOCATION OF EXCAVATION.
 2. TAKE PRECAUTION TO AVOID DAMAGE TO GAS COMPANY INSTALLATIONS.
 3. SEE PROVINCIAL REGULATION 140/92 FOR DETAILS.

METRIC
 WHOLE NUMBERS INDICATE MILLIMETRES
 DECIMALIZED NUMBERS INDICATE METRES

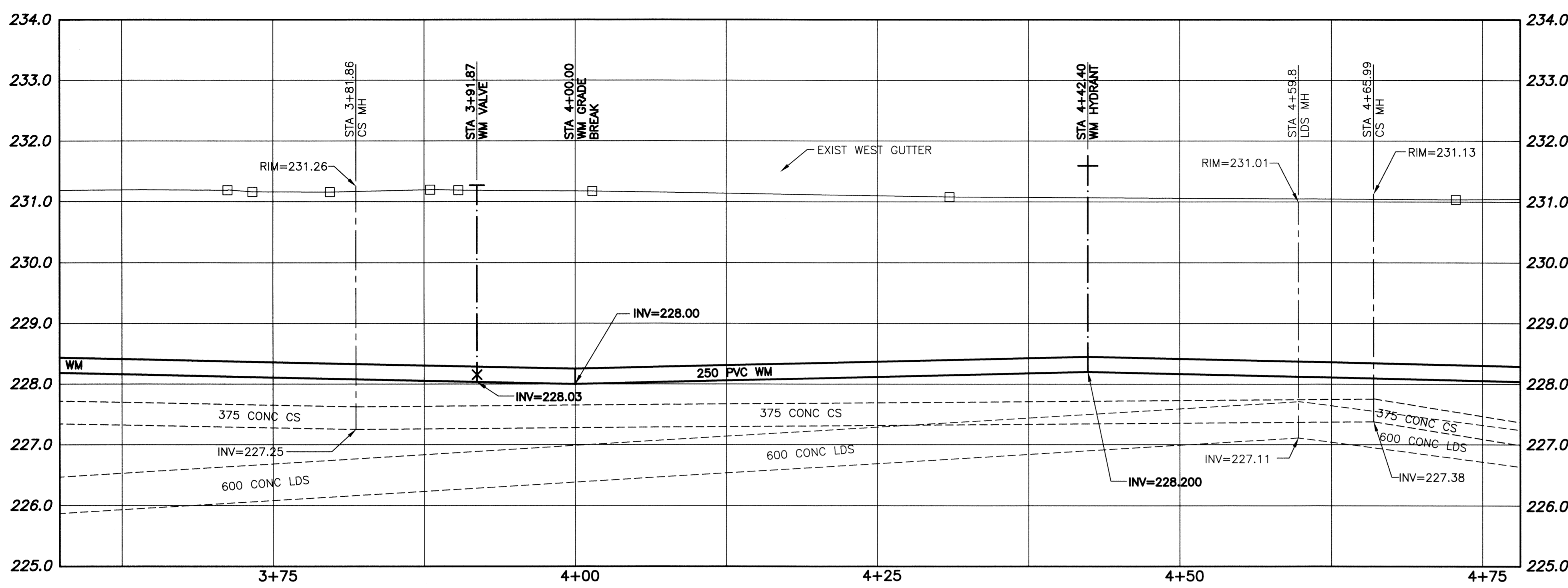

NOTE: CHAINAGES SHOWN ARE ALONG CENTERLINE OF R.O.W.

- CONSTRUCTION NOTES:**
1. EXPOSE WATERMAIN CONNECTIONS AND CONFIRM INVERTS PRIOR TO CONSTRUCTION.
 2. INSTALL WATERMAIN BY TRENCHLESS METHODS.
 3. ALL MATERIALS SHALL CONFORM TO THE CITY OF WINNIPEG STANDARD CONSTRUCTION SPECIFICATIONS.
 4. MINIMUM COVER TO TOP OF PROPOSED WATERMAIN SHALL BE 2.5m FROM STREET CENTERLINE.
 5. INSTALL ALL HYDRANTS WITH FLANGE ELEVATION 50mm TO 150mm ABOVE FINISHED GRADE.
 6. REPLACE ALL EXISTING LEAD SERVICES FROM THE PROPOSED WATERMAIN TO PROPERTY LINE.
 7. NOTIFY ALL AFFECTED RESIDENTS AND BUSINESSES 24 HOURS IN ADVANCE OF ANY WATER SHUTDOWN OR DISRUPTION OF SERVICES.
 8. LOCATION OF WATER SERVICES SHOWN ON DRAWING ARE APPROXIMATE. THE CONTRACTOR SHALL FIELD LOCATE ALL WATER SERVICES PRIOR TO CONSTRUCTION.
 9. BACKFILL UNDER OR WITHIN 1.0m OF PAVEMENTS, (INCLUDING SIDEWALKS) SHALL BE CLASS 3 BACKFILL EXCEPT AS NOTED. BACKFILL IN BOULEVARDS SHALL BE CLASS 5 BACKFILL.
 10. WATER VALVES TO BE CLOCKWISE TO CLOSE (BLACK OPERATING NUT)

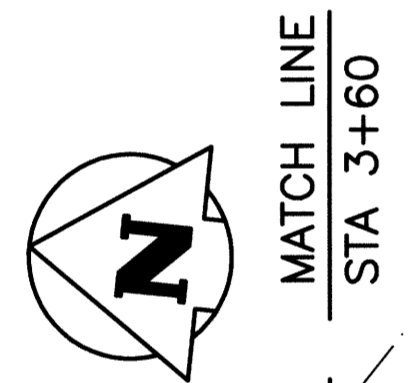

MATCH LINE
STA 3+60

MATCH LINE
STA 4+75

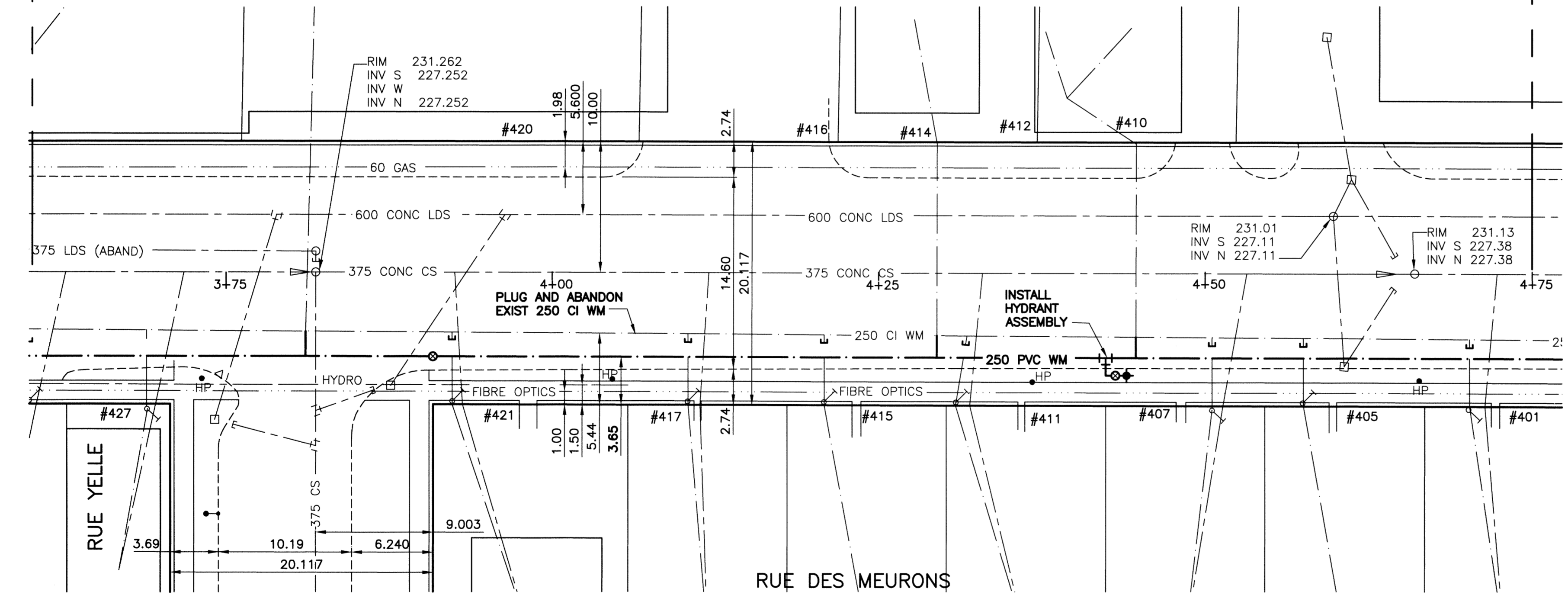

CURB STOP			CORPORATION STOP		
ADDRESS TYPE/NATURE	DISTANCE (METERS)	SIZE(mm) & TYPE	SHORT & LONG MEASUREMENT (METER)	CORPORATION LOCATION	REMARKS
435 DES MEURONS ST RESIDENTIAL	BLDG 8.0	20 COPPER	0.3 L/RHL		
431 DES MEURONS ST RESIDENTIAL	BLDG 7.5	20 COPPER	0.3 L/LHL		
427 DES MEURONS ST RESIDENTIAL	BLDG 5.7	20 COPPER	1.2 R/LHL		
421 DES MEURONS ST RESIDENTIAL	BLDG 10.6	20 COPPER	1.0 R/RHL		TAX STBJ-709020-06
420 DES MEURONS ST INDUSTRIAL	BLDG 1.5	25 COPPER	4.1 L/RHL	OPP S/C	REVERSE TAPPED
417 DES MEURONS ST RESIDENTIAL	BLDG 10.4	20 COPPER	3.9 L/RHL		
415 DES MEURONS ST RESIDENTIAL	BLDG 10.4	20 COPPER	1.5 S/NHL		DEC/02-RENEWED SERVICE BOX
414 DES MEURONS ST COMMERCIAL	BLDG 2.0	20 COPPER	1.8 R/RHL		
412 DES MEURONS ST COMMERCIAL		3.0 L/RHL			
411 DES MEURONS ST RESIDENTIAL	BLDG 10.4	20 COPPER	0.9 R/RHL	OPP N/HL	
410 DES MEURONS ST COMMERCIAL	BLDG 0.6	20 COPPER	3.0 L/RHL		
407 DES MEURONS ST RESIDENTIAL	BLDG 12.1	20 COPPER	1.9 R/LHL		
405 DES MEURONS ST RESIDENTIAL	BLDG 10.3	20 COPPER	2.1 L/RHL		
401 DES MEURONS ST RESIDENTIAL	BLDG 10.6	20 COPPER	2.2 L/RHL		

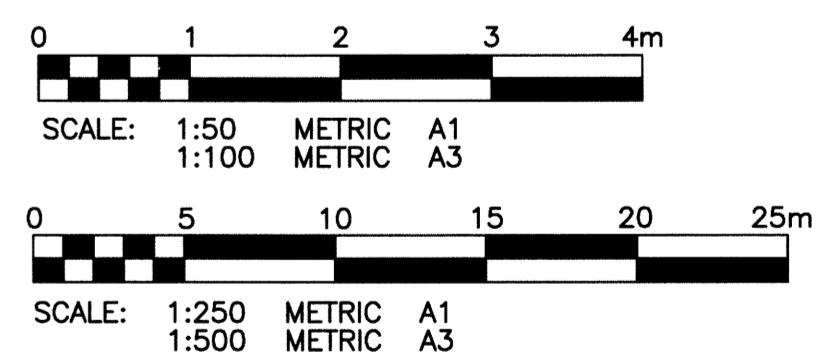

EXISTING	LEGEND-PLAN	PROPOSED	EXISTING	LEGEND-PLAN	PROPOSED	EXISTING	LEGEND-PROFILE	PROPOSED
150 WM	WATERMAIN	150 WM	HYDRO	WATERMAIN	150 WM	WATERMAIN	150 WM	WATERMAIN
+	HYDRANT	+	M.T.S.	HYDRANT, VALVE	+	+	HYDRANT, VALVE	+
⊙	VALVE	⊙	CONCRETE	LAND DRAINAGE SEWER	300 LDS	300 LDS	LAND DRAINAGE SEWER	300 LDS
---	LAND DRAINAGE SEWER	---	ASPHALT	WASTE WATER SEWER	250 WWS	250 WWS	WASTE WATER SEWER	250 WWS
---	WASTE WATER SEWER	---	SIDEWALK	C PROFILE	X	X	C PROFILE	X
○	MANHOLE	○	PLANING	NORTH/WEST GUTTER	□	□	NORTH/WEST GUTTER	□
□	CATCH BASIN	□	PROPERTY LINE	SOUTH/EAST GUTTER	○	○	SOUTH/EAST GUTTER	○
▽	CURB INLET	▽	SURVEY BAR	N/W, S/E R'S	◇, ○	◇, ○	N/W, S/E R'S	◇, ○
∩	BEND	∩	GAS	N/W, S/E TOP/CURB	□, ○	□, ○	N/W, S/E TOP/CURB	□, ○
∩	REDUCER	∩	CURB STOP					
J	TEE	J	TEE					

LOCATION APPROVED UNDERGROUND STRUCTURES

SUPV. U/G STRUCTURES COMMITTEE DATE

NOTE:
 LOCATION OF UNDERGROUND STRUCTURES AS SHOWN ARE BASED ON THE BEST INFORMATION AVAILABLE BUT NO GUARANTEE IS GIVEN THAT ALL EXISTING UTILITIES ARE SHOWN OR THAT THE GIVEN LOCATIONS ARE EXACT. CONFIRMATION OF EXISTENCE AND EXACT LOCATION OF ALL SERVICES MUST BE OBTAINED FROM THE INDIVIDUAL UTILITIES BEFORE PROCEEDING WITH CONSTRUCTION.

B.M. KGS BASE ELEV. DWGS BASE ON C.S.R.S. NAD 83 SYSTEM UTM GRID.

KGS GROUP CONSULTING ENGINEERS

DESIGNED BY: **BJM** CHECKED BY: **RBO**
 DRAWN BY: **DMW** APPROVED BY: **[Signature]**

HOR. SCALE: 1:250
 VERTICAL: 1:50

ISSUED FOR CONSTRUCTION 13/03/26 BY: **[Signature]**
 NO. REVISIONS DATE BY DATE 13/01/16

ENGINEER'S SEAL: **[Signature]** B.J.J. MIKOLAYENKO Member 24888

THE CITY OF WINNIPEG WATER AND WASTE DEPARTMENT

PROJECT TITLE: **2013 WATERMAIN RENEWALS CONTRACT 4**

RUE DES MEURONS HAMEL AVE TO BERTRAND ST STA 3+60 TO STA 4+75

SHEET 03 OF 04
 COMPUTER FILE NAME: RUE DES MEURONS PLOT
 CITY DRAWING NUMBER: D-13173

CONSULTANT DRAWING NO. 13-0107-001