

NOTE: CHAINAGES SHOWN ARE ALONG E. R. OF WILTON ST.

WATER SERVICE INFORMATION

ADDRESS	SIZE (mm) MATERIAL (STREET)	SIZE (mm) MATERIAL (PROP.)	SHORT & LONG MEASUREMENT	CORP. LOCATION	REMARKS
1103 CORYDON AVE RESIDENTIAL	20 COPPER	20 COPPER	1.65 EWL HSE 1.84 EEL WILTON	0.2 W OF S/C	-
1108 CORYDON AVE RESIDENTIAL	20 COPPER	20 COPPER	3.16 EWL HSE 3.86 EEL WILTON	1.7 W OF S/C	-
1113 CORYDON AVE RESIDENTIAL	20 COPPER	20 COPPER	1.42 EWL HSE	OPP S/C	-
1114 CORYDON AVE RESIDENTIAL	50 LEAD	50 LEAD	2.47 WEL BLDG	OPP S/C	-
1114 CORYDON AVE COMMERCIAL	50 COPPER	50 COPPER	14.62 WML WILTON	OPP S/C	-

* SERVICES TO BE RENEWED TO R. ALL OTHERS TO BE RECONNECTED

MATCHLINE 2+00 SEE DWG D-13187

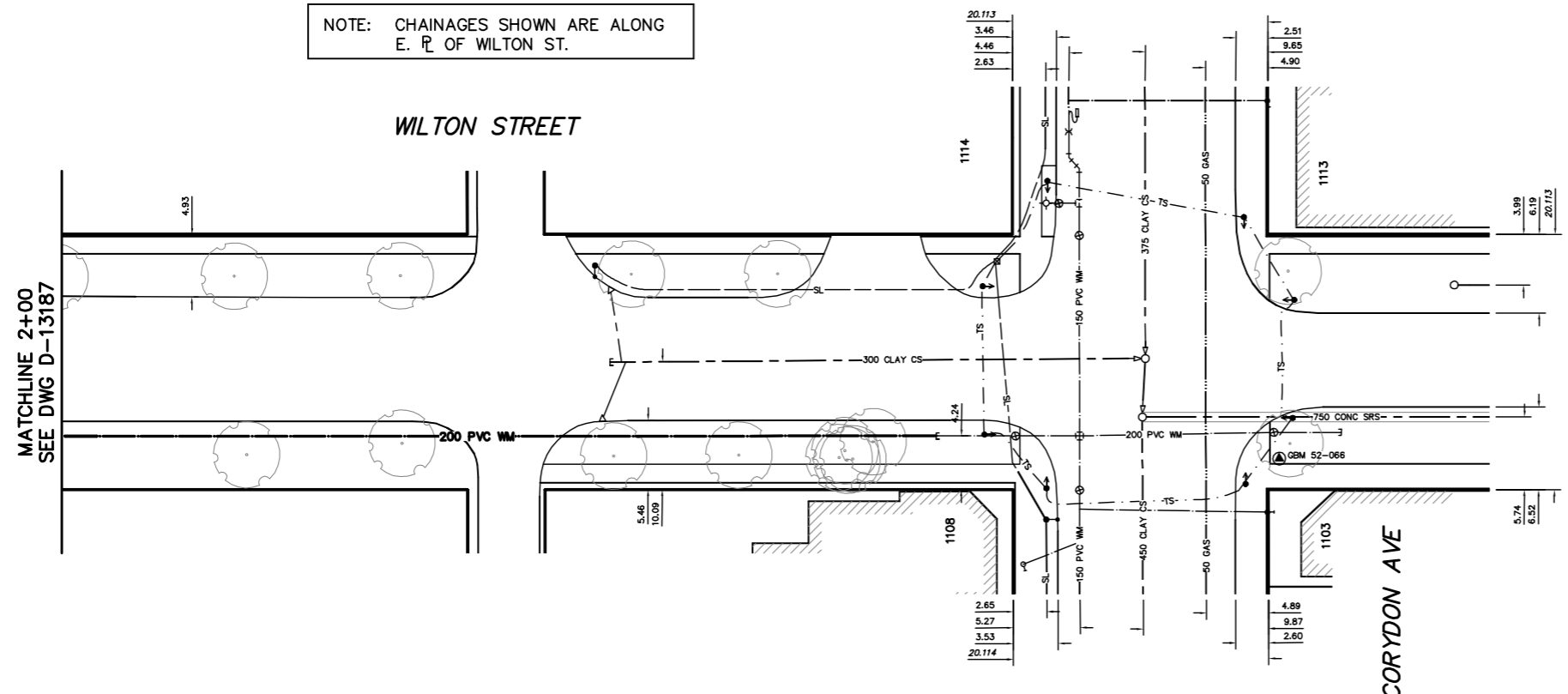

VALVES TO BE COUNTER-CLOCKWISE TO CLOSE (RED OPERATING NUT)

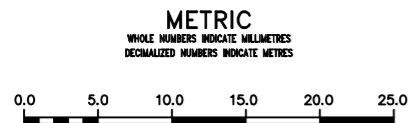

WARNING
IF POWER EQUIPMENT OR EXPLOSIVES ARE TO BE USED FOR EXCAVATION ON THIS PROJECT THE CONTRACTOR MUST:
1) NOTIFY THE GAS COMPANY OF THE PROPOSED LOCATION OF EXCAVATION.
2) TAKE PRECAUTION TO AVOID DAMAGE TO GAS COMPANY INSTALLATIONS.
SEE PROVINCIAL REGULATION 210/72 FOR DETAILS

LOCATION APPROVED UNDERGROUND STRUCTURES
SUPV. U/G STRUCTURES COMMITTEE DATE
NOTE: LOCATION OF UNDERGROUND STRUCTURES AS SHOWN ARE BASED ON THE BEST INFORMATION AVAILABLE BUT NO GUARANTEE IS GIVEN THAT ALL EXISTING UTILITIES ARE SHOWN OR THAT THE GIVEN LOCATIONS ARE EXACT. CONFIRMATION OF EXISTENCE AND EXACT LOCATION OF ALL SERVICES MUST BE OBTAINED FROM THE INDIVIDUAL UTILITIES BEFORE PROCEEDING WITH CONSTRUCTION.

B.M. ELEV.	
CONSTRUCTION COMPLETION DATE: YYYY MM DD	
NO.	REVISIONS
	DATE
	BY

DESIGNED BY	LA	CHECKED BY	SC
DRAWN BY	CJH	APPROVED BY	KZ
SCALE:		RELEASED FOR CONSTRUCTION	
HORIZONTAL	1:250	K.R. ZUREK	
VERTICAL	1:50	DATE 13.04.09	
DATE	2013 04 09	DATE 13.04.09	

ENGINEER'S SEAL
ORIGINAL SIGNED BY S.R.J. COURNOYER 13.04.08
CONSULTANT DRAWING NUMBER

THE CITY OF WINNIPEG
WATER AND WASTE DEPARTMENT
ENGINEERING DIVISION
2013 WATER RENEWALS
WILTON STREET
5 N OF JESSIE AVENUE TO CORYDON AVENUE
SHEET 15 OF 15
CITY DRAWING NUMBER
D-13188