

NOTE: CHAINAGES SHOWN ARE ALONG E. R. OF BERTHA ST.

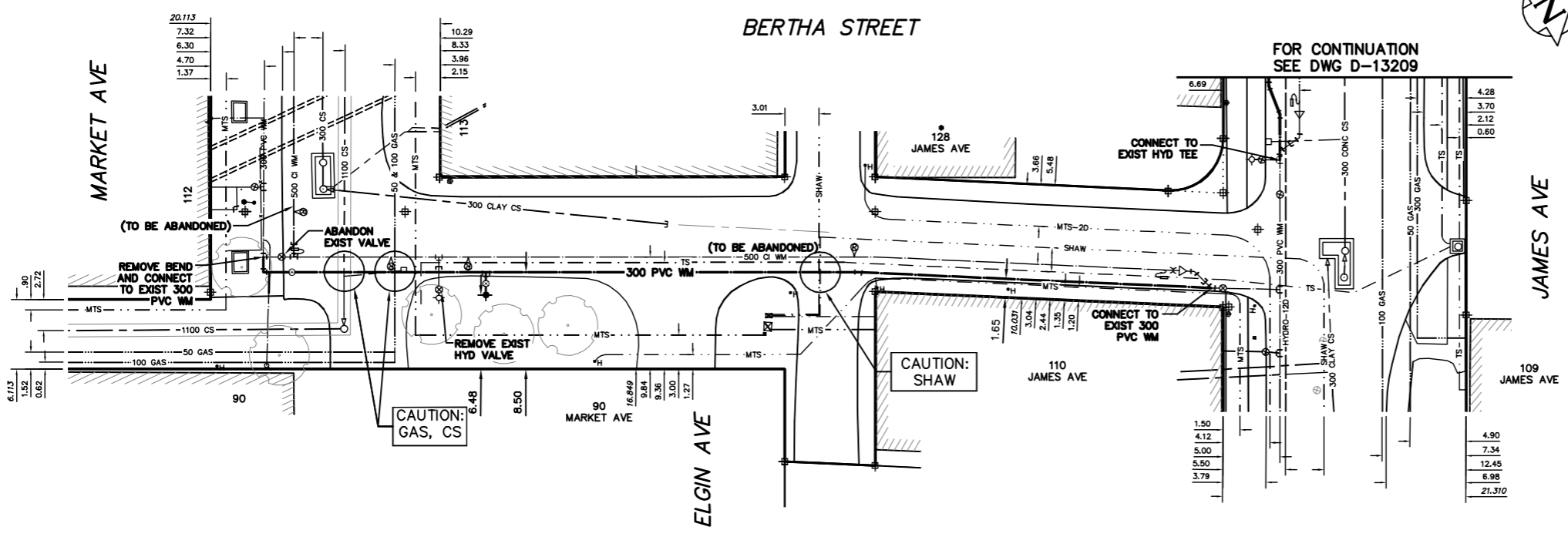

**WATER SERVICE INFORMATION**

ADDRESS	SIZE (mm)	MATERIAL	SHORT & LONG MEASUREMENT	CORP. LOCATION	REMARKS
110 JAMES AVE COMMERCIAL	150	PVC	3.97 EWL BLDG	OPP VALVE	SERV. OFF JAMES
128 JAMES AVE COMMERCIAL	12	PVC	4.0 EEL BERTHA		SERV. OFF JAMES
128 JAMES AVE COMMERCIAL	12	LEAD	24.41 WEL BLDG	0.2 W OF S/C	RENEW TO R
128 JAMES AVE COMMERCIAL	150	PVC	31.98 WEL BERTHA		SERV. OFF JAMES
90 MARKET AVE COMMERCIAL	150	PVC	12.10 WEL BLDG	OPP VALVE	RENEW TO R
113 MARKET AVE COMMERCIAL	150	PVC	19.76 WEL BERTHA		SERV. OFF JAMES
113 MARKET AVE COMMERCIAL	38	COPPER	2.45 SNL BLDG	0.5 S OF S/C	SERV. OFF BERTHA
113 MARKET AVE COMMERCIAL	38	COPPER	5.01 WEL MARKET		RECONNECT TO SERVICE
113 MARKET AVE COMMERCIAL	150	PVC	11.49 WEL BLDG	OPP VALVE	SERV. OFF MARKET
113 MARKET AVE COMMERCIAL	150	PVC	11.50 WEL BERTHA		SERV. OFF MARKET

\* SERVICES TO BE RENEWED TO R. ALL OTHERS TO BE RECONNECTED

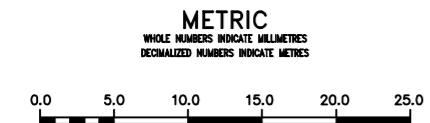

**WARNING**  
 IF POWER EQUIPMENT OR EXPLOSIVES ARE TO BE USED FOR EXCAVATION ON THIS PROJECT THE CONTRACTOR MUST:  
 1) NOTIFY THE GAS COMPANY OF THE PROPOSED LOCATION OF EXCAVATION.  
 2) TAKE PRECAUTION TO AVOID DAMAGE TO GAS COMPANY INSTALLATIONS.  
 SEE PROVINCIAL REGULATION 210/72 FOR DETAILS

**LOCATION APPROVED UNDERGROUND STRUCTURES**  
 SUPV. U/G STRUCTURES COMMITTEE DATE  
 NOTE:  
 LOCATION OF UNDERGROUND STRUCTURES AS SHOWN ARE BASED ON THE BEST INFORMATION AVAILABLE BUT NO GUARANTEE IS GIVEN THAT ALL EXISTING UTILITIES ARE SHOWN OR THAT THE GIVEN LOCATIONS ARE EXACT. CONFIRMATION OF EXISTENCE AND EXACT LOCATION OF ALL SERVICES MUST BE OBTAINED FROM THE INDIVIDUAL UTILITIES BEFORE PROCEEDING WITH CONSTRUCTION.

NO.	REVISIONS	DATE	BY

DESIGNED BY TS  
 DRAWN BY CJH/RS  
 SCALE:  
 HORIZONTAL 1:250  
 VERTICAL 1:50  
 CHECKED BY SC  
 APPROVED BY KZ  
 RELEASED FOR CONSTRUCTION  
 DATE 2013 04 19

ENGINEER'S SEAL  
 ORIGINAL SIGNED BY K.R. ZUREK 13.04.19  
 CONSULTANT DRAWING NUMBER

**THE CITY OF WINNIPEG**  
 WATER AND WASTE DEPARTMENT  
 ENGINEERING DIVISION  
 2013 WATER RENEWALS  
**BERTHA STREET**  
 MARKET AVENUE TO JAMES AVENUE  
 SHEET 5 OF 10  
 CITY DRAWING NUMBER D-13205