

WATER SERVICE INFORMATION					
ADDRESS	SIZE (mm) MATERIAL (STREET)	SIZE (mm) MATERIAL (PROP.)	SHORT & LONG MEASUREMENT	CORP. LOCATION	REMARKS
827 CLIFTON ST RESIDENTIAL	20 COPPER	20 COPPER	6.8 SNL HSE	OPP S/C	RECONNECT SERVICE
828 CLIFTON ST RESIDENTIAL	20 COPPER	20 COPPER	3.00>NNL ST. MATTHEWS	OPP S/C	RECONNECT SERVICE
831 CLIFTON ST RESIDENTIAL	20 COPPER	20 COPPER	10.3>NNL ST. MATTHEWS	OPP S/C	RECONNECT SERVICE
832 CLIFTON ST RESIDENTIAL	20 COPPER	20 COPPER	7.1 SNL HSE	0.3 N OF S/C	RECONNECT SERVICE
834 CLIFTON ST RESIDENTIAL	20 COPPER	20 COPPER	16.6>NNL ST. MATTHEWS	OPP S/C	RECONNECT SERVICE
835 CLIFTON ST RESIDENTIAL	20 COPPER	20 COPPER	22.5>NNL ST. MATTHEWS	OPP S/C	RECONNECT SERVICE
838 CLIFTON ST RESIDENTIAL	20 COPPER	20 COPPER	6.8 SNL HSE	0.9 N OF S/C	RECONNECT SERVICE
839 CLIFTON ST RESIDENTIAL	20 COPPER	20 COPPER	31.7>NNL ST. MATTHEWS	OPP S/C	RECONNECT SERVICE
842 CLIFTON ST RESIDENTIAL	20 COPPER	20 COPPER	6.2 SNL HSE	OPP S/C	RECONNECT SERVICE
843 CLIFTON ST RESIDENTIAL	20 COPPER	20 COPPER	30.6>NNL ST. MATTHEWS	OPP S/C	RECONNECT SERVICE
846 CLIFTON ST RESIDENTIAL	20 COPPER	20 COPPER	2.6 SNL HSE	OPP S/C	RECONNECT SERVICE
847 CLIFTON ST RESIDENTIAL	20 COPPER	20 COPPER	49.0>NNL ST. MATTHEWS	OPP S/C	RECONNECT SERVICE
848 CLIFTON ST RESIDENTIAL	20 COPPER	20 COPPER	8.4 SNL HSE	0.2 S OF S/C	RECONNECT SERVICE
851 CLIFTON ST RESIDENTIAL	20 COPPER	20 COPPER	43.1>NNL ST. MATTHEWS	OPP S/C	RECONNECT SERVICE
852 CLIFTON ST RESIDENTIAL	20 COPPER	20 COPPER	2.3 SNL HSE	OPP S/C	RECONNECT SERVICE
853 CLIFTON ST RESIDENTIAL	20 COPPER	20 COPPER	63.0>NNL ST. MATTHEWS	OPP S/C	RECONNECT SERVICE
854 CLIFTON ST RESIDENTIAL	20 COPPER	20 COPPER	2.3 SNL HSE	1.4 S OF S/C	RECONNECT SERVICE
855 CLIFTON ST RESIDENTIAL	20 COPPER	20 COPPER	61.6>NNL ST. MATTHEWS	OPP S/C	RECONNECT SERVICE
856 CLIFTON ST RESIDENTIAL	20 COPPER	20 COPPER	2.8 SNL HSE	OPP S/C	RECONNECT SERVICE
857 CLIFTON ST RESIDENTIAL	20 COPPER	20 COPPER	76.3>NNL ST. MATTHEWS	OPP S/C	RECONNECT SERVICE
858 CLIFTON ST RESIDENTIAL	20 COPPER	20 COPPER	6.5 SNL HSE	0.4 N OF S/C	RECONNECT SERVICE
859 CLIFTON ST RESIDENTIAL	20 COPPER	20 COPPER	71.0>NNL ST. MATTHEWS	OPP S/C	RECONNECT SERVICE
860 CLIFTON ST RESIDENTIAL	20 COPPER	20 COPPER	6.7 SNL HSE	0.6 N OF S/C	RECONNECT SERVICE
861 CLIFTON ST RESIDENTIAL	20 COPPER	20 COPPER	86.0>NNL ST. MATTHEWS	OPP S/C	RECONNECT SERVICE
862 CLIFTON ST RESIDENTIAL	20 COPPER	20 COPPER	6.3 SNL HSE	0.2 S OF S/C	RECONNECT SERVICE
863 CLIFTON ST RESIDENTIAL	20 COPPER	20 COPPER	84.4>NNL ST. MATTHEWS	OPP S/C	RECONNECT SERVICE
864 CLIFTON ST RESIDENTIAL	20 COPPER	20 COPPER	2.4 SNL HSE	1.4 N OF S/C	RECONNECT SERVICE
865 CLIFTON ST RESIDENTIAL	20 COPPER	20 COPPER	99.6>NNL ST. MATTHEWS	OPP S/C	RECONNECT SERVICE

*SERVICES TO BE RENEWED TO R. ALL OTHERS TO BE RECONNECTED

NOTE: CHAINAGES SHOWN ARE ALONG E. R. OF CLIFTON ST.

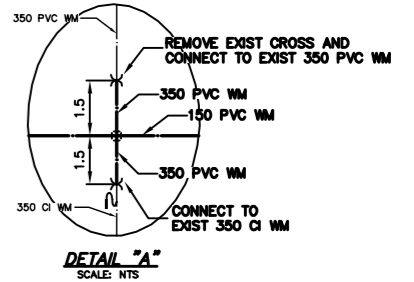
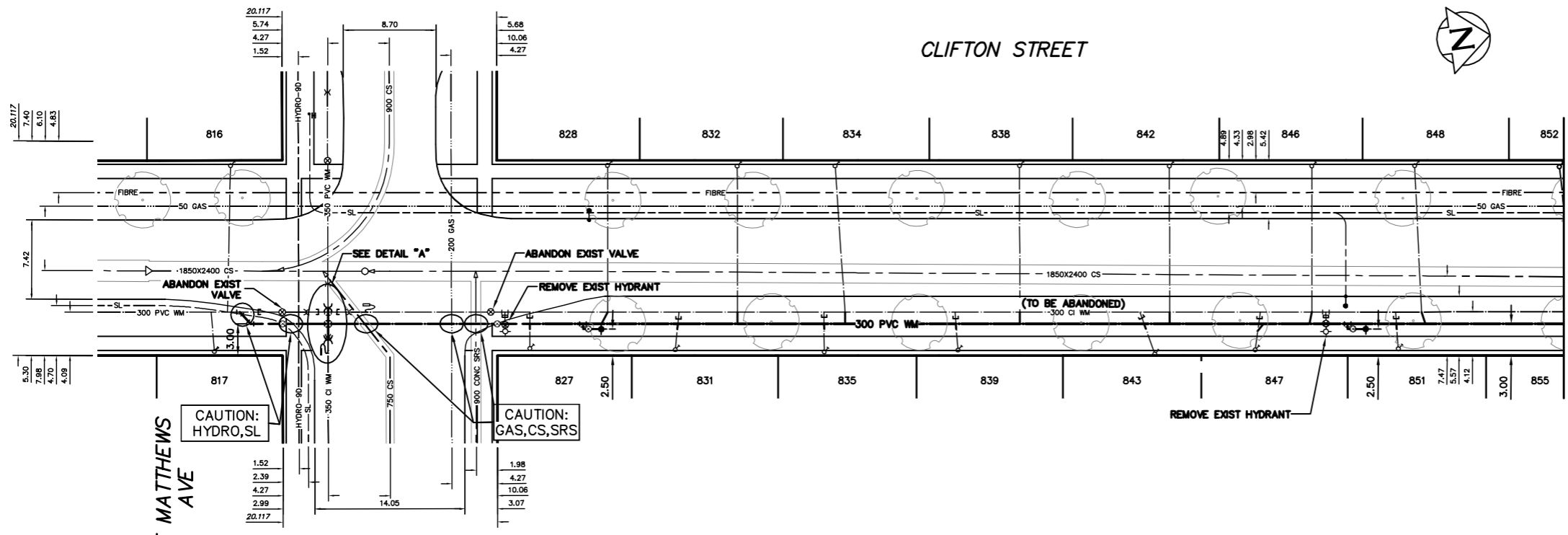

VALVES TO BE COUNTER-CLOCKWISE TO CLOSE (RED OPERATING NUT)

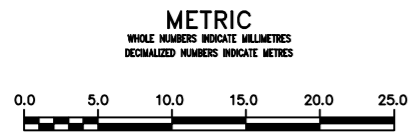

WARNING
IF POWER EQUIPMENT OR EXPLOSIVES ARE TO BE USED FOR EXCAVATION ON THIS PROJECT THE CONTRACTOR MUST:
1) NOTIFY THE GAS COMPANY OF THE PROPOSED LOCATION OF EXCAVATION.
2) TAKE PRECAUTION TO AVOID DAMAGE TO GAS COMPANY INSTALLATIONS.
SEE PROVINCIAL REGULATION 210/72 FOR DETAILS

LOCATION APPROVED UNDERGROUND STRUCTURES
SUPV. U/G STRUCTURES COMMITTEE DATE
NOTE:
LOCATION OF UNDERGROUND STRUCTURES AS SHOWN ARE BASED ON THE BEST INFORMATION AVAILABLE BUT NO GUARANTEE IS GIVEN THAT ALL EXISTING UTILITIES ARE SHOWN OR THAT THE GIVEN LOCATIONS ARE EXACT. CONFIRMATION OF EXISTENCE AND EXACT LOCATION OF ALL SERVICES MUST BE OBTAINED FROM THE INDIVIDUAL UTILITIES BEFORE PROCEEDING WITH CONSTRUCTION.

B.M. ELEV.	
CONSTRUCTION COMPLETION DATE: YYYY MM DD	
DESIGNED BY	MK
CHECKED BY	SC
DRAWN BY	CJH/RS
APPROVED BY	KZ
SCALE:	
HORIZONTAL	1:250
VERTICAL	1:50
RELEASED FOR CONSTRUCTION	K.R. ZUREK
DATE	2013 05 27
DATE	13-05-28
NO.	REVISIONS
DATE	BY
DATE	2013 05 27
PLOT DATE:	2013 05 28

ENGINEER'S SEAL
ORIGINAL SIGNED BY S.R.J. COURNOYER 13-05-27
CONSULTANT DRAWING NUMBER

THE CITY OF WINNIPEG
Winnipeg
WATER AND WASTE DEPARTMENT
ENGINEERING DIVISION
2013 WATER RENEWALS
CLIFTON STREET
ST MATTHEWS AVENUE TO
100 N OF ST MATTHEWS AVENUE
SHEET 6 OF 11
CITY DRAWING NUMBER
D-13248