

"CAUTION - HYDRO, MTS, GAS, FIBRE OPTIC AND TELEPHONE BURIED CABLES" ON THE CONSTRUCTION SITE

WATER CONNECTION DATA table with columns: ADDRESS, SIZE & TYPE, DISTANCE TO PL, STOP COCK LOCATION, CORPORATION COCK LOCATION, COMMENTS. Lists various commercial addresses along Higgins Avenue and their water service details.

- CONSTRUCTION NOTES: 1. WATERMAIN TO HAVE 2.5m COVER FROM CENTRELINE OF ROAD. 2. ALL CURB REPLACEMENT TO MATCH EXISTING CURB. 3. ALL EXISTING WATERMANS AT CONNECTION LOCATIONS ARE TO HAVE INVERTS VERIFIED PRIOR TO CONSTRUCTION. 4. INSTALL ALL HYDRANTS WITH FLANGE ELEVATION FROM 50mm TO 150mm ABOVE FINISHED GRADE. 5. SALVAGE ALL EXISTING HYDRANT ASSEMBLIES AND VALVES WHEN DIRECTED BY THE CONTRACT ADMINISTRATOR AND RETURN TO THE CITY YARD. ABANDON THE REMAINING VALVES (AND/OR VALVE BOXES) AND HYDRANT ASSEMBLIES. 6. INSTALL WATERMAIN BY TRENCHLESS METHODS UNDER ALL PAVEMENTS, TREES, LIGHT STANDARDS, AND OTHER APPURTENANCES. 7. LOCATION OF ALL SERVICES TO BE CONFIRMED IN FIELD. 8. RENEW ALL LEAD WATER CONNECTIONS UP TO THE PROPERTY LINE WITH 19mm COPPER WATER CONNECTIONS UNLESS RENEWAL SIZE IS OTHERWISE NOTED. 9. ALL VALVES SHALL TURN COUNTER CLOCKWISE TO CLOSE WITH RED OPERATING NUT. 10. ALL BACKFILL UNDER AND WITHIN 1.0m OF PAVEMENT OR SIDEWALK SHALL BE CLASS 3. 11. ALL BACKFILL UNDER BOULEVARD SHALL BE CLASS 5. 12. ABANDON SERVICES NO LONGER IN USE WHERE DIRECTED BY CONTRACT ADMINISTRATOR. 13. CONTRACTOR TO NOTIFY BUSINESSES AND RESIDENTS A MINIMUM OF 24 HOURS PRIOR TO ANY DISRUPTION TO WATER SERVICE.

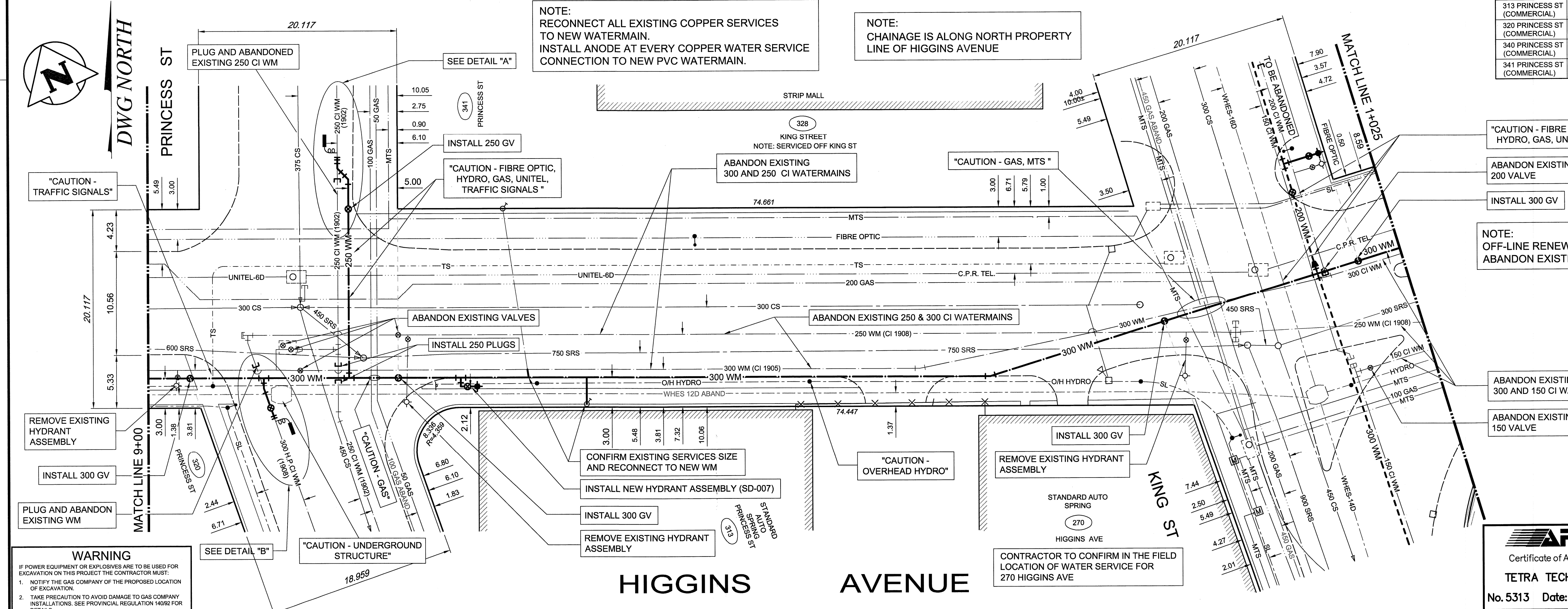

WARNING: IF POWER EQUIPMENT OR EXPLOSIVES ARE TO BE USED FOR EXCAVATION ON THIS PROJECT THE CONTRACTOR MUST: 1. NOTIFY THE GAS COMPANY OF THE PROPOSED LOCATION OF EXCAVATION. 2. TAKE PRECAUTION TO AVOID DAMAGE TO GAS COMPANY INSTALLATIONS. SEE PROVINCIAL REGULATION 1409/92 FOR DETAILS.

Legend-Plan table showing symbols for existing and proposed watermain, sewer, and utility lines, including dimensions and material types.

LOCATION APPROVED UNDERGROUND STRUCTURES: SUPV. U/G STRUCTURES COMMITTEE DATE: ...

CITY OF WINNIPEG B.M. ELEV. table with columns for stationing and elevation.

TETRA TECH logo and project information including designer GWC, checker KJM, and dates.



CITY OF WINNIPEG WATER AND WASTE DEPARTMENT logo and project details: 2013 WATERMAIN RENEWALS - CONTRACT 8, HIGGINS AVENUE 76m EAST OF STANLEY STREET TO 5m EAST OF KING STREET, CITY DRAWING NUMBER D-13223, SHEET 2 OF 10, C0002.