

REFERENCE NOTES

- A. PAVEMENT DIMENSIONS ARE TO BACK OF CURB
- B. BASELINE IS CENTRE LINE RIGHT-OF-WAY
- C. PROPERTY LINES OBTAINED FROM CITY OF WINNIPEG L.B.I.S., AND NO SCALE FACTOR WAS APPLIED
- D. REFER TO AECOM FIELD BOOK NO. 4794

CONSTRUCTION NOTES

1. REMOVE EXISTING CONCRETE PAVEMENT AND CONSTRUCT NEW 150mm REINFORCED CONCRETE PAVEMENT
2. REMOVE EXISTING CONCRETE PAVEMENT AND CONSTRUCT NEW 200mm CONCRETE PAVEMENT WITH 50mm ASPHALTIC PAVEMENT (TYPE 1A)
3. PLACE CURING COMPOUND IN PAVEMENT JOINTS
4. CONSTRUCT NEW BARRIER CURB (180mm HT. SEPARATE)
5. CONSTRUCT NEW MODIFIED BARRIER CURB (180mm HT. INTEGRAL)
6. CONSTRUCT NEW CURB RAMP (10mm HT. INTEGRAL)
7. RENEW EXISTING 100mm CONCRETE SIDEWALK
8. INSTALL DETECTABLE WARNING SURFACE TILE
9. INSTALL NEW CURB AND GUTTER INLET c/w CATCH BASIN (SD-024) AND CONNECT TO EXISTING 350SRS
10. REMOVE EXISTING FRAME AND COVER AND PLACE NEW FRAME AND SOLID COVER (AP-005)
11. REMOVE EXISTING CURB INLET AND CATCH BASIN
12. REMOVE EXISTING CURB INLET AND CATCH BASIN AND ABANDON EXISTING LEAD
13. INSTALL 150mm SUBDRAIN
14. ADJUST EXISTING MANHOLE/CATCH BASIN TO GRADE
15. INSTALL NEW CAST IRON RISER RING
16. ADJUST EXISTING WATER VALVE TO GRADE
17. ADJUST EXISTING CURB STOP

MATCHLINE 0+130

MATCHLINE 0+260

PLACE CURING COMPOUND IN PAVEMENT JOINTS

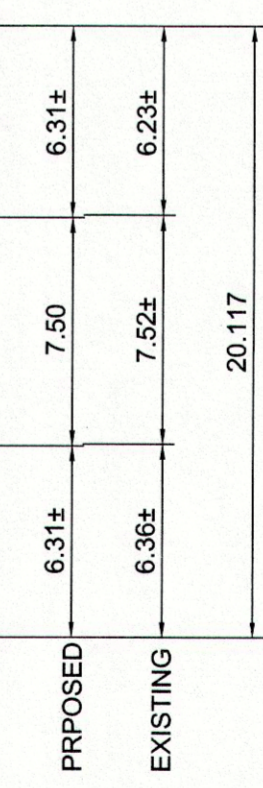
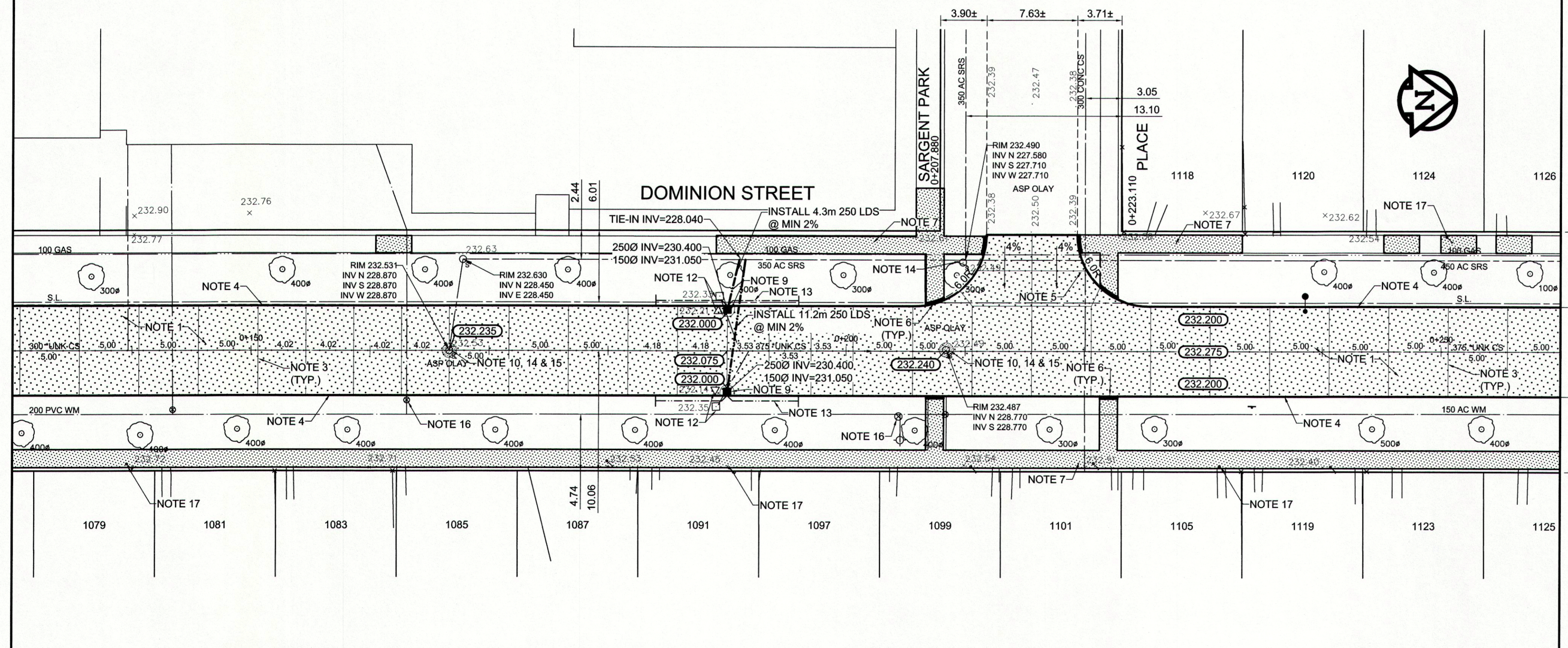

AECOM
Certificate of Authorization
AECOM Canada Ltd.
No. 4671 Date: May 2013

METRIC
WHOLE NUMBERS INDICATE MILLIMETRES
DECIMALIZED NUMBERS INDICATE METRES

EXISTING	LEGEND - PLAN	PROPOSED	EXISTING	LEGEND - PLAN	PROPOSED	EXISTING	LEGEND - PROFILE	PROPOSED
	WATERMAIN			HYDRO			C PROFILE	
	HYDRANT			M.T.S.			NORTH/WEST GUTTER	
	VALVE			CONCRETE			SOUTH/EAST GUTTER	
	LAND DRAINAGE SEWER			ASPHALT			N/W PROPERTY LINE	
	WASTEWATER SEWER			PROPERTY LINE			S/E PROPERTY LINE	
	MANHOLE			SURVEY BAR				
	CATCH BASIN			ELEVATION				
	CURB INLET			TREE				
	JUNCTIONS			SIDEWALK RAMP				
	CULVERT			CONCRETE SIDEWALK				
	GAS			FENCE				

LOCATION APPROVED UNDERGROUND STRUCTURES

SUPV. U/G STRUCTURES COMMITTEE DATE

NOTE:
LOCATION OF UNDERGROUND STRUCTURES AS SHOWN ARE BASED ON THE BEST INFORMATION AVAILABLE BUT NO GUARANTEE IS GIVEN THAT ALL EXISTING UTILITIES ARE SHOWN OR THAT THE GIVEN LOCATIONS ARE EXACT. CONFIRMATION OF EXISTENCE AND EXACT LOCATION OF ALL SERVICES MUST BE OBTAINED FROM THE INDIVIDUAL UTILITIES BEFORE PROCEEDING WITH CONSTRUCTION.

NO.	REVISIONS	DATE	BY
0	ISSUED FOR TENDER	05/30/2013	BC
A	ISSUED FOR REVIEW	05/17/2013	BC

AECOM		ENGINEER'S SEAL	
DESIGNED BY	BC	CHECKED BY	KWR
DRAWN BY	SS	APPROVED BY	
HOR. SCALE:	1:250	RELEASED FOR CONSTRUCTION BY:	
VERTICAL:	1:10	DATE	MAY 2013

PROVINCE OF MANITOBA
REGISTERED PROFESSIONAL ENGINEER
K.W. RAE
Date: May 2013

THE CITY OF WINNIPEG
PUBLIC WORKS DEPARTMENT
ENGINEERING DIVISION

2013 LOCAL STREET RENEWAL PROGRAM

DOMINION ST. - WELLINGTON AVE. TO SARGENT AVE.
PAVEMENT RECONSTRUCTION
STATION 0+130 TO STATION 0+260

CITY DRAWING NUMBER
SHEET 11 OF 16

CONSULTANT DRAWING NO. CT11