

TYPICAL SECTION

SCALE HOR. 1:150
VER. 1:50

CONSTRUCTION SCOPE OF WORK

- CONCRETE PAVEMENT RENEWALS (SLAB, JOINT, ISOLATIONS)
- MILL EXISTING LIP CURB
- CONSTRUCTION OF NEW BARRIER CURB
- PLACEMENT OF ASPHALT OVERLAY
- SIDEWALK RENEWAL

NOTES:

1. PAVEMENT DIMENSIONS ARE TO BACK OF CURB.
2. PROPERTY LINES OBTAINED FROM CITY OF WINNIPEG. NO SCALE FACTOR WAS APPLIED.
3. ALL SIDEWALK, CURB, AND CONCRETE REPAIRS TO BE MARKED OUT IN FIELD BY CONTRACT ADMINISTRATOR.
4. ALL ADJUSTMENTS FOR CATCHBASINS, MANHOLES, VALVES & INLETS TO BE MARKED IN FIELD BY CONTRACT ADMINISTRATOR.
5. PAVEMENT REPAIRS SHOWN ARE ONLY A REPRESENTATIVE APPROXIMATION OF THE TENDERED QUANTITIES.
6. ASPHALT TIE-INS ON APPROACHES TO BE DETERMINED IN FIELD BY THE CONTRACT ADMINISTRATOR.
7. ASPHALT GRADES TO BE MARKED IN FIELD BY THE CONTRACT ADMINISTRATOR.

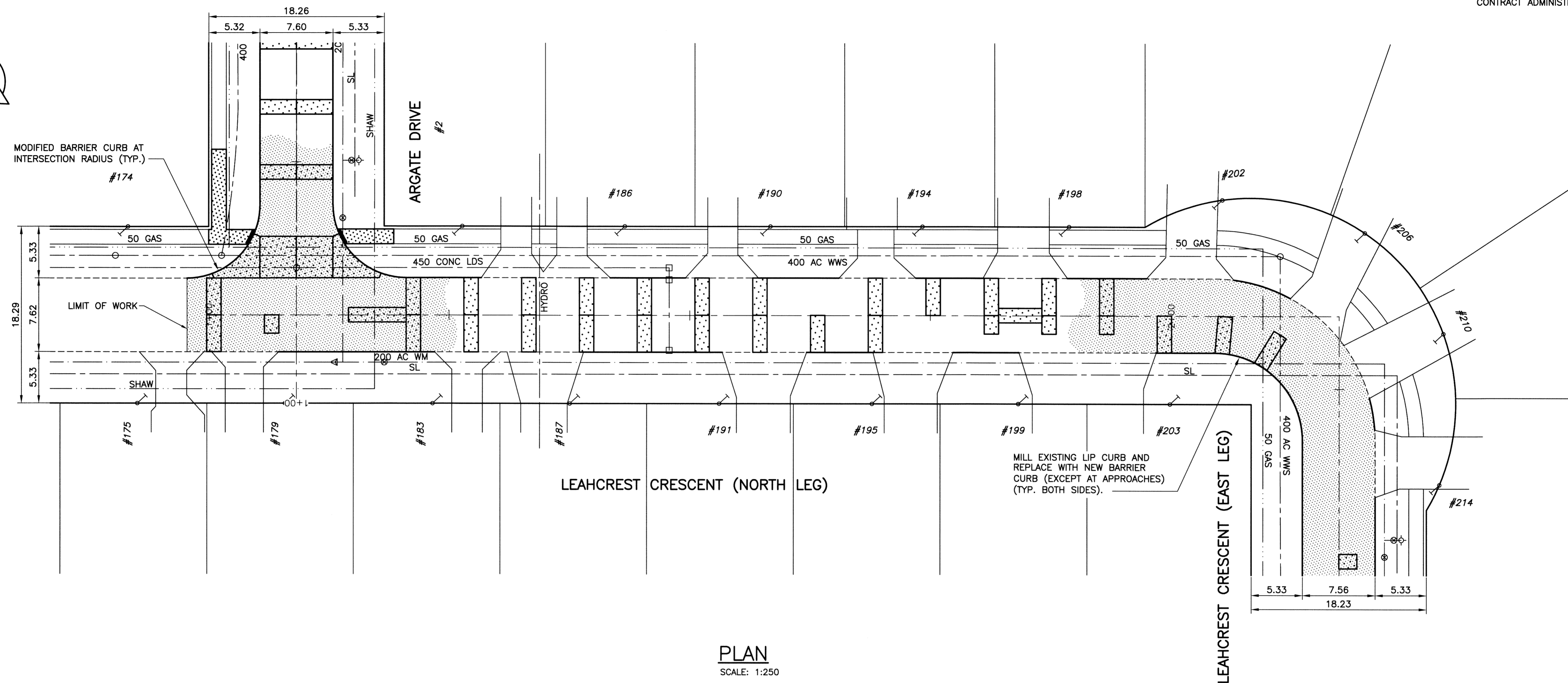
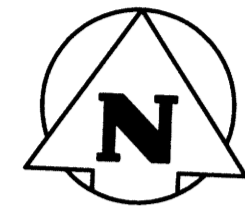

PLAN

SCALE: 1:250

WARNING
NOTIFY THE GAS COMPANY OF THE PROPOSED LOCATION OF EXCAVATION. TAKE PRECAUTION TO AVOID DAMAGE TO GAS COMPANY INSTALLATIONS. SEE PROVINCIAL REGULATION 210/72 FOR DETAILS.

METRIC
WHOLE NUMBERS INDICATE MILLIMETRES
DECIMALIZED NUMBERS INDICATE METRES

PROPERTY LIMITS DELINEATION
DELINEATION OF PROPERTY LIMITS AS SHOWN ON THIS DWG DOES NOT REPRESENT A "LEGAL SURVEY". KGS GROUP MAKES NO REPRESENTATION OR WARRANTY AS TO THE ACCURACY OF PROPERTY LIMITS DELINEATED ON THIS DWG, NOR ON THE DIMENSIONAL ACCURACY OF DWG FEATURES RELATIVE TO THOSE PROPERTY LIMITS.

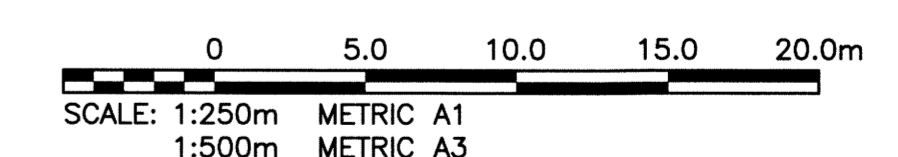

300 LDS	LAND DRAINAGE SEWER	300 LDS							
250 WWS	WASTE WATER SEWER	250 WWS	+	TEST HOLE					
	GAS		—	GUY WIRE					
	HYDRO		—	LIGHT STANDARD					
	M.T.S.		—	BACK OF CURB					
150 WM	WATERMAIN	150 WM	—	CONCRETE					
	HYDRANT		+	ASPHALT					
	VALVE		+	SIDEWALK	X—X	Q PROFILE			
	MANHOLE		○	PROPERTY LINE	□—□	N/W LANE EDGE			
	CATCH BASIN		□	SURVEY BAR	○—○	S/E LANE EDGE			
	CURB INLET		▽	GEODETIC BENCHMARK	⊕	PARKING/DRIVEWAY			
	POLES		•	ELEVATION	(32.231)	WINDOW/DOOR SILL			
EXISTING	LEGEND—PLAN	PROPOSED	EXISTING	LEGEND—PLAN	PROPOSED	EXISTING	LEGEND—PROFILE	PROPOSED	

LOCATION APPROVED UNDERGROUND STRUCTURES

SUPV. U/G STRUCTURES COMMITTEE DATE

NOTE:
LOCATION OF UNDERGROUND STRUCTURES AS SHOWN ARE BASED ON THE BEST INFORMATION AVAILABLE BUT NO GUARANTEE IS GIVEN THAT ALL EXISTING UTILITIES ARE SHOWN OR THAT THE GIVEN LOCATIONS ARE EXACT. CONFIRMATION OF EXISTENCE AND EXACT LOCATION OF ALL SERVICES MUST BE OBTAINED FROM THE INDIVIDUAL UTILITIES BEFORE PROCEEDING WITH CONSTRUCTION.

B.M. ELEV.	15-13	S.E. Cor. Jefferson Ave. & Argate Dr., Tbl. in W. Conc. foundation No. 1825 Jefferson Ave., 3.3m N. & 0.1m below stucco of S.W. Cor. of dwelling.
ISSUED FOR TENDER	13/06/04	BY: B.J.M.
NO. REVISIONS	DATE	BY: DATE

DESIGNED BY	BJM	CHECKED BY	CR
DRAWN BY	GEL	APPROVED BY	
HOR. SCALE:	1:250	RELEASED FOR CONSTRUCTION:	
VERTICAL:	—	DATE	13/05/13

ENGINEER'S SEAL

B.J. MIKOLAYENKO
REGISTERED PROFESSIONAL ENGINEER
Member 24888
JUNE 4/2013

CONSULTANT DRAWING NO.
13-0107-004-C10

THE CITY OF WINNIPEG
PUBLIC WORKS DEPARTMENT
TRANSPORTATION ENGINEERING DIVISION

PROJECT TITLE
2013 LOCAL STREET REHABILITATION PROGRAM

LEAHCREST CRESCENT
ARGATE DR TO ANGLIA AVE
ARGATE DR TO LEAHCREST CR (E LEG)

SHEET OF
10 OF **16**

COMPUTER FILE NAME
13-0107-004_CALL

DRAWING NUMBER
C10