

TYPICAL SECTION

SCALE HOR. 1:150
VER. 1:50

CONSTRUCTION SCOPE OF WORK

- PLANING EXISTING ASPHALT SURFACE
- FULL BARRIER CURB RENEWAL
- CONCRETE PAVEMENT RENEWALS (SLAB, JOINT, ISOLATIONS)
- SIDEWALK RENEWAL
- BUS STOP SIDEWALK IMPROVEMENTS
- PLACEMENT OF ASPHALT OVERLAY

NOTES:

1. PAVEMENT DIMENSIONS ARE TO BACK OF CURB.
2. PROPERTY LINES OBTAINED FROM CITY OF WINNIPEG. NO SCALE FACTOR WAS APPLIED.
3. ALL SIDEWALK, CURB, AND CONCRETE REPAIRS TO BE MARKED OUT IN FIELD BY CONTRACT ADMINISTRATOR.
4. ALL ADJUSTMENTS FOR CATCHBASINS, MANHOLES, VALVES & INLETS TO BE MARKED IN FIELD BY CONTRACT ADMINISTRATOR.
5. PAVEMENT REPAIRS SHOWN ARE ONLY A REPRESENTATIVE APPROXIMATION OF THE TENDERED QUANTITIES.
6. ASPHALT TIE-INS ON APPROACHES TO BE DETERMINED IN FIELD BY THE CONTRACT ADMINISTRATOR.
7. ASPHALT GRADES TO BE MARKED IN FIELD BY THE CONTRACT ADMINISTRATOR.

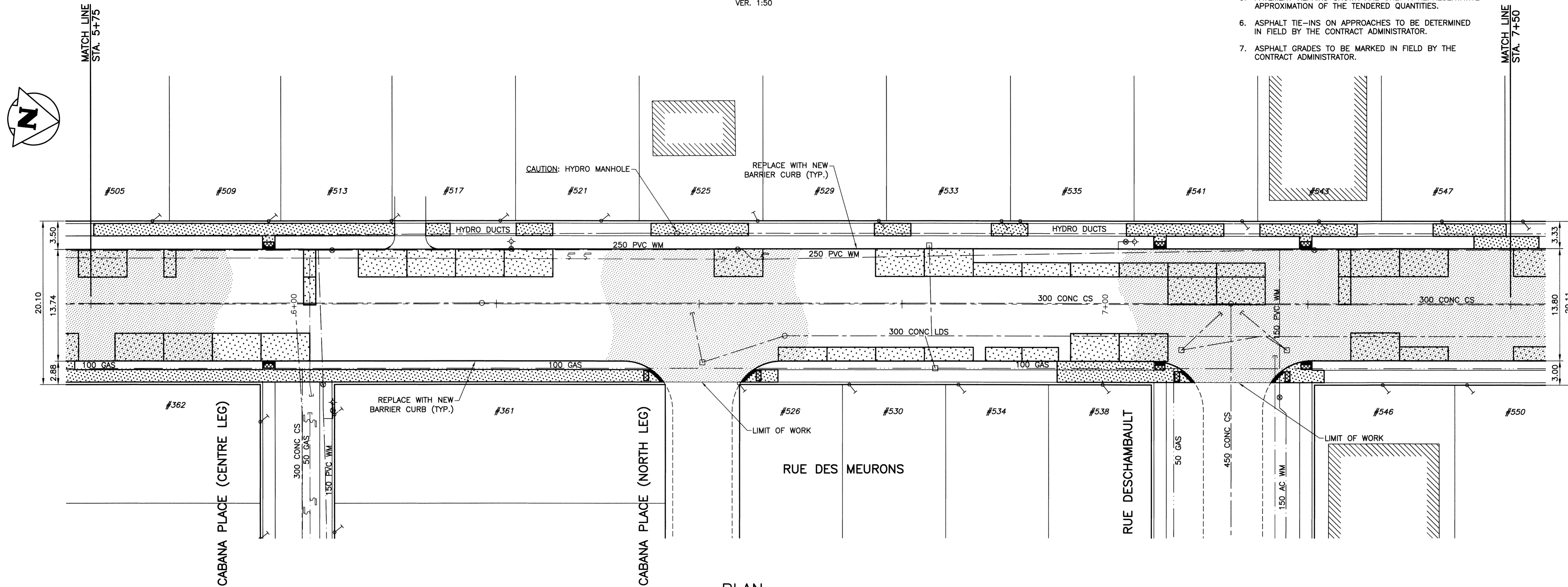

PLAN

SCALE: 1:250

WARNING
NOTIFY THE GAS COMPANY OF THE PROPOSED LOCATION OF EXCAVATION. TAKE PRECAUTION TO AVOID DAMAGE TO GAS COMPANY INSTALLATIONS. SEE PROVINCIAL REGULATION 210/72 FOR DETAILS.

METRIC
WHOLE NUMBERS INDICATE MILLIMETRES
DECIMALIZED NUMBERS INDICATE METRES

PROPERTY LIMITS DELINEATION
DELINEATION OF PROPERTY LIMITS AS SHOWN ON THIS DWG DOES NOT REPRESENT A "LEGAL SURVEY". KGS GROUP MAKES NO REPRESENTATION OR WARRANTY AS TO THE ACCURACY OF PROPERTY LIMITS DELINEATED ON THIS DWG, NOR ON THE DIMENSIONAL ACCURACY OF DWG FEATURES RELATIVE TO THOSE PROPERTY LIMITS.

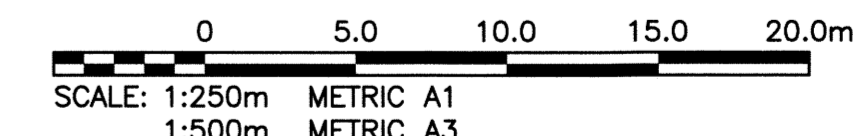

LOCATION APPROVED UNDERGROUND STRUCTURES		B.M. ELEV. 3.4-11 231.413	S.E. Cor. of Rue Des Meurons & Hornel Ave., 10m. in W. Conc. wall of International Laboratories No. 490 Rue Des Meurons, 0.5m S. & 1.0m below back of N.W. Cor. of Bldg.
SUPV. U/G STRUCTURES COMMITTEE	DATE		
NOTE: LOCATION OF UNDERGROUND STRUCTURES AS SHOWN ARE BASED ON THE BEST INFORMATION AVAILABLE BUT NO GUARANTEE IS GIVEN THAT ALL EXISTING UTILITIES ARE SHOWN OR THAT THE GIVEN LOCATIONS ARE EXACT. CONFIRMATION OF EXISTENCE AND EXACT LOCATION OF ALL SERVICES MUST BE OBTAINED FROM THE INDIVIDUAL UTILITIES BEFORE PROCEEDING WITH CONSTRUCTION.			
0	ISSUED FOR TENDER	13/06/04	BY [Signature]
	NO. REVISIONS	DATE	BY

KGS GROUP CONSULTING ENGINEERS		ENGINEER'S SEAL	
DESIGNED BY	BJM	CHECKED BY	CR
DRAWN BY	GEL	APPROVED BY	
HOR. SCALE:	1:250	RELEASED FOR CONSTRUCTION:	
VERTICAL:	-	DATE	13/05/13
CONSULTANT DRAWING NO. 13-0107-004_D-3348-4		DATE	

THE CITY OF WINNIPEG PUBLIC WORKS DEPARTMENT TRANSPORTATION ENGINEERING DIVISION	
PROJECT TITLE 2013 LOCAL STREET REHABILITATION PROGRAM	SHEET OF 15 OF 16
RUE DES MEURONS	
BERTRAND ST TO DE LA CATHEDRALE	
STA 5+75 TO STA 7+50	
COMPUTER FILE NAME 13-0107-004_CALL	CITY DRAWING NUMBER D-3348-4

P:\Projects\2013\13-0107-004\DocControl\ToBasissue\DWG\13-0107-004_D-3348-4-Rev0.dwg - Tab: D-3348-4 - Plotted By: DCherchie 06/04/2013 [Tue 1:31pm] PLOT 1:1 A-1