

File Name: P:\Projects\2013\13-0107-005\Doc\Control\ToBeIssued\DWG\13-0107-005_P-3347-03-Rev.0.dwg - Tab: P-3347-03 Plotted By: DDeroche 13/05/20 [Thu 11:36am]

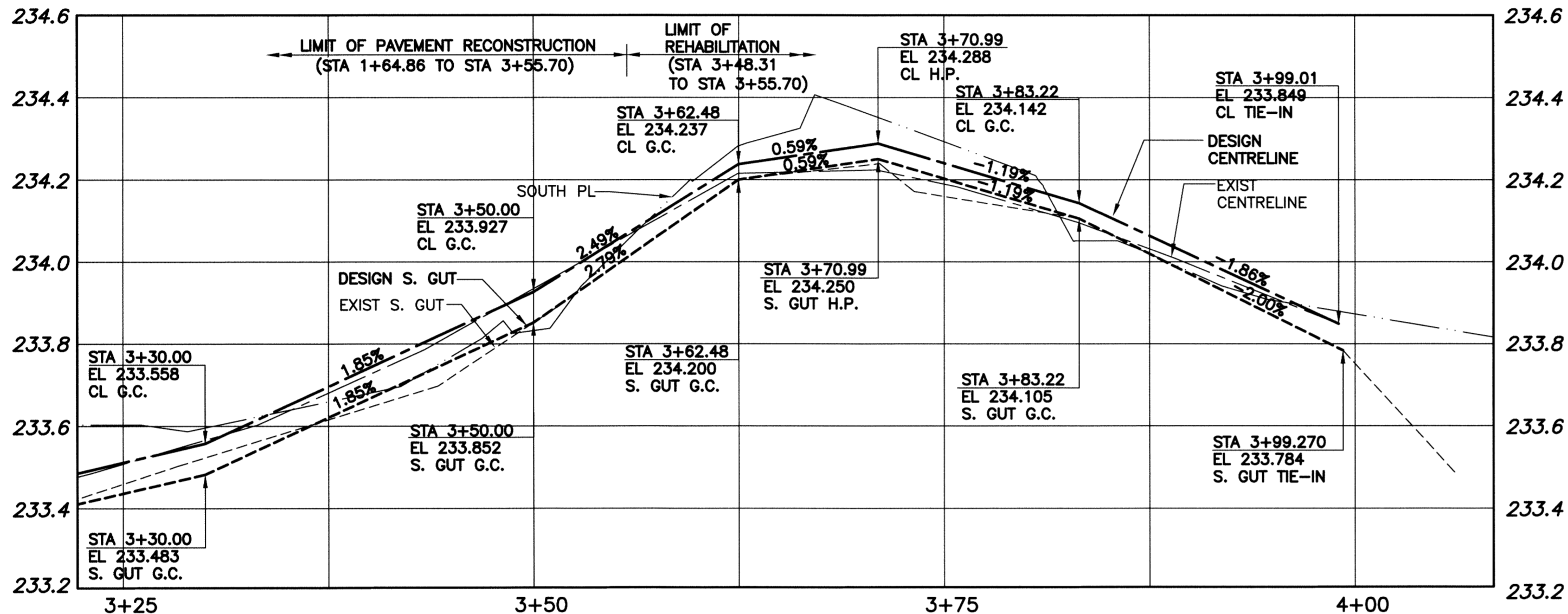

MATCH LINE
STA 3+25

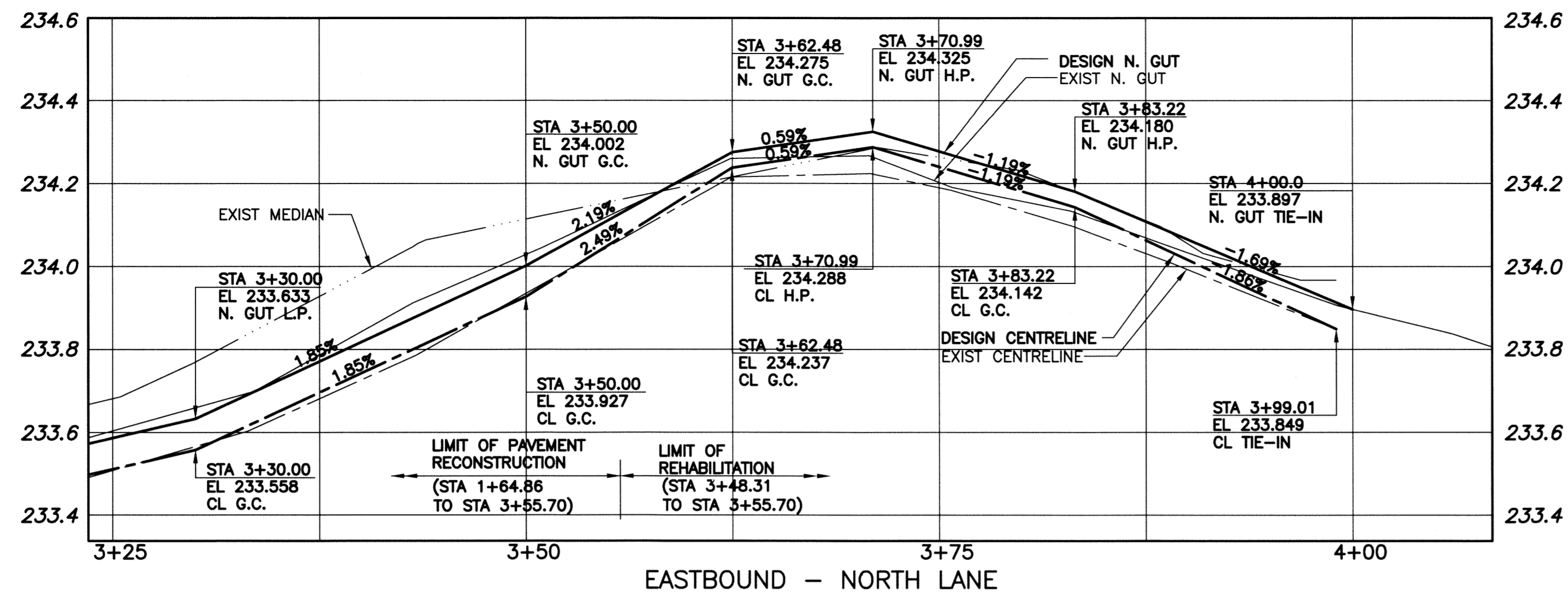
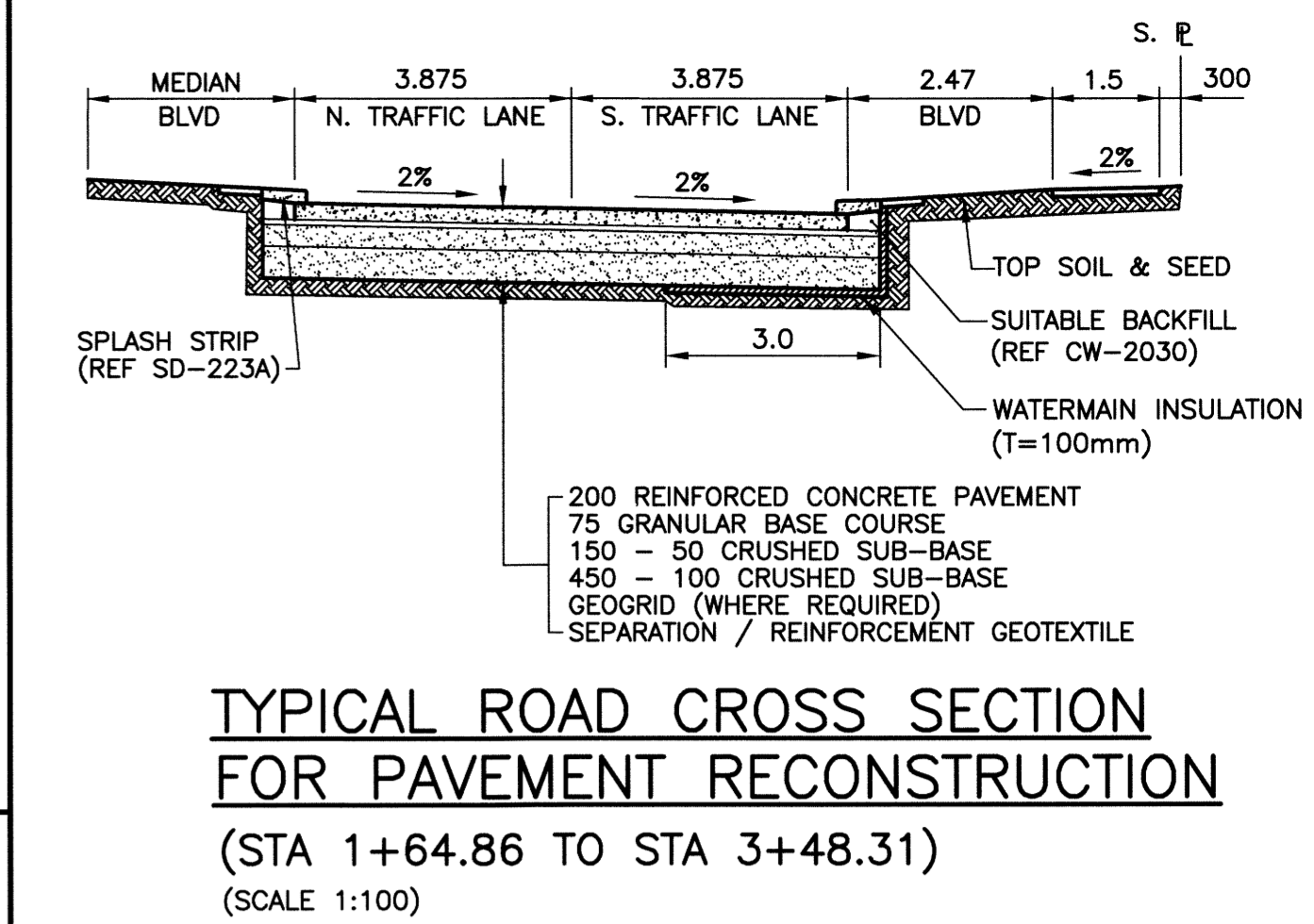
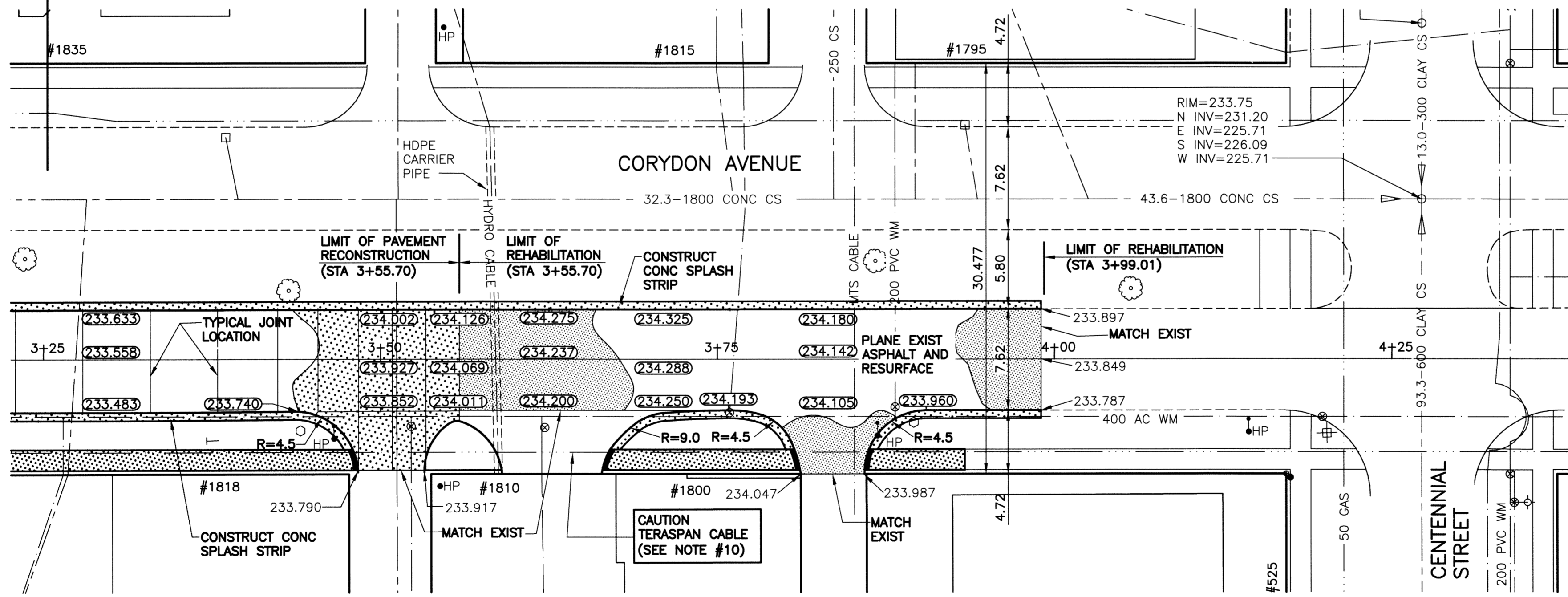

- NOTE:**
- STATION CHAINAGE IS BASED ON CENTER LINE OF EAST BOUND CORYDON AVENUE.
 - ADJUST NEW MANHOLE AND CATCH BASIN RIMS TO NEW GRADES.
 - ISOLATE MANHOLES AND CATCH BASINS IN ACCORDANCE WITH (COW SD-228C).
 - PLUG SUB DRAINS AT TERMINAL ENDS.
 - RE-GRADE EXISTING PRIVATE SIDEWALKS AS DIRECTED BY THE CONTRACT ADMINISTRATOR.
 - ISOLATE ALL POLES, BASES AND PILES WITHIN SIDEWALK (SEE COW SD-228C).
 - AVOID DAMAGE TO EXISTING TREES WITHIN THE LIMITS OF CONSTRUCTION.
 - ALL PAVEMENT MEASUREMENTS ARE TO BACK OF CURB ASSUMING A HYPOTHETICAL BARRIER CURB
 - CAUTION: THE TERASPAN CABLE IS LOCATED ALONG THE ENTIRE LENGTH OF THE PROJECT AND WITHIN 300mm OF THE GROUND/PAVEMENT SURFACE.
 - CONTACT TERASPAN TO LOWER FIBRE OPTIC CABLE WHERE REQUIRED.
 - INSTALL 100mm THICK APPROVED INSULATION BETWEEN THE CATCH BASINS AND EXISTING 400 AC WATERMAIN.
 - INSTALL 100mm THICK INSULATION AS SHOWN ON THE (TYPICAL ROAD CROSS SECTION FOR PAVEMENT RECONSTRUCTION). INSTALL INSULATION AS CLOSE TO THE SOUTH WALL OF THE ROADWAY EXCAVATION AS POSSIBLE.
 - ADJUST VALVES AS REQUIRED.
 - EXCAVATION PERMITS REQUIRED PRIOR TO CONSTRUCTION.
 - TRAFFIC SIGNALS CLEARANCE REQUIRED (PH 204-986-4193).
 - CURING COMPOUND IN SAW CUT JOINTS TO BE APPLIED OVER WEST HALF OF RECONSTRUCTION (STA. 1+65.0 TO STA. 2+60.0). NO CURING COMPOUND (SLAB OR JOINT) TO BE APPLIED FROM STA 3+47.0 TO STA 3+55.0
 - INSTALL SIDEWALK DETECTABLE WARNING TILES ON PUBLIC SIDEWALKS AT ROAD CROSSINGS. ORIENT SIDEWALK DETECTABLE WARNING TILES SO THAT EDGES PARALLEL WITH WALKING DIRECTION ARE ALIGNED WITH SIDEWALK RAMP ON OPPOSITE SIDE OF STREET AT ANY PARTICULAR PEDESTRIAN CROSSING.

PROPERTY LIMITS DELINEATION
 DELINEATION OF PROPERTY LIMITS AS SHOWN ON THIS DWG DOES NOT REPRESENT A "LEGAL SURVEY". KGS GROUP MAKES NO REPRESENTATION OR WARRANTY AS TO THE ACCURACY OF PROPERTY LIMITS DELINEATED ON THIS DWG, NOR ON THE DIMENSIONAL ACCURACY OF DWG FEATURES RELATIVE TO THOSE PROPERTY LIMITS.

WARNING
 1. NOTIFY THE GAS COMPANY OF THE PROPOSED LOCATION OF EXCAVATION.
 2. TAKE PRECAUTION TO AVOID DAMAGE TO GAS COMPANY INSTALLATIONS.
 3. SEE PROVINCIAL REGULATION 210/72 FOR DETAILS.

METRIC
 WHOLE NUMBERS INDICATE MILLIMETRES
 DECIMALIZED NUMBERS INDICATE METRES

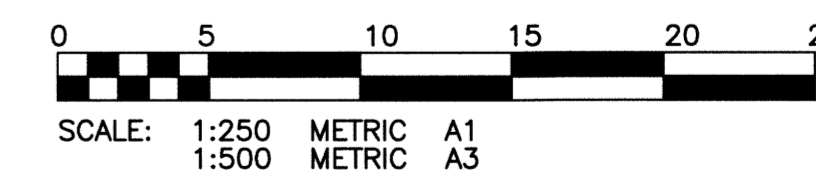

300 LBS	LAND DRAINAGE SEWER	300 LBS	TERASPAN CABLE		
250 WWS	WASTE WATER SEWER	250 WWS	TEST HOLE		
	GAS		GUY WIRE		
	HYDRO		LIGHT STANDARD		
	M.T.S.		BACK OF CURB		
150 WM	WATERMAIN	150 WM	CONCRETE		
	HYDRANT		ASPHALT		
	VALVE		SIDEWALK		
	MANHOLE		PROPERTY LINE		
	CATCH BASIN		SURVEY BAR		
	CURB INLET		GEODETIC BENCHMARK		
	POLES		ELEVATION	231.334	(32.231)
EXISTING	LEGEND-PLAN	PROPOSED	EXISTING	LEGEND-PLAN	PROPOSED

LOCATION APPROVED UNDERGROUND STRUCTURES		B.M. KGS BASE ELEV.	DWGS BASE ON C.S.R.S. NAD 83 SYSTEM UTM GRID.
SUPV. U/G STRUCTURES COMMITTEE	DATE		
NOTE: LOCATION OF UNDERGROUND STRUCTURES AS SHOWN ARE BASED ON THE BEST INFORMATION AVAILABLE BUT NO GUARANTEE IS GIVEN THAT ALL EXISTING UTILITIES ARE SHOWN OR THAT THE GIVEN LOCATIONS ARE EXACT. CONFIRMATION OF EXISTENCE AND EXACT LOCATION OF ALL SERVICES MUST BE OBTAINED FROM THE INDIVIDUAL UTILITIES BEFORE PROCEEDING WITH CONSTRUCTION.			
NO.	REVISIONS	DATE	BY
		13/05/20	

	DESIGNED BY	AKW	CHECKED BY	JDF
	DRAWN BY	DMW	APPROVED BY	CR
HOR. SCALE: 1:250		RELEASED FOR CONSTRUCTION:		
VERTICAL: 1:50		DATE		
CONSULTANT DRAWING NO.		13-0107-005		
THE CITY OF WINNIPEG PUBLIC WORKS DEPARTMENT TRANSPORTATION ENGINEERING DIVISION				
PROJECT TITLE CORYDON AVENUE EASTBOUND PAVEMENT RECONSTRUCTION/REHABILITATION				
KENASTON BLVD. TO CENTENNIAL ST. STA 3+25 TO STA 4+00				
SHEET		OF		
03		03		
COMPUTER FILE NAME				
CORYDON PLOT				
CITY DRAWING NUMBER				
P-3347-03				