

6 TRANSITION SLAB - CONCRETE TO ASPHALT ROADWAY
87, 91 | 106 SCALE HORZ: 1:50 VERT: 1:25

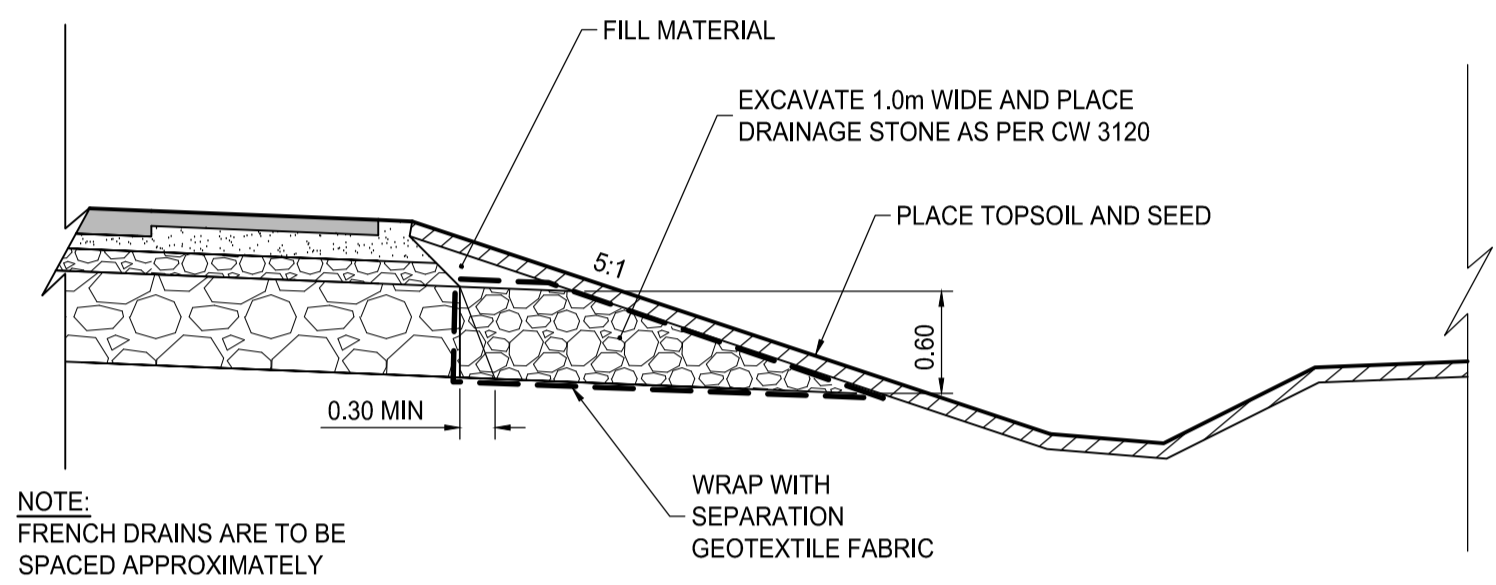

8 FRENCH DRAIN
87, 89, 90, 101 | 106 SCALE HORZ: 1:100 VERT: 1:50

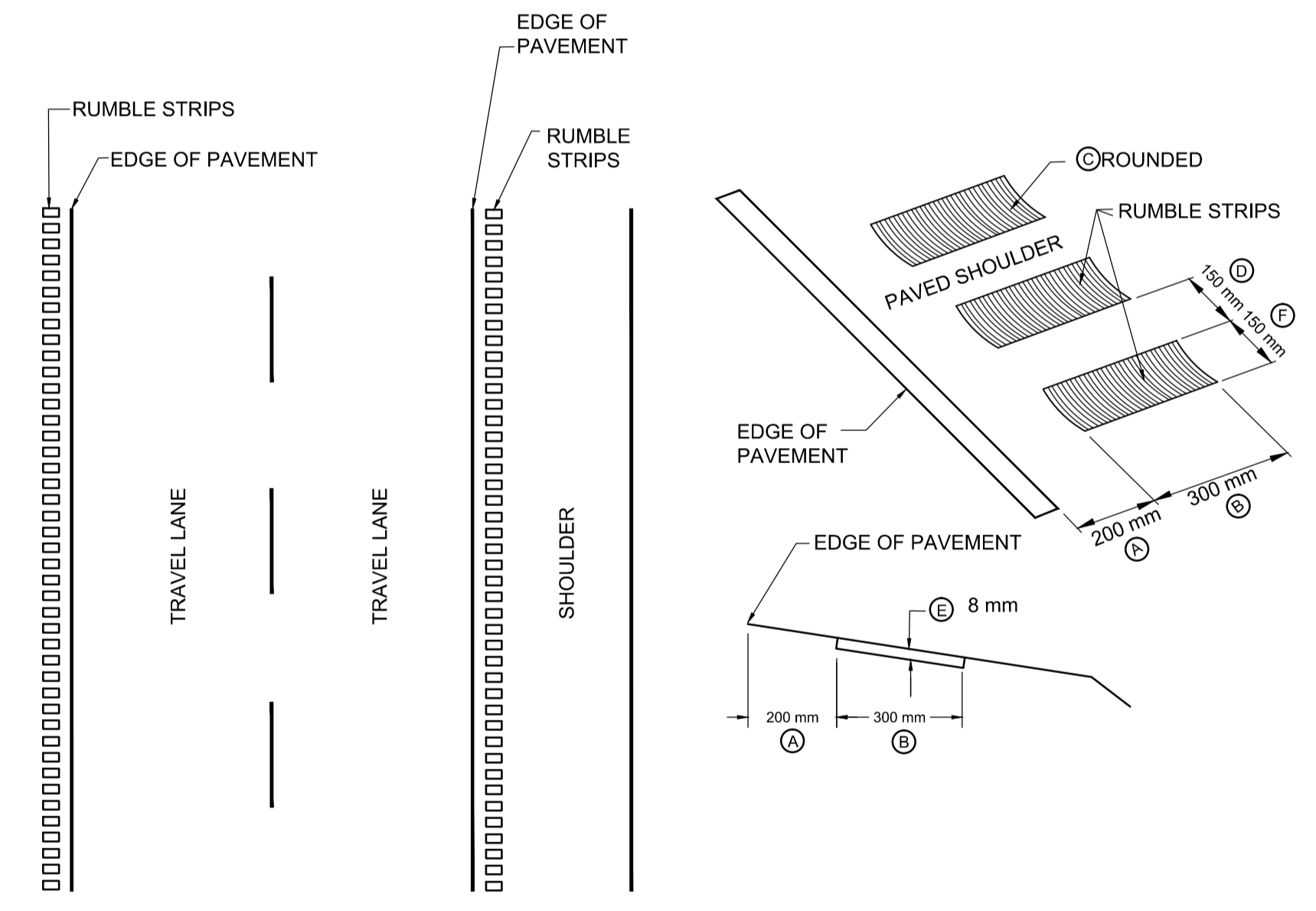

- A - DISTANCE FROM THE TRAVELLED LANE (200 mm)
- B - WIDTH OF PATTERN (TRAVERSE TO DIRECTION OF TRAVEL (300 mm))
- C - STRIP SHAPE (ROUNDED)
- D - SPACING BETWEEN STRIPS (150 mm ± 40 mm)
- E - STRIP DEPTH (8 ± 2 mm)
- F - STRIP LENGTH (LONGITUDINAL TO DIRECTION OF TRAVEL (150 ± 25 mm))

9 ASPHALT RUMBLE STRIP
87, 89, 90, 91 | 106 SCALE 1:100

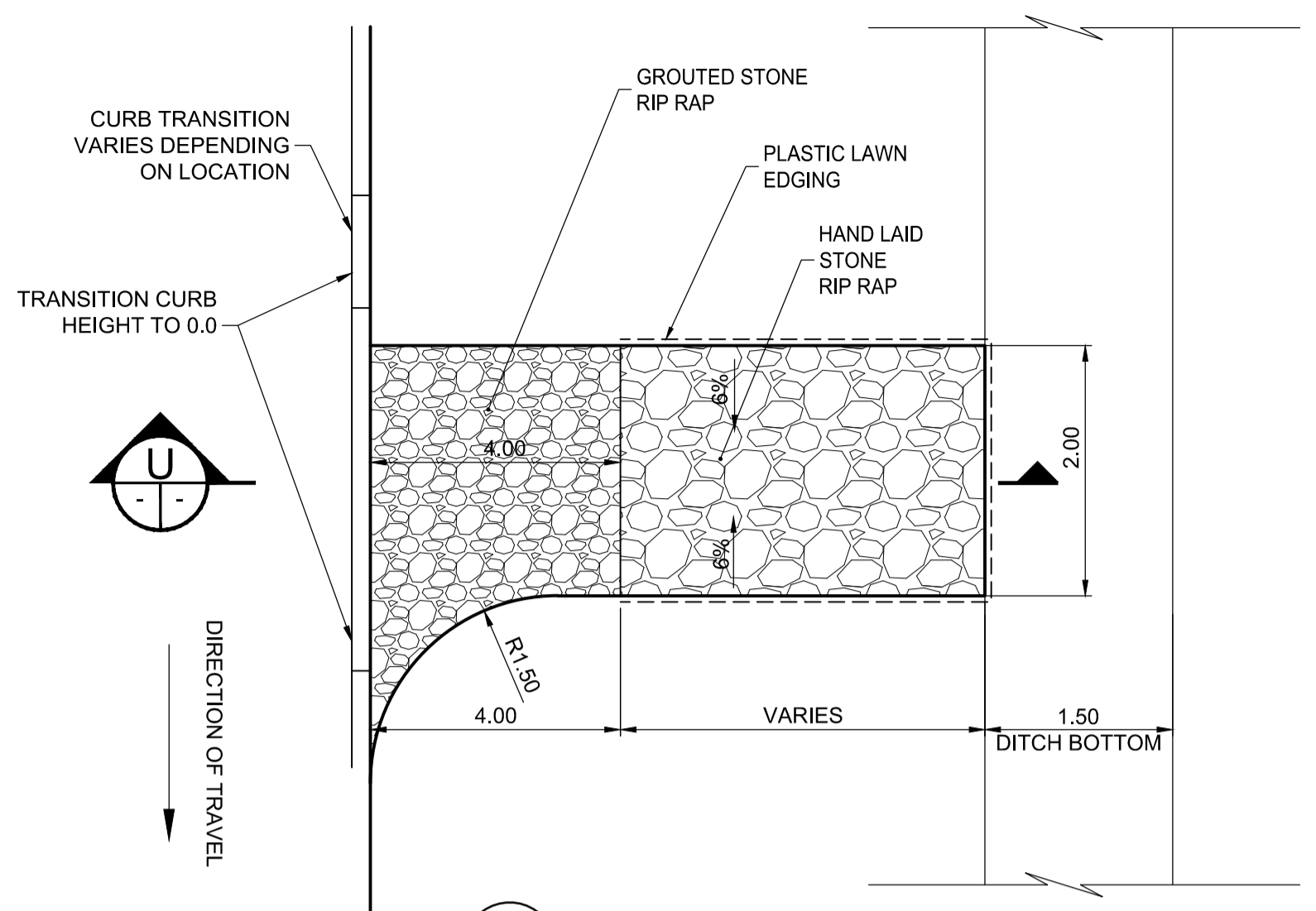

10 STONE RIP RAP CHANNEL
87 | 106 SCALE: NTS

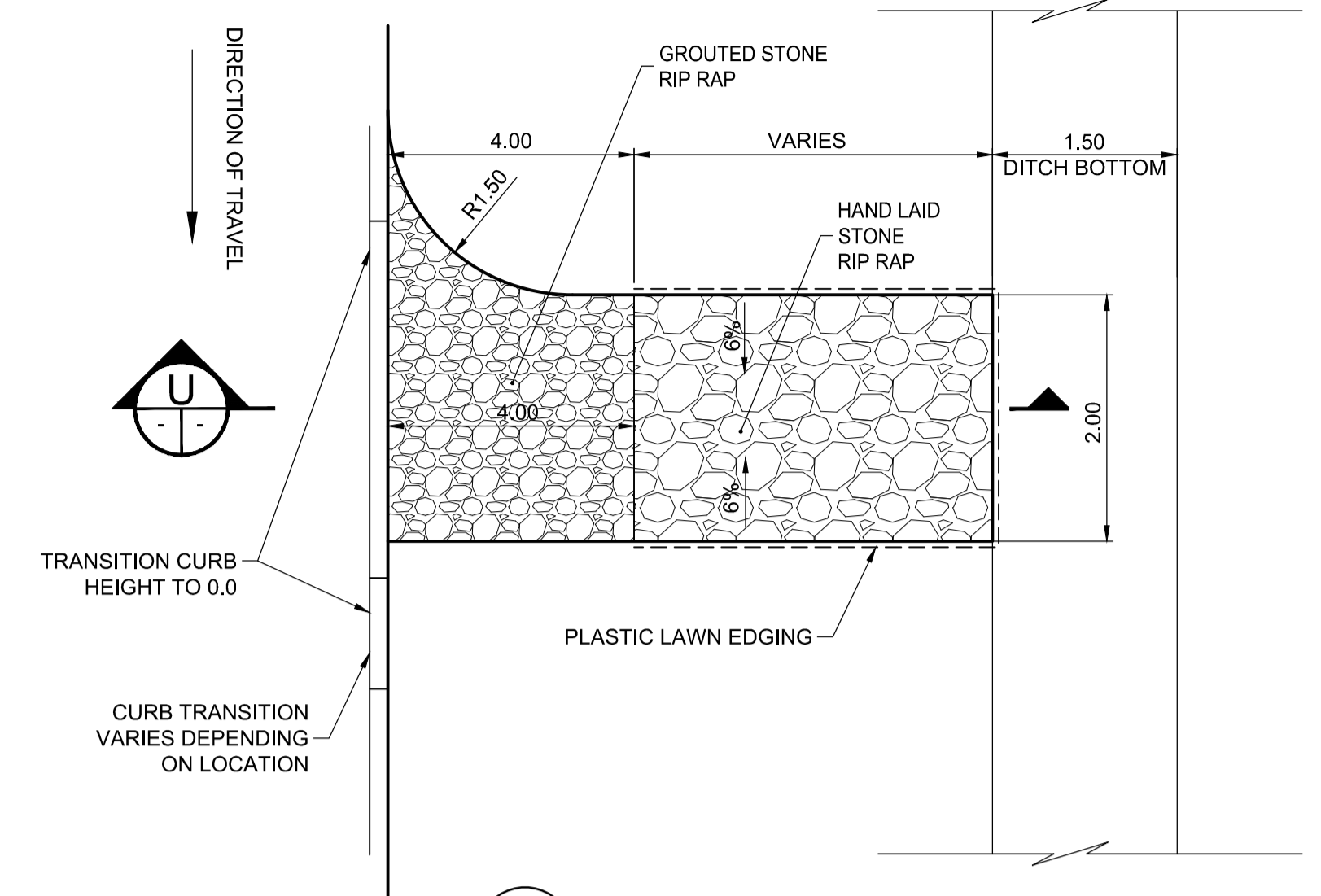

11 STONE RIP RAP CHANNEL
89 | 106 SCALE: NTS

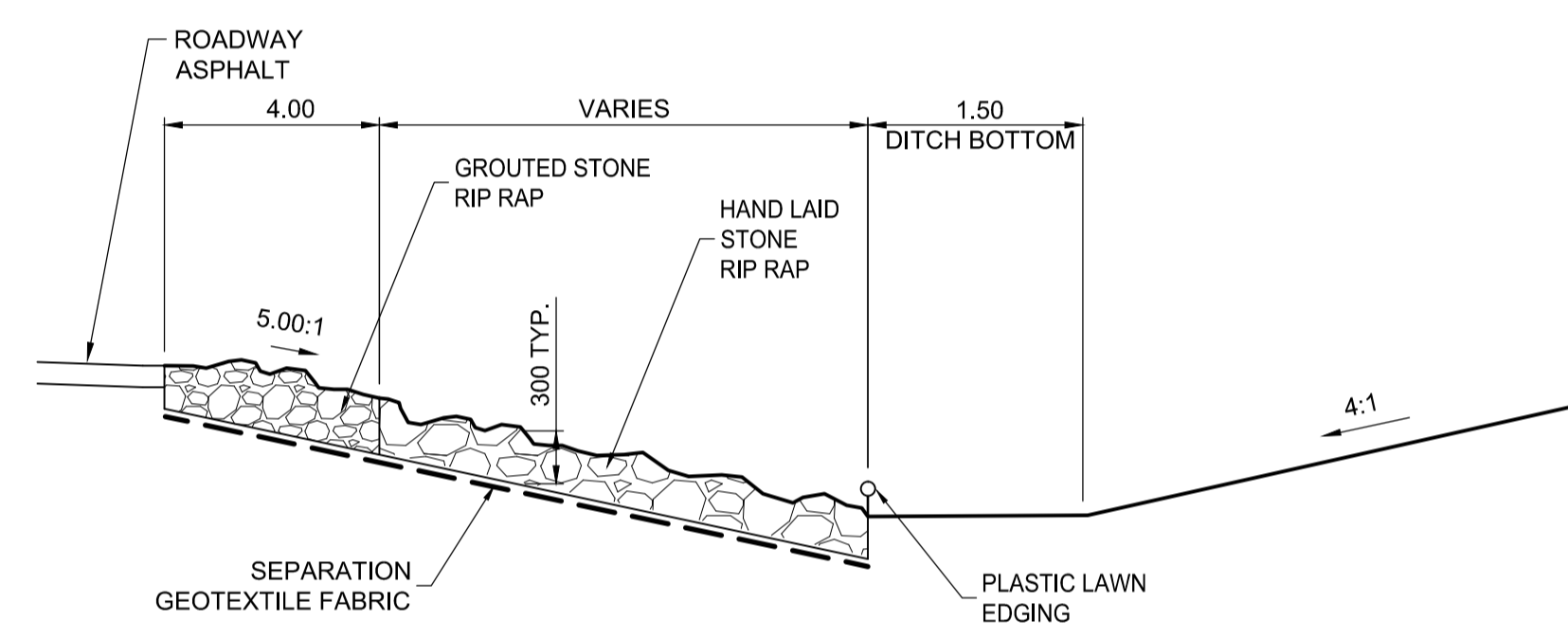

STONE RIPRAP CHANNEL SECTION
SCALE NTS

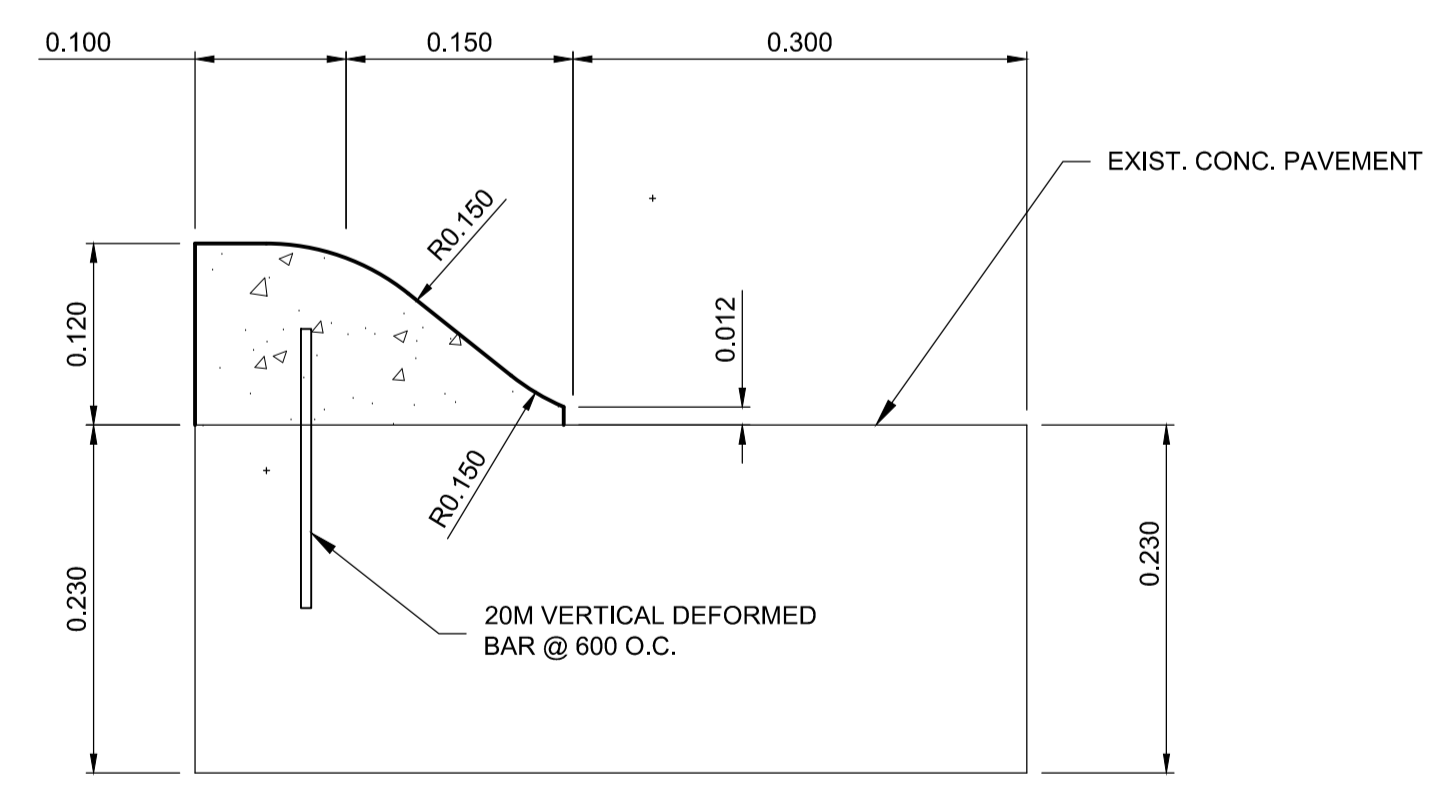

15 120 mm DOWELLED MOUNTABLE CURB
89 | 106 SCALE 1:5



METRIC

WHOLE NUMBERS INDICATE MILLIMETRES
DECIMALIZED NUMBERS INDICATE METRES

WARNING

- IF POWER EQUIPMENT OR EXPLOSIVES ARE TO BE USED FOR EXCAVATION ON THIS PROJECT THE CONTRACTOR MUST:
- NOTIFY THE GAS COMPANY OF THE PROPOSED LOCATION OF EXCAVATION.
 - TAKE PRECAUTION TO AVOID DAMAGE TO GAS COMPANY INSTALLATIONS SEE PROVINCIAL REGULATION 210/72 FOR DETAILS.
 - OBTAIN EXCAVATION PERMITS PRIOR TO CONSTRUCTION.
 - A MINIMUM VERTICAL SEPARATION OF 300 mm FROM GAS MAINS AND 100 mm FROM GAS SERVICE MUST BE MAINTAINED BETWEEN ANY MANITOBA HYDRO FACILITY AND ANY NEW INSTALLATIONS.
 - A MINIMUM 900 mm OF COVER SHALL BE MAINTAINED IN ALL AREAS WHERE EQUIPMENT WILL BE CROSSING, TRAVELING OR COMPACTING OVER THE HIGH PRESSURE GAS MAINS.
 - IF EQUIPMENT MUST CROSS, TRAVEL, OR COMPACT OVER THE GAS MAIN WITH LESS THAN THE MINIMUM DEPTH COVER, EARTH BRIDGING OR STEEL PLATES SHALL BE PLACED OVER THE MAIN AND EXTEND A MINIMUM OF 1.0 METRE ON EITHER SIDE AT EACH CROSSING LOCATION.

G:\CAD\126606\Contract\Drawings\Civil_Details.dwg

150 W.M.	150 W.M.	M.T.S.	M.T.S.	150 mm W.M.	150 mm W.M.
WATERMAIN	WATERMAIN	M.T.S.	M.T.S.	150 mm W.M.	WATERMAIN
HYDRANT VALVE	HYDRANT VALVE			HYDRANT VALVE	
300 LDS LAND DRAINAGE SEWER	300 LDS LAND DRAINAGE SEWER			300 mm L.D.S. LAND DRAINAGE SEWER	
250 WWS WASTE WATER SEWER	250 WWS WASTE WATER SEWER			250 mm W.W.S. WASTE WATER SEWER	
MANHOLE	MANHOLE			MANHOLE	
CATCH BASIN	CATCH BASIN			CATCH BASIN	
TEST HOLES	TEST HOLES			TEST HOLES	
JUNCTIONS	JUNCTIONS			JUNCTIONS	
CULVERT	CULVERT			CULVERT	
100 GAS	100 GAS			100 GAS	
EXISTING	LEGEND-PLAN	PROPOSED	EXISTING	LEGEND-PLAN	PROPOSED

UNDERGROUND STRUCTURES SUPV. U/G STRUCTURES COMMITTEE DATE _____		B.M. 654008 N: 5515764.610 E: 633359.697 654210 N: 5514436.957 E: 630550.534		DESIGNED BY MRD DRAWN BY PMW CHECKED BY APPROVED BY	DESIGN TEAM 	ENGINEER'S SEAL 	THE CITY OF WINNIPEG PUBLIC WORKS DEPARTMENT WAVERLEY WEST ARTERIAL ROADS PROJECT (WWARP) PART 3 - CONTRACT 2 ROUTE 90 TO ROUTE 165 OVERPASS (KENASTON BLVD.) AND ASSOCIATED WORKS	CITY DRAWING NUMBER B242-13-106 SHEET 106 OF 128
NOTE: LOCATION OF UNDERGROUND STRUCTURES AS SHOWN ARE BASED ON THE BEST INFORMATION AVAILABLE BUT NO GUARANTEE IS GIVEN THAT ALL EXISTING UTILITIES ARE SHOWN OR THAT THE GIVEN LOCATIONS ARE EXACT. CONFIRMATION OF EXISTENCE AND EXACT LOCATION OF ALL SERVICES MUST BE OBTAINED FROM THE INDIVIDUAL UTILITIES BEFORE PROCEEDING WITH CONSTRUCTION.		HOR. SCALE AS SHOWN VERTICAL	RELEASED FOR CONSTRUCTION DATE	CONSULTANT PROJECT NUMBER 12-6606	DETAILS 2 OF 3	CONSULTANT DRAWING NUMBER P-3349-106		