

KENASTON EB

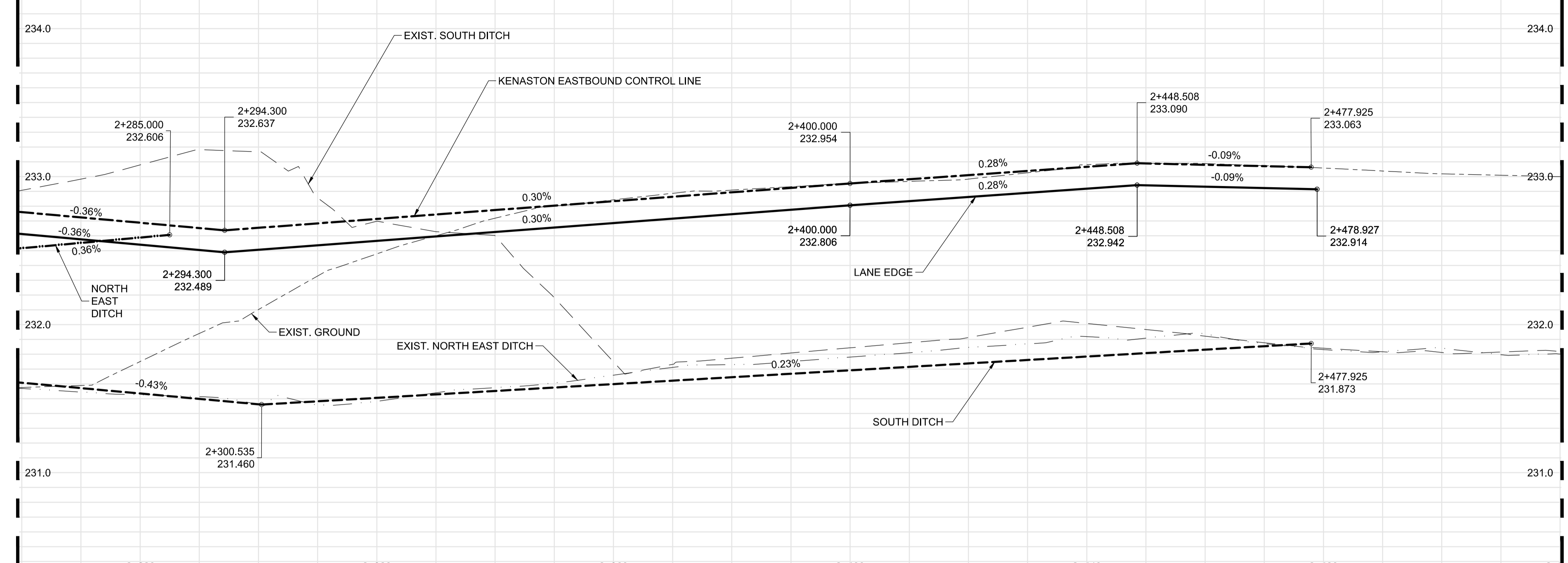

BISHOP GRANDIN BV

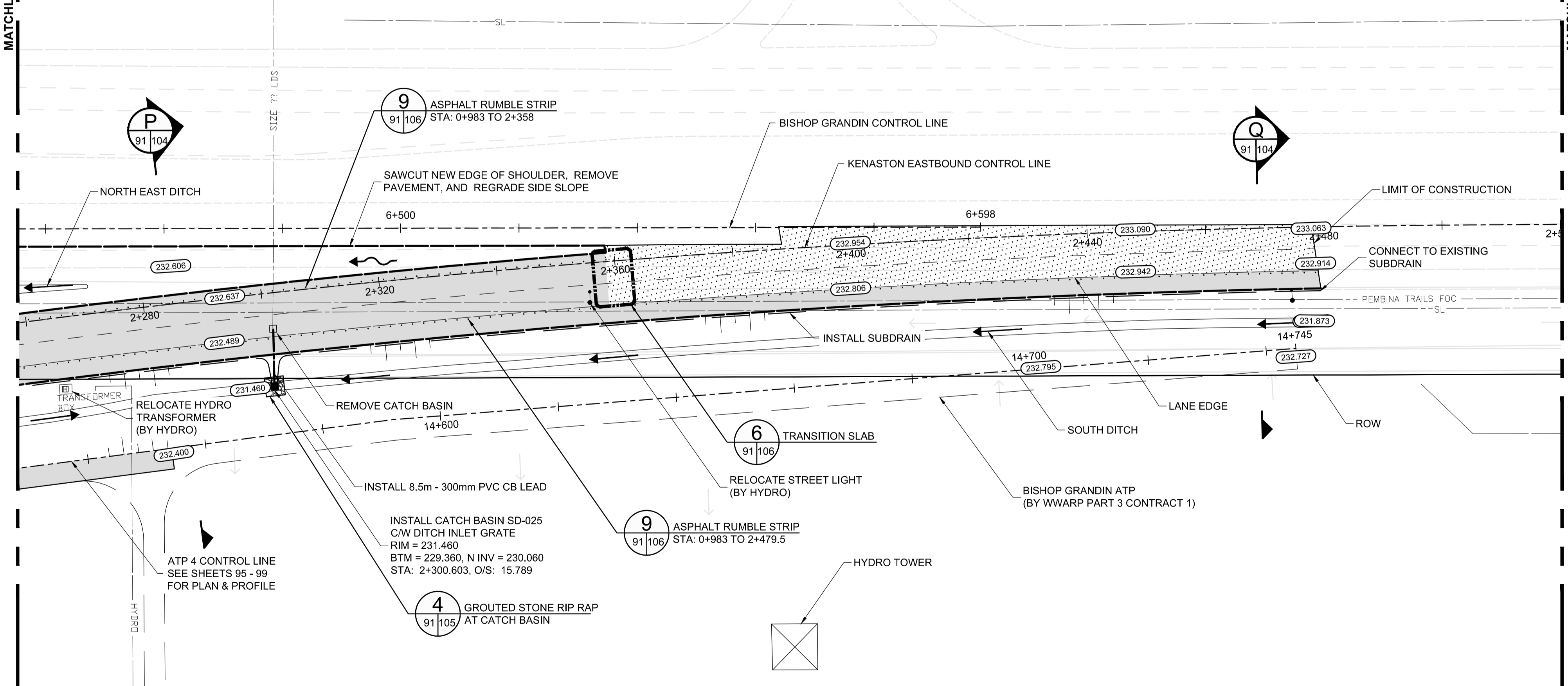

METRIC

WHOLE NUMBERS INDICATE MILLIMETRES
DECIMALIZED NUMBERS INDICATE METRES

WARNING

- IF POWER EQUIPMENT OR EXPLOSIVES ARE TO BE USED FOR EXCAVATION ON THIS PROJECT THE CONTRACTOR MUST:
- NOTIFY THE GAS COMPANY OF THE PROPOSED LOCATION OF EXCAVATION.
 - TAKE PRECAUTION TO AVOID DAMAGE TO GAS COMPANY INSTALLATIONS SEE PROVINCIAL REGULATION 210/72 FOR DETAILS.
 - OBTAIN EXCAVATION PERMITS PRIOR TO CONSTRUCTION.
 - A MINIMUM VERTICAL SEPARATION OF 300 mm FROM GAS MAINS AND 100 mm FROM GAS SERVICE MUST BE MAINTAINED BETWEEN ANY MANITOBA HYDRO FACILITY AND ANY NEW INSTALLATIONS.
 - A MINIMUM 900 mm OF COVER SHALL BE MAINTAINED IN ALL AREAS WHERE EQUIPMENT WILL BE CROSSING, TRAVELING OR COMPACTING OVER THE HIGH PRESSURE GAS MAINS.
 - IF EQUIPMENT MUST CROSS, TRAVEL, OR COMPACT OVER THE GAS MAIN WITH LESS THAN THE MINIMUM DEPTH COVER, EARTH BRIDGING OR STEEL PLATES SHALL BE PLACED OVER THE MAIN AND EXTEND A MINIMUM OF 1.0 METRE ON EITHER SIDE AT EACH CROSSING LOCATION.

G:\CAD\126606\Contract\Contract_2\Current\Civil_Plan_Profile.dwg

| | | | | | | | |
|---------|---------------------|---------|----------------|----------------|---------------|---------------------|---------------|
| 150 WM | WATERMAIN | 150 WM | M.T.S. | M.T.S. | 150 mm W.M. | WATERMAIN | 150 mm W.M. |
| ⊕ | HYDRANT | ⊕ | CONCRETE | CONCRETE | + | HYDRANT | + |
| ⊗ | VALVE | ⊗ | ASPHALT | ASPHALT | ⊗ | VALVE | ⊗ |
| 300 LDS | LAND DRAINAGE SEWER | 300 LDS | PLANING | PLANING | 300 mm L.D.S. | LAND DRAINAGE SEWER | 300 mm L.D.S. |
| 250 WWS | WASTE WATER SEWER | 250 WWS | SIDEWALK | SIDEWALK | 250 mm W.W.S. | WASTE WATER SEWER | 250 mm W.W.S. |
| ○ | MANHOLE | ● | PAVING STONES | PAVING STONES | --- | MANHOLE | --- |
| □ | CATCH BASIN | ■ | PROPERTY LINE | PROPERTY LINE | --- | CATCH BASIN | --- |
| ⊕ | TEST HOLES | ⊕ | SURVEY BAR | SURVEY BAR | --- | TEST HOLES | --- |
| + | JUNCTIONS | + | CURB RAMP | CURB RAMP | --- | JUNCTIONS | --- |
| — | CULVERT | — | DITCH | DITCH | --- | CULVERT | --- |
| 100 GAS | GAS | 100 GAS | SWALE | SWALE | --- | GAS | --- |
| --- | EXISTING | --- | LEGEND-PLAN | LEGEND-PLAN | --- | EXISTING | --- |
| --- | PROPOSED | --- | LEGEND-PROFILE | LEGEND-PROFILE | --- | PROPOSED | --- |

UNDERGROUND STRUCTURES
SUPPLY U/G STRUCTURES COMMITTEE DATE

NOTE:
LOCATION OF UNDERGROUND STRUCTURES AS SHOWN ARE BASED ON THE BEST INFORMATION AVAILABLE BUT NO GUARANTEE IS GIVEN THAT ALL EXISTING UTILITIES ARE SHOWN OR THAT THE GIVEN LOCATIONS ARE EXACT. CONFIRMATION OF EXISTENCE AND EXACT LOCATION OF ALL SERVICES MUST BE OBTAINED FROM THE INDIVIDUAL UTILITIES BEFORE PROCEEDING WITH CONSTRUCTION.

| | | | |
|-----------------|----------------|--------|----------------|
| B.M. 654008 | N: 5515764.610 | 654210 | N: 5514436.957 |
| E: 633359.697 | E: 630550.534 | | |
| ELEV. 232.463 m | ELEV. --- | | |

| | |
|-------------------|--------------|
| DESIGNED BY | MRD |
| DRAWN BY | PMW |
| CHECKED BY | DBW |
| APPROVED BY | DPK |
| HOR. SCALE | 1:500 |
| VERTICAL | 1:20 |
| ISSUED FOR TENDER | 13/08/08 MRD |
| NO. REVISIONS | DATE BY |
| | 2013/08/08 |



THE CITY OF WINNIPEG
PUBLIC WORKS DEPARTMENT

Waverley West Arterial Roads Project
(WWARP) PART 3 - CONTRACT 2
ROUTE 90 TO ROUTE 165 OVERPASS (KENASTON BLVD.)
AND ASSOCIATED WORKS

PLAN AND PROFILE - KENASTON EB
STA: 2+260 TO 2+520

CITY DRAWING NUMBER: B242-13-91
SHEET 91 OF 128
CONSULTANT DRAWING NUMBER: P-3349-91

CONSULTANT PROJECT NUMBER: 12-6606