

KENASTON SB

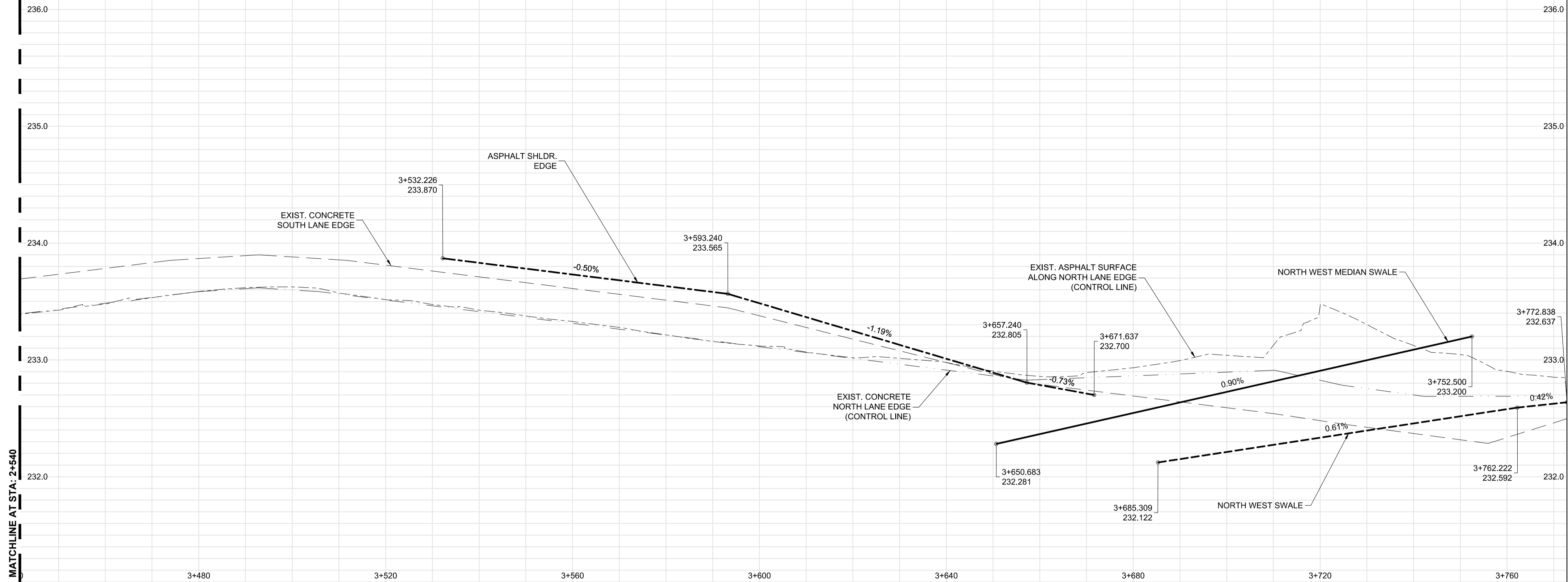

MATCHLINE AT STA: 2+540

KENASTON BV

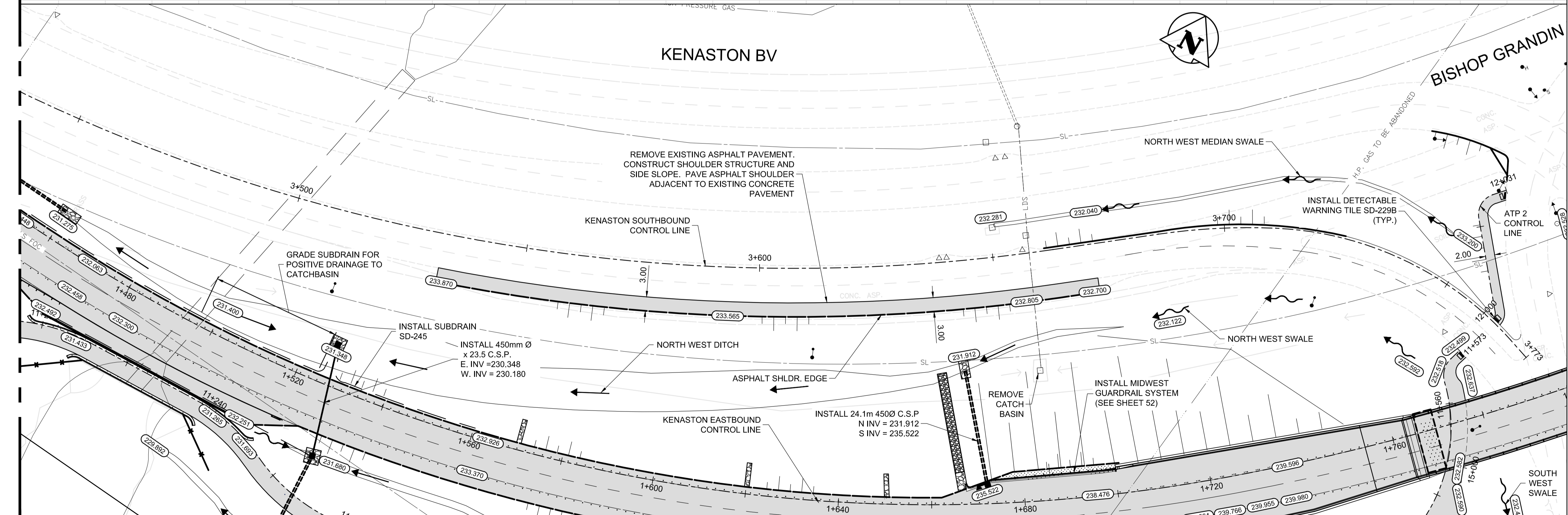

METRIC

WHOLE NUMBERS INDICATE MILLIMETRES  
DECIMALIZED NUMBERS INDICATE METRES

WARNING

IF POWER EQUIPMENT OR EXPLOSIVES ARE TO BE USED FOR EXCAVATION ON THIS PROJECT THE CONTRACTOR MUST:

- NOTIFY THE GAS COMPANY OF THE PROPOSED LOCATION OF EXCAVATION.
- TAKE PRECAUTION TO AVOID DAMAGE TO GAS COMPANY INSTALLATIONS SEE PROVINCIAL REGULATION 210/72 FOR DETAILS.
- OBTAIN EXCAVATION PERMITS PRIOR TO CONSTRUCTION.
- A MINIMUM VERTICAL SEPARATION OF 300 mm FROM GAS MAINS AND 100 mm FROM GAS SERVICE MUST BE MAINTAINED BETWEEN ANY MANITOBA HYDRO FACILITY AND ANY NEW INSTALLATIONS.
- A MINIMUM 900 mm OF COVER SHALL BE MAINTAINED IN ALL AREAS WHERE EQUIPMENT WILL BE CROSSING, TRAVELING OR COMPACTING OVER THE HIGH PRESSURE GAS MAINS.
- IF EQUIPMENT MUST CROSS, TRAVEL, OR COMPACT OVER THE GAS MAIN WITH LESS THAN THE MINIMUM DEPTH COVER, EARTH BRIDGING OR STEEL PLATES SHALL BE PLACED OVER THE MAIN AND EXTEND A MINIMUM OF 1.0 METRE ON EITHER SIDE AT EACH CROSSING LOCATION.

G:\CAD\126606\Contract\2\Civil\Plan\_Profile.dwg

150 WM	WATERMAIN	150 WM	MTS	M.T.S.	150 mm W.M.	WATERMAIN	150 mm W.M.
HYDRANT VALVE	HYDRANT VALVE	CONCRETE ASPHALT PLANING	CONCRETE ASPHALT PLANING	CONCRETE ASPHALT PLANING	CONCRETE ASPHALT PLANING	HYDRANT VALVE	HYDRANT VALVE
300 LDS LAND DRAINAGE SEWER	300 LDS LAND DRAINAGE SEWER	250 WWS WASTE WATER SEWER	250 WWS WASTE WATER SEWER	250 mm W.W.S.	250 mm W.W.S.	300 LDS LAND DRAINAGE SEWER	300 LDS LAND DRAINAGE SEWER
MANHOLE	MANHOLE	CATCH BASIN	CATCH BASIN	PAVING STONES	PAVING STONES	WASTE WATER SEWER	WASTE WATER SEWER
TEST HOLES	TEST HOLES	PROPERTY LINE	PROPERTY LINE	SURVEY BAR	SURVEY BAR	Q PROFILE	Q PROFILE
JUNCTIONS	JUNCTIONS	CURB RAMP	CURB RAMP	NORTH/WEST GUTTER	NORTH/WEST GUTTER	SOUTH/EAST GUTTER	SOUTH/EAST GUTTER
CULVERT	CULVERT	DITCH	DITCH	NORTH/WEST T/LANE	NORTH/WEST T/LANE	SOUTH/EAST T/LANE	SOUTH/EAST T/LANE
100 GAS	100 GAS	SWALE	SWALE				
EXISTING	LEGEND-PLAN	PROPOSED	EXISTING	LEGEND-PLAN	PROPOSED	EXISTING	LEGEND-PROFILE

UNDERGROUND STRUCTURES  
SUPV. U/G STRUCTURES COMMITTEE DATE

NOTE:  
LOCATION OF UNDERGROUND STRUCTURES AS SHOWN ARE BASED ON THE BEST INFORMATION AVAILABLE BUT NO GUARANTEE IS GIVEN THAT ALL EXISTING UTILITIES ARE SHOWN OR THAT THE GIVEN LOCATIONS ARE EXACT. CONFIRMATION OF EXISTENCE AND EXACT LOCATION OF ALL SERVICES MUST BE OBTAINED FROM THE INDIVIDUAL UTILITIES BEFORE PROCEEDING WITH CONSTRUCTION.

B.M.	654008	N: 5515764.610	654210	N: 5514436.957
ELEV.	232.463	m	E: 630550.534	ELEV.
0	ISSUED FOR TENDER	13/08/08	MRD	
NO.	REVISIONS	DATE	BY	DATE

DESIGNED BY	MRD
DRAWN BY	PMW
CHECKED BY	DBW
APPROVED BY	DPK
HOR. SCALE	1:500
VERTICAL	1:20
DATE	2013/08/08

DESIGN TEAM

RELEASED FOR CONSTRUCTION

ENGINEER'S SEAL

CONSULTANT PROJECT NUMBER  
12-6606

THE CITY OF WINNIPEG  
PUBLIC WORKS DEPARTMENT

WAVERLEY WEST ARTERIAL ROADS PROJECT  
(WWARP) PART 3 - CONTRACT 2  
ROUTE 90 TO ROUTE 165 OVERPASS (KENASTON BLVD.)  
AND ASSOCIATED WORKS

CITY DRAWING NUMBER  
B242-13-92

SHEET 92 OF 128

CONSULTANT DRAWING NUMBER  
P-3349-92

PLAN AND PROFILE - KENASTON SB  
STA: 3+445 TO 3+770