

| LUMINAIRE SCHEDULE (all equipment to be MB Hydro Power Smart Approved) | | | | | | |
|--|--------------|-----------------------------------|-------------------|------------------------|---------|--|
| TYPE | MANUFACTURER | MODEL # | MOUNTING | LAMP | VOLTAGE | COMMENTS |
| A | LITHONIA | SP5-G-2-28T5-A12125-120-LP841-CSA | RECESSED IN T-BAR | 2-28WTS, 4100K | 120 | TWO LEVELS LIGHTING - 1 BALLAST PER LUMINAIRE/PROGRAMMED START AND T-BAR SAFETY CLIPS 95% BALLAST FACTOR |
| B | LITHONIA | LB 2 28T5 120 GEB10PS-CSA | SURFACE DRYWALL | 2-28WTS, 3500K, 84 CRI | 120 | TWO LEVELS LIGHTING ROOM 102- 2 BALLAST PER LUMINAIRE |

NOTES:

- ALL FLUORESCENT LAMPS SHALL BE C/W FULLY ELECTRONIC BALLASTS.
- ELECTRICAL SUBCONTRACTOR SHALL SUBMIT "POWER SMART PROGRAM" APPLICATION TO MANITOBA HYDRO ON BEHALF OF THE CITY OF WINNIPEG. ALL HYDRO REBATES SHALL BE ADDRESSED AND RETURNED TO THE CITY OF WINNIPEG AND A COPY TO THE CONTRACT ADMINISTRATOR.

NOTES:

- REFER TO ELECTRICAL KEY PLAN AND SYMBOL LEGEND DWG E0001 FOR ELECTRICAL SYMBOL SCHEDULE AND LETTERS DESIGNATION.
- ALL MATERIAL SHALL BE NEW AND BE CSA APPROVED OR ULC LISTED
- ALL WIRING SHALL BE MINIMUM #12 AWG COPPER
- ALL INTERIOR WIRING IN CEILING SPACE ABOVE T-BAR CEILING IN DRY AREAS SHALL BE AC90 (ARMOURED) CABLE OR RW90 WIRE INSTALLED IN EMT CONDUIT. ALL EMT CONDUIT SHALL INCLUDE A DEDICATED INSULATED GREEN GROUND WIRE.
- ALL WIRING AND CONDUITS SHALL BE CONCEALED UNLESS NOTED OTHERWISE.
- ELECTRICAL SUBCONTRACTOR IS RESPONSIBLE FOR SEALING ALL PENETRATIONS THROUGH FIRE RATED WALLS AND ASSEMBLIES WITH RATED FIRE STOP RATED EQUAL TO THAT OF THE ADJACENT MATERIALS. ALL FIRE STOP MATERIALS AND INSTALLATION SHALL CONFORM TO UL 1479 AND ASTM E-814-10
- PROVIDE SHOP DRAWINGS INCLUDING BALLAST CUT SHEETS.
- ALL CIRCUITING IS FOR GROUPING PURPOSES ONLY. ELECTRICAL CONTRACTOR TO ENSURE PANELS ARE PROPERLY BALANCED.
- ALL CIRCUITS SHOULD HAVE A SEPARATE GROUND.
- ALL "NIGHT LIGHT" LUMINAIRES ARE ENERGIZED 24 HOURS WITHOUT LIGHTING CONTROL.
- PROVIDE A MINIMUM OF 100 HOURS OF BURN-OUT TIME FOR ALL LUMINAIRES.
- PROVIDE 1000mm EXTRA LENGTH OF COILED ELECTRICAL CONDUCTOR PER EACH LUMINAIRE IN ALL AREAS ABOVE T-BAR CEILING. ALL LUMINAIRE WIRING TO BE DONE IN CONDUIT WITH THE EXCEPTION OF DROP FLEXIBLE CONDUIT FROM JUNCTION BOX TO LUMINAIRE.
- ALL LUMINAIRES BALLAST OR LAMPS SHALL BE APPROVED UNDER THE MANITOBA HYDRO POWER SMART PROGRAM AND APPROVED BY LUMINAIRE MANUFACTURER FOR WARRANTY PURPOSES. ELECTRICAL CONTRACTOR TO PROVIDE BALLAST AND LAMP CUT SHEETS WITH SHOP DRAWING OF EACH LUMINAIRE FOR APPROVAL.
- REFER TO ARCHITECTURAL DRAWINGS FOR BUILDING DETAILS.

| REFERENCE DRAWINGS | |
|--------------------|-------------|
| NO. | DESCRIPTION |
| | |
| | |
| | |
| | |
| | |
| | |
| | |
| | |
| | |
| | |

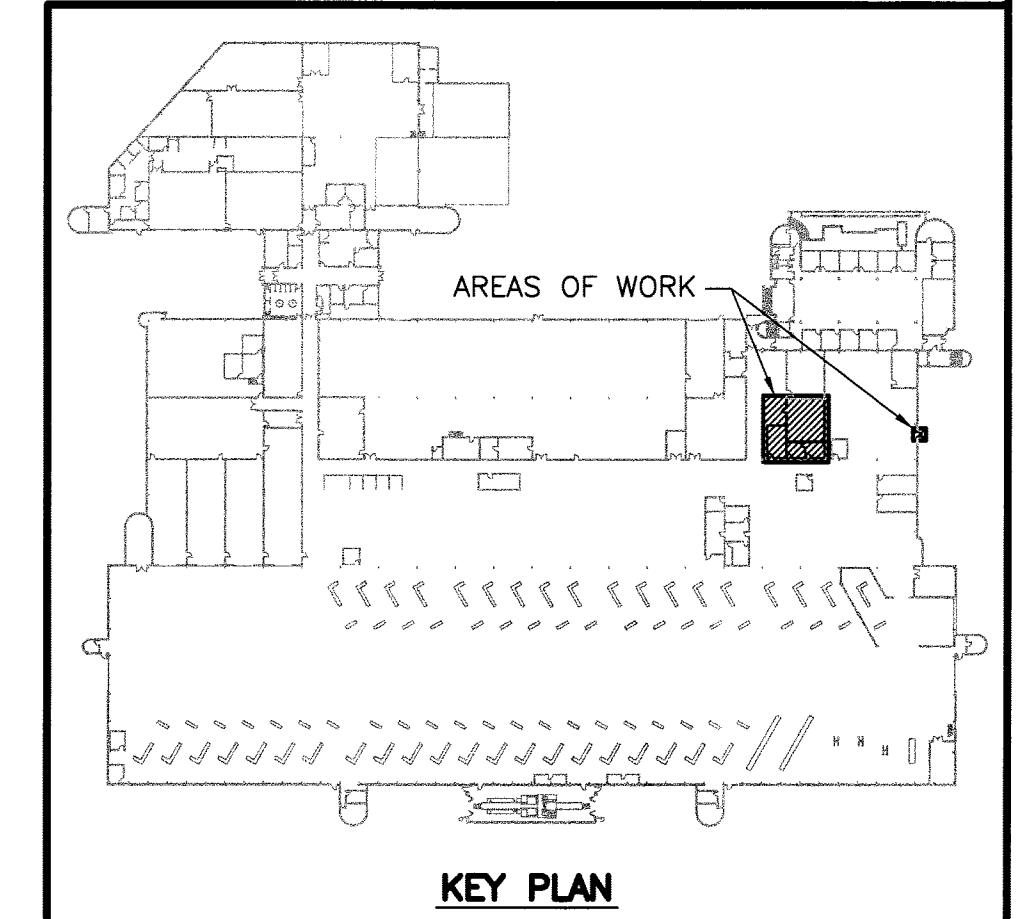
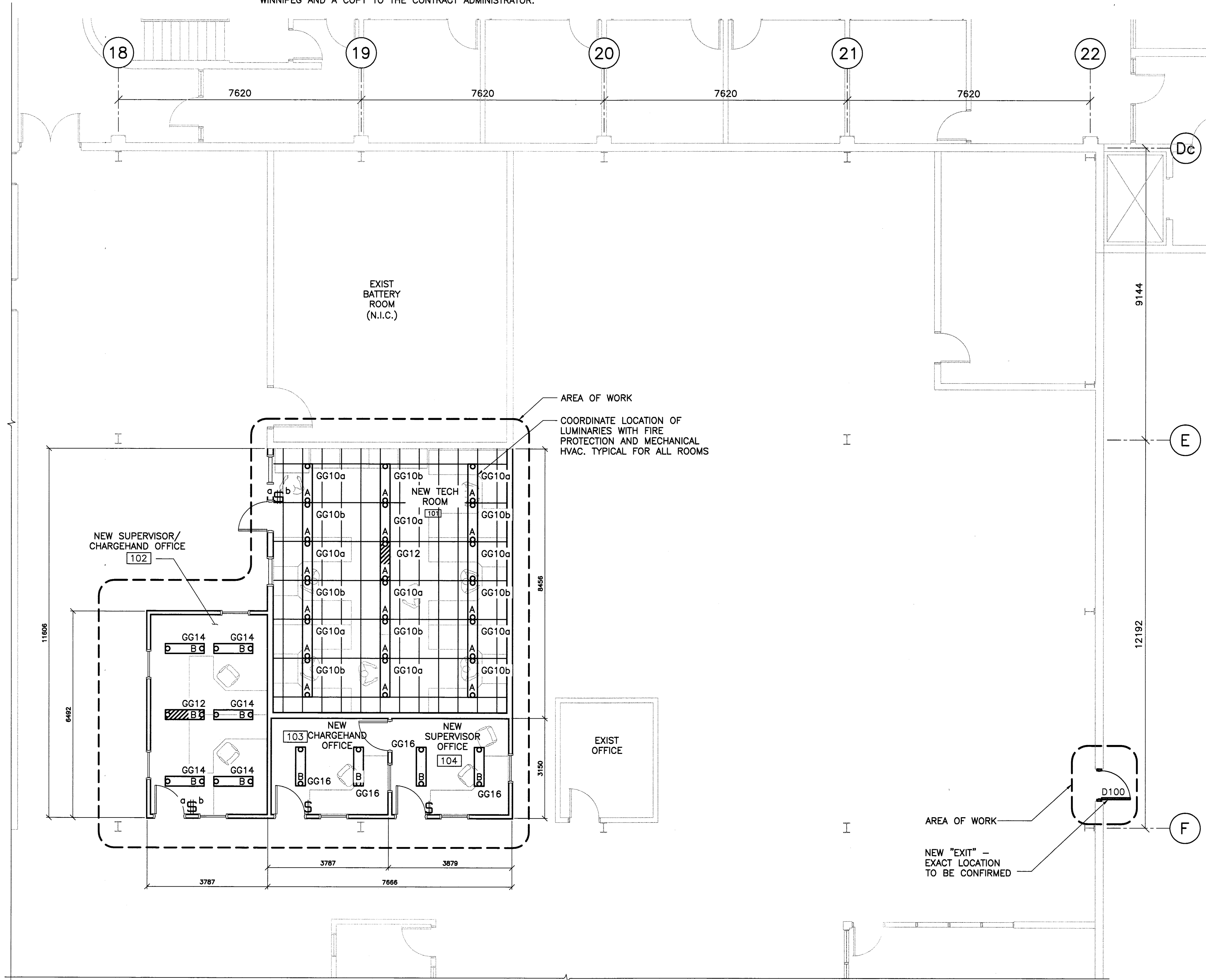
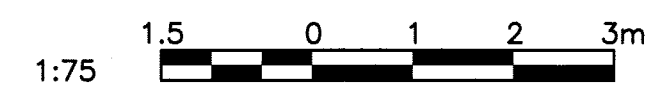

| NO. | DATE | DISCUSSION | PREPARED | REVIEW | DESIGN | AUTHORIZE |
|-----|----------|-------------------|----------|--------|--------|-----------|
| 00 | 13.06.27 | ISSUED FOR TENDER | KS | HC | KS | |

PROVINCE OF MANITOBA
 JUN 23, 2013
 H.A. CEBALGAS
 Member
 22882
 REGISTERED PROFESSIONAL ENGINEER

APEGM
 Certificate of Authorization
TETRA TECH WEI Inc.
 No. 5313 Date: April 30, 2014

ORIGINAL SIGNED 13.06.27

| DESIGNED BY: | PREPARED BY: | REVIEWED BY: |
|--------------|--------------|--------------|
| HC | KS | HC |

DATE: 2013.05.24 SCALE: AS NOTED

THE CONTENT OF THIS DOCUMENT IS NOT INTENDED FOR THE USE OF, NOR IS IT INTENDED TO BE RELIED UPON BY ANY PERSON, FIRM OR CORPORATION OTHER THAN THE CLIENT AND TETRA TECH WEI Inc. (Tetra Tech). TETRA TECH WEI Inc. (Tetra Tech) DENIES ANY LIABILITY WHATSOEVER TO OTHER PARTIES FOR DAMAGES OR INJURY SUFFERED BY SUCH THIRD PARTY ARISING FROM THE USE OF THIS DOCUMENT BY THEM, WITHOUT THE EXPRESSED WRITTEN AUTHORITY OF TETRA TECH WEI Inc. (Tetra Tech) AND OUR CLIENT. THIS DOCUMENT IS SUBJECT TO FURTHER RESTRICTIONS IMPOSED BY THE CONTRACT BETWEEN THE CLIENT AND TETRA TECH WEI Inc. (Tetra Tech) AND THESE PARTIES PERMISSION MUST BE SOUGHT REGARDING THIS DOCUMENT IN ALL OTHER CIRCUMSTANCES.

CLIENT:
**CITY OF WINNIPEG
 TRANSIT DEPARTMENT**



PROJECT NAME:
 ELECTRICAL SECTION RENOVATION AT THE WINNIPEG TRANSIT GARAGE, 421 OSBORNE STREET

DRAWING DESCRIPTION:
**ELECTRICAL
 PARTIAL MAIN FLOOR PLAN
 LIGHTING DETAILS**

| DRAWING NO. | REV. |
|----------------------|------|
| 1329720200-DWG-E0004 | 00 |

1
 PARTIAL MAIN FLOOR PLAN
 1:75