

ALLEY PAVEMENT PROFILE
SCALE: 1:250 HOR
1:10 VER

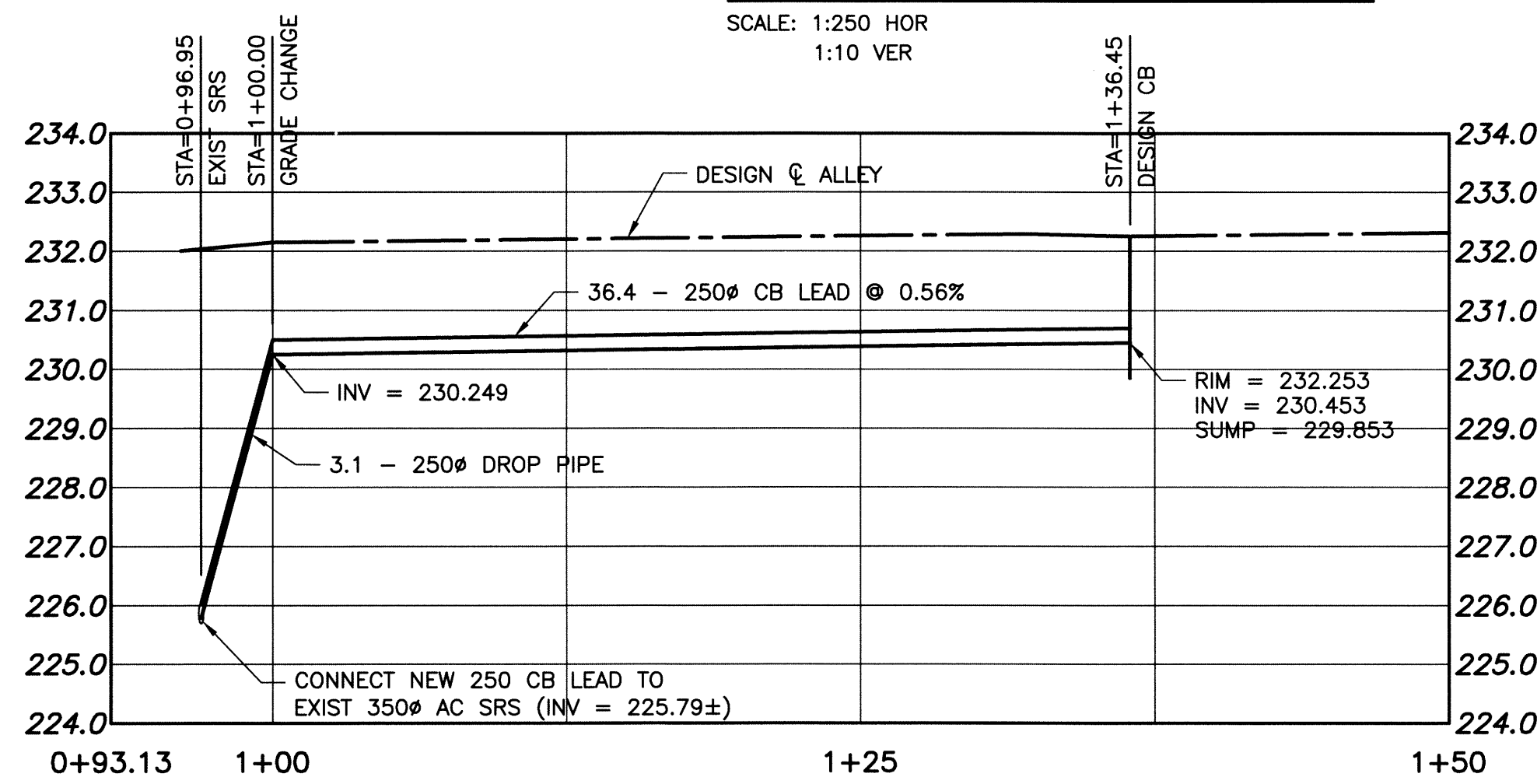

ALLEY SEWER PROFILE
SCALE: 1:250 HOR
1:100 VER

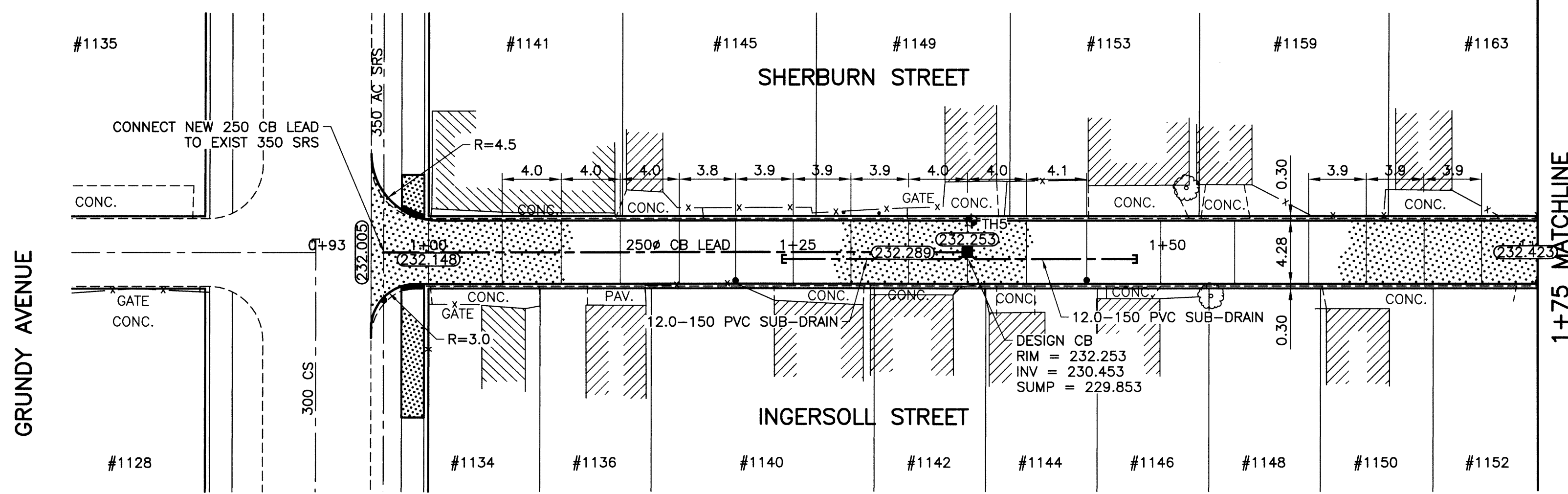

ALLEY PAVEMENT PLAN
SCALE: 1:250 HOR

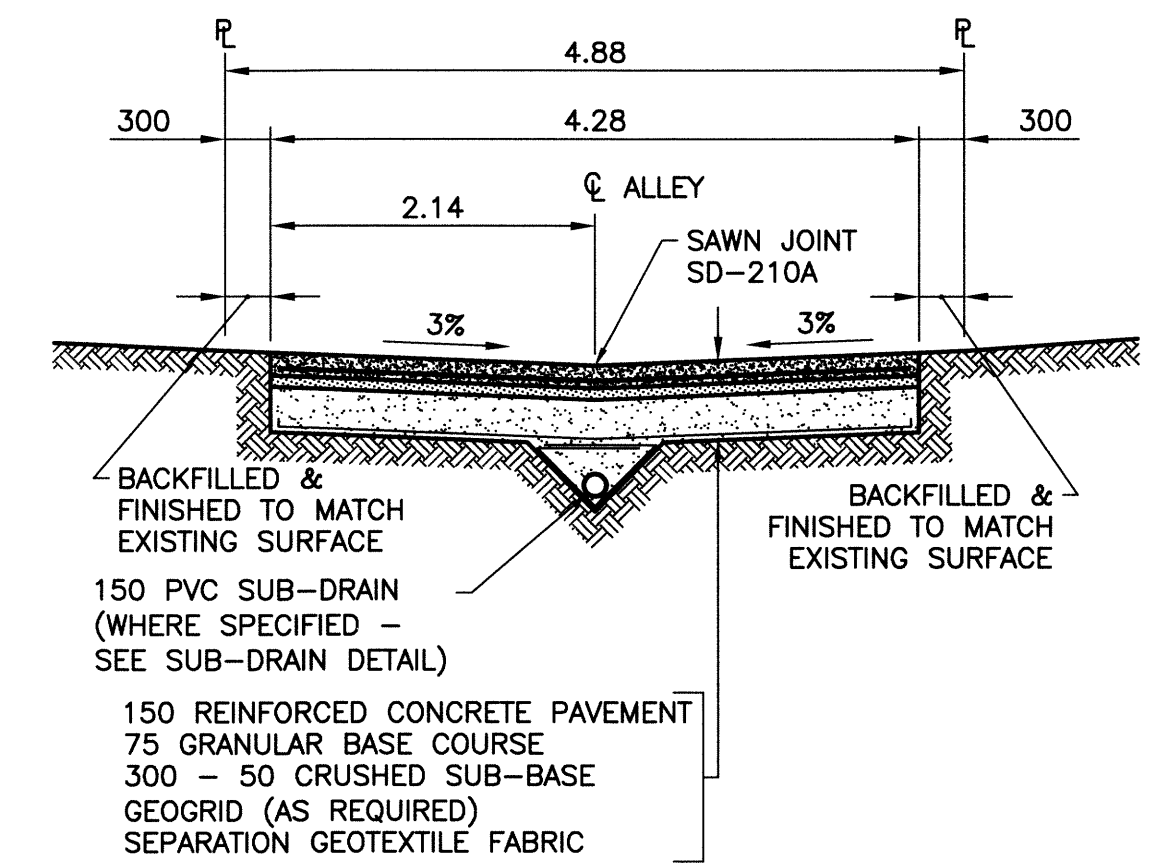

TYPICAL CROSS SECTION
SCALE: 1:50

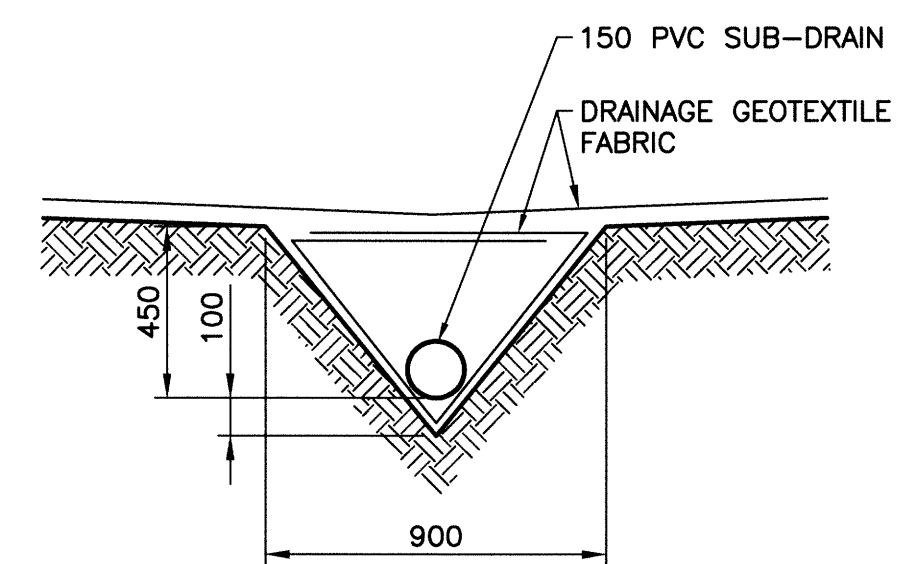

SUB-DRAIN DETAIL
SCALE: 1:20

NOTES:

1. STATION CHAINAGE IS BASED ON CENTERLINE OF ALLEY RIGHT OF WAY.
2. ADJUST MH AND CB RIMS TO NEW GRADES.
3. PLUG SUB-DRAINS AT TERMINAL ENDS.
4. REGRADE EXISTING PRIVATE SIDEWALKS AS REQUIRED.
5. INSTALLATION OF LIP CURBS AND THEIR EXTENTS TO BE DETERMINED BY THE CONTRACT ADMINISTRATOR.
6. LIGHT STANDARDS, HYDRO POLES AND ANCHORS MAY REQUIRE TEMPORARY SUPPORT/REMOVAL OR REPLACEMENT AT THE CONTRACTOR'S EXPENSE.
7. ISOLATE ALL POLES, BASES AND PILES WITHIN ALLEY RIGHT OF WAY (SD-228C)
8. AVOID DAMAGE TO EXISTING TREES WITHIN THE LIMITS OF CONSTRUCTION
9. CITY OF WINNIPEG SURVEY MONUMENTS EXIST ON THIS SITE. CONTRACTOR TO CONTACT THE CITY OF WINNIPEG GEOMATICS BRANCH 5 WORKING DAYS IN ADVANCE OF CONSTRUCTION TO COORDINATE MONUMENT PROTECTION SERVICES (204-918-1360)

WARNING

NOTIFY THE GAS COMPANY OF THE PROPOSED LOCATION OF EXCAVATION. TAKE PRECAUTION TO AVOID DAMAGE TO GAS COMPANY INSTALLATIONS. SEE PROVINCIAL REGULATION 210/72 FOR DETAILS.

METRIC

WHOLE NUMBERS INDICATE MILLIMETRES
DECIMALIZED NUMBERS INDICATE METRES

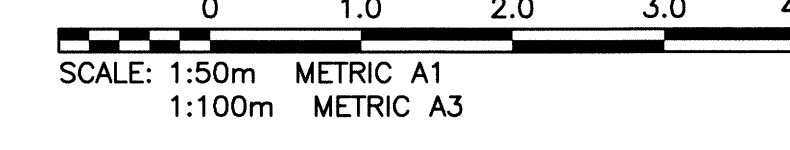
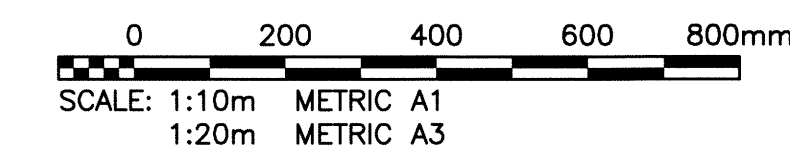
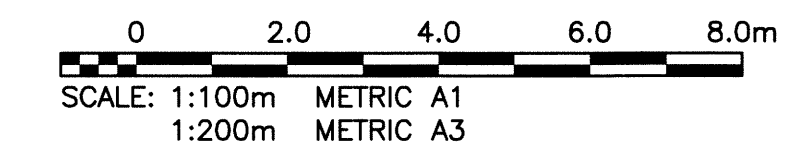

PROPERTY LIMITS DELINEATION

DELINEATION OF PROPERTY LIMITS AS SHOWN ON THIS DWG DOES NOT REPRESENT A "LEGAL SURVEY". KGS GROUP MAKES NO REPRESENTATION OR WARRANTY AS TO THE ACCURACY OF PROPERTY LIMITS DELINEATED ON THIS DWG, NOR ON THE DIMENSIONAL ACCURACY OF DWG FEATURES RELATIVE TO THOSE PROPERTY LIMITS.

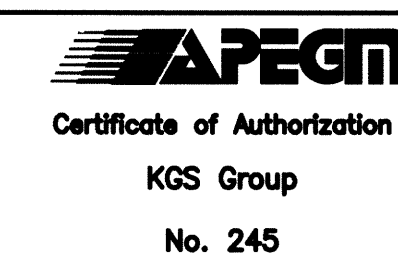

300 LBS	LAND DRAINAGE SEWER	300 LBS	TEST HOLE		
250 WWS	WASTE WATER SEWER	250 WWS	GUY WIRE		
---	GAS	---	LIGHT STANDARD		
---	HYDRO	---	BACK OF CURB		
---	M.T.S.	---	CONCRETE		
---	WATERMAIN	---	ASPHALT		
---	VALVE	---	SIDEWALK		
---	MANHOLE	---	PROPERTY LINE		
---	CATCH BASIN	---	SURVEY BAR		
---	CURB INLET	---	GEODETIC BENCHMARK		
---	POLES	---	ELEVATION		
EXISTING	LEGEND-PLAN	PROPOSED	EXISTING	LEGEND-PLAN	PROPOSED

LOCATION APPROVED UNDERGROUND STRUCTURES

SUPV. U/G STRUCTURES COMMITTEE DATE

NOTE:
LOCATION OF UNDERGROUND STRUCTURES AS SHOWN ARE BASED ON THE BEST INFORMATION AVAILABLE BUT NO GUARANTEE IS GIVEN THAT ALL EXISTING UTILITIES ARE SHOWN OR THAT THE GIVEN LOCATIONS ARE EXACT. CONFIRMATION OF EXISTENCE AND EXACT LOCATION OF ALL SERVICES MUST BE OBTAINED FROM THE INDIVIDUAL UTILITIES BEFORE PROCEEDING WITH CONSTRUCTION.

B.M. 36-007	N.W. Cor. Notre Dame & McPhillips in traffic island. Brass plug beneath Valve Box, 2.7m S. of N.L. of Notre Dame produced from the W. & 0.3m W. of W.L. McPhillips produced from the N.
ELEV. 232.065	
NO.	REVISIONS
DATE	BY

DESIGNED BY	RBO	CHECKED BY	CR
DRAWN BY	GEL	APPROVED BY	
HOR. SCALE:	1:250	RELEASED FOR CONSTRUCTION:	
VERTICAL:	1:50	DATE	13/06/12

ENGINEER'S SEAL

CONSULTANT DRAWING NO. 13-0107-007_C14

THE CITY OF WINNIPEG
PUBLIC WORKS DEPARTMENT
TRANSPORTATION ENGINEERING DIVISION

PROJECT TITLE
2013 ALLEY RENEWAL PROGRAM
CONTRACT 1
SHERBURN ST/INGERSOLL ST
GRUNDY AVE TO NOTRE DAME AVE
GRUNDY AVE TO STA 1+75

SHEET 14 OF 16
COMPUTER FILE NAME 13-0107-007_CALL
CITY DRAWING NUMBER 0014