

- CONSTRUCTION NOTES:**
1. ALL PVC PIPE SHALL HAVE CLASS B-TYPE 3 BEDDING AND ALL CONCRETE PIPE SHALL HAVE CLASS B-SAND BEDDING.
 2. ALL BACKFILL TO BE CLASS 3.
 3. CB LEADS TO BE INSTALLED AT MIN. 1.0% SLOPE OR AS DIRECTED BY CONTRACT ADMINISTRATOR.
 4. PIPE INSTALLED IN C.P.R. R.O.W. TO BE INSTALLED USING PIPE JACKING METHOD. NO EXCAVATIONS ARE PERMITTED WITHIN THE C.P.R. R.O.W.
 5. PIPE CROSSING IN C.P.R. R.O.W. TO BE CONSTRUCTED, MAINTAINED, AND OPERATED IN ACCORDANCE WITH TCE-10 STANDARDS.
 6. INSTALL 150 mm SUB DRAIN IN BOTH DIRECTIONS OF CATCH BASINS ALONG PAVEMENT EDGE AS PER SD-245 AND CAP ENDS.

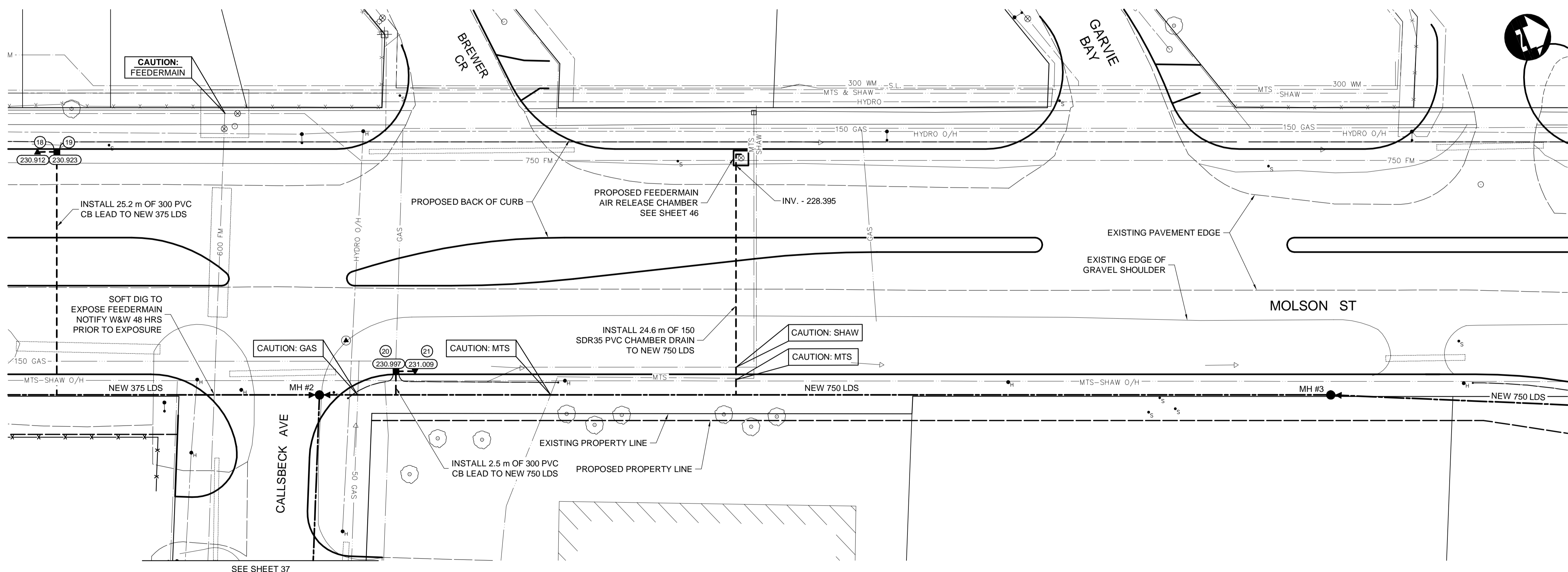

NOTE:
SIGNIFICANT CHANGES TO THE LDS DESIGN WERE MADE FOR ADDENDUM NO. 3 PLEASE REVIEW ALL ASPECTS OF PLAN/PROFILES

METRIC

WHOLE NUMBERS INDICATE MILLIMETRES
DECIMALIZED NUMBERS INDICATE METRES

WARNING

IF POWER EQUIPMENT OR EXPLOSIVES ARE TO BE USED FOR EXCAVATION ON THIS PROJECT THE CONTRACTOR MUST:

1. NOTIFY THE GAS COMPANY OF THE PROPOSED LOCATION OF EXCAVATION.
2. TAKE PRECAUTION TO AVOID DAMAGE TO GAS COMPANY INSTALLATIONS SEE PROVINCIAL REGULATION 210/72 FOR DETAILS.
3. OBTAIN EXCAVATION PERMITS PRIOR TO CONSTRUCTION.

APEGM
Certificate of Authorization
Dillon Consulting Limited (MB)
No. 1789 Date: 01/14/2014

| | | | | | | | | |
|-------------|---------------------|-------------|---------------------|-------------------|----------------|----------------|----------------|----------------|
| 150 WM | WATERMAIN | 150 WM | HYDRO | HYDRO | HYDRO | 150 WM | WATERMAIN | 150 WM |
| HYDRANT | HYDRANT | 300 LDS | LAND DRAINAGE SEWER | WASTE WATER SEWER | MANHOLE | CATCH BASIN | CURB INLET | JUNCTIONS |
| VALVE | VALVE | 250 WWS | LAND DRAINAGE SEWER | WASTE WATER SEWER | MANHOLE | CATCH BASIN | CURB INLET | JUNCTIONS |
| 300 LDS | LAND DRAINAGE SEWER | 250 WWS | LAND DRAINAGE SEWER | WASTE WATER SEWER | MANHOLE | CATCH BASIN | CURB INLET | JUNCTIONS |
| 250 WWS | WASTE WATER SEWER | MANHOLE | CATCH BASIN | CURB INLET | JUNCTIONS | CULVERT | 100 GAS | GAS |
| MANHOLE | CATCH BASIN | CURB INLET | JUNCTIONS | CULVERT | 100 GAS | GAS | EXISTING | LEGEND-PLAN |
| CATCH BASIN | CURB INLET | JUNCTIONS | CULVERT | 100 GAS | GAS | EXISTING | LEGEND-PLAN | PROPOSED |
| CURB INLET | JUNCTIONS | CULVERT | 100 GAS | GAS | EXISTING | LEGEND-PLAN | PROPOSED | EXISTING |
| JUNCTIONS | CULVERT | 100 GAS | GAS | EXISTING | LEGEND-PLAN | PROPOSED | EXISTING | LEGEND-PROFILE |
| CULVERT | 100 GAS | GAS | EXISTING | LEGEND-PLAN | PROPOSED | EXISTING | LEGEND-PROFILE | PROPOSED |
| 100 GAS | GAS | EXISTING | LEGEND-PLAN | PROPOSED | EXISTING | LEGEND-PROFILE | PROPOSED | |
| GAS | EXISTING | LEGEND-PLAN | PROPOSED | EXISTING | LEGEND-PROFILE | PROPOSED | | |
| EXISTING | LEGEND-PLAN | PROPOSED | EXISTING | LEGEND-PROFILE | PROPOSED | | | |

| UNDERGROUND STRUCTURES | | B.M. ELEV. | DESIGNED BY | WPN |
|------------------------|---------------------------|------------|-------------|------|
| NO. | REVISIONS | DATE | BY | DATE |
| 5 | ISSUED FOR ADDENDUM NO. 3 | 01/14/14 | JNC | |
| 4 | ISSUED FOR ADDENDUM NO. 1 | 01/06/14 | JNC | |
| 3 | ISSUED FOR TENDER | 12/16/13 | JNC | |
| 2 | ISSUED FOR REVIEW | 07/22/13 | JNC | |
| 1 | ISSUED FOR REVIEW | 06/21/13 | JNC | |
| DATE | 01/14/2014 | | | |

DILLON CONSULTING

ENGINEER'S SEAL
PROVINCE OF MANITOBA
W.P. NAIRN
01/14/2014
Member 34277
REGISTERED PROFESSIONAL ENGINEER

CONSULTANT PROJECT NUMBER
12-7055

THE CITY OF WINNIPEG
PUBLIC WORKS DEPARTMENT

PANET ROAD/MOLSON STREET
RECONSTRUCTION AND TWINNING

LDS - PANET-MOLSON (2 OF 3)

CITY DRAWING NUMBER
P-3350-35

SHEET **35** OF **47**

CONSULTANT DRAWING NUMBER

G:\CAD\127055\02-Civil\01-Contract\10-Plan-Profile-LDS.dwg