

- CONSTRUCTION NOTES:**
1. ALL PVC PIPE SHALL HAVE CLASS B-TYPE 3 BEDDING AND ALL CONCRETE PIPE SHALL HAVE CLASS B-SAND BEDDING.
 2. ALL BACKFILL TO BE CLASS 3.
 3. CB LEADS TO BE INSTALLED AT MIN. 1.0% SLOPE OR AS DIRECTED BY CONTRACT ADMINISTRATOR.
 4. PIPE INSTALLED IN C.P.R. R.O.W. TO BE INSTALLED USING PIPE JACKING METHOD. NO EXCAVATIONS ARE PERMITTED WITHIN THE C.P.R. R.O.W.
 5. PIPE CROSSING IN C.P.R. R.O.W. TO BE CONSTRUCTED, MAINTAINED, AND OPERATED IN ACCORDANCE WITH TCE-10 STANDARDS.
 6. INSTALL 150 mm SUB DRAIN IN BOTH DIRECTIONS OF CATCH BASINS ALONG PAVEMENT EDGE AS PER SD-245 AND CAP ENDS.

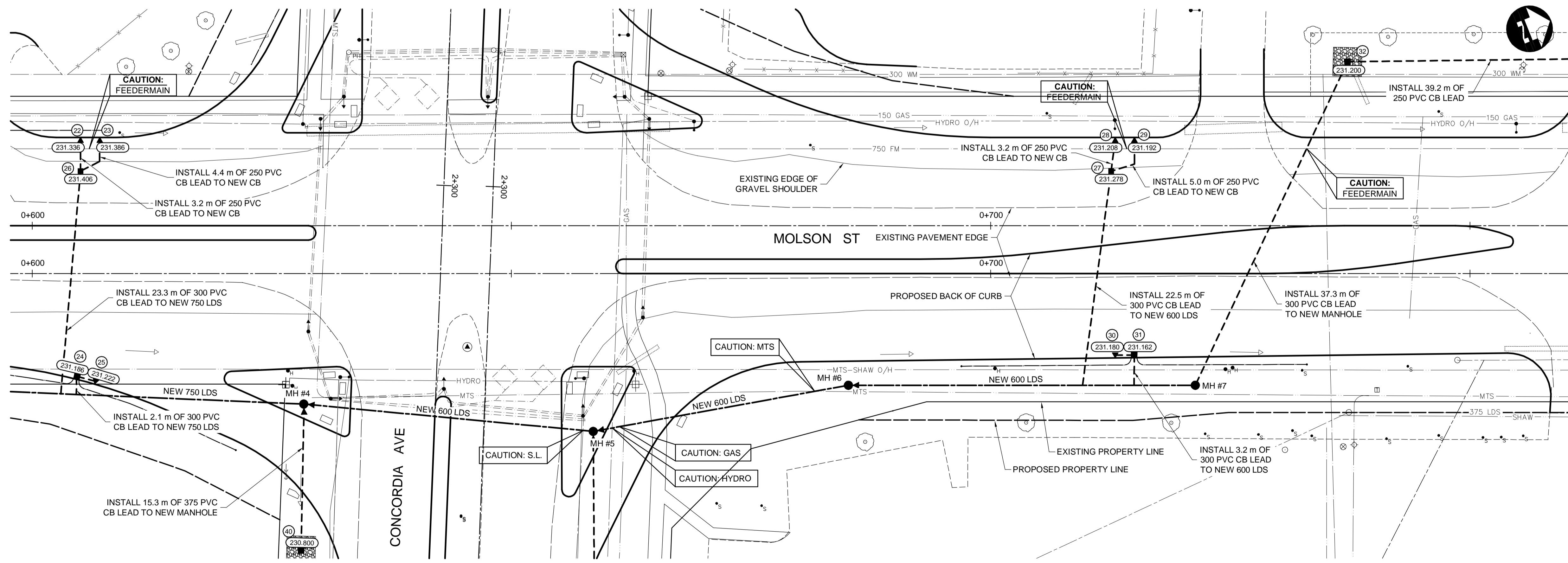

NOTE: SIGNIFICANT CHANGES TO THE LDS DESIGN WERE MADE FOR ADDENDUM NO. 3 PLEASE REVIEW ALL ASPECTS OF PLAN/PROFILES

METRIC

WHOLE NUMBERS INDICATE MILLIMETRES
DECIMALIZED NUMBERS INDICATE METRES

WARNING

IF POWER EQUIPMENT OR EXPLOSIVES ARE TO BE USED FOR EXCAVATION ON THIS PROJECT THE CONTRACTOR MUST:

1. NOTIFY THE GAS COMPANY OF THE PROPOSED LOCATION OF EXCAVATION.
2. TAKE PRECAUTION TO AVOID DAMAGE TO GAS COMPANY INSTALLATIONS SEE PROVINCIAL REGULATION 210/72 FOR DETAILS.
3. OBTAIN EXCAVATION PERMITS PRIOR TO CONSTRUCTION.

APEGM
Certificate of Authorization
Dillon Consulting Limited (MB)
No. 1789 Date: 01/14/2014

G:\CAD\127055\02-Civil\01-Contract\10-Plan-Profile-LDS.dwg

150 WM	WATERMAIN	150 WM	HYDRO	HYDRO	HYDRO	150 WM	WATERMAIN	150 WM
300 LDS	HYDRANT VALVE	300 LDS	MTS	MTS	300 LDS	300 LDS	HYDRANT VALVE	300 LDS
250 WWS	LAND DRAINAGE SEWER	250 WWS		CONCRETE	250 WWS	250 WWS	WASTE WATER SEWER	250 WWS
	WASTE WATER SEWER			ASPHALT			LAND DRAINAGE SEWER	
	MANHOLE			PLANING			WASTE WATER SEWER	
	CATCH BASIN			SIDEWALK			PROFILE	
	CURB INLET			PAVING STONES			NORTH/WEST GUTTER	
	JUNCTIONS			PARTIAL DEPTH REPAIR			SOUTH/EAST GUTTER	
	CULVERT			PROPERTY LINE			NORTH/WEST DITCH	
100 GAS	GAS	100 GAS		DRAINAGE ARROW			SOUTH/EAST DITCH	
				CURB RAMP				
EXISTING	LEGEND-PLAN	PROPOSED	EXISTING	LEGEND-PLAN	PROPOSED	EXISTING	LEGEND-PROFILE	PROPOSED

UNDERGROUND STRUCTURES		B.M. ELEV.
SUPV. U/G STRUCTURES	DATE	
4	ISSUED FOR ADDENDUM NO. 3	01/14/14 JNC
3	ISSUED FOR TENDER	12/16/13 JNC
2	ISSUED FOR REVIEW	07/22/13 JNC
1	ISSUED FOR REVIEW	06/21/13 JNC
NO.	REVISIONS	DATE BY
		01/14/2014

DESIGNED BY: WPN
DRAWN BY: TJH
CHECKED BY: JNC
APPROVED BY: DPK
HOR. SCALE: 1:250
VERTICAL: 1:50
RELEASED FOR CONSTRUCTION: DATE

ENGINEER'S SEAL
PROVINCE OF MANITOBA
REGISTERED PROFESSIONAL ENGINEER
W.P. NAIRN
01/14/2014
Member 34277
CONSULTANT PROJECT NUMBER: 12-7055

THE CITY OF WINNIPEG
PUBLIC WORKS DEPARTMENT
Winnipeg
PANET ROAD/MOLSON STREET
RECONSTRUCTION AND TWINNING
LDS - PANET-MOLSON (3 OF 3)
CITY DRAWING NUMBER: P-3350-36
SHEET 36 OF 47
CONSULTANT DRAWING NUMBER