

NOTE: CONTRACTOR TO MAINTAIN
MINIMUM 3.5m LANE WIDTHS

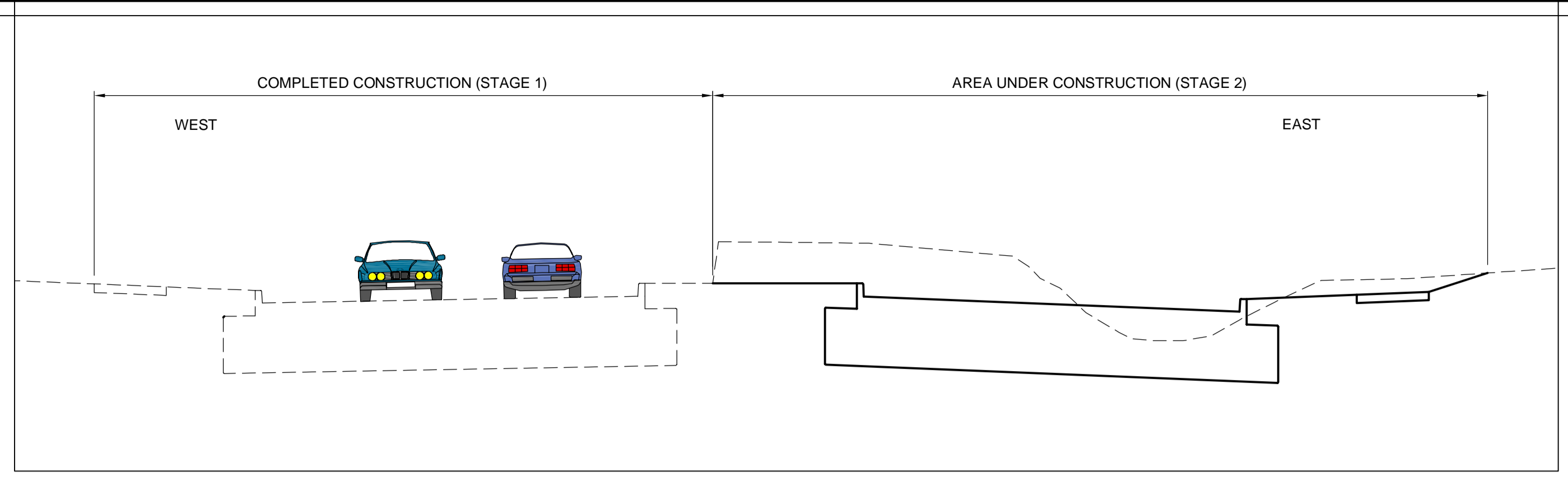

TYPICAL STAGE 2 SECTION

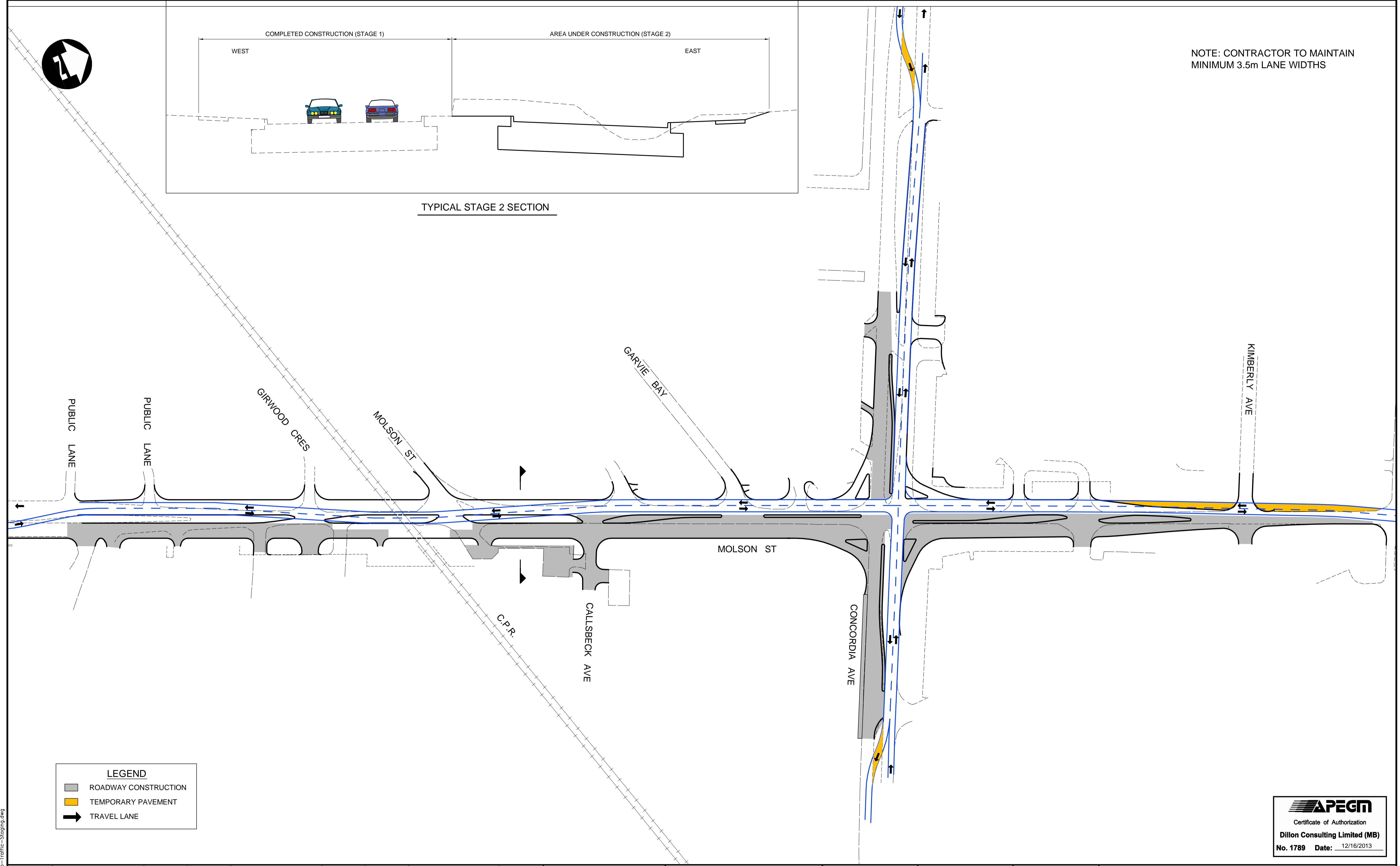

LEGEND

- ROADWAY CONSTRUCTION
- TEMPORARY PAVEMENT
- TRAVEL LANE

APEGM
Certificate of Authorization
Dillon Consulting Limited (MB)
No. 1789 Date: 12/16/2013

150 WM	WATERMAIN	150 WM	HYDRO	HYDRO	HYDRO	150 WM	WATERMAIN	150 WM
⊕	HYDRANT	⊕	MTS	MTS	MTS	⊕	HYDRANT	⊕
⊗	VALVE	⊗				⊗	VALVE	⊗
300 LDS	LAND DRAINAGE SEWER	300 LDS				300 LDS	LAND DRAINAGE SEWER	300 LDS
250 WWS	WASTE WATER SEWER	250 WWS				250 WWS	WASTE WATER SEWER	250 WWS
○	MANHOLE	●				○	MANHOLE	●
□	CATCH BASIN	■				□	CATCH BASIN	■
▽	CURB INLET	▽				▽	CURB INLET	▽
—	JUNCTIONS	—				—	JUNCTIONS	—
—	CULVERT	—				—	CULVERT	—
100 GAS	GAS	100 GAS				100 GAS	GAS	100 GAS
EXISTING	LEGEND—PLAN	PROPOSED	EXISTING	LEGEND—PLAN	PROPOSED	EXISTING	LEGEND—PROFILE	PROPOSED

UNDERGROUND STRUCTURES

SUPPLY, U/G STRUCTURES DATE

LOCATION OF UNDERGROUND STRUCTURES AS SHOWN ARE BASED ON THE BEST INFORMATION AVAILABLE, BUT NO GUARANTEE IS GIVEN THAT ALL EXISTING UTILITIES ARE SHOWN OR THAT THE GIVEN LOCATIONS ARE EXACT. CONFIRMATION OF EXISTENCE AND EXACT LOCATION OF ALL SERVICES MUST BE OBTAINED FROM THE INDIVIDUAL UTILITIES BEFORE PROCEEDING WITH CONSTRUCTION.

B.M. ELEV.	NO.	REVISIONS	DATE	BY
	3	ISSUED FOR TENDER	12/16/13	JNC
	2	ISSUED FOR REVIEW	07/22/13	JNC
	1	ISSUED FOR REVIEW	06/21/13	JNC

DESIGNED BY	JMS/MRD
DRAWN BY	TJH
CHECKED BY	JNC
APPROVED BY	DPK
HOR. SCALE	NTS
VERTICAL	
DATE	12/16/2013

DILLON CONSULTING

RELEASED FOR CONSTRUCTION

ENGINEER'S SEAL
PROVINCE OF MANITOBA
REGISTERED PROFESSIONAL ENGINEER
J.N. CRANG
12/16/2013
CONSULTANT PROJECT NUMBER
12-7055

THE CITY OF WINNIPEG
PUBLIC WORKS DEPARTMENT

PANET ROAD/MOLSON STREET
RECONSTRUCTION AND TWINNING

CONSTRUCTION-TRAFFIC STAGING - PHASE 2

CITY DRAWING NUMBER
P-3350-12
SHEET 12 OF 45
CONSULTANT DRAWING NUMBER

GA:\CAD\127055\02-Civil\01-Contract\15-Traffic-Staging.dwg