

- CONSTRUCTION NOTES:**
1. ALL PVC PIPE SHALL HAVE CLASS B-TYPE 3 BEDDING AND ALL CONCRETE PIPE SHALL HAVE CLASS B-SAND BEDDING.
 2. BACKFILL UNDER PAVEMENT, IN SIDEWALKS, & WITHIN 1.0 M OF PAVEMENT TO BE 6" LIMESTONE FLOOD TAMPED.
 3. BACKFILL IN BOULEVARD TO BE CLASS 5.
 4. ALL CATCH BASIN LEADS TO BE 200 Ø AND INSTALLED AT MIN. 1.0% SLOPE OR AS DIRECTED BY CONTRACT ADMINISTRATOR.
 5. PIPE INSTALLED IN C.P.R. R.O.W. TO BE INSTALLED USING PIPE JACKING METHOD. NO EXCAVATIONS ARE PERMITTED WITHIN THE C.P.R. R.O.W.
 6. PIPE CROSSING IN C.P.R. R.O.W. TO BE CONSTRUCTED, MAINTAINED, AND OPERATED IN ACCORDANCE WITH TCE-10 STANDARDS.
 7. WARNING SIGN TO BE INSTALLED NEAR PROPERTY LINES INDICATING BURIED UTILITY.

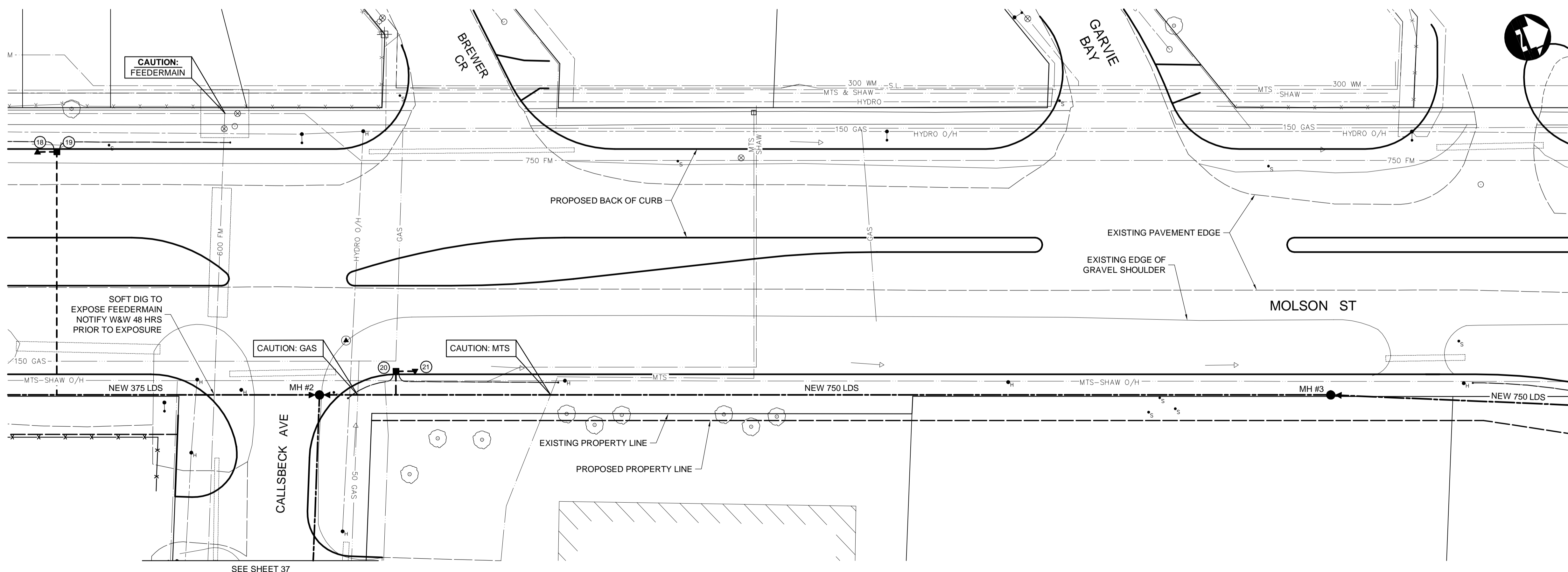

* SEE PLAN/PROFILE SHEETS FOR CATCH BASIN AND CATCH PIT DATA

METRIC

WHOLE NUMBERS INDICATE MILLIMETRES
DECIMALIZED NUMBERS INDICATE METRES

WARNING

IF POWER EQUIPMENT OR EXPLOSIVES ARE TO BE USED FOR EXCAVATION ON THIS PROJECT THE CONTRACTOR MUST:

1. NOTIFY THE GAS COMPANY OF THE PROPOSED LOCATION OF EXCAVATION.
2. TAKE PRECAUTION TO AVOID DAMAGE TO GAS COMPANY INSTALLATIONS SEE PROVINCIAL REGULATION 210/72 FOR DETAILS.
3. OBTAIN EXCAVATION PERMITS PRIOR TO CONSTRUCTION.

APEGM
Certificate of Authorization
Dillon Consulting Limited (MB)
No. 1789 Date: 12/16/2013

150 WM	WATERMAIN	150 WM	HYDRO	HYDRO	HYDRO	150 WM	WATERMAIN	150 WM
HYDRANT	HYDRANT	MTS	MTS	MTS	MTS	HYDRANT	HYDRANT	HYDRANT
VALVE	VALVE	CONCRETE	CONCRETE	CONCRETE	CONCRETE	VALVE	VALVE	VALVE
300 LDS	LAND DRAINAGE SEWER	300 LDS	WASTE WATER SEWER	300 LDS	WASTE WATER SEWER	300 LDS	LAND DRAINAGE SEWER	300 LDS
250 WWS	WASTE WATER SEWER	250 WWS	WASTE WATER SEWER	250 WWS	WASTE WATER SEWER	250 WWS	WASTE WATER SEWER	250 WWS
MANHOLE	MANHOLE	MANHOLE	MANHOLE	MANHOLE	MANHOLE	MANHOLE	MANHOLE	MANHOLE
CATCH BASIN	CATCH BASIN	CATCH BASIN	CATCH BASIN	CATCH BASIN	CATCH BASIN	CATCH BASIN	CATCH BASIN	CATCH BASIN
CURB INLET	CURB INLET	CURB INLET	CURB INLET	CURB INLET	CURB INLET	CURB INLET	CURB INLET	CURB INLET
JUNCTIONS	JUNCTIONS	JUNCTIONS	JUNCTIONS	JUNCTIONS	JUNCTIONS	JUNCTIONS	JUNCTIONS	JUNCTIONS
CULVERT	CULVERT	CULVERT	CULVERT	CULVERT	CULVERT	CULVERT	CULVERT	CULVERT
100 GAS	GAS	100 GAS	GAS	100 GAS	GAS	100 GAS	GAS	100 GAS
EXISTING	LEGEND-PLAN	PROPOSED	EXISTING	LEGEND-PLAN	PROPOSED	EXISTING	LEGEND-PROFILE	PROPOSED

NO.	REVISIONS	DATE	BY
3	ISSUED FOR TENDER	12/16/13	JNC
2	ISSUED FOR REVIEW	07/22/13	JNC
1	ISSUED FOR REVIEW	06/21/13	JNC

DESIGNED BY: WPN
DRAWN BY: TJH
CHECKED BY: JNC
APPROVED BY: DPK

RELEASING FOR CONSTRUCTION: 12/16/2013

CONSULTANT PROJECT NUMBER: 12-7055

THE CITY OF WINNIPEG
PUBLIC WORKS DEPARTMENT

PANET ROAD/MOLSON STREET
RECONSTRUCTION AND TWINNING

LDS - PANET-MOLSON (2 OF 3)

CITY DRAWING NUMBER: P-3350-35
SHEET OF: 35 OF 45
CONSULTANT DRAWING NUMBER

G:\CAD\127055\02-Civil\01-Contract\10-Plan-Profile-LDS.dwg