

ALLEY PAVEMENT PROFILE
SCALE: 1:250 HOR
1:10 VER

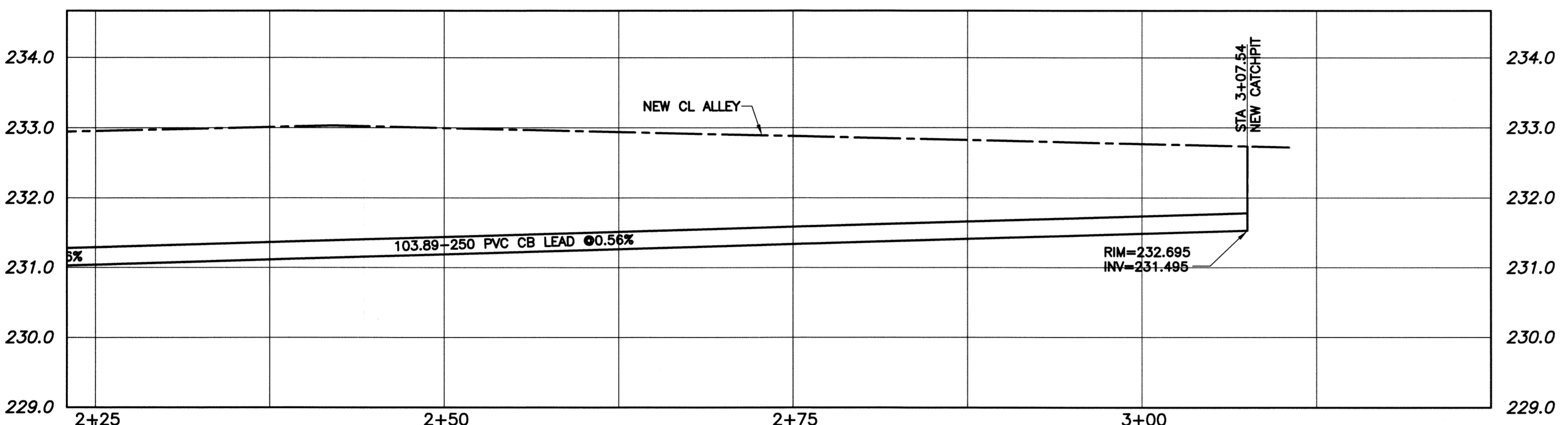

ALLEY UNDERGROUND PROFILE
SCALE: 1:250 HOR
1:50 VER

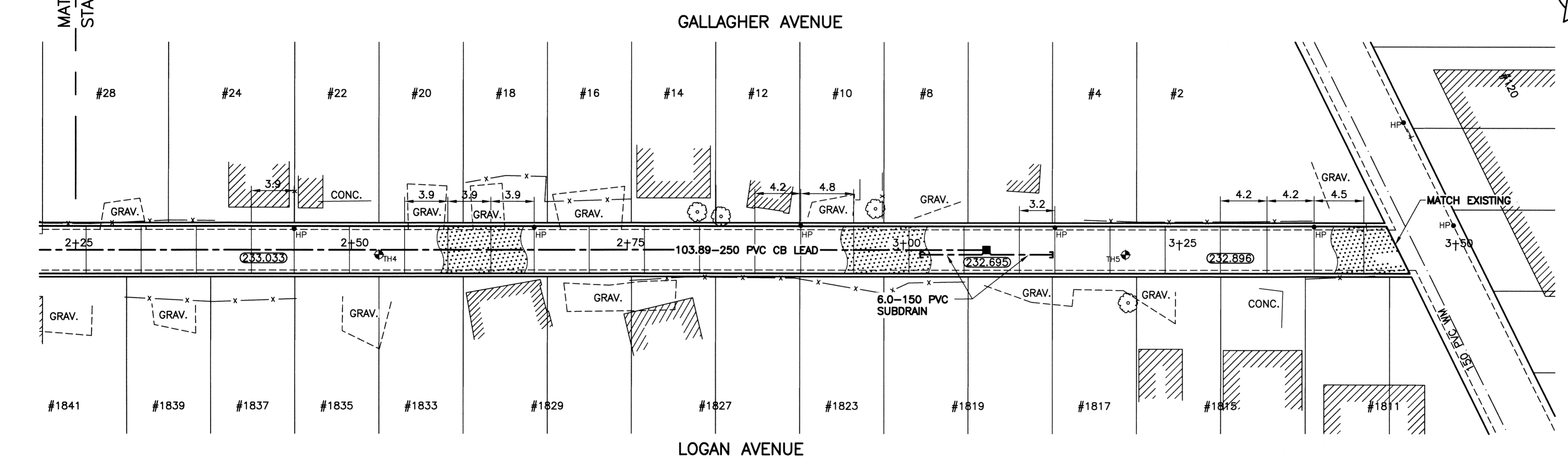

ALLEY PAVEMENT PLAN
SCALE: 1:250 HOR

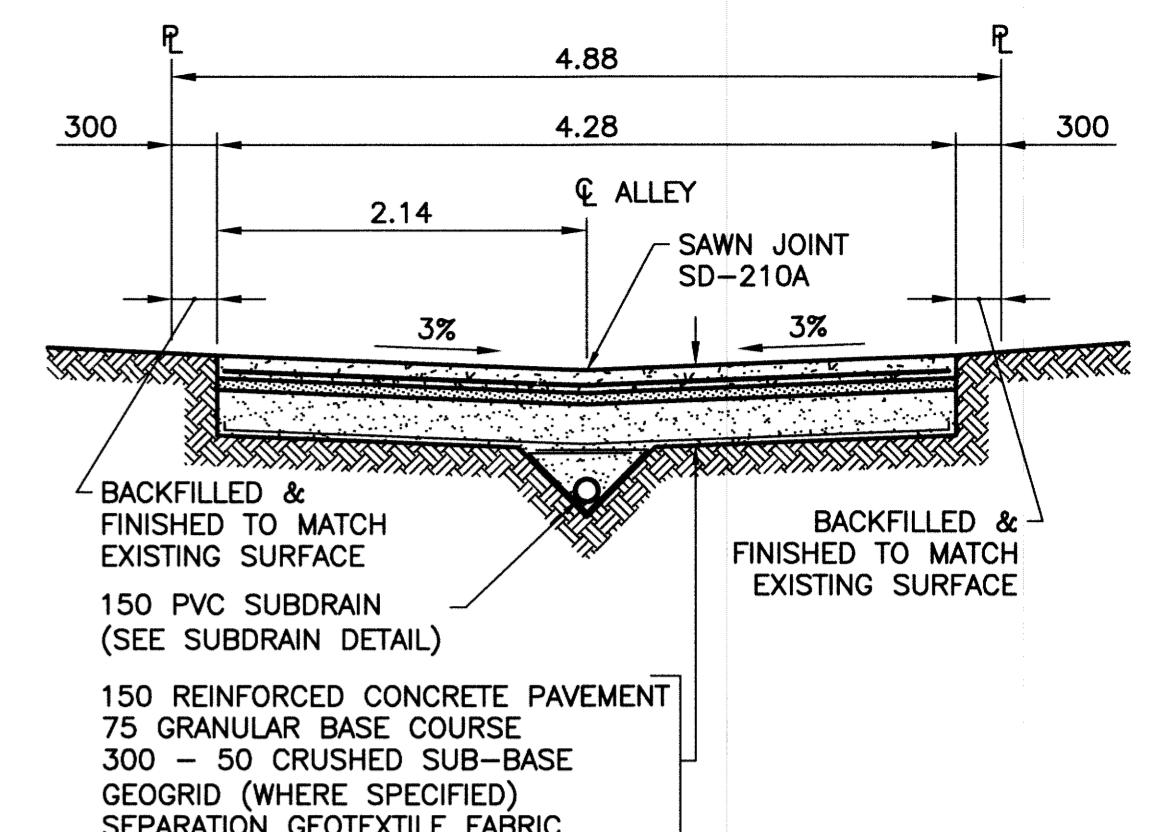

TYPICAL CROSS SECTION
SCALE: NTS

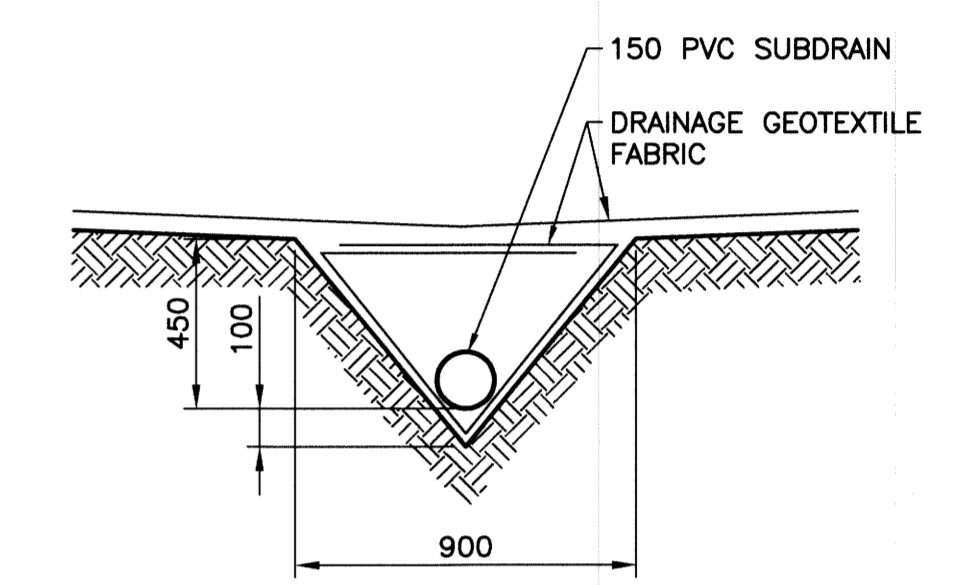

SUBDRAIN DETAIL
SCALE: 1:20

NOTES:

1. STATION CHAINAGE IS BASED ON CENTERLINE OF ALLEY RIGHT OF WAY.
2. ADJUST MH AND CB RIMS TO NEW GRADES.
3. PLUG SUBDRAINS AT TERMINAL ENDS.
4. REGRADE EXISTING PRIVATE SIDEWALKS AS REQUIRED.
5. INSTALLATION OF LIP CURBS AND THEIR EXTENTS TO BE DETERMINED BY THE CONTRACT ADMINISTRATOR.
6. LIGHT STANDARDS, HYDRO POLES AND THEIR ANCHORS MAY REQUIRE TEMPORARY SUPPORT/REMOVAL OR REPLACEMENT AT THE CONTRACTOR'S EXPENSE.
7. ISOLATE ALL POLES, BASES AND PILES WITHIN ALLEY RIGHT OF WAY (SD-228C)
8. AVOID DAMAGE TO EXISTING TREES WITHIN THE LIMITS OF CONSTRUCTION.

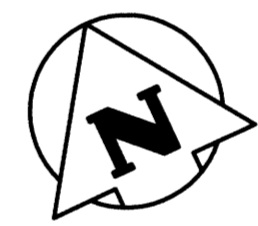

KEEWATIN STREET

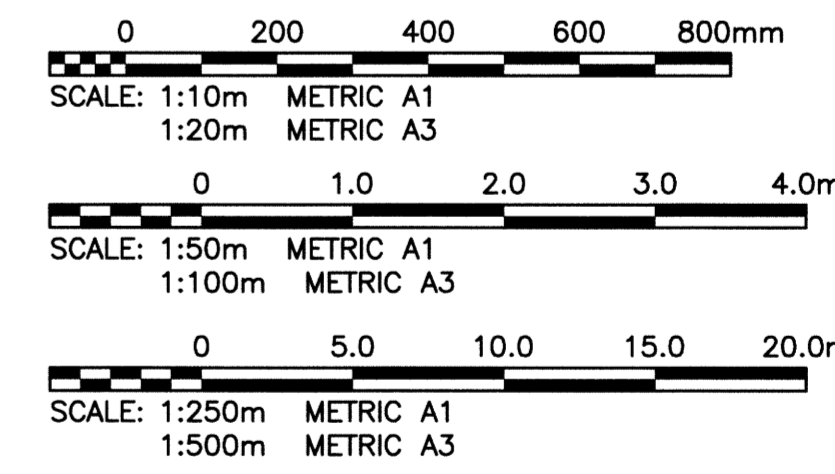

WARNING

NOTIFY THE GAS COMPANY OF THE PROPOSED LOCATION OF EXCAVATION. TAKE PRECAUTION TO AVOID DAMAGE TO GAS COMPANY INSTALLATIONS. SEE PROVINCIAL REGULATION 210/72 FOR DETAILS.

METRIC

WHOLE NUMBERS INDICATE MILLIMETRES
DECIMALIZED NUMBERS INDICATE METRES

PROPERTY LIMITS DELINEATION

DELINEATION OF PROPERTY LIMITS AS SHOWN ON THIS DWG DOES NOT REPRESENT A "LEGAL SURVEY". KGS GROUP MAKES NO REPRESENTATION OR WARRANTY AS TO THE ACCURACY OF PROPERTY LIMITS DELINEATED ON THIS DWG, NOR ON THE DIMENSIONAL ACCURACY OF DWG FEATURES RELATIVE TO THOSE PROPERTY LIMITS.



300_LDS	LAND DRAINAGE SEWER	300_LDS							
250_WWS	WASTE WATER SEWER	250_WWS							
	GAS								
	HYDRO								
	M.T.S.								
150_WM	WATERMAIN	150_WM							
	HYDRANT								
	VALVE								
	MANHOLE								
	CATCH BASIN								
	CURB INLET								
	POLES								
EXISTING	LEGEND-PLAN	PROPOSED	EXISTING	LEGEND-PLAN	PROPOSED	EXISTING	LEGEND-PROFILE	PROPOSED	

LOCATION APPROVED UNDERGROUND STRUCTURES		B.M. - 8 ELEV. - 232.957	S.W. Cor. Logan Ave. & Kewatini St., Tbl. in N. Conc. foundation No. 1800 Logan Ave. (Westbrook Medical Centre), 3.0m W. & 0.3m below brick of N.E. Cor of Bldg.
SUPV. U/G STRUCTURES COMMITTEE	DATE		
NOTE: LOCATION OF UNDERGROUND STRUCTURES AS SHOWN ARE BASED ON THE BEST INFORMATION AVAILABLE BUT NO GUARANTEE IS GIVEN THAT ALL EXISTING UTILITIES ARE SHOWN OR THAT THE GIVEN LOCATIONS ARE EXACT. CONFIRMATION OF EXISTENCE AND EXACT LOCATION OF ALL SERVICES MUST BE OBTAINED FROM THE INDIVIDUAL UTILITIES BEFORE PROCEEDING WITH CONSTRUCTION.			
NO.	ISSUED FOR TENDER	13/08/13	CR
NO.	REVISIONS	DATE	BY

KGS GROUP CONSULTING ENGINEERS		DESIGNED BY	AKW	CHECKED BY	CR
		DRAWN BY	DMW	APPROVED BY	CR
		HOR. SCALE:	1:250	RELEASED FOR CONSTRUCTION:	
		VERTICAL:	1:50	DATE	13/08/12

ENGINEER'S SEAL
PROVINCE OF MANITOBA
M.C. ROWBOTHAM
22678
August 13, 2013
CONSULTANT DRAWING NO.
13-0107-006_C08

THE CITY OF WINNIPEG
PUBLIC WORKS DEPARTMENT
TRANSPORTATION ENGINEERING DIVISION

PROJECT TITLE
2013 LOCAL IMPROVEMENT ALLEY PROGRAM

SHEET OF
08 OF 09

COMPUTER FILE NAME
13-0107-006_CALL

CITY DRAWING NUMBER
0008

GALLAGHER AVE/LOGAN AVE
DEE ST TO KEEWATIN ST
STA 2+25 TO WEST ALLEY

P:\Projects\2013\13-0107-006\Doc\Control\ToBeIssued\DWG\13-0107-006_C08-Rev. 0.dwg - Tab: 08 Plotted By: Gloewen 08/13/2013 [True 1:02pm] PLOT 1:1 A-1