

**ALLEY PAVEMENT PROFILE**  
SCALE: 1:250 HOR  
1:10 VER

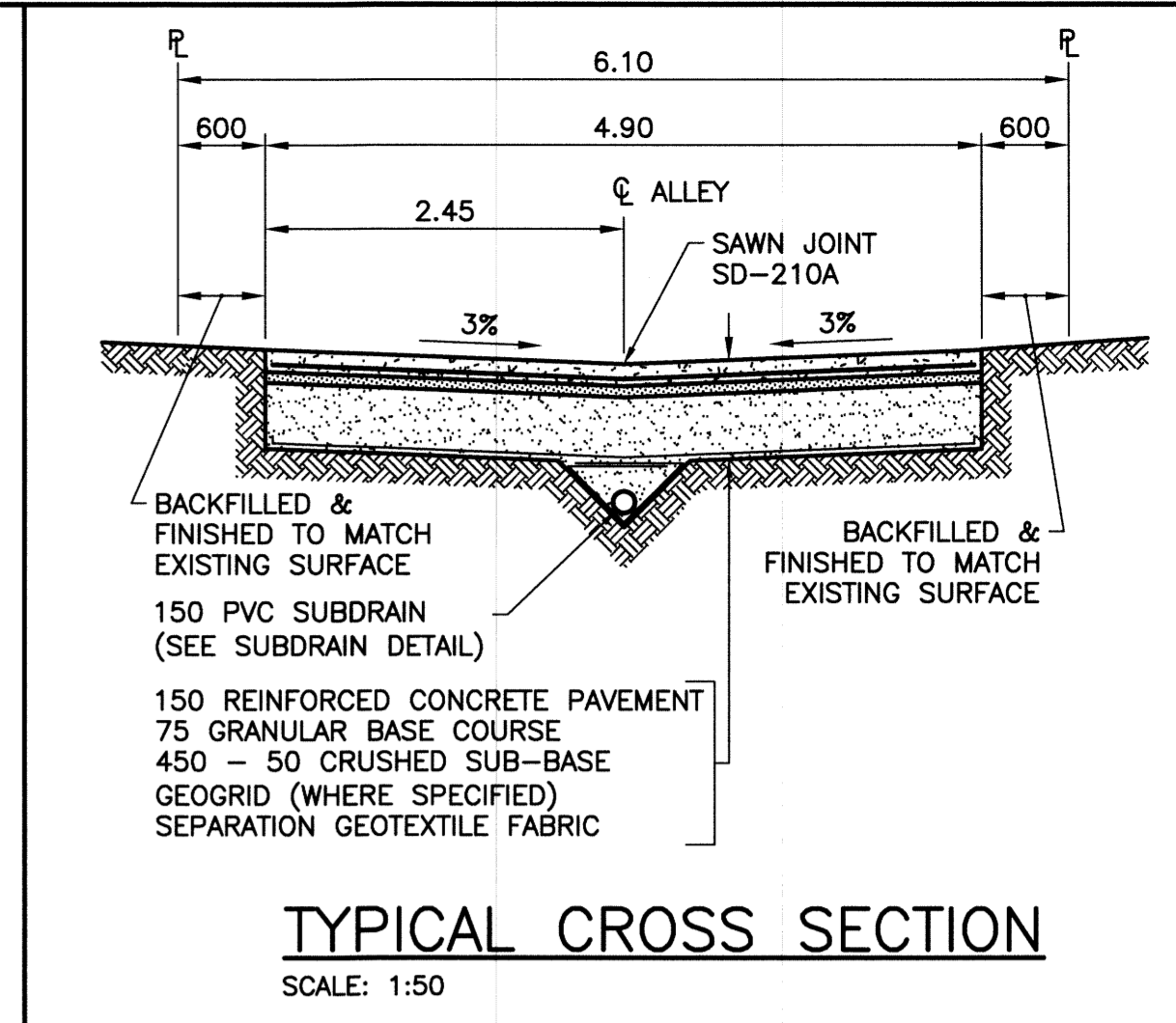

**TYPICAL CROSS SECTION**  
SCALE: 1:50

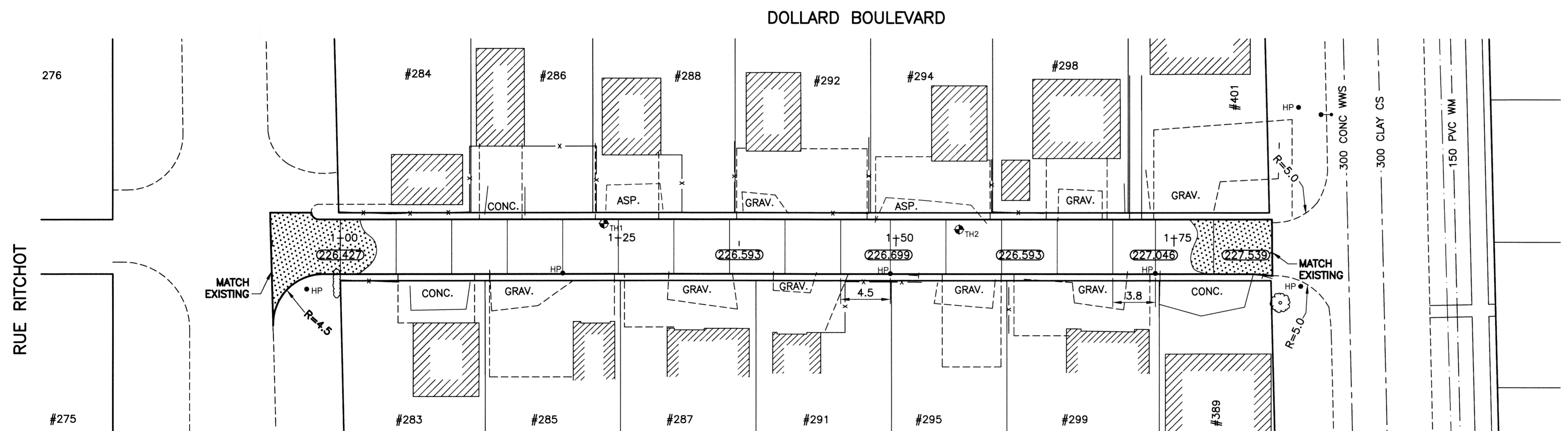

**ALLEY PAVEMENT PLAN**  
SCALE: 1:250 HOR

- NOTES:**
1. STATION CHAINAGE IS BASED ON CENTERLINE OF ALLEY RIGHT OF WAY.
  2. ADJUST MH AND CB RIMS TO NEW GRADES.
  3. PLUG SUBDRAINS AT TERMINAL ENDS.
  4. REGRADE EXISTING PRIVATE SIDEWALKS AS REQUIRED.
  5. INSTALLATION OF LIP CURBS AND THEIR EXTENTS TO BE DETERMINED BY THE CONTRACT ADMINISTRATOR.
  6. LIGHT STANDARDS, HYDRO POLES AND ANCHORS MAY REQUIRE TEMPORARY SUPPORT/REMOVAL OR REPLACEMENT AT THE CONTRACTOR'S EXPENSE.
  7. ISOLATE ALL POLES, BASES AND PILES WITHIN ALLEY RIGHT OF WAY (SD-228C)
  8. AVOID DAMAGE TO EXISTING TREES WITHIN THE LIMITS OF CONSTRUCTION.

**WARNING**  
NOTIFY THE GAS COMPANY OF THE PROPOSED LOCATION OF EXCAVATION. TAKE PRECAUTION TO AVOID DAMAGE TO GAS COMPANY INSTALLATIONS. SEE PROVINCIAL REGULATION 210/72 FOR DETAILS.



RUE ST JEAN BAPTISTE

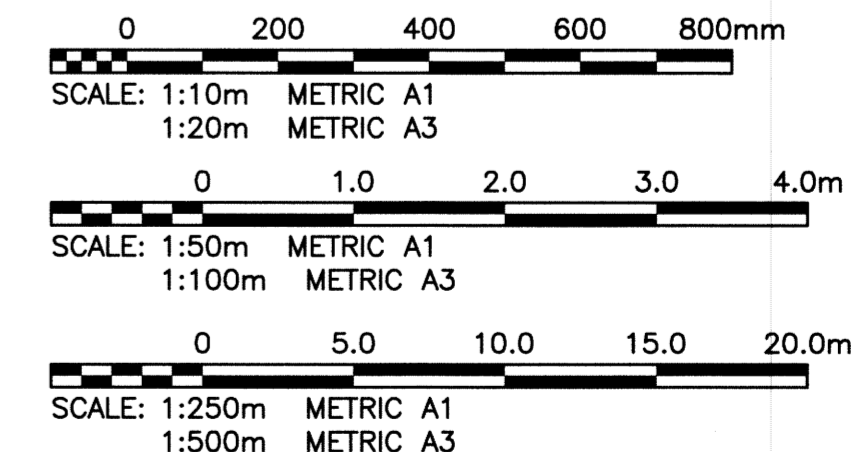

**METRIC**  
WHOLE NUMBERS INDICATE MILLIMETRES  
DECIMALIZED NUMBERS INDICATE METRES

**PROPERTY LIMITS DELINEATION**  
DELINEATION OF PROPERTY LIMITS AS SHOWN ON THIS DWG DOES NOT REPRESENT A "LEGAL SURVEY". KGS GROUP MAKES NO REPRESENTATION OR WARRANTY AS TO THE ACCURACY OF PROPERTY LIMITS DELINEATED ON THIS DWG, NOR ON THE DIMENSIONAL ACCURACY OF DWG FEATURES RELATIVE TO THOSE PROPERTY LIMITS.



300 LGS	LAND DRAINAGE SEWER	300 LGS	TEST HOLE			
250 WWS	WASTE WATER SEWER	250 WWS	GUY WIRE			
---	GAS	---	LIGHT STANDARD			
---	HYDRO	---	BACK OF CURB			
---	M.T.S.	---	CONCRETE			
150 WM	WATERMAIN	150 WM	ASPHALT			
+	HYDRANT	+	SIDEWALK			
⊗	VALVE	⊗	PROPERTY LINE			
○	MANHOLE	○	SURVEY BAR			
□	CATCH BASIN	□	GEODETIC BENCHMARK			
▽	CURB INLET	▽	ELEVATION	32.231	TTTTT	
•	POLES	•	EXISTING	LEGEND-PLAN	PROPOSED	EXISTING
---	LEGEND-PLAN	---	PROPOSED	LEGEND-PROFILE	PROPOSED	EXISTING

**LOCATION APPROVED UNDERGROUND STRUCTURES**  
SUPV. U/G STRUCTURES DATE COMMITTEE

**NOTE:**  
LOCATION OF UNDERGROUND STRUCTURES AS SHOWN ARE BASED ON THE BEST INFORMATION AVAILABLE BUT NO GUARANTEE IS GIVEN THAT ALL EXISTING UTILITIES ARE SHOWN OR THAT THE GIVEN LOCATIONS ARE EXACT. CONFIRMATION OF EXISTENCE AND EXACT LOCATION OF ALL SERVICES MUST BE OBTAINED FROM THE INDIVIDUAL UTILITIES BEFORE PROCEEDING WITH CONSTRUCTION.

B.M. - 10	ELEV. - 231.032	N.W. Cor. Rue Des Meurons & Goulet St. E. in S. Conc. Foundation of Firehall No. 3 in District No. 5, 0.5m below W. & 0.2m below back of S.E. Cor. of Bldg.
NO.	REVISIONS	DATE BY
0	ISSUED FOR TENDER	13/08/13 CR

DESIGNED BY	AKW	CHECKED BY	CR
DRAWN BY	DMW	APPROVED BY	CR
HOR. SCALE:	1:250	RELEASED FOR CONSTRUCTION:	
VERTICAL:	1:50	DATE	13/08/12

ENGINEER'S SEAL  
M.S. ROWBOTHAM  
Member  
22679  
AUGUST 15, 2013  
CONSULTANT DRAWING NO. 13-0107-006\_C09

**THE CITY OF WINNIPEG**  
PUBLIC WORKS DEPARTMENT  
TRANSPORTATION ENGINEERING DIVISION

PROJECT TITLE: 2013 LOCAL IMPROVEMENT ALLEY PROGRAM  
DOLLARD BLVD/BERTRAND ST  
RUE RITSHOT TO RUE ST JEAN BAPTISTE  
STA 0+93.9 TO STA 1+83.9

SHEET OF 09 09  
COMPUTER FILE NAME: 13-0107-006\_CALL  
CITY DRAWING NUMBER: 0009

P:\Projects\2013\13-0107-006\DocControl\ToBalisaued\DWG\13-0107-006\_C09-Rev 0.dwg - Tab: 09 Plotted By: DBaroche 08/13/2013 [Tue 11:47am] PLOT 1:1 A-1