

NOTE:  
SEE DRAWING 30-SHT-CR-1106 FOR TRACKAGE INFORMATION.

NOTE:  
RAILWAY EQUIPMENT AND FACILITIES TO BE PROTECTED DURING CONSTRUCTION.

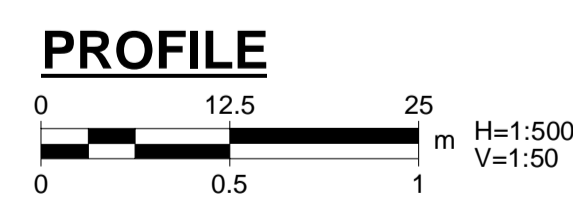
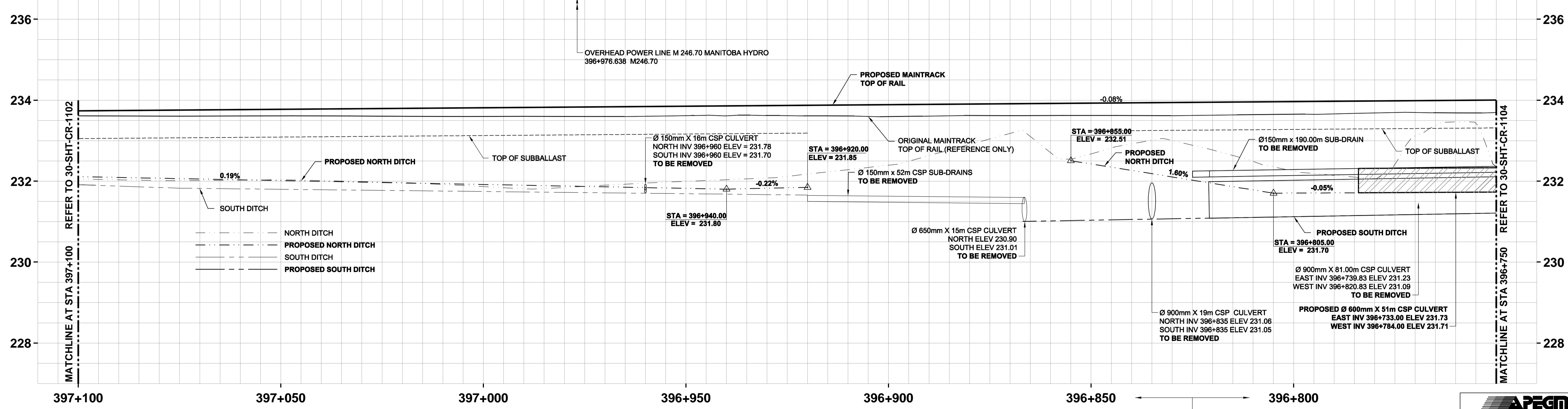
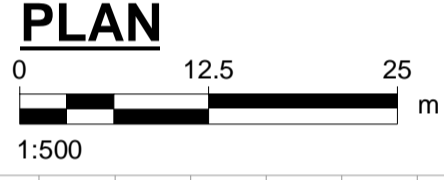

STATIONING REFERENCED ALONG SOUTH MAIN TRACK

**APEGM**  
Certificate of Authorization  
AECOM Canada Ltd.  
No. 4671 Date: 2014/01/22  
BID OPPORTUNITY NO. 712-2013

LOCATION APPROVED UNDERGROUND STRUCTURES

SUPV. U/G STRUCTURES COMMITTEE DATE

NOTE:  
LOCATION OF UNDERGROUND STRUCTURES AS SHOWN ARE BASED ON THE BEST INFORMATION AVAILABLE. BUT NO GUARANTEE IS GIVEN THAT ALL EXISTING UTILITIES ARE SHOWN OR THAT THE GIVEN LOCATIONS ARE EXACT. CONFIRMATION OF EXISTENCE AND EXACT LOCATION OF ALL SERVICES MUST BE OBTAINED FROM THE INDIVIDUAL UTILITIES BEFORE PROCEEDING WITH CONSTRUCTION.

NO.	REVISIONS	DATE	BY
2	Issued For Addendum	14/01/22	RCP
1	Issued For Addendum	13/12/10	RCP
0	Issued For Tender	13/10/15	RCP

<b>AECOM</b>		ENGINEER'S SEAL	
DESIGNED BY: BRP	CHECKED BY: BJM		
DRAWN BY: WD	APPROVED BY: RCP		
HOR. SCALE: 1:500	RELEASED FOR CONSTRUCTION BY:		
DATE: 2014/01/22	DATE: 2014/01/22	CONSULTANT DRAWING NO. 30-SHT-CR-1103	

**THE CITY OF WINNIPEG PUBLIC WORKS DEPARTMENT**

PLESSIS ROAD TWINNING AND GRADE SEPARATION AT CN REDDITT SUBDIVISION CONTRACT 3

SHOOFLY REMOVAL AND FINAL CONFIGURATION  
PLAN AND PROFILE  
Sta. 396+750 to Sta. 397+100

CITY DRAWING NUMBER U238-2014-2203  
SHEET 03 OF 14  
**CR-1103**