

2013-05-08

MATCHLINE: PLESSIS SOUTHBOUND - STA. 2+420 (SEE SHEET CT-0005)

MATCHLINE: PLESSIS SOUTHBOUND - STA. 2+580 (SEE SHEET CT-0007)

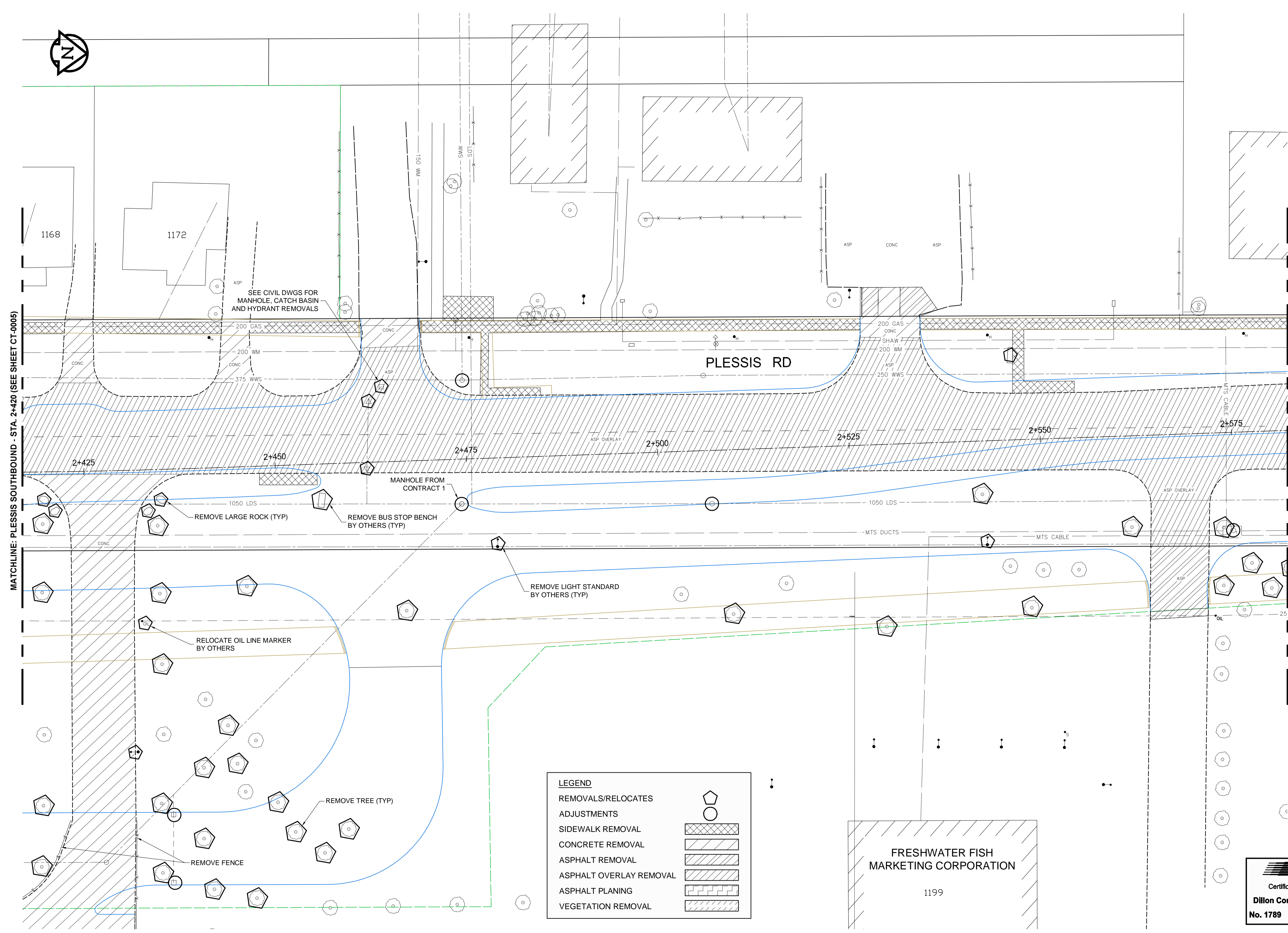

LEGEND	
REMOVALS/RELOCATES	
ADJUSTMENTS	
SIDEWALK REMOVAL	
CONCRETE REMOVAL	
ASPHALT REMOVAL	
ASPHALT OVERLAY REMOVAL	
ASPHALT PLANING	
VEGETATION REMOVAL	

FRESHWATER FISH MARKETING CORPORATION
1199

APEGM
Certificate of Authorization
Dillon Consulting Limited (MB)
No. 1789 Date: 2013/11/21

BID OPPORTUNITY NO. 712-2013

EXISTING	LEGEND-PLAN	PROPOSED	EXISTING	LEGEND-PLAN	PROPOSED	EXISTING	LEGEND-PROFILE	PROPOSED
	WATERMAIN			HYDRO			WATERMAIN	
	HYDRANT			MTS			WATERMAIN	
	VALVE			M.T.S.			LAND DRAINAGE SEWER	
	LAND DRAINAGE SEWER			WASTE WATER SEWER			WASTE WATER SEWER	
	MANHOLE			CONCRETE			ASPHALT	
	CATCH BASIN			PLANING			SIDEWALK	
	CURB INLET			PAVING STONES			PROPERTY LINE	
	JUNCTIONS			DRAINAGE SWALE			DRAINAGE ARROW	
	CULVERT			CURB RAMP			GAS	
	GAS			EXISTING			LEGEND-PROFILE	

LOCATION APPROVED UNDERGROUND STRUCTURES
SUPV. U/G STRUCTURES COMMITTEE DATE

NOTE:
LOCATION OF UNDERGROUND STRUCTURES AS SHOWN ARE BASED ON THE BEST INFORMATION AVAILABLE, BUT NO GUARANTEE IS GIVEN THAT ALL EXISTING UTILITIES ARE SHOWN OR THAT THE GIVEN LOCATIONS ARE EXACT. CONFIRMATION OF EXISTENCE AND EXACT LOCATION OF ALL SERVICES MUST BE OBTAINED FROM THE INDIVIDUAL UTILITIES BEFORE PROCEEDING WITH CONSTRUCTION.

B.M. NO.	ELEV.	REVISIONS	DATE	BY
0		ISSUED FOR TENDER	2013/11/21	TJP

DESIGNED BY	CHECKED BY
TJH	TJP
DRAWN BY	APPROVED BY
TJH	DPK
HOR. SCALE:	RELEASED FOR CONSTRUCTION BY:
1:250	
VERTICAL:	DATE
	2013/11/21

ENGINEER'S SEAL
PROVINCE OF MANITOBA
REGISTERED PROFESSIONAL ENGINEER
T.J. PETERS
2013/11/21
Member 22309

CONSULTANT DRAWING NO.
12-6576-CT-0006

THE CITY OF WINNIPEG PUBLIC WORKS DEPARTMENT

PLESSIS ROAD TWINNING AND GRADE SEPARATION AT CN REDDITT SUBDIVISION CONTRACT 3

REMOVALS - PLESSIS 2+420 TO 2+580

CITY DRAWING NUMBER U238-2014-2106
SHEET 06 OF 66

CT-0006