

NORTHEAST ACCESS ROAD						
SEGMENT	STATION (START)	STATION (END)	NORTHING (START)	EASTING (START)	NORTHING (END)	EASTING (END)
L23	0+000.000	0+016.344	5528034.509	641897.410	5528050.828	641896.504
L24	0+016.344	0+031.742	5528050.828	641896.504	5528066.211	641897.186
L25	0+031.742	0+209.147	5528066.211	641897.186	5528243.514	641891.206
C21	0+209.147	0+232.884	5528243.514	641891.206	5528257.993	641875.534
L26	0+232.884	0+251.852	5528257.993	641875.534	5528257.132	641856.585

CURVE DATA					
#	R.	Δc	Tc	L.	L.C.
C21	15.000	90°40'16"	15.177	23.738	21.337

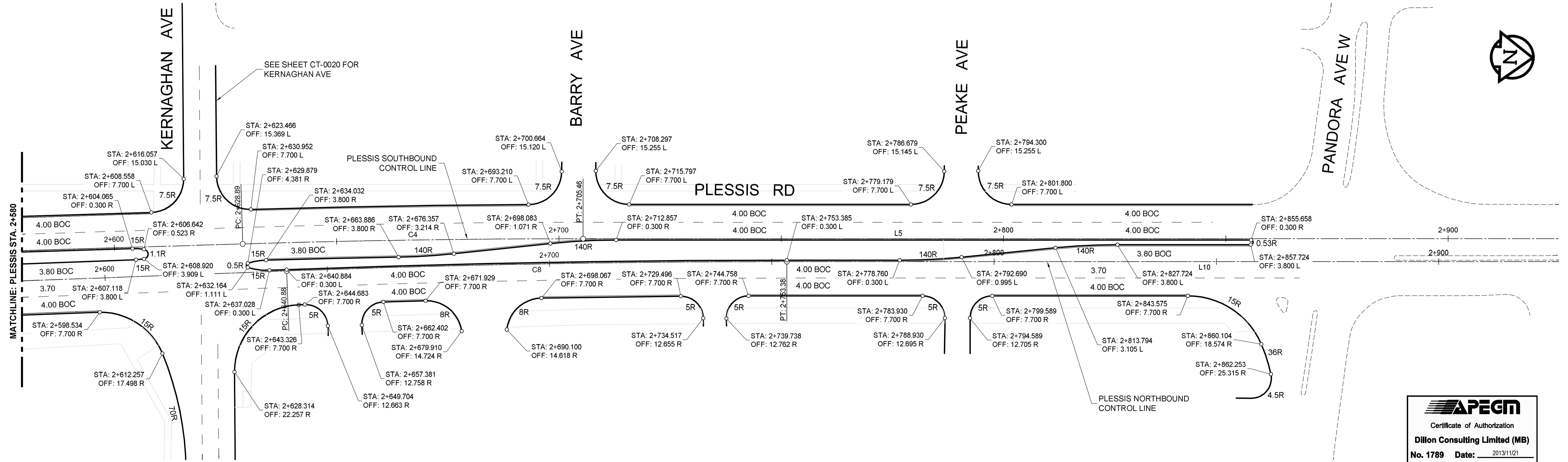
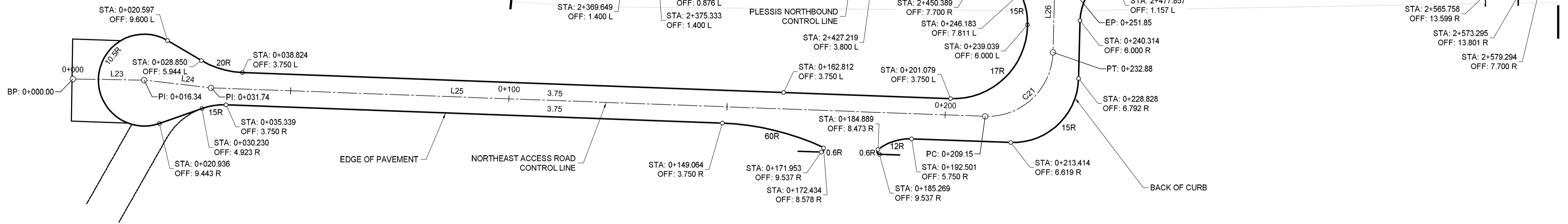

APEGM
 Certificate of Authorization
Dillon Consulting Limited (MB)
 No. 1789 Date: 2013/11/21

BID OPPORTUNITY NO. 712-2013

150 WM	WATERMAIN	150 WM	HYDRO	HYDRO	150 WM	WATERMAIN	150 WM
HYDRANT	HYDRANT	MTS	MTS	CONCRETE	HYDRANT	HYDRANT	MTS
VALVE	VALVE			ASPHALT	VALVE	VALVE	
300 LDS	LAND DRAINAGE SEWER	300 LDS		PLANING	300 LDS	LAND DRAINAGE SEWER	300 LDS
250 WWS	WASTE WATER SEWER	250 WWS		SIDEWALK	250 WWS	WASTE WATER SEWER	250 WWS
MANHOLE	MANHOLE			PAVING STONES	MANHOLE	MANHOLE	
CATCH BASIN	CATCH BASIN			PROPERTY LINE	CATCH BASIN	CATCH BASIN	
CURB INLET	CURB INLET			DRAINAGE SWALE	CURB INLET	CURB INLET	
JUNCTIONS	JUNCTIONS			DRAINAGE ARROW	JUNCTIONS	JUNCTIONS	
CULVERT	CULVERT			CURB RAMP	CULVERT	CULVERT	
100 GAS	GAS	100 GAS		LEGEND-PLAN	100 GAS	GAS	
EXISTING	LEGEND-PLAN	PROPOSED	EXISTING	LEGEND-PROFILE	EXISTING	LEGEND-PROFILE	PROPOSED

LOCATION APPROVED UNDERGROUND STRUCTURES

SUPV. U/G STRUCTURES COMMITTEE DATE

NOTE:
 LOCATION OF UNDERGROUND STRUCTURES AS SHOWN ARE BASED ON THE BEST INFORMATION AVAILABLE, BUT NO GUARANTEE IS GIVEN THAT ALL EXISTING UTILITIES ARE SHOWN OR THAT THE GIVEN LOCATIONS ARE EXACT. CONFIRMATION OF EXISTENCE AND EXACT LOCATION OF ALL SERVICES MUST BE OBTAINED FROM THE INDIVIDUAL UTILITIES BEFORE PROCEEDING WITH CONSTRUCTION.

B.M. ELEV.	NO.	ISSUED FOR TENDER	DATE	BY
	0	ISSUED FOR TENDER	2013/11/21	TJP
		REVISIONS		

DESIGNED BY	RTP	CHECKED BY	TJP
DRAWN BY	TJH	APPROVED BY	DPK
HOR. SCALE:	1:500	RELEASED FOR CONSTRUCTION BY:	
VERTICAL:		DATE	2013/11/21

ENGINEER'S SEAL
 PROVINCE OF MANITOBA
 DESIGNATED BY
T.J. PETERS
 2013/11/21
 Member
 22309
 REGISTERED PROFESSIONAL ENGINEER

THE CITY OF WINNIPEG PUBLIC WORKS DEPARTMENT

PLESSIS ROAD TWINNING AND GRADE SEPARATION AT CN REDDITT SUBDIVISION CONTRACT 3

CITY DRAWING NUMBER U238-2014-2118
 SHEET 18 OF 66

CONTROL LINE GEOMETRY - PLESSIS (2 OF 2)

CT-0018

2013-04-30