

- CONSTRUCTION NOTES:**
- CONTRACTOR SHALL TAKE PRECAUTIONARY STEPS TO AVOID DAMAGE FROM CONSTRUCTION ACTIVITIES TO EXISTING BOULEVARDS AND TREES WITHIN THE LIMITS OF CONSTRUCTION.
 - LOCATION OF EXISTING SERVICES ARE TO BE CONFIRMED IN THE FIELD BY THE CONTRACTOR.
 - TIE-INS TO BE VERIFIED IN THE FIELD BY THE CONTRACT ADMINISTRATOR.
 - LIMITS OF SIDEWALK RENEWALS TO BE FINALIZED IN THE FIELD BY THE CONTRACT ADMINISTRATOR.
 - FOR ADJUSTMENTS AND REMOVALS SEE SHEETS CT-0002 TO CT-0010.
 - DITCH GRADING TO BE FINALIZED IN FIELD BY CONTRACT ADMINISTRATOR.
 - INSTALL 18 m OF 150 mm SUB DRAIN TO CATCH BASINS IN BOTH DIRECTIONS PARALLEL TO ROADWAY AS PER SD-245 AND CAP ENDS.
 - INSTALL 100 m OF 150 mm SUB DRAIN ON EITHER SIDE OF PLESSIS UNDERPASS LOW POINT. (LOWEST PAVEMENT EDGE ONLY)
 - SEE CIVIL DRAWINGS FOR ALL CATCH BASIN AND CULVERT INFORMATION.
 - INSTALL MODIFIED BARRIER CURB (SD-203B) ON ALL CONCRETE APPROACH RADII.
 - EXCAVATION SLOPES ON EITHER SIDE OF THE RAIL SHOOFLY SHALL BE AS DIRECTED IN THE GEOTECHNICAL MEMO WITHIN THE BID OPPORTUNITY.
 - NO VIBRATORY COMPACTION OVER OIL LINES.

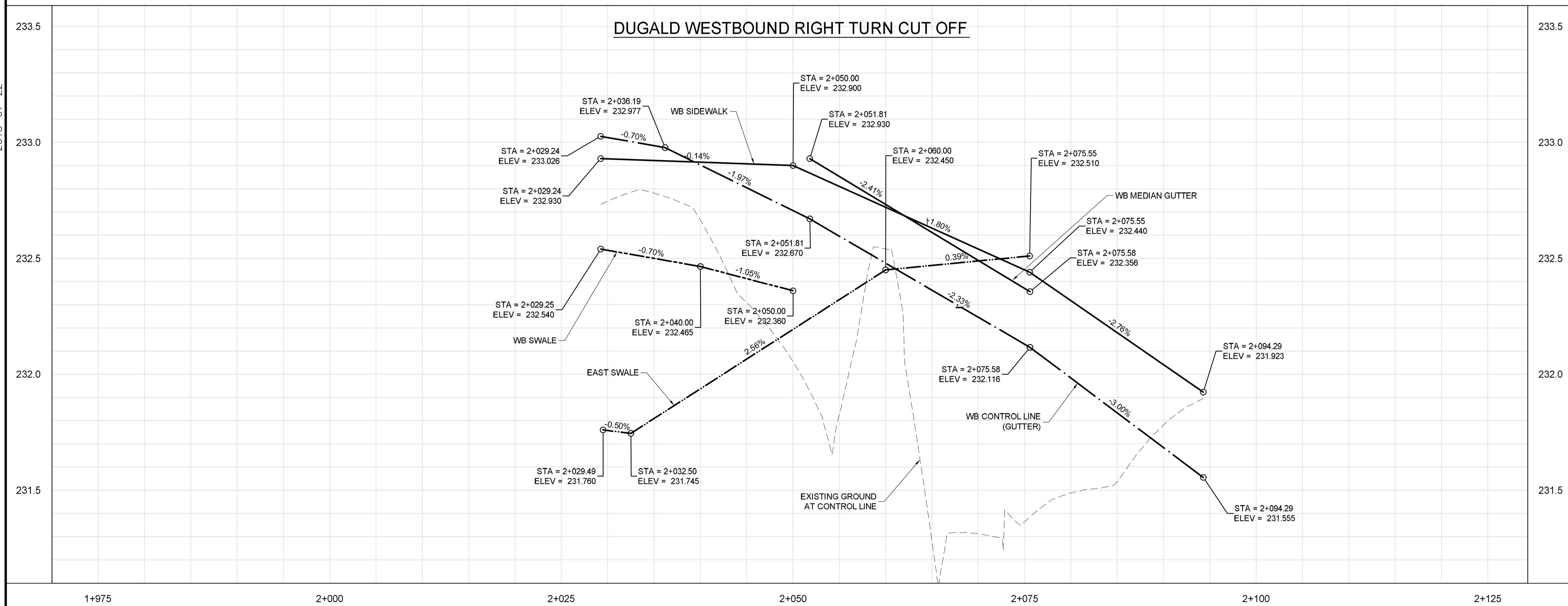

METRIC
WHOLE NUMBERS INDICATE MILLIMETRES
DECIMALIZED NUMBERS INDICATE METRES

WARNING

IF POWER EQUIPMENT OR EXPLOSIVES ARE TO BE USED FOR EXCAVATION ON THIS PROJECT THE CONTRACTOR MUST:

- NOTIFY THE GAS COMPANY OF THE PROPOSED LOCATION OF EXCAVATION.
- TAKE PRECAUTION TO AVOID DAMAGE TO GAS COMPANY INSTALLATIONS SEE PROVINCIAL REGULATION 140/22 FOR DETAILS.
- OBTAIN EXCAVATION PERMITS PRIOR TO CONSTRUCTION.



| | | | | | | | | | | | | | | | | | | | | | | | | | | | | | | | | | | | |
|---|---|------------|-------|--|--|---|---|--|--|---|--|---|-------------------|------------|-----|-----|-----------|------|----|--|--|-----------------|----------------|--------------|-----------------|-----------------------|-------------------------------|--------|-----------------|---|--|---|--|--|--|
| 1+975 | 2+000 | 2+025 | 2+050 | 2+075 | 2+100 | 2+125 | BID OPPORTUNITY NO. 712-2013 | | | | | | | | | | | | | | | | | | | | | | | | | | | | |
| <table border="1" style="width: 100%; border-collapse: collapse;"> <tr> <td style="width: 50%; text-align: center;"> 150 WM WATERMAIN HYDRANT VALVE 300 LDS LAND DRAINAGE SEWER 250 WWS WASTE WATER SEWER MANHOLE CATCH BASIN CURB INLET JUNCTIONS CULVERT 100 GAS EXISTING LEGEND-PLAN PROPOSED EXISTING </td> <td style="width: 50%; text-align: center;"> 150 WM HYDRO M.T.S. CONCRETE ASPHALT PLANING SIDEWALK PAVING STONES PROPERTY LINE DRAINAGE SWALE DRAINAGE ARROW CURB RAMP EXISTING LEGEND-PLAN PROPOSED EXISTING </td> </tr> <tr> <td style="width: 50%; text-align: center;"> 150 WM WATERMAIN HYDRANT VALVE 300 LDS LAND DRAINAGE SEWER 250 WWS WASTE WATER SEWER MANHOLE CATCH BASIN CURB INLET JUNCTIONS CULVERT 100 GAS EXISTING LEGEND-PROFILE PROPOSED EXISTING </td> <td style="width: 50%; text-align: center;"> 150 WM HYDRO M.T.S. CONCRETE ASPHALT PLANING SIDEWALK PAVING STONES PROPERTY LINE DRAINAGE SWALE DRAINAGE ARROW CURB RAMP EXISTING LEGEND-PROFILE PROPOSED EXISTING </td> </tr> </table> | | | | 150 WM WATERMAIN HYDRANT VALVE 300 LDS LAND DRAINAGE SEWER 250 WWS WASTE WATER SEWER MANHOLE CATCH BASIN CURB INLET JUNCTIONS CULVERT 100 GAS EXISTING LEGEND-PLAN PROPOSED EXISTING | 150 WM HYDRO M.T.S. CONCRETE ASPHALT PLANING SIDEWALK PAVING STONES PROPERTY LINE DRAINAGE SWALE DRAINAGE ARROW CURB RAMP EXISTING LEGEND-PLAN PROPOSED EXISTING | 150 WM WATERMAIN HYDRANT VALVE 300 LDS LAND DRAINAGE SEWER 250 WWS WASTE WATER SEWER MANHOLE CATCH BASIN CURB INLET JUNCTIONS CULVERT 100 GAS EXISTING LEGEND-PROFILE PROPOSED EXISTING | 150 WM HYDRO M.T.S. CONCRETE ASPHALT PLANING SIDEWALK PAVING STONES PROPERTY LINE DRAINAGE SWALE DRAINAGE ARROW CURB RAMP EXISTING LEGEND-PROFILE PROPOSED EXISTING | <p>LOCATION APPROVED UNDERGROUND STRUCTURES</p> <p>SUPV. U/G STRUCTURES COMMITTEE DATE</p> <p>NOTE: LOCATION OF UNDERGROUND STRUCTURES AS SHOWN ARE BASED ON THE BEST INFORMATION AVAILABLE, BUT NO GUARANTEE IS GIVEN THAT THE GIVEN LOCATIONS ARE EXACT. CONFIRMATION OF EXISTENCE AND EXACT LOCATION OF ALL SERVICES MUST BE OBTAINED FROM THE INDIVIDUAL UTILITIES BEFORE PROCEEDING WITH CONSTRUCTION.</p> | | <p>B.M. ELEV.</p> <table border="1" style="width: 100%; border-collapse: collapse;"> <tr> <td>0</td> <td>ISSUED FOR TENDER</td> <td>2013/11/21</td> <td>TJP</td> </tr> <tr> <td>NO.</td> <td>REVISIONS</td> <td>DATE</td> <td>BY</td> </tr> </table> | | 0 | ISSUED FOR TENDER | 2013/11/21 | TJP | NO. | REVISIONS | DATE | BY | <p style="text-align: center;">DILLON CONSULTING</p> <table border="1" style="width: 100%; border-collapse: collapse;"> <tr> <td>DESIGNED BY RTP</td> <td>CHECKED BY TJP</td> </tr> <tr> <td>DRAWN BY TJH</td> <td>APPROVED BY DPK</td> </tr> <tr> <td>HOR. SCALE: VERTICAL:</td> <td>RELEASED FOR CONSTRUCTION BY:</td> </tr> <tr> <td>DATE -</td> <td>DATE 2013/11/21</td> </tr> </table> | | DESIGNED BY RTP | CHECKED BY TJP | DRAWN BY TJH | APPROVED BY DPK | HOR. SCALE: VERTICAL: | RELEASED FOR CONSTRUCTION BY: | DATE - | DATE 2013/11/21 | <p style="text-align: center;">ENGINEER'S SEAL</p> <p style="text-align: center;">PROVINCE OF MANITOBA DESIGNED BY T.J. PETERS 2013/11/21 Member 22309 REGISTERED PROFESSIONAL ENGINEER</p> | | <p style="text-align: center;">THE CITY OF WINNIPEG PUBLIC WORKS DEPARTMENT</p> <p style="text-align: center;">PLESSIS ROAD TWINNING AND GRADE SEPARATION AT CN REDDITT SUBDIVISION CONTRACT 3</p> <p style="text-align: right;">CITY DRAWING NUMBER U238-2014-2142 SHEET 42 OF 66</p> | | <p style="text-align: center;">PROFILE - PLESSIS AND DUGALD RIGHT TURN CUT OFF</p> <p style="text-align: right; font-size: 24pt;">CT-0042</p> | |
| 150 WM WATERMAIN HYDRANT VALVE 300 LDS LAND DRAINAGE SEWER 250 WWS WASTE WATER SEWER MANHOLE CATCH BASIN CURB INLET JUNCTIONS CULVERT 100 GAS EXISTING LEGEND-PLAN PROPOSED EXISTING | 150 WM HYDRO M.T.S. CONCRETE ASPHALT PLANING SIDEWALK PAVING STONES PROPERTY LINE DRAINAGE SWALE DRAINAGE ARROW CURB RAMP EXISTING LEGEND-PLAN PROPOSED EXISTING | | | | | | | | | | | | | | | | | | | | | | | | | | | | | | | | | | |
| 150 WM WATERMAIN HYDRANT VALVE 300 LDS LAND DRAINAGE SEWER 250 WWS WASTE WATER SEWER MANHOLE CATCH BASIN CURB INLET JUNCTIONS CULVERT 100 GAS EXISTING LEGEND-PROFILE PROPOSED EXISTING | 150 WM HYDRO M.T.S. CONCRETE ASPHALT PLANING SIDEWALK PAVING STONES PROPERTY LINE DRAINAGE SWALE DRAINAGE ARROW CURB RAMP EXISTING LEGEND-PROFILE PROPOSED EXISTING | | | | | | | | | | | | | | | | | | | | | | | | | | | | | | | | | | |
| 0 | ISSUED FOR TENDER | 2013/11/21 | TJP | | | | | | | | | | | | | | | | | | | | | | | | | | | | | | | | |
| NO. | REVISIONS | DATE | BY | | | | | | | | | | | | | | | | | | | | | | | | | | | | | | | | |
| DESIGNED BY RTP | CHECKED BY TJP | | | | | | | | | | | | | | | | | | | | | | | | | | | | | | | | | | |
| DRAWN BY TJH | APPROVED BY DPK | | | | | | | | | | | | | | | | | | | | | | | | | | | | | | | | | | |
| HOR. SCALE: VERTICAL: | RELEASED FOR CONSTRUCTION BY: | | | | | | | | | | | | | | | | | | | | | | | | | | | | | | | | | | |
| DATE - | DATE 2013/11/21 | | | | | | | | | | | | | | | | | | | | | | | | | | | | | | | | | | |

2013-07-22