

NOTE:
SEE DRAWING 30-SHT-CR-1106 FOR TRACKAGE INFORMATION.

NOTE:
RAILWAY EQUIPMENT AND FACILITIES TO BE PROTECTED DURING CONSTRUCTION.

TEMPORARY FIBRE TO BE RETIRED IN PLACE AFTER BRIDGE COMPLETION

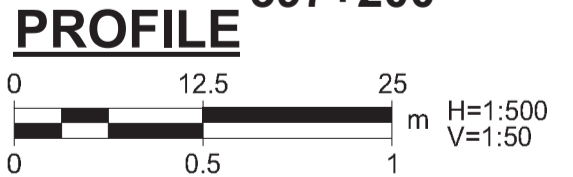
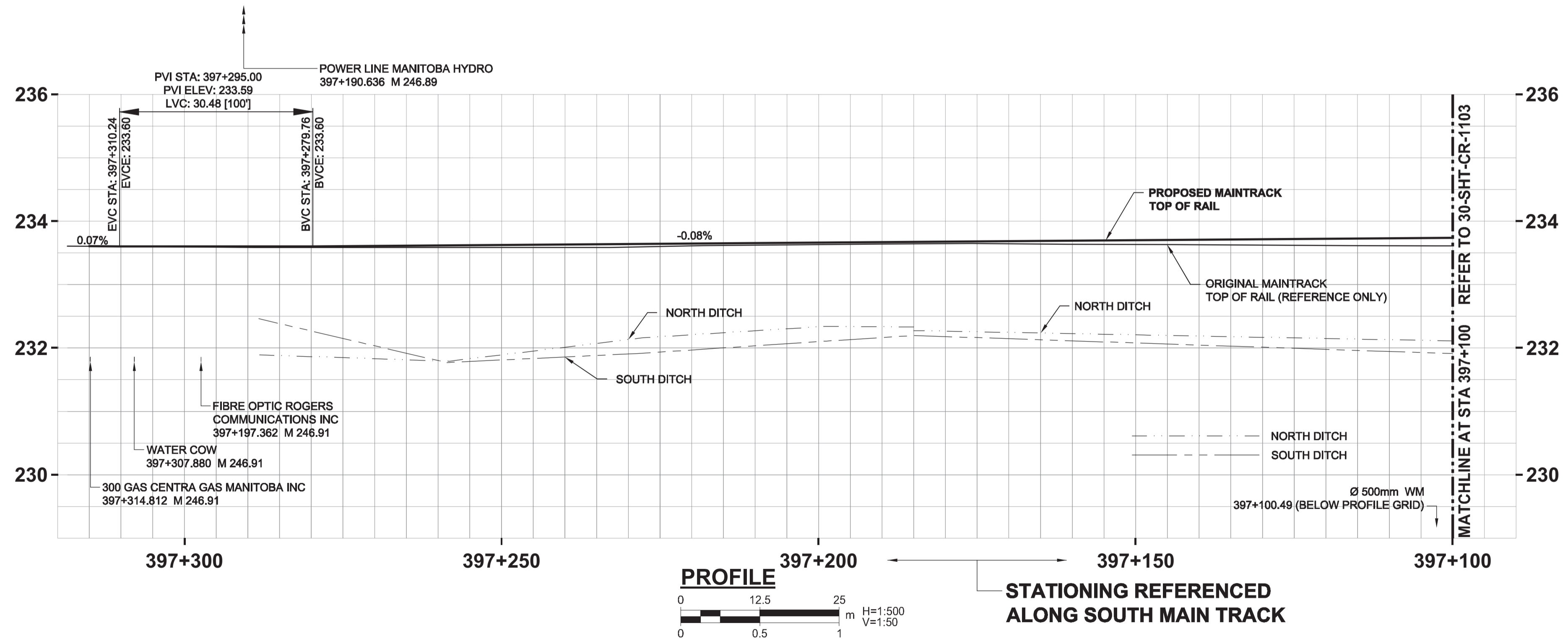

STATIONING REFERENCED ALONG SOUTH MAIN TRACK

APEGM
Certificate of Authorization
AECOM Canada Ltd.
No. 4671 Date: 2013/10/15
BID OPPORTUNITY NO. 712-2013

LOCATION APPROVED UNDERGROUND STRUCTURES

SUPV. U/G STRUCTURES COMMITTEE DATE

NOTE:
LOCATION OF UNDERGROUND STRUCTURES AS SHOWN ARE BASED ON THE BEST INFORMATION AVAILABLE. BUT NO GUARANTEE IS GIVEN THAT ALL EXISTING UTILITIES ARE SHOWN OR THAT THE GIVEN LOCATIONS ARE EXACT. CONFIRMATION OF EXISTENCE AND EXACT LOCATION OF ALL SERVICES MUST BE OBTAINED FROM THE INDIVIDUAL UTILITIES BEFORE PROCEEDING WITH CONSTRUCTION.

B.M. ELEV.	NO.	ISSUED FOR TENDER	DATE	BY
	0	Issued For Tender	13/10/15	RCP

AECOM		ENGINEER'S SEAL	
DESIGNED BY	BRP	CHECKED BY	BJM
DRAWN BY	WD	APPROVED BY	RCP
HOR. SCALE:	1:500	RELEASED FOR CONSTRUCTION BY:	
VERTICAL:	1:50	DATE	2013/10/15
		DATE	2013/10/15

CONSULTANT DRAWING NO.
30-SHT-CR-1102

THE CITY OF WINNIPEG
PUBLIC WORKS DEPARTMENT

PLESSIS ROAD TWINNING AND GRADE SEPARATION AT CN REDDITT SUBDIVISION CONTRACT 3

SHOOFLY REMOVAL AND FINAL CONFIGURATION
PLAN AND PROFILE
Sta. 397+100 to Sta. 397+320

CITY DRAWING NUMBER
U238-2014-2202

SHEET 02 OF 09

CR-1102