

AT - 841094

2013-08-01

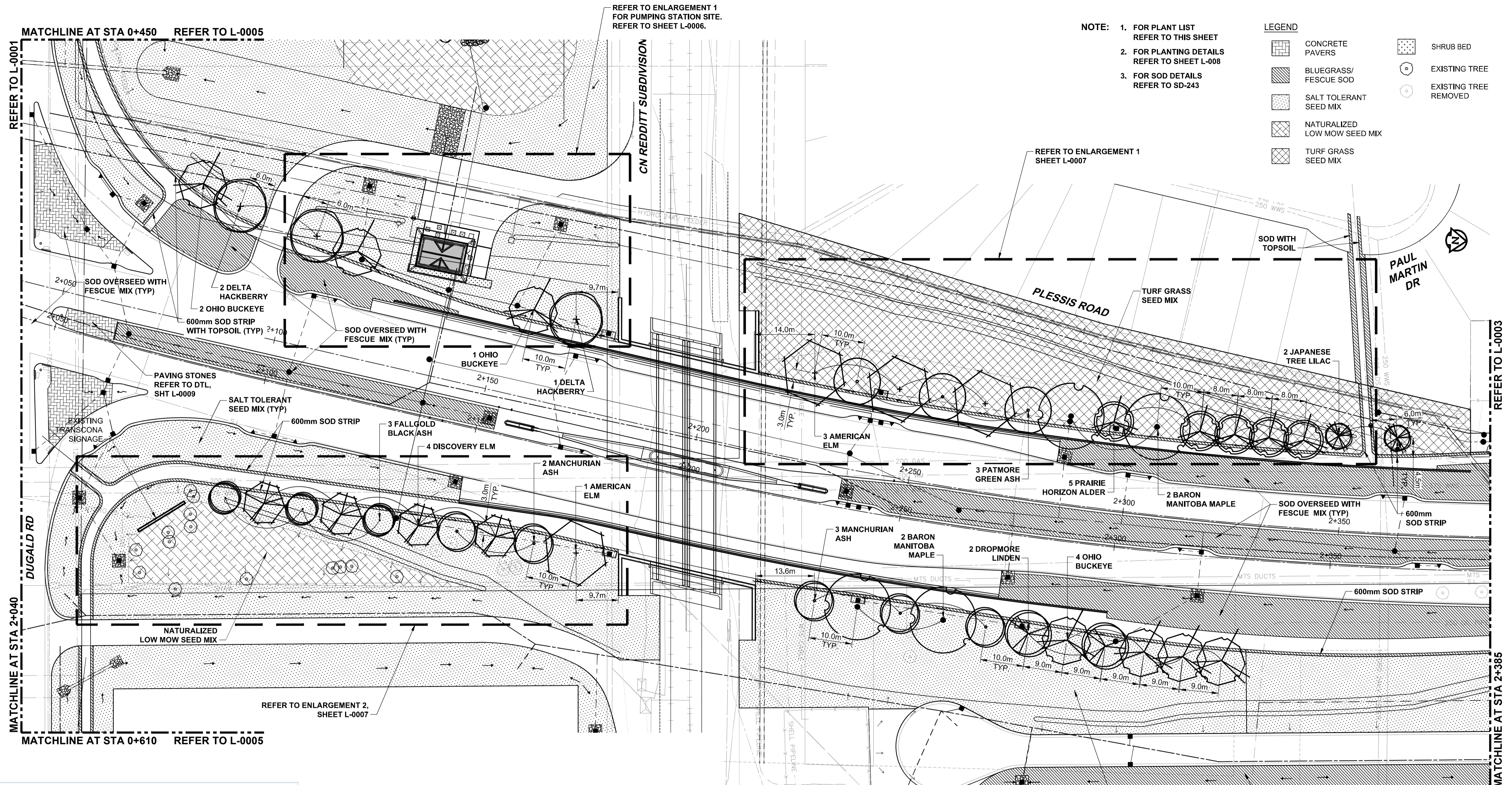

NOTE: 1. FOR PLANT LIST REFER TO THIS SHEET
 2. FOR PLANTING DETAILS REFER TO SHEET L-008
 3. FOR SOD DETAILS REFER TO SD-243

LEGEND

[Symbol]	CONCRETE PAVERS	[Symbol]	SHRUB BED
[Symbol]	BLUEGRASS/FESCUE SOD	[Symbol]	EXISTING TREE
[Symbol]	SALT TOLERANT SEED MIX	[Symbol]	EXISTING TREE REMOVED
[Symbol]	NATURALIZED LOW MOW SEED MIX		
[Symbol]	TURF GRASS SEED MIX		

PLANT LIST

No.	COMMON NAME	BOTANICAL NAME	SIZE / HT	NOTES
DECIDUOUS TREES - LARGE				
4	Baron Manitoba Maple	<i>Acer negundo</i>	65mm cal.	B&B/Machine
10	Ohio Buckeye	<i>Aesculus glabra</i>	50mm cal.	B&B/Machine
5	Prairie Horizon Alder	<i>Alnus hisuta 'Harbin'</i>	50mm cal.	B&B/Machine
3	Delta Hackberry	<i>Celtis occidentalis 'Delta'</i>	50mm cal.	B&B/Machine
5	Manchurian Ash	<i>Fraxinus mandshurica</i>	65mm cal.	B&B/Machine
3	Fallgold Black Ash	<i>Fraxinus nigra 'Fallgold'</i>	65mm cal.	B&B/Machine
3	Patmore Green Ash	<i>Fraxinus pennsylvanica 'Patmore'</i>	65mm cal.	B&B/Machine
10	Trembling Aspen	<i>Populus tremuloides</i>	50mm cal.	B&B/Machine
9	Bur Oak	<i>Quercus macrocarpa</i>	45mm cal.	B&B/Machine
4	Little Leaf Linden	<i>Tilia cordata</i>	65mm cal.	B&B/Machine
2	Dropmore Linden	<i>Tilia</i>	65mm cal.	B&B/Machine
7	American Elm	<i>Ulmus americana</i>	65mm cal.	B&B/Machine
10	Discovery Elm	<i>Ulmus davidiana japonica 'Discovery'</i>	65mm cal.	B&B/Machine

No.	COMMON NAME	BOTANICAL NAME	SIZE / HT	NOTES	SPACING
DECIDUOUS TREES - SMALL					
14	Amur Maple	<i>Acer ginnala</i>	40mm cal.	B&B/Machine	6.0m o.c.
6	Japanese Tree Lilac	<i>Syringa reticulata</i>	50mm cal.	B&B/Machine	
CONIFEROUS TREES					
12	Black Hills Spruce	<i>Picea glauca 'Densata'</i>	2.4m ht.	B&B/Machine	
10	Black Hills Spruce	<i>Picea glauca 'Densata'</i>	1.8m ht.	B&B/Machine	
8	Colorado Spruce	<i>Picea pungens 'var. glauca'</i>	2.4m ht.	B&B/Machine	
10	Colorado Spruce	<i>Picea pungens 'var. glauca'</i>	1.8m ht.	B&B/Machine	
DECIDUOUS SHRUBS					
24	Redosier Dogwood	<i>Cornus stolonifera</i>	0.9m ht.	B&B/Container	2.5m o.c.
7	Firedance Dogwood	<i>Cornus sericea 'Balladine'</i>	0.75m ht.	B&B/Container	1.25m o.c.
7	Red-Berried Elder	<i>Sambucus racemosa</i>	1.2m ht.	B&B/Container	
10	False Spirea	<i>Sorbaria sorbifolia</i>	0.9m ht.	B&B/Container	2.0m o.c.
18	Nannyberry	<i>Viburnum lentago</i>	0.9m ht.	B&B/Container	2.5m o.c.
63	Downy Arrowwood	<i>Viburnum rafinesqueanum</i>	1.2m ht.	B&B/Container	1.5m o.c.

SPECIFICATION: All plant material to be supplied and installed in accordance with the latest edition of Landscape Canada's Metric Guide Specifications for Nursery Stock
 NOTE: SEE PLANTING DETAILS, SHEET

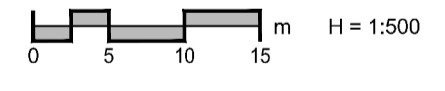

APEGM
 Certificate of Authorization
 AECOM Canada Ltd.
 No. 4671 Date: _____

METRIC
 WHOLE NUMBERS INDICATE MILLIMETRES
 DECIMALIZED NUMBERS INDICATE METRES

<p>150 WM WATERMAIN</p> <p>HYDRANT</p> <p>VALVE</p> <p>300 LDS LAND DRAINAGE SEWER</p> <p>250 WWS WASTE WATER SEWER</p> <p>MANHOLE</p> <p>CATCH BASIN</p> <p>CURB INLET</p> <p>CULVERT</p> <p>SURVEY BAR</p> <p>LAMP STANDARD</p> <p>LEGEND - PLAN</p>	<p>HYDRO</p> <p>MTS</p> <p>GAS</p> <p>LEGEND - PLAN</p>	<p>PROPERTY LINE</p> <p>EXISTING</p> <p>LEGEND - PROFILE</p> <p>NEW</p>	<p>LOCATION APPROVED UNDERGROUND STRUCTURES</p> <p>SUPV. U/G STRUCTURES COMMITTEE DATE</p> <p>NOTE: LOCATION OF UNDERGROUND STRUCTURES AS SHOWN ARE BASED ON THE BEST INFORMATION AVAILABLE, BUT NO GUARANTEE IS GIVEN THAT ALL EXISTING UTILITIES ARE SHOWN OR THAT THE GIVEN LOCATIONS ARE EXACT. CONFIRMATION OF EXISTENCE AND EXACT LOCATION OF ALL SERVICES MUST BE OBTAINED FROM THE INDIVIDUAL UTILITIES BEFORE PROCEEDING WITH CONSTRUCTION.</p>	<p>B.M. ELEV.</p>	<p>AECOM</p>	<p>ENGINEER'S SEAL</p>	<p>THE CITY OF WINNIPEG PUBLIC WORKS DEPARTMENT</p>	<p>PLESSIS ROAD TWINNING AND GRADE SEPARATION AT CN REDDITT SUBDIVISION CONTRACT 3</p>	<p>CITY DRAWING NUMBER U238-2014-2402</p> <p>SHEET 02 OF 10</p>