

ALLEY PAVEMENT PROFILE
SCALE: 1:250 HOR
1:10 VER

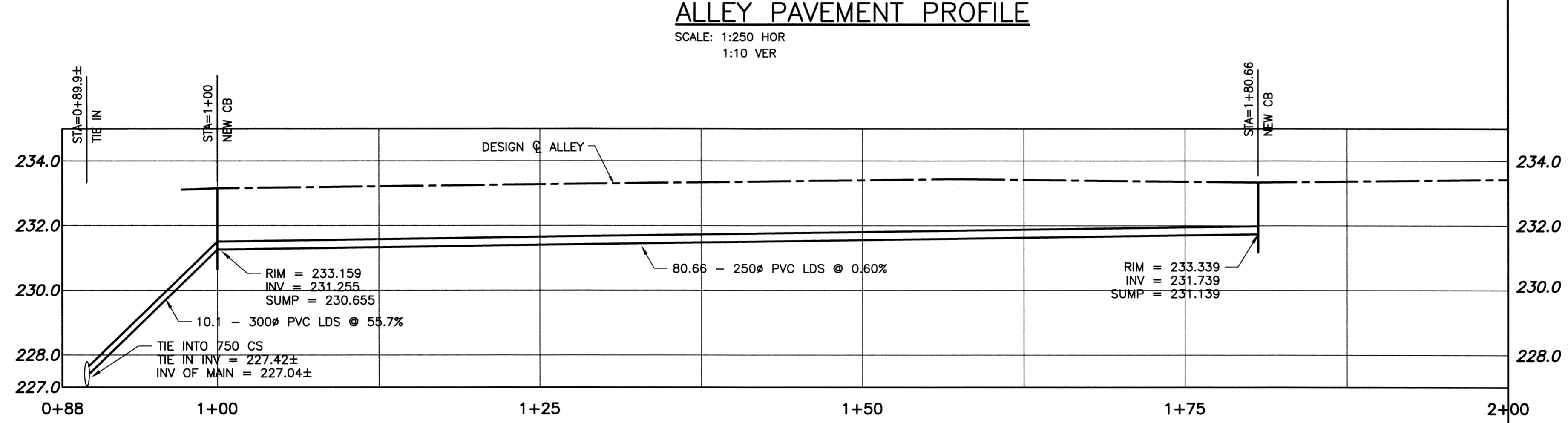

SEWER PROFILE
SCALE: 1:250 HOR
1:100 VER

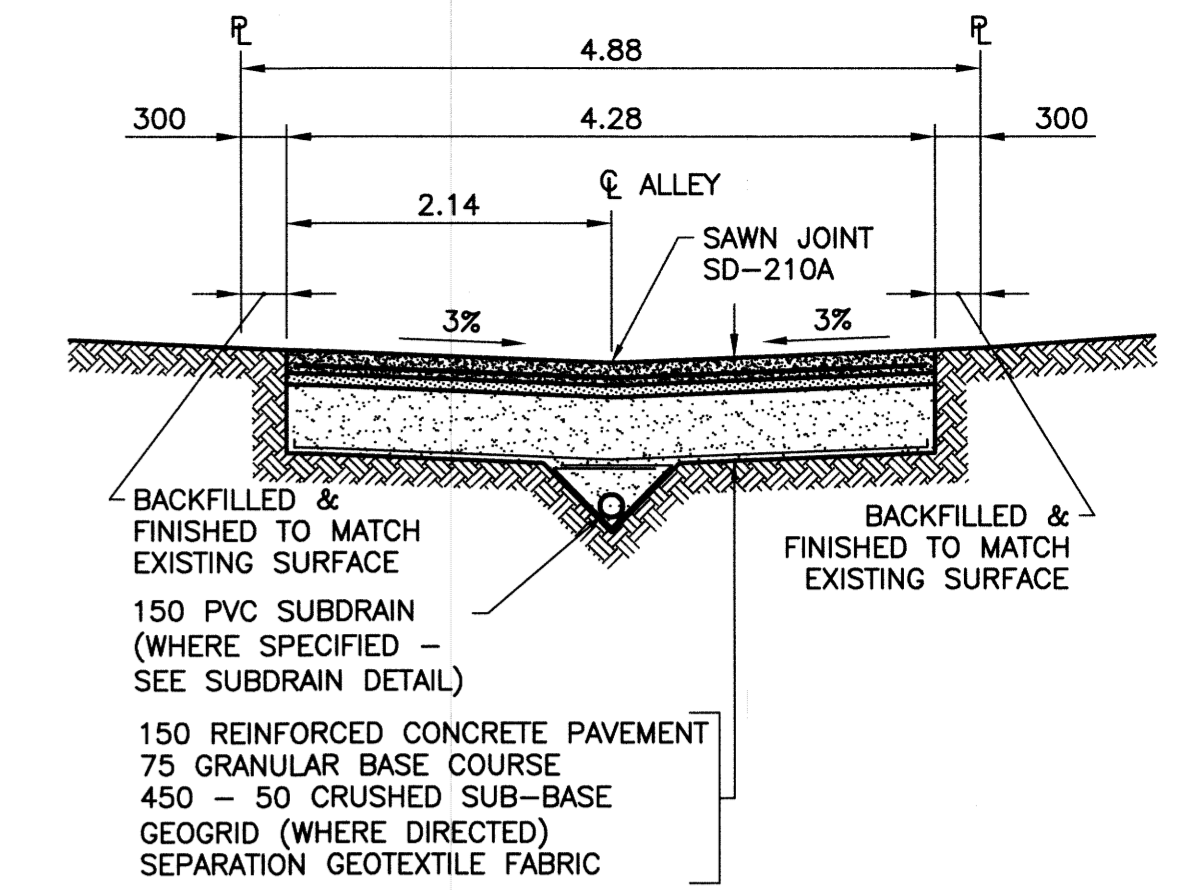

TYPICAL CROSS SECTION
SCALE: 1:50

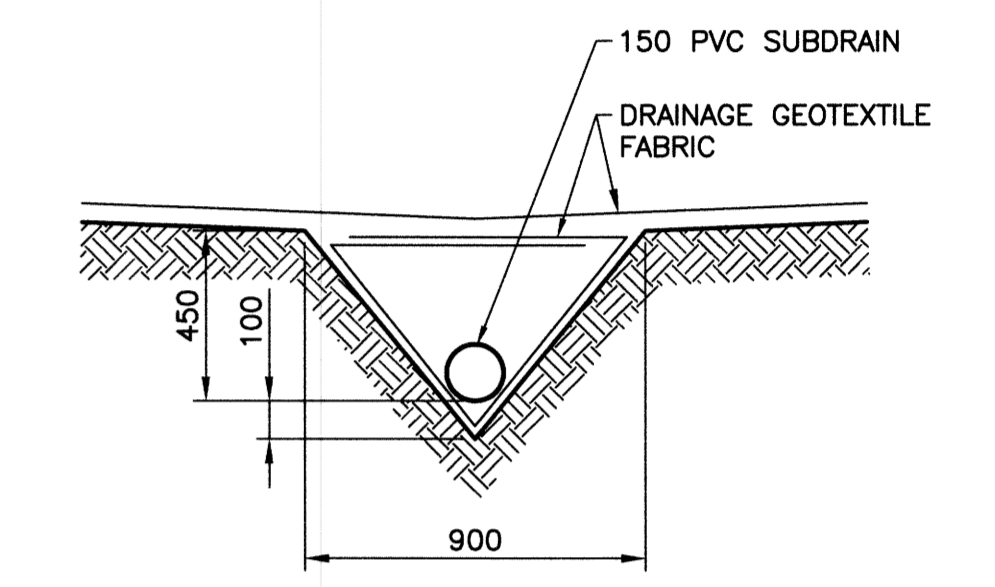

SUBDRAIN DETAIL
SCALE: 1:20

- NOTES:**
1. STATION CHAINAGE IS BASED ON CENTERLINE OF ALLEY RIGHT OF WAY.
 2. ADJUST MH AND CB RIMS TO NEW GRADES.
 3. PLUG SUBDRAINS AT TERMINAL ENDS.
 4. REGRADE EXISTING PRIVATE SIDEWALKS AS REQUIRED.
 5. INSTALLATION OF LIP CURBS AND THEIR EXTENTS TO BE DETERMINED BY THE CONTRACT ADMINISTRATOR.
 6. LIGHT STANDARDS, HYDRO POLES AND ANCHORS MAY REQUIRE TEMPORARY SUPPORT/REMOVAL OR REPLACEMENT AT THE CONTRACTOR'S EXPENSE.
 7. ISOLATE ALL POLES, BASES AND PILES WITHIN ALLEY RIGHT OF WAY (SD-228C)
 8. AVOID DAMAGE TO EXISTING TREES WITHIN THE LIMITS OF CONSTRUCTION.

WARNING
NOTIFY THE GAS COMPANY OF THE PROPOSED LOCATION OF EXCAVATION. TAKE PRECAUTION TO AVOID DAMAGE TO GAS COMPANY INSTALLATIONS. SEE PROVINCIAL REGULATION 210/72 FOR DETAILS.

METRIC
WHOLE NUMBERS INDICATE MILLIMETRES
DECIMALIZED NUMBERS INDICATE METRES

PROPERTY LIMITS DELINEATION
DELINEATION OF PROPERTY LIMITS AS SHOWN ON THIS DWG DOES NOT REPRESENT A "LEGAL SURVEY". KGS GROUP MAKES NO REPRESENTATION OR WARRANTY AS TO THE ACCURACY OF PROPERTY LIMITS DELINEATED ON THIS DWG, NOR ON THE DIMENSIONAL ACCURACY OF DWG FEATURES RELATIVE TO THOSE PROPERTY LIMITS.

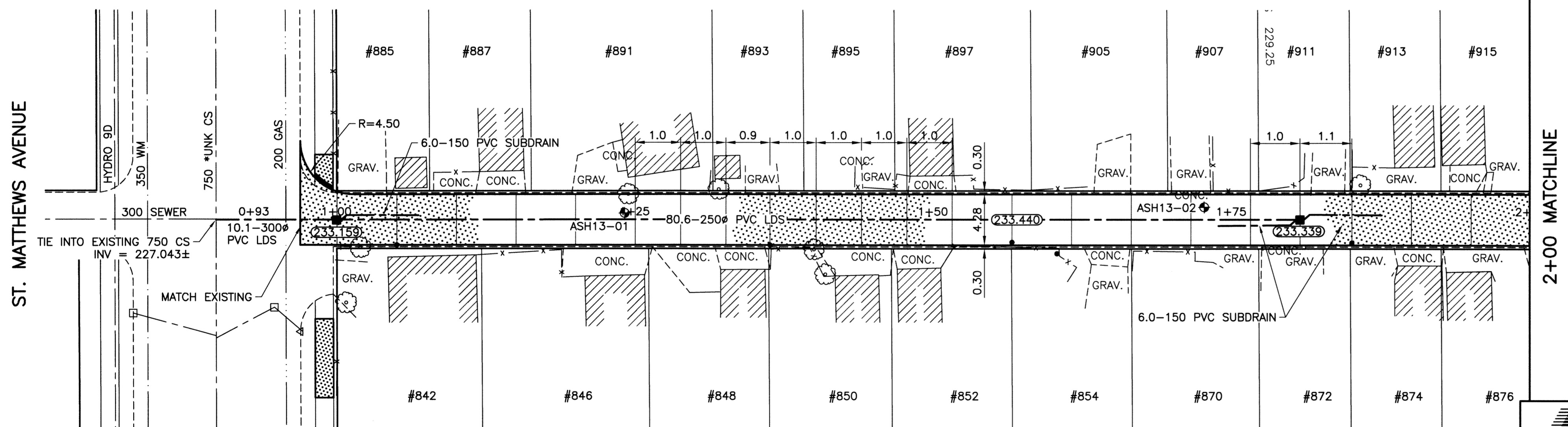

VALOUR ROAD ALLEY PAVEMENT PLAN
SCALE: 1:250 HOR

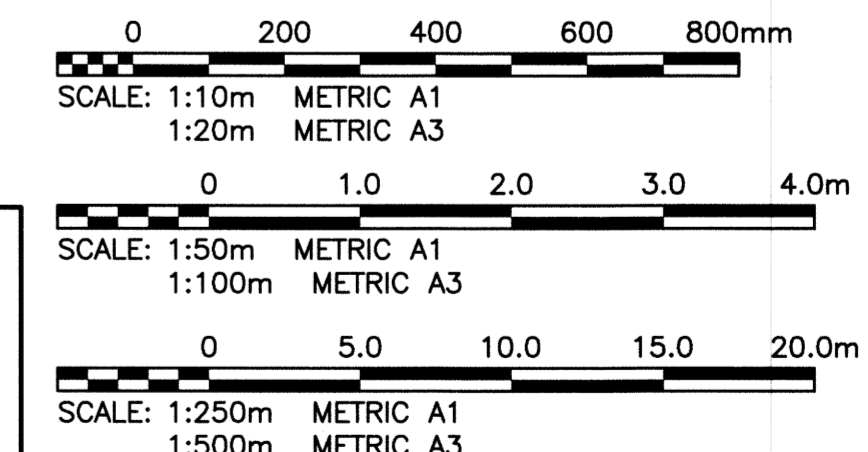

APEGM
Certificate of Authorization
KGS Group
No. 245

300 LDS	LAND DRAINAGE SEWER	300 LDS	TEST HOLE		
250 WWS	WASTE WATER SEWER	250 WWS	GUY WIRE		
---	GAS	---	LIGHT STANDARD		
---	HYDRO	---	BACK OF CURB		
---	M.T.S.	---	CONCRETE		
150 WM	WATERMAIN	150 WM	ASPHALT		
+	HYDRANT	+	SIDEWALK		
o	VALVE	o	PROPERTY LINE		
o	MANHOLE	o	SURVEY BAR		
□	CATCH BASIN	□	GEODETIC BENCHMARK		
▽	CURB INLET	▽	ELEVATION	231.334	32.231
•	POLES	•			
---	EXISTING	---	LEGEND-PLAN	EXISTING	LEGEND-PROFILE
---	PROPOSED	---	PROPOSED	EXISTING	PROPOSED

LOCATION APPROVED UNDERGROUND STRUCTURES

SUPV. U/G STRUCTURES COMMITTEE DATE

NOTE:
LOCATION OF UNDERGROUND STRUCTURES AS SHOWN ARE BASED ON THE BEST INFORMATION AVAILABLE BUT NO GUARANTEE IS GIVEN THAT ALL EXISTING UTILITIES ARE SHOWN OR THAT THE GIVEN LOCATIONS ARE EXACT. CONFIRMATION OF EXISTENCE AND EXACT LOCATION OF ALL SERVICES MUST BE OBTAINED FROM THE INDIVIDUAL UTILITIES BEFORE PROCEEDING WITH CONSTRUCTION.

B.M. 37-003	Bolt in 7.3m Conc. pile, 0.3m N. of N.L. of St.	ELEV. 233.449
1	ISSUED FOR ADDENDUM 1	13/08/28
0	ISSUED FOR TENDER	13/08/22
NO.	REVISIONS	DATE

KGS GROUP CONSULTING ENGINEERS

DESIGNED BY	GES	CHECKED BY	CR
DRAWN BY	GEL	APPROVED BY	RJH
HOR. SCALE:	1:250	RELEASED FOR CONSTRUCTION:	
VERTICAL:	1:50	DATE	13/08/20

ENGINEER'S SEAL
M.C. ROWBOTHAM
22878
August 27, 2013
CONSULTANT DRAWING NO. 13-0107-011-C12

THE CITY OF WINNIPEG PUBLIC WORKS DEPARTMENT TRANSPORTATION ENGINEERING DIVISION

PROJECT TITLE: 2013 ALLEY RENEWAL PROGRAM CONTRACT 2
ST MATTHEWS AVE TO ELLICE AVE
ST MATTHEWS AVE TO STA 2+00

SHEET 12 OF 15
COMPUTER FILE NAME: 13-0107-011_CALL
CITY DRAWING NUMBER: 0012

P:\Projects\2013\13-0107-011\Doc\Control\Tab\Balsaued\DWG\13-0107-011_C12-Rev 1.dwg - Tab: 12 Plotted By: GGreen 08/27/2013 [Tue 2:03pm] PLOT 1:1 A-1