

ALLEY PAVEMENT PROFILE

SCALE: 1:250 HOR
1:10 VER

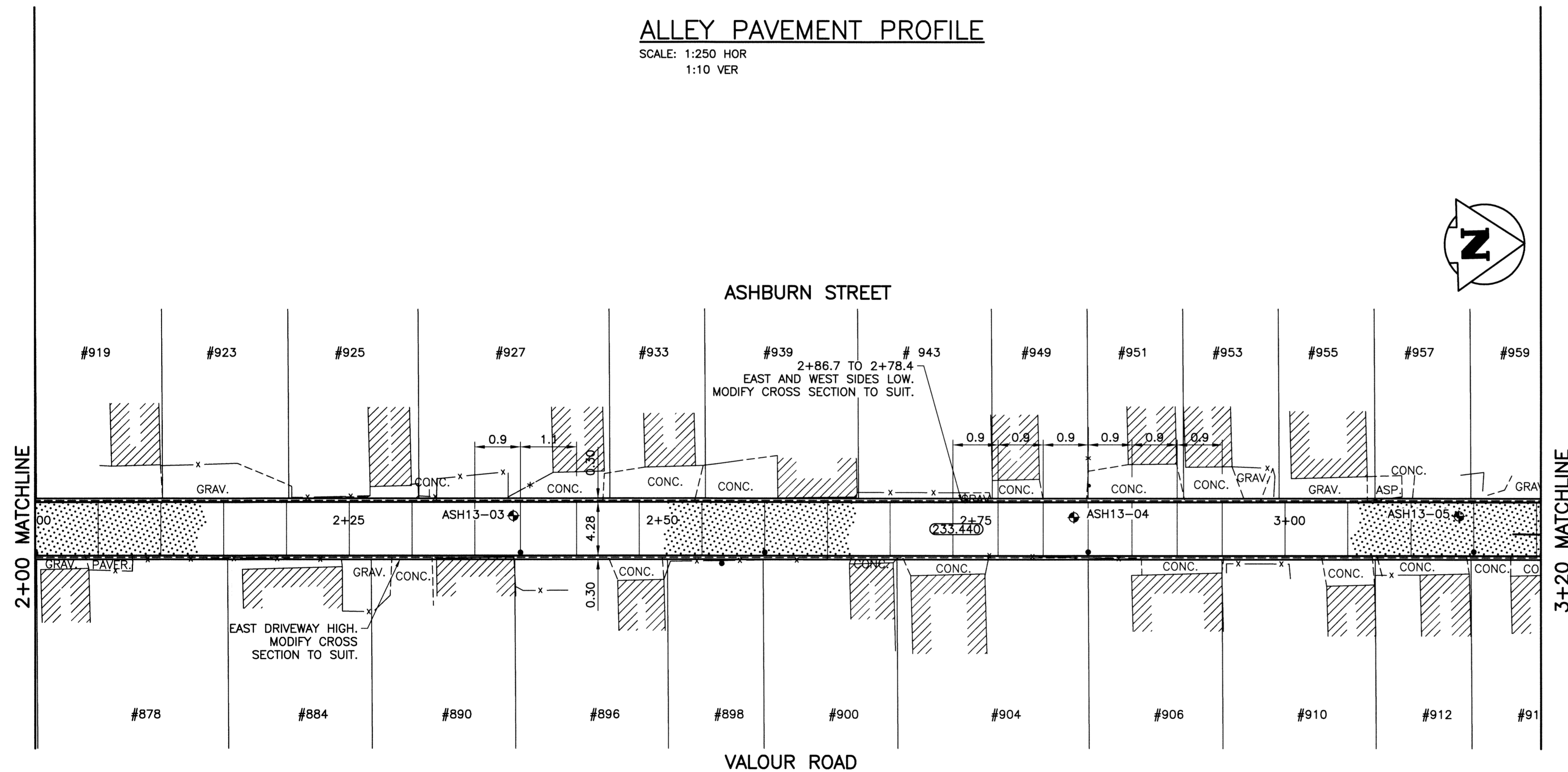

ALLEY PAVEMENT PLAN

SCALE: 1:250 HOR

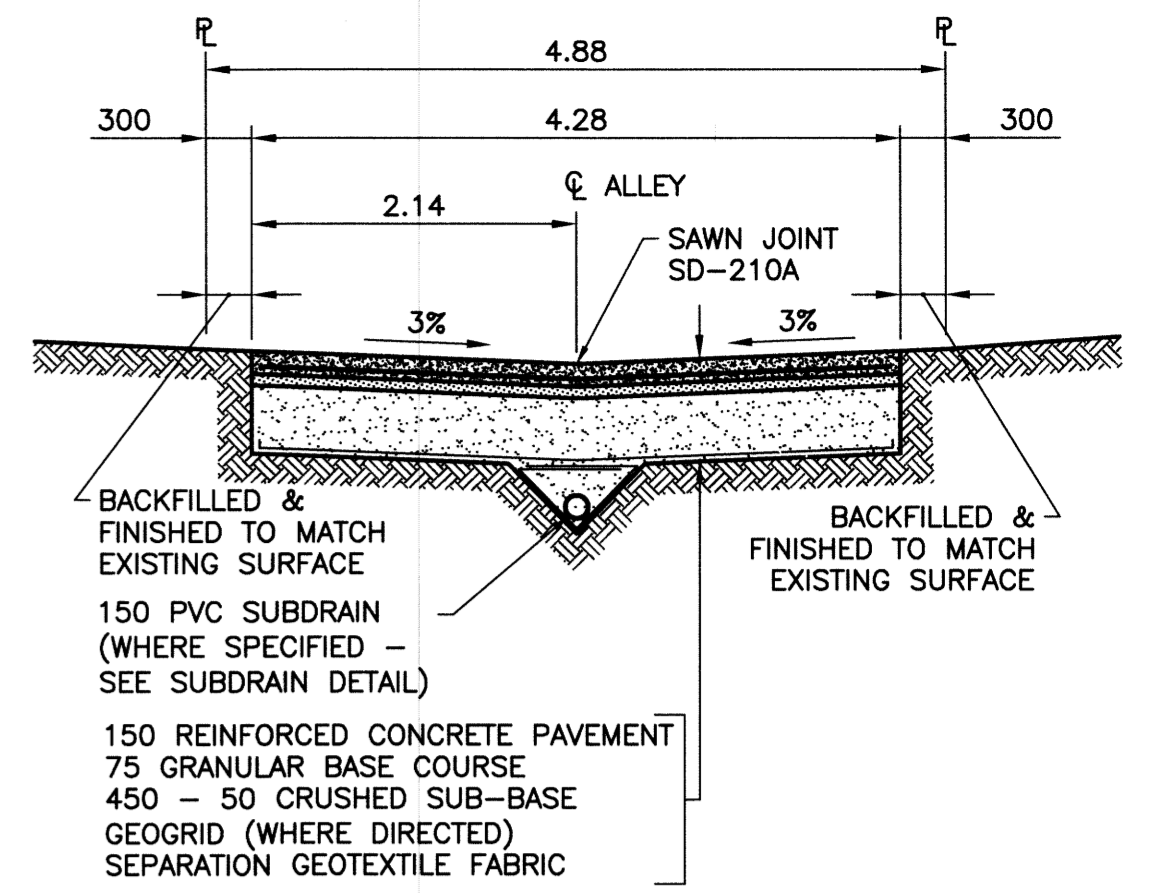

TYPICAL CROSS SECTION

SCALE: 1:50

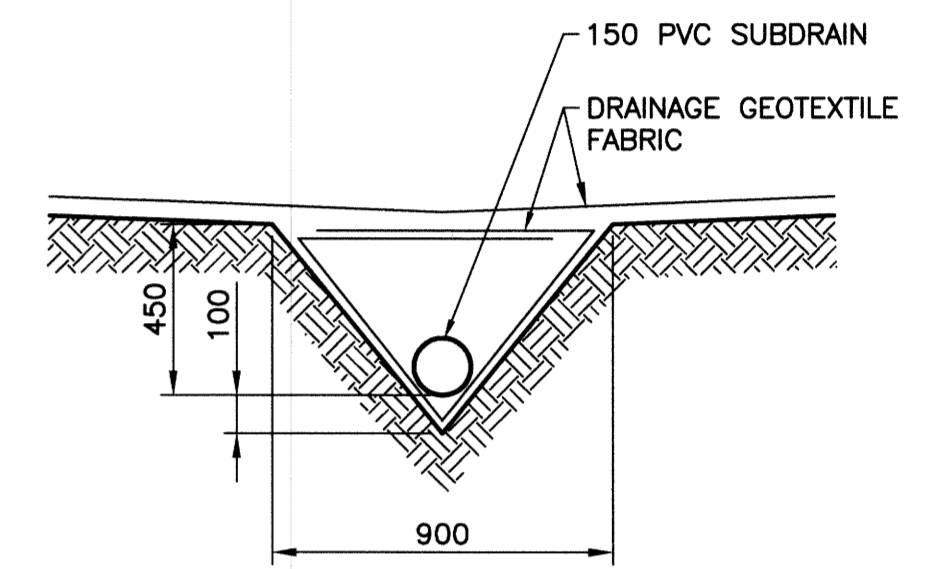

SUBDRAIN DETAIL

SCALE: 1:20

NOTES:

1. STATION CHAINAGE IS BASED ON CENTERLINE OF ALLEY RIGHT OF WAY.
2. ADJUST MH AND CB RIMS TO NEW GRADES.
3. PLUG SUBDRAINS AT TERMINAL ENDS.
4. REGRADE EXISTING PRIVATE SIDEWALKS AS REQUIRED.
5. INSTALLATION OF LIP CURBS AND THEIR EXTENTS TO BE DETERMINED BY THE CONTRACT ADMINISTRATOR.
6. LIGHT STANDARDS, HYDRO POLES AND ANCHORS MAY REQUIRE TEMPORARY SUPPORT/REMOVAL OR REPLACEMENT AT THE CONTRACTOR'S EXPENSE.
7. ISOLATE ALL POLES, BASES AND PILES WITHIN ALLEY RIGHT OF WAY (SD-228C)
8. AVOID DAMAGE TO EXISTING TREES WITHIN THE LIMITS OF CONSTRUCTION.

WARNING

NOTIFY THE GAS COMPANY OF THE PROPOSED LOCATION OF EXCAVATION. TAKE PRECAUTION TO AVOID DAMAGE TO GAS COMPANY INSTALLATIONS. SEE PROVINCIAL REGULATION 210/72 FOR DETAILS.

METRIC

WHOLE NUMBERS INDICATE MILLIMETRES
DECIMALIZED NUMBERS INDICATE METRES

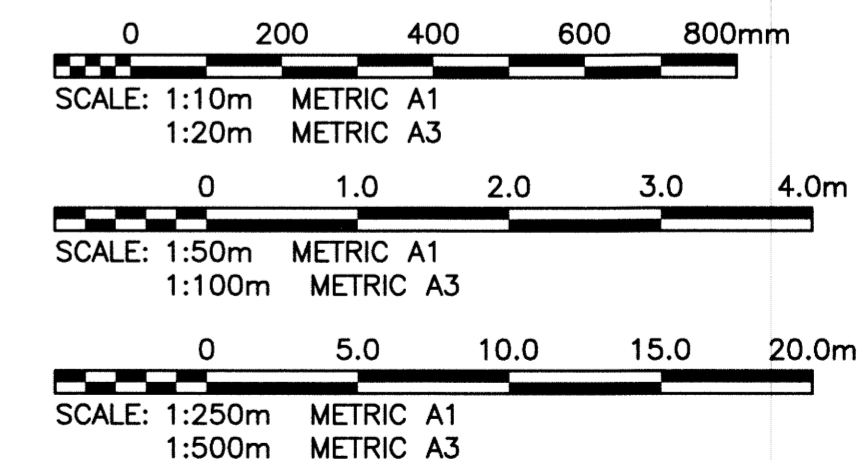

PROPERTY LIMITS DELINEATION

DELINEATION OF PROPERTY LIMITS AS SHOWN ON THIS DWG DOES NOT REPRESENT A "LEGAL SURVEY". KGS GROUP MAKES NO REPRESENTATION OR WARRANTY AS TO THE ACCURACY OF PROPERTY LIMITS DELINEATED ON THIS DWG, NOR ON THE DIMENSIONAL ACCURACY OF DWG FEATURES RELATIVE TO THOSE PROPERTY LIMITS.



300 LDS	LAND DRAINAGE SEWER	300 LDS							
250 WWS	WASTE WATER SEWER	250 WWS	+	TEST HOLE					
	GAS		—	GUY WIRE					
	HYDRO		—	LIGHT STANDARD					
	M.T.S.		—	BACK OF CURB					
150 WM	WATERMAIN	150 WM	—	CONCRETE					
+	HYDRANT	+	+	ASPHALT					
⊗	VALVE	⊗	—	SIDEWALK					
○	MANHOLE	○	—	PROPERTY LINE					
□	CATCH BASIN	□	+	SURVEY BAR					
▽	CURB INLET	▽	+	GEODETIC BENCHMARK					
•	POLES	•	+	ELEVATION	32.231				
EXISTING	LEGEND-PLAN	PROPOSED	EXISTING	LEGEND-PLAN	PROPOSED	EXISTING	LEGEND-PROFILE	PROPOSED	

LOCATION APPROVED UNDERGROUND STRUCTURES

SUPV. U/G STRUCTURES COMMITTEE DATE
NOTE: LOCATION OF UNDERGROUND STRUCTURES AS SHOWN ARE BASED ON THE BEST INFORMATION AVAILABLE BUT NO GUARANTEE IS GIVEN THAT THE GIVEN LOCATIONS ARE EXACT. CONFIRMATION OF EXISTENCE AND EXACT LOCATION OF ALL SERVICES MUST BE OBTAINED FROM THE INDIVIDUAL UTILITIES BEFORE PROCEEDING WITH CONSTRUCTION.

B.M.	37-003	Bolt in 7.3m Conc. pile, 0.3m N. of N.L.
ELEV.	233.449	of St.
NO.	REVISIONS	DATE BY
1	ISSUED FOR ADDENDUM 1	13/08/28 GES
0	ISSUED FOR TENDER	13/08/22 GES

DESIGNED BY	GES	CHECKED BY	CR
DRAWN BY	GEL	APPROVED BY	RJH
HOR. SCALE:	1:250	RELEASED FOR CONSTRUCTION:	
VERTICAL:	1:50	DATE	13/08/20

ENGINEER'S SEAL
M.C. ROWBOTHAM
22678
August 27, 2013
CONSULTANT DRAWING NO. 13-0107-011_C13

THE CITY OF WINNIPEG
PUBLIC WORKS DEPARTMENT
TRANSPORTATION ENGINEERING DIVISION
PROJECT TITLE: 2013 ALLEY RENEWAL PROGRAM CONTRACT 2
ASHBURN ST/VALOUR RD
ST MATTHEWS AVE TO ELLICE AVE
STA 2+00 TO STA 3+20
SHEET 13 OF 15
COMPUTER FILE NAME: 13-0107-011_CALL
CITY DRAWING NUMBER: 0013

P:\Projects\2013\13-0107-011\DocControl\ToBeIssued\DWG\13-0107-011_C13-Rev 1.dwg - Tab: 13 Plotted By: Gloewen 08/27/2013 [Tue 2:04pm] PLOT 1:1 A-1